

UNITED STATES  
DEPARTMENT OF THE INTERIOR  
BUREAU OF LAND MANAGEMENT

FORM APPROVED  
OMB NO. 1004-0137  
Expires March 31, 2007

SUNDRY NOTICES AND REPORTS ON WELLS

Do not use this form for proposals to drill or to re-enter an abandoned well. Use Form 3160-3 (APD) for such proposals.

SUBMIT IN TRIPLICATE - Other instructions on reverse side

1. Type of Well

☐ Oil Well ☒ Gas Well ☐ Other

2. Name of Operator

Peoples Energy Production - TX, L.P.

3a. Address

909 Farmin, Suite 1300, Houston TX 77010

3b. Phone No. (include area code)

713-890-3651

4. Location of Well (Footage, Sec., T., R., M., or Survey Description)

UL P, Sec 25, T-32N, R-9W  
1030' FSL & 870' FEL  
San Juan County, New Mexico

5. Lease Serial No.

NNM-0013642

6. If Indian, Allottee or Tribe Name

7. If Unit or CA/Agreement, Name and/or No.

8. Well Name and No.

Gardner #4A

9. API Well No.

30-045-22768

10. Field and Pool, or Exploratory Area

Blanco-Mesa Verde

11. County or Parish, State

San Juan NM

12. CHECK APPROPRIATE BOX(ES) TO INDICATE NATURE OF NOTICE, REPORT, OR OTHER DATA

TYPE OF SUBMISSION

☒ Notice of Intent

☐ Subsequent Report

☐ Final Abandonment Notice

TYPE OF ACTION

☐ Acidize

☐ Alter Casing

☐ Casing Repair

☐ Change Plans

☐ Convert to Injection

☐ Deepen

☐ Fracture Treat

☐ New Construction

☐ Plug and Abandon

☐ Plug Back

☐ Production (Start/Resume)

☐ Reclamation

☐ Recomplete

☐ Temporarily Abandon

☐ Water Disposal

☐ Water Shut-Off

☐ Well Integrity

☒ Other Amend

Acreeage Dedication

13. Describe Proposed or Completed Operation (clearly state all pertinent details, including estimated starting date of any proposed work and approximate duration thereof. If the proposal is to deepen directionally or recompleat horizontally, give subsurface locations and measured and true vertical depths of all pertinent markers and zones. Attach the Bond under which the work will be performed or provide the Bond No. on file with BLM/BIA. Required subsequent reports shall be filed within 30 days following completion of the involved operations. If the operation results in a multiple completion or recompleat in a new interval, a Form 3160-4 shall be filed once testing has been completed. Final Abandonment Notices shall be filed only after all requirements, including reclamation, have been completed, and the operator has determined that the final site is ready for final inspection.)

Please find attached, a plat for the above well indicating an amended acreage dedication.

All wells within Section 25 are to be amended to reflect stand up 320's (E/2, W/2) acreage dedication.

Currently there is a mixture of stand up's and lay down's which are conflicting.

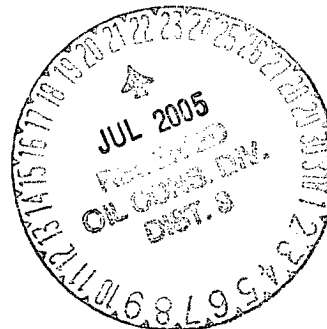

14. I hereby certify that the foregoing is true and correct  
Name (Printed/Typed)

Dianne Sumrall

Title

Production & Regulatory Supervisor

Date 07/13/05

THIS SPACE FOR FEDERAL OR STATE OFFICE USE

Approved by

/s/ Adrienne Brumley

Title

Pet. Eng

Date

7/19/05

Conditions of approval, if any, are attached. Approval of this notice does not warrant or certify that the applicant holds legal or equitable title to those rights in the subject lease which would entitle the applicant to conduct operations thereon.

Office

FFO

NEW MEXICO OIL CONSERVATION COMMISSION  
WELL LOCATION AND ACERAGE DEDICATION PLAT

EXHIBIT #5

All distances must be from the outer boundaries of the Section

Koch Exploration Company			Lease <b>GARDNER</b>		Well No. <b>4-A</b>
Init Letter <b>P</b>	Section <b>25</b>	Township <b>32 NORTH</b>	Range <b>9 WEST</b>	County <b>SAN JUAN</b>	
Actual Footage Location of Well: <b>1030</b> feet from the <b>SOUTH</b> line and <b>870</b> feet from the <b>EAST</b> line Ground Level Elev. <b>6670</b> Producing Formation <b>Mesa Verde</b> Pool <b>Blanco</b> Dedicated Acreage: <b>320.78</b> Acres					

1. Outline the acreage dedicated to the subject well by colored pencil or hachure marks on the plat below.
2. If more than one lease is dedicated to the well, outline each and identify the ownership thereof (both as to working interest and royalty).
3. If more than one lease of different ownership is dedicated to the well, have the interests of all owners been consolidated by communitization, unitization, force-pooling, etc?

( ) Yes ( ) No If answer is "yes," type of consolidation \_\_\_\_\_

If answer is "no," list the owners and tract descriptions which have actually consolidated. (Use reverse side of this form if necessary.) \_\_\_\_\_

No allowable will be assigned to the well until all interests have been consolidated (by communitization, unitization, forced-pooling, or otherwise) or until a non standard unit, eliminating such interests, has been approved by the Commission.

CERTIFICATION

I hereby certify that the information contained herein is true and complete to the best of my knowledge and belief.

Vernon J. Lowe  
Name

Vernon J. Lowe  
Position

Asst. Operations Manager  
Koch Exploration Company  
Div. of Koch Industries Inc  
Date

9-9-77

I hereby certify that the well location shown on this plat was plotted from field notes of actual surveys made by me or under my supervision, and that the same is true and correct to the best of my knowledge and belief.

16 August 1977

Date Surveyed  
James P. Leese  
Registered Professional Engineer  
and/or Land Surveyor **James P. Leese**

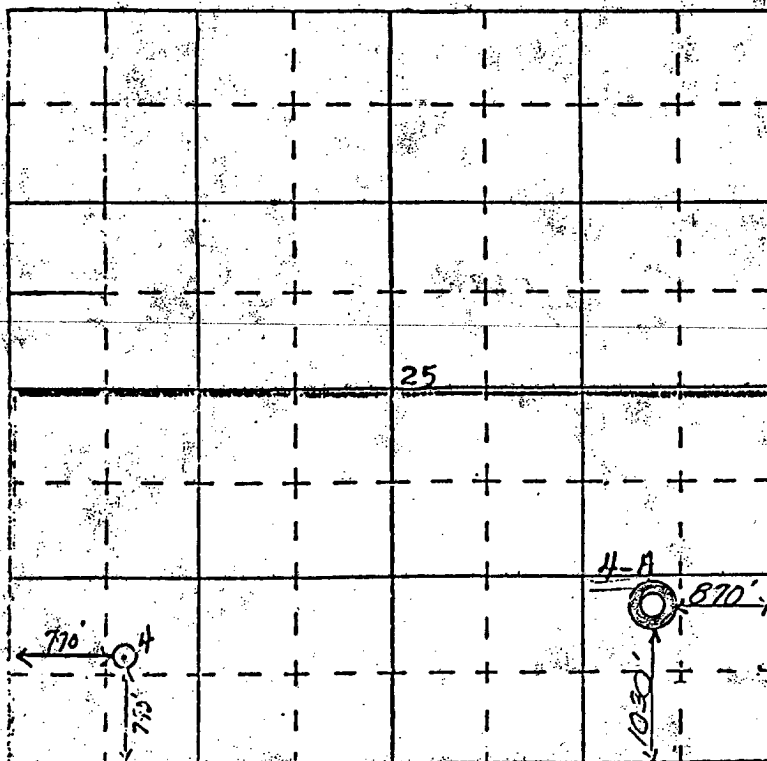

SCALE - 1 INCHES EQUALS 1 MILE