

District I
1625 N. French Dr., Hobbs, NM 88240
District II
1301 W. Grand Avenue, Artesia, NM 88210
District III
1000 Rio Brazos Road, Aztec, NM 87410
District IV
1220 S. St. Francis Dr., Santa Fe, NM 87505

State of New Mexico
Energy Minerals and Natural Resources

Form C-144
June 1, 2004

Oil Conservation Division
1220 South St. Francis Dr.
Santa Fe, NM 87505

For drilling and production facilities, submit to
appropriate NMOCD District Office.
For downstream facilities, submit to Santa Fe
office

Pit or Below-Grade Tank Registration or Closure

Is pit or below-grade tank covered by a "general plan"? Yes ☒ No ☐

Type of action: Registration of a pit or below-grade tank ☐ Closure of a pit or below-grade tank ☒

Operator: **Black Hills Gas Resources** Telephone: **(505) 634-1111 ext 27** e-mail address: **lbenally@bhgp.com**
Address: **3200 N 1st Street PO Box 249 Bloomfield, NM 87413**
Facility or well name: **Jicarilla 458-5 #2** API #: **30-039-25781** U/L or Qtr/Qtr **1850' FSL 790' FWL (NE/4 SE/4)** Sec **5** T **30N** R **3W**
County: **Rio Arriba** Latitude **36° 50' 19.62202" N** Longitude **107° 10' 44.384506" W** NAD: 1927 ☐ 1983 ☒
Surface Owner: Federal ☐ State ☐ Private ☐ Indian ☒

Pit Type: Drilling <input checked="" type="checkbox"/> Production <input type="checkbox"/> Disposal <input type="checkbox"/> Workover <input type="checkbox"/> Emergency <input type="checkbox"/> Lined <input checked="" type="checkbox"/> Unlined <input type="checkbox"/> Liner type: Synthetic <input checked="" type="checkbox"/> Thickness 15 mil Clay <input type="checkbox"/> Pit Volume 5,000 bbl	Below-grade tank Volume: _____ bbl Type of fluid: _____ Construction material: _____ Double-walled, with leak detection? Yes <input type="checkbox"/> If not, explain why not: _____	
Depth to ground water (vertical distance from bottom of pit to seasonal high water elevation of ground water.)	Less than 50 feet	(20 points)
	50 feet or more, but less than 100 feet	(10 points)
	100 feet or more	(0 points)
Wellhead protection area: (Less than 200 feet from a private domestic water source, or less than 1000 feet from all other water sources.)	Yes	(20 points)
	No	(0 points)
Distance to surface water: (horizontal distance to all wetlands, playas, irrigation canals, ditches, and perennial and ephemeral watercourses.)	Less than 200 feet	(20 points)
	200 feet or more, but less than 1000 feet	(10 points)
	1000 feet or more	(0 points)
Ranking Score (Total Points)		0 points

If this is a pit closure: (1) Attach a diagram of the facility showing the pit's relationship to other equipment and tanks. (2) Indicate disposal location: (check the onsite box if you are burying in place) onsite ☒ offsite ☐ If offsite, name of facility: _____. (3) Attach a general description of remedial action taken including remediation start date and end date. (4) Groundwater encountered: No ☒ Yes ☐ If yes, show depth below ground surface _____ ft. and attach sample results. (5) Attach soil sample results and a diagram of sample locations and excavations.

Additional Comments:
No visual soil staining was seen, soils had no odor, and pit only had produced water from drilling operations. No soil samples were taken.

I hereby certify that the information above is true and complete to the best of my knowledge and belief. I further certify that the above-described pit or below-grade tank has been/will be constructed or closed according to NMOCD guidelines ☒, a general permit ☐, or an (attached) alternative OCD-approved plan ☐.

Date: **09/30/05**

Printed Name/Title: **Lynn H. Benally / Regulatory Specialist**

Signature: 

Your certification and NMOCD approval of this application/closure does not relieve the operator of liability should the contents of the pit or tank contaminate ground water or otherwise endanger public health or the environment. Nor does it relieve the operator of its responsibility for compliance with any other federal, state, or local laws and/or regulations.

Approval:

Printed Name/Title:

DEPUTY OIL & GAS INSPECTOR, DIST. 03

Signature:

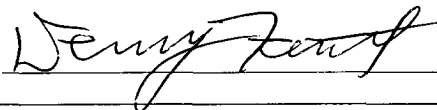

Date:

OCT 07 2005

Pit Closure Diagram

Operator: Black Hills Gas Resources

Telephone: (505) 634-1111 ext 27

e-mail address: lbenally@bhep.com

Address: 3200 N 1st Street PO Box 249 Bloomfield, NM 87413

Facility or well name: Jicarilla 458-5 #2 API #: 30-039-25781 U/L or Qtr/Qtr 1850' FSL 790' FWL (NE/4 SE/4) Sec 5 T 30N R 3W

County: Rio Arriba Latitude 36° 50' 19.62202" N Longitude 107° 10' 44.84506" W NAD: 1927 ☐ 1983 ☒

Surface Owner: Federal ☐ State ☐ Private ☐ Indian ☒



Well head

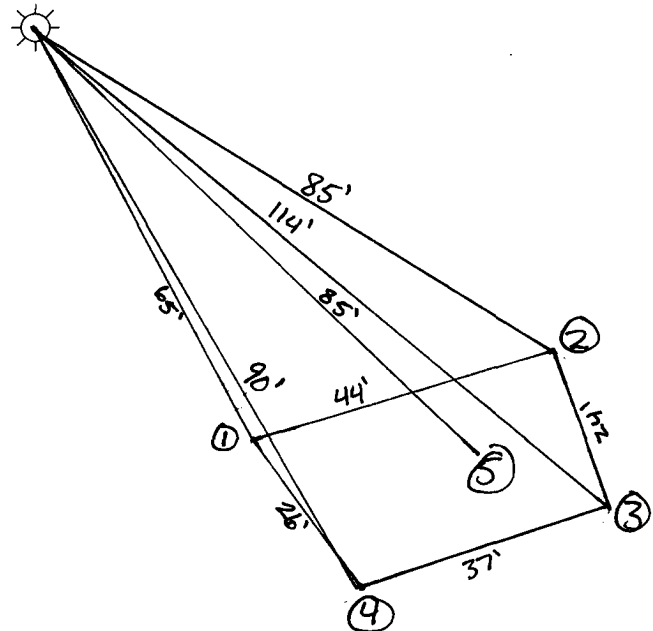

1. $\angle 152^\circ$ from North
2. $\angle 122^\circ$ from North
3. $\angle 130^\circ$ from North
4. $\angle 150^\circ$ from North
5. $\angle 134^\circ$ from North

Scale: $\frac{3}{8}'' = 10'$