

2005 JUL 11 PM 1 34

RECEIVED  
FARMINGTON NM  
2005 JUL 11 PM 1 34  
RECEIVED  
070 FARMINGTON NM  
UNITED STATES  
DEPARTMENT OF THE INTERIOR  
BUREAU OF LAND MANAGEMENT  
APPLICATION OF FOR PERMIT TO DRILL OR REENTER

FORM APPROVED  
OMB No. 1004-0136  
Expires November 30, 2000

5. Lease Serial No. **SF - 079319**

6. If Indian, Allottee or tribe Name

7. If Unit or CA Agreement, Name and No

8. Lease Name and Well No.  
**Schwerdtfeger A LS 25**

9. API Well No.  
**30-045-33226**

10. Field and Pool, or Exploratory  
**Basin Fruitland Coal**

11. Sec., T., R., M., or Blk. and survey or Area  
**SECTION 36 T28N & R09W**  
**K**

12. County or Parish  
**SAN JUAN**

13. State  
**NEW MEXICO**

17. Spacing Unit dedicated to this well  
**318.85 w/p**

20. BLM/BIA Bond No. on file  
**WY2924**

23. Estimated duration  
**3 DAYS**

24. Attachments

The following, completed in accordance with the requirements of Onshore Oil and Gas Order No. 1, shall be attached to this form:

1. Well plat certified by a registered surveyor.
2. A Drilling Plan.
3. A Surface Use Plan (if the location is on National forest System Lands, the SUPO shall be filed with the appropriate Forest Service Office).
4. Bond to cover the operations unless covered by an existing bond on file (see Item 20 above).
5. Operator certification.
6. Such other site specific information and/or plans as may be required by the authorized officer.

25. Signature **Cherry Hlava** Name (Printed/typed) **Cherry Hlava** Date **07/01/2005**

Title  
**Regulatory Analyst**

Approved by (Signature) **Jim Lovel** Name (Printed/Typed) Date **9/15/05**

Title **Field Manager - Minerals** Office

Application approval does not warrant or certify the applicant holds legal or equitable title to those rights in the subject lease which would entitle the applicant to conduct Operations thereon.

Conditions of approval, if any, are attached.

Title 18 U.S.C. Section 1001 and title 43 U.S.C. Section 1212, make it a crime for any person knowingly and willfully to make to any department or agency of the United States any false, fictitious or fraudulent statements or representations as to any matter within its jurisdiction.

\*(Instructions on reverse)

This action is subject to technical and procedural review pursuant to 43 CFR 3165.3 and appeal pursuant to 43 CFR 3165.4

DRILLING OPERATIONS AUTHORIZED ARE  
SUBJECT TO COMPLIANCE WITH ATTACHED  
"GENERAL REQUIREMENTS".

NMOC

District I  
PO Box 1980, Hobbs NM 88241-1980  
District II  
PO Drawer KK, Artesia, NM 87211-0719  
District III  
1000 Rio Brazos Rd., Aztec, NM 87410  
District IV  
PO Box 2088, Santa Fe, NM 87504-2088

State of New Mexico  
Energy, Minerals & Natural Resources Department

OIL CONSERVATION DIVISION  
PO Box 2088  
Santa Fe, NM 87504-2088

Form C-102  
Revised February 21, 1994  
Instructions on back  
Submit to Appropriate District Office  
State Lease - 4 Copies  
Fee Lease - 3 Copies

☐ AMENDED REPORT

WELL LOCATION AND ACREAGE DEDICATION PLAT

|                                     |  |   |  |  |  |                              |  |
|-------------------------------------|--|---|--|--|--|------------------------------|--|
| 1 API Number<br><b>30-045-33226</b> |  | 2 Pool Code<br><b>71629</b>                             |  | 3 Pool Name<br><b>Basin Fruitland Coal</b> |  |                              |  |
| 4 Property Code<br><b>001033</b>    |  | 5 Property Name<br><b>Schwerdtfeger A LS</b>            |  |  |  | 6 Well Number<br><b># 25</b> |  |
| 7 OGRID No.<br><b>000778</b>        |  | 8 Operator Name<br><b>BP AMERICA PRODUCTION COMPANY</b> |  |  |  | 9 Elevation<br><b>5889</b>   |  |

10 Surface Location

| UL or Lot No. | Section   | Township    | Range      | Lot 1dn | Feet from the | North/South line | Feet from the | East/West line | County          |
|---------------|-----------|-------------|------------|---------|---------------|------------------|---------------|----------------|-----------------|
| <b>K</b>      | <b>36</b> | <b>28 N</b> | <b>9 W</b> |         | <b>1875</b>   | <b>SOUTH</b>     | <b>1790</b>   | <b>WEST</b>    | <b>SAN JUAN</b> |

11 Bottom Hole Location If Different From Surface

|                                     |         |                    |       |                       |               |                  |               |                |        |
|-------------------------------------|---------|--------------------|-------|-----------------------|---------------|------------------|---------------|----------------|--------|
| 12 UL or lot no.                    | Section | Township           | Range | Lot 1dn               | Feet from the | North/South line | Feet from the | East/West line | County |
|                                     |         |                    |       |                       |               |                  |               |                |        |
| 13 Dedicated Acres<br><b>318.85</b> |         | 14 Joint or Infill |       | 15 Consolidation Code |               | 16 Order No.     |               |                |        |

NO ALLOWABLE WILL BE ASSIGNED TO THIS COMPLETION UNTIL ALL INTERESTS HAVE BEEN CONSOLIDATED  
OR A NON-STANDARD UNIT HAS BEEN APPROVED BY THE DIVISION

|  |  |  |  |  |  |
|--|--|--|--|--|--|
|  |  |  |  | <b>17 OPERATOR CERTIFICATION</b><br>I hereby certify that the information contained herein is true and complete to the best of my knowledge and belief.<br><br><b>Cherry Hlava</b><br>Signature<br><b>Cherry Hlava</b><br>Printed Name<br><b>Regulatory Analyst</b><br>Title<br><b>July 1, 05</b><br>Date  |  |
|  |  |  |  | <b>18 SURVEYOR CERTIFICATION</b><br>I hereby certify that the well location shown on this plat was plotted from field notes of actual surveys made by me or under my supervision, and that the same is true and correct to the best of my belief.<br><b>Restaked: June 15, 2005</b><br><b>May 12, 2005</b><br>Date of Survey<br>Signature and Seal of Professional Surveyor<br><br><b>7016</b><br>Certificate Number |  |

**PAD LAYOUT PLAN & PROFILE**  
**BP AMERICA PRODUCTION COMPANY**  
 Schwerdtfeger A LS # 25  
 1875' F/SL 1790' F/WL  
 SEC. 36, T28N, R9W, N.M.P.M.  
 SAN JUAN COUNTY, NEW MEXICO

Lat: 36.6167°  
 Long: 107.7428°

Lat: 36°36'59"  
 Long: 107°44'34"

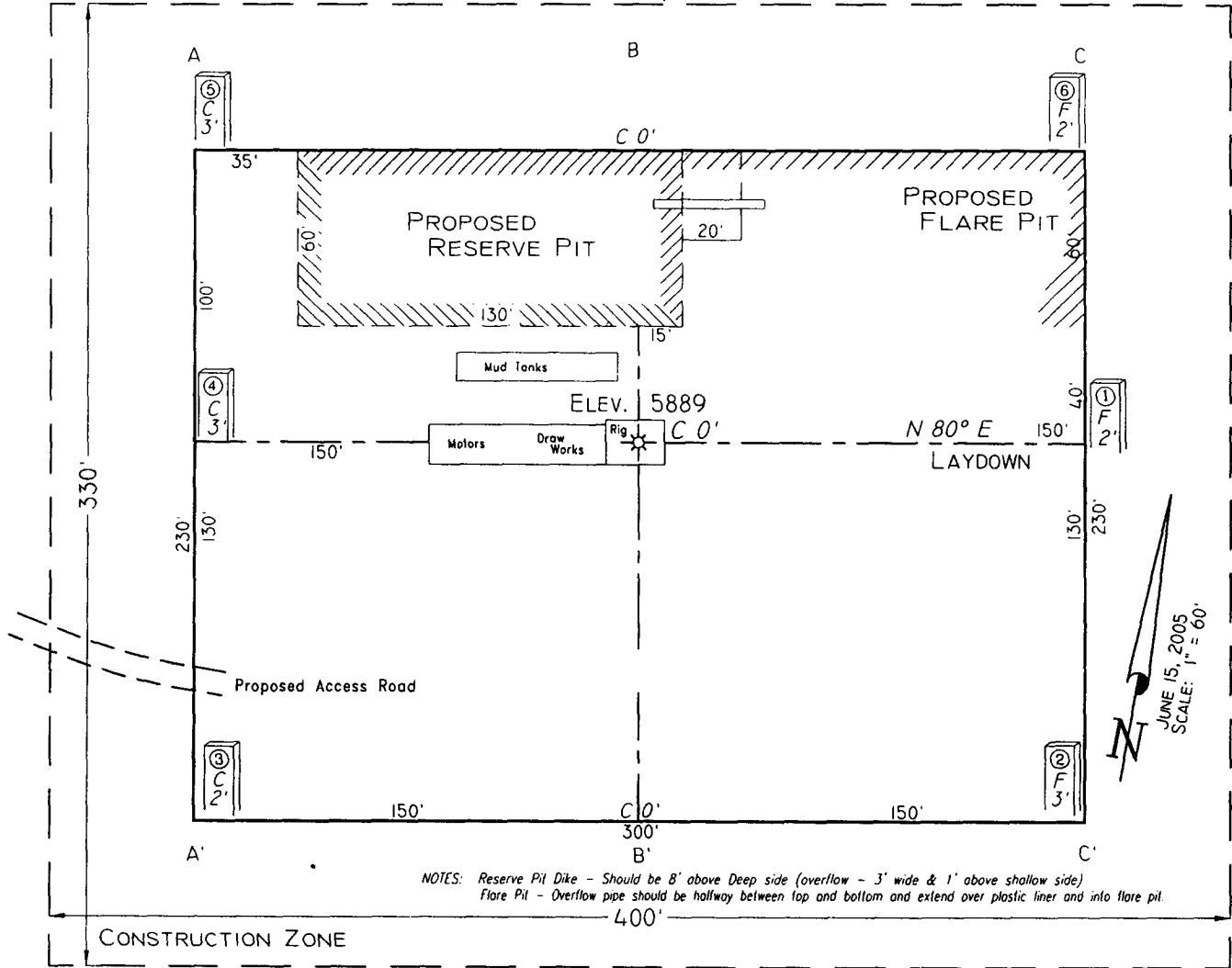

Area of Construction Zone - 330'x400' or 3.03 acres, more or less.

SCALE: 1"=60'-HORIZ.  
 1"=40'-VERT.

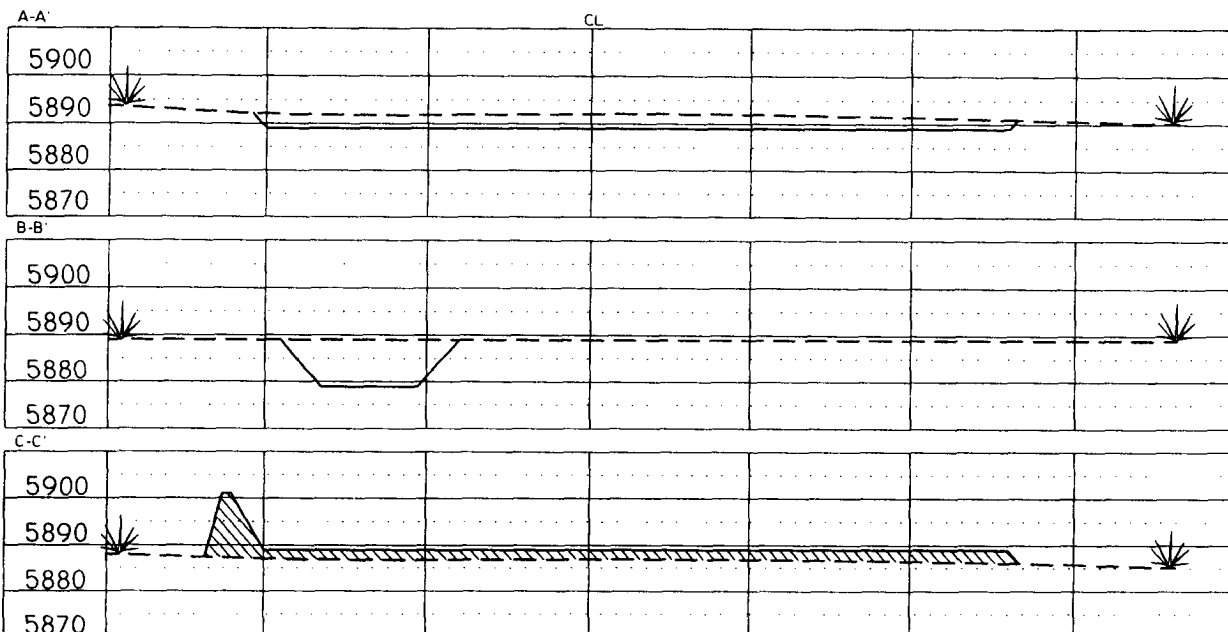

NOTE: Contractor should call One-Call for location of any marked or unmarked buried pipelines or cables on well pad and/or access road at least two (2) working days prior to construction.

Cuts and fills shown are approximate - final finished elevation is to be adjusted so earthwork will balance. Corner stakes are approximate and do not include additional areas needed for sideslopes and drainages. Final Pad Dimensions are to be verified by Contractor.

VANN SURVEYS  
 P. O. Box 1306  
 Farmington, NM

UNITED STATES  
DEPARTMENT OF THE INTERIOR  
BUREAU OF LAND MANAGEMENT

**SUNDRY NOTICES AND REPORTS ON WELLS**  
*Do not use this form for proposals to drill or to re-enter an  
Abandoned well. Use Form 3160-3 (APD) for such proposals.*

FORM APPROVED  
OMB No. 1004-0135  
Expires November 30, 2000

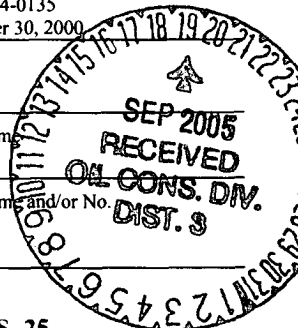

**SUBMIT IN TRIPLICATE – Other instructions on reverse side**

|  |  |  |
|--|--|--|
| 1. Type of Well<br><input type="checkbox"/> Oil Well <input checked="" type="checkbox"/> Gas Well <input type="checkbox"/> Other     |  | 5. Lease Serial No.<br><b>SF - 079319</b>                              |
| 2. Name of Operator<br><b>BP AMERICA PRODUCTION COMPANY</b>  |  | 6. If Indian, Allottee or tribe Name<br><b>09</b>                      |
| 3a. Address<br><b>P.O. Box 3092 Houston, Tx 77253-3092</b>   | 3b. Phone No. (include area code)<br><b>281-366-4081</b> | 7. If Unit or CA/Agreement, Name and/or No.<br><b>09</b>               |
| 4. Location of Well (Footage, Sec., T., R., M., or Survey Description)<br><b>Section 36 T28N R09W NESW 1875' FSL &amp; 1790' FWL</b> |  | 8. Well Name and No.<br><b>Schwerdtfeger A LS 25</b>                   |
|  |  | 9. API Well No.<br><b>3604533224</b>                                   |
|  |  | 10. Field and Pool, or Exploratory Area<br><b>BASIN FRUITLAND COAL</b> |
|  |  | 11. County or Parish, State<br><b>SAN JUAN, NM</b>                     |

**12. CHECK APPROPRIATE BOX(ES) TO INDICATE NATURE OR NOTICE, REPORT, OR OTHER DATA**

| TYPE OF SUBMISSION                                   | TYPE OF ACTION                                |   |  |   |
|--|---|---|--|---|
| <input checked="" type="checkbox"/> Notice of Intent | <input type="checkbox"/> Acidize              | <input type="checkbox"/> Deepen           | <input type="checkbox"/> Production (Start/Resume) | <input type="checkbox"/> Water shut-Off             |
| <input type="checkbox"/> Subsequent Report           | <input type="checkbox"/> Alter Casing         | <input type="checkbox"/> Fracture Treat   | <input type="checkbox"/> Reclamation               | <input type="checkbox"/> Well Integrity             |
| <input type="checkbox"/> Final Abandonment Notice    | <input type="checkbox"/> Casing Repair        | <input type="checkbox"/> New Construction | <input type="checkbox"/> Recomplete                | <input type="checkbox"/> Other                      |
|  | <input type="checkbox"/> Change Plans         | <input type="checkbox"/> Plug and Abandon | <input type="checkbox"/> Water Disposal            | <input type="checkbox"/> Slight change to Tops & TD |
|  | <input type="checkbox"/> Convert to Injection | <input type="checkbox"/> Plug Back        |  |   |

13. Describe Proposed or Completed Operation (clearly state all pertinent details, including estimated starting date of any proposed work and approximate duration thereof. If the proposal is to deepen directionally or recompleat horizontally, give subsurface locations and measured and true vertical depths of all pertinent markers and zones. Attach the Bond under which the work will be performed or provide the Bond No. on file with BLM/BIA. Required subsequent reports shall be filed within 30 days following completion of the involved operations. If the operation results in a multiple completion or recompleat in a new interval, a Form 3160-4 shall be filed once testing has been completed. Final Abandonment Notices shall be filed only after all requirements, including reclamation, have been completed, and the operator has determined that the site is ready for final inspection.

**On 7/1/05 APD was submitted for BLM approval. Subsequently BP America has revised the Fruitland and Pictured Cliffs tops and corrected the ground elevation to match plat (C-102). Please see the attached Amended drilling plan (form 46)**

**The TD will change only 8' and will not change the cement program.**

14. I hereby certify that the foregoing is true and correct  
Name (Printed/typed)

**Cherry Hlava**

Title **Regulatory Analyst**

Signature

Date **07/15/2005**

**THIS SPACE FOR FEDERAL OR STATE OFFICE USE**

|   |  |                     |
|---|--|---------------------|
| Approved by <i>Cherry Hlava</i>   | Title <i>Acting Field Manager Minerals</i> | Date <i>9/15/05</i> |
| Conditions of approval, if any, are attached. Approval of this notice does not warrant or Certify that the applicant holds legal or equitable title to those rights in the subject lease which would entitle the applicant to conduct operations thereon. |  | Office              |

Title 18 U.S.C. Section 1001 and Title 43 U.S.C. Section 1212, make it a crime for any person knowingly and willfully to make to any department or agency of the United States any false, fictitious or fraudulent statements or representations as to any matter within its jurisdiction.

NMCCD



# Cementing Program

Well Name: Schwerdtferger A LS #25  
 Location: Sec 36 - 28N - 09W, 1875' FSL, 1790' FWL  
 County: San Juan  
 State: New Mexico

API No.   
 Well Flac   
 Formation: Fruitland Coal  
 KB Elev (est) 5938  
 GL Elev. (est) 5927

## Casing Program:

| Casing String | Est. Depth (ft.) | Hole Size (in.) | Casing Size (in.) | Thread | TOC (ft.) |
|---------------|------------------|-----------------|-------------------|--------|-----------|
| Surface       | 200              | 12.25           | 8 5/8             | 8rd    | Surface   |
| Production -  | 2193             | 7.875           | 5 1/2             | 8rd    | Surface   |

## Casing Properties: (No Safety Factor Included)

| Casing String | Size (in.) | Weight (lb/ft) | Grade |
|---------------|------------|----------------|-------|
| Surface       | 8 5/8      | 20             | H-40  |
| Production -  | 5 1/2      | 15.5           | J-55  |

## Mud Program

| Apx. Interval (ft.) | Mud Type   | Mud Weight | Recommended Mud Properties Prio Cementing: |
|---------------------|------------|------------|--|
|                     |            |            | PV <20<br>YP <10<br>Fluid Loss <6          |
| 0 - SCP             | Water/Spud | 8.6-9.2    |  |
| SCP - TD            | Water/LSND | 8.6-9.2    |  |

## Cementing Program:

|                      | Surface | Production |
|----------------------|---------|------------|
| Excess %, Lead       | 100     | 40         |
| Excess %, Tail       | NA      | 40         |
| BHST (est deg. F)    | 75      | 120        |
| Special Instructions | 1,6     | 2,4,6      |

1. Do not wash pumps and lines.
2. Wash pumps and lines.
3. Reverse out
4. Run Blend Test on Cement
5. Record Rate, Pressure, and Density on 3.5" disk
6. Confirm densitometer with pressurized mud scales

## Surface:

|             |                          |            |                   |
|-------------|--------------------------|------------|-------------------|
| Preflush    | 20 bbl.                  | FreshWater |                   |
| Slurry 1    | 130 sx Class C Cement    |            | 165 cuft          |
| TOC@Surface | + 2% CaCl2 (accelerator) |            |                   |
|             |                          |            | 0.4127 cuft/ft OH |

| Slurry Properties: | Density (lb/gal) | Yield (ft3/sk) | Water (gal/sk) |
|--------------------|------------------|----------------|----------------|
| Slurry 1           | 15.2             | 1.27           | 5.8            |

Casing Equipment:

- 8-5/8", 8R, ST&C
- 1 Guide Shoe
- 1 Top Wooden Plug
- 1 Autofill insert float valve
- Centralizers, 1 per joint except top joint
- 1 Stop Ring
- 1 Thread Lock Compound

# Cementing Program

**Production:**

Fresh Water                      10 bbl                      CW100

|             |                             |                        |
|-------------|-----------------------------|------------------------|
| Lead        | 174 sx Class "G" Cement     | 455 cuft               |
| Slurry 1    | + 3% D79 extender           |                        |
| TOC@Surface | + 2% S1 Calcium Chloride    |                        |
|             | +1/4 #/sk. Cellophane Flake |                        |
|             | + 0.1% D46 antifoam'        |                        |
| Tail        | 111 sx 50/50 Class "G"/Poz  | 141 cuft               |
| Slurry 2    | + 2% gel (extender)         |                        |
| 500 ft fill | 0.1% D46 antifoam           | 0.2009 cuft/ft OH      |
|             | +1/4 #/sk. Cellophane Flake | 0.1733 cuft/ft csg ann |
|             | + 2% CaCl2 (accelerator)    |                        |

| Slurry Properties: | Density<br>(lb/gal) | Yield<br>(ft3/sk) | Water<br>(gal/sk) |
|--------------------|---------------------|-------------------|-------------------|
| Slurry 1           | 11.4                | 2.61              | 17.77             |
| Slurry 2           | 13.5                | 1.27              | 5.72              |

Casing Equipment:

- 5 1/2", 8R, ST&C
- 1 Float Shoe (autofill with minimal LCM in mud)
- 1 Float Collar (autofill with minimal LCM in mud)
- Centralizers as needed
- 1 Top Rubber Plug
- 1 Thread Lock Compound

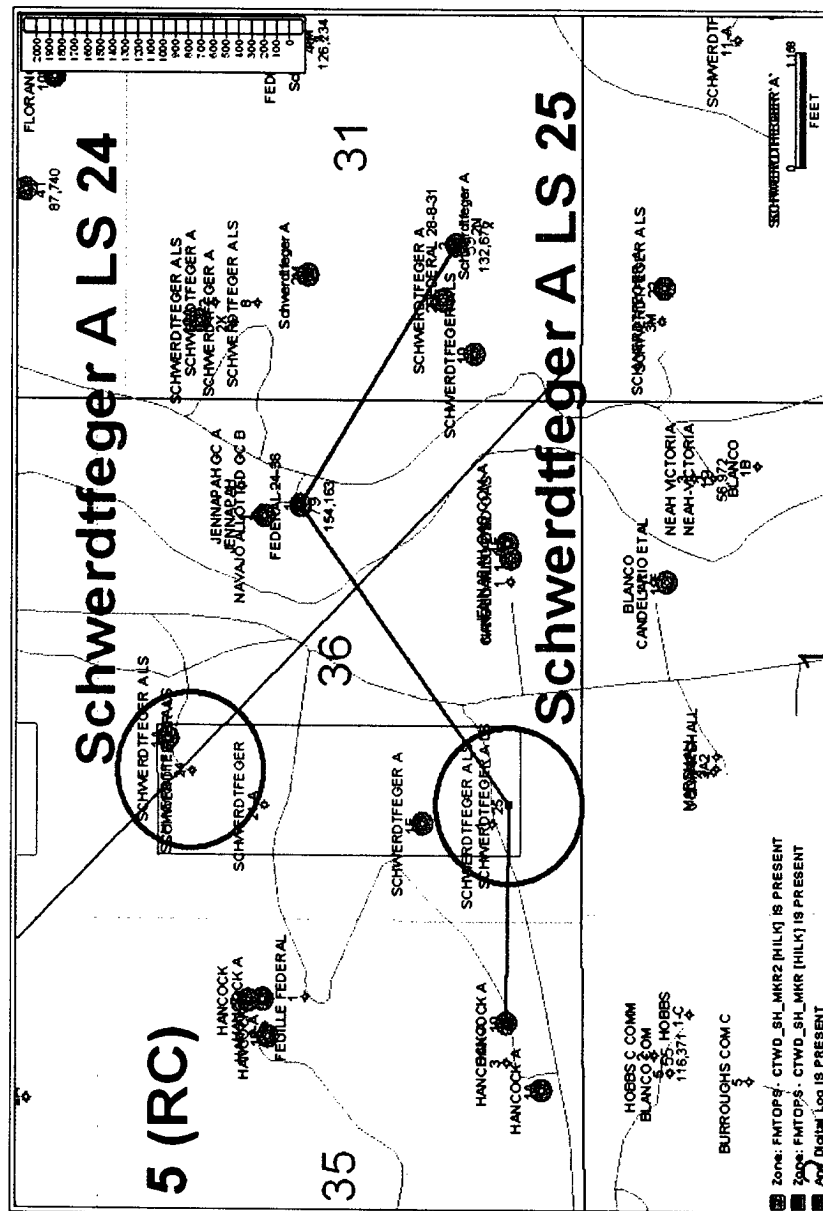



# BP American Production Company

## Well Control Equipment Schematic

