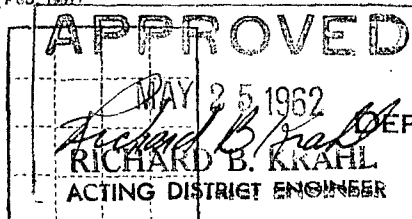

30.045-07202

Form 9-331a
(Feb. 1951)Budget Form No. 42-R382
Approval expires 12-31-60.

(SUBMIT IN TRIPLICATE)

UNITED STATES

DEPARTMENT OF THE INTERIOR
GEOLOGICAL SURVEY

Land Office Santa Fe

Lease No. 077107-A

Unit

RECEIVED

SUNDRY NOTICES AND REPORTS ON WELLS

MAY 25 1962

U. S. GEOLOGICAL SURVEY FARMINGTON, NEW MEXICO	
NOTICE OF INTENTION TO DRILL.....	<input checked="" type="checkbox"/> SUBSEQUENT REPORT OF WATER SHUT-OFF.....
NOTICE OF INTENTION TO CHANGE PLANS.....	SUBSEQUENT REPORT OF SHOOTING OR ACIDIZING.....
NOTICE OF INTENTION TO TEST WATER SHUT-OFF.....	SUBSEQUENT REPORT OF ALTERING CASING.....
NOTICE OF INTENTION TO RE-DRILL OR REPAIR WELL.....	SUBSEQUENT REPORT OF RE-DRILLING OR REPAIR.....
NOTICE OF INTENTION TO SHOOT OR ACIDIZE.....	SUBSEQUENT REPORT OF ABANDONMENT.....
NOTICE OF INTENTION TO PULL OR ALTER CASING.....	SUPPLEMENTARY WELL HISTORY.....
NOTICE OF INTENTION TO ABANDON WELL.....	

(INDICATE ABOVE BY CHECK MARK NATURE OF REPORT, NOTICE, OR OTHER DATA)

May 25, 1962

Hancock "B"

Well No. 8 is located 820 ft. from ^(N) line and 1500 ft. from ^(W) line of sec. 27

NW/4 Sec. 27

(1/4 Sec. and Sec. No.)

28N

(Twp.)

9W

(Range)

N.M.P.M.

(Meridian)

South Blanco Pictured Cliffs

(Field)

San Juan

(County or Subdivision)

New Mexico

(State or Territory)

The elevation of the derrick floor above sea level is 6885 ft.

DETAILS OF WORK

(State names of and expected depths to objective sands; show sizes, weights, and lengths of proposed casings; indicate mudlogging jobs, cementing points, and all other important proposed work)

It is intended to mud drill a well with rotary tools thru the Pictured Cliffs formation and to perforate and fracture possible producing zones. Est. T. D. 3220'.

Casing Program:

8 5/8" at 120' w/120 sks. cement circulated to surface.

2 7/8" at 3220' w/120 sks. cement to cover Ojo Alamo.

The NW/4 of Section 27 is dedicated to this well.

I understand that this plan of work must receive approval in writing by the Geological Survey before operations may be commenced.

Company El Paso Natural Gas Company

Address Box 990

Farmington, New Mexico

By

W. W. Meacham

Title Petroleum Engineer

Well Location and Acreage Dedication Plat

Section A.

Date MAY 4, 1962

Operator EL PASO NATURAL GAS COMPANY Lease HANCOCK "B" SFO77107-A
 Well No. 8 Unit Letter C Section 27 Township 28-N Range 9-W NMPM
 Located 820 Feet From NORTH Line 1500 Foot From WEST Line
 County SAN JUAN G. L. Elevation 6875 Dedicated Acreage 160 Acres
 Name of Producing Formation PICTURED CLIFFS Pool SOUTH BLANCO P.C.

1. Is the Operator the only owner in the dedicated acreage outlined on the plat below?
 Yes ☒ No ☐
2. If the answer to question one is "no", have the interests of all the owners been consolidated by communitization agreement or otherwise? Yes ☐ No ☐ If answer is "yes", Type of Consolidation.
3. If the answer to question two is "no", list all the owners and their respective interests below:

Owner

Land Description

Section B.

This is to certify that the information in Section A above is true and complete to the best of my knowledge and belief.

El Paso Natural Gas Company

(Operator)

Original Signed D. W. Meehan

(Representative)

Box 990

(Address)

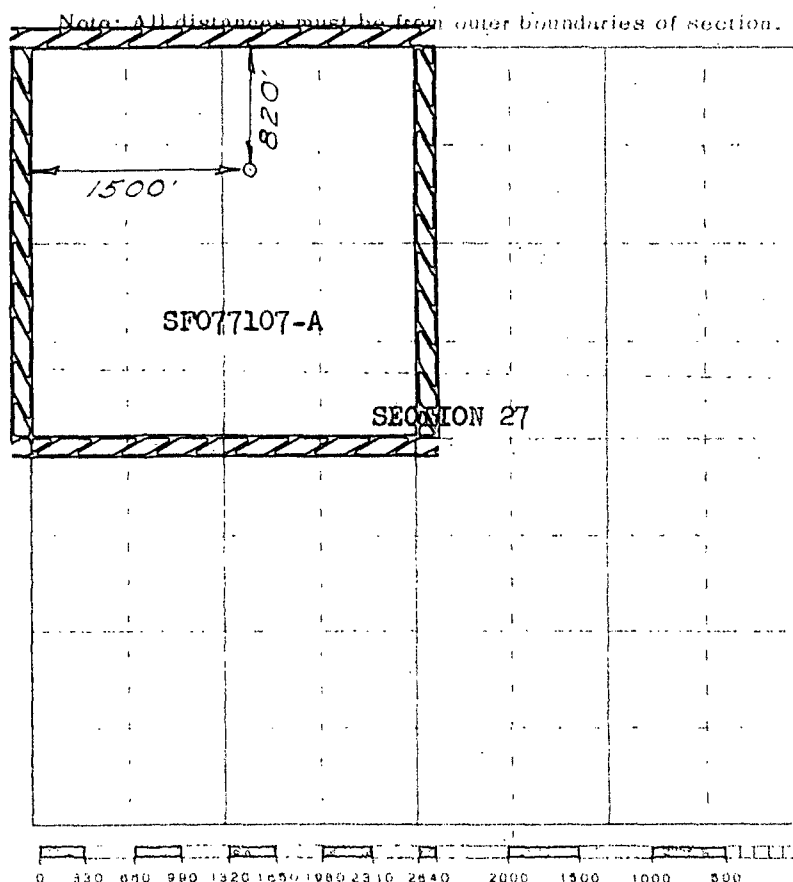
Farmington, New Mexico

Scale 4 inches equal 1 mile

This is to certify that the above plat was prepared from field notes of actual surveys made by me or under my supervision and that the same are true and correct to the best of my knowledge and belief.

(Seal)

Date Surveyed APRIL 26, 1962

David O. Kibben
 Registered Professional Engineer and/or Land Surveyor

Farmington, New Mexico