

District I  
1625 N. French Dr., Hobbs, NM 88240  
District II  
1361 W. Grand Avenue, Artesia, NM 88210  
District III  
1000 Rio Brazos Road, Aztec, NM 87410  
District IV  
1220 S. St. Francis Dr., Santa Fe, NM 87505

State of New Mexico  
Energy Minerals and Natural Resources

Oil Conservation Division  
1220 South St. Francis Dr.  
Santa Fe, NM 87505

Form C-144  
June 1, 2004

For drilling and production facilities, submit to  
appropriate NMOCD District Office.  
For downstream facilities, submit to Santa Fe  
office

**Pit or Below-Grade Tank Registration or Closure**

Is pit or below-grade tank covered by a "general plan"? Yes ☒ No ☐

(WFS CLOSURE)

Type of action: Registration of a pit or below-grade tank ☐ Closure of a pit or below-grade tank ☒

Operator: <u>BURLINGTON RESOURCES OIL &amp; GAS CO</u> Telephone: _____ e-mail address: _____	
Address: <u>801 CHERRY ST FORT WORTH, TX 76102</u>	
Facility or well name: <u>HARE #019</u>	API #: <u>30-045-08121</u> U/L or Qtr/Qtr <u>A</u> SEC <u>23</u> T <u>29N</u> R <u>10W</u>
County: <u>SAN JUAN</u>	Latitude <u>36.71583</u> Longitude <u>-107.84896</u> NAD: 1927 <input checked="" type="checkbox"/> 1983 <input type="checkbox"/>
Surface Owner: Federal <input checked="" type="checkbox"/> State <input type="checkbox"/> Private <input type="checkbox"/> Indian <input type="checkbox"/>	
<b>Pit</b> Type: Drilling <input type="checkbox"/> Production <input checked="" type="checkbox"/> Disposal <input type="checkbox"/> Workover <input type="checkbox"/> Emergency <input type="checkbox"/> Lined <input type="checkbox"/> Unlined <input checked="" type="checkbox"/> Liner Type: Synthetic <input checked="" type="checkbox"/> Thickness _____ mil Clay <input type="checkbox"/> Pit Volume <u>77</u> bbl	<b>Below-grade tank</b> Volume: _____ bbl Type of fluid: _____ Construction Material: _____ Double-walled, with leak detection? Yes <input checked="" type="checkbox"/> If not, explain why not.
Depth to ground water (vertical distance from bottom of pit to seasonal high water elevation of ground water.)	Less than 50 feet (20 points) 50 feet or more, but less than 100 feet (10 points) <u>0</u> 100 feet or more (0 points)
Wellhead protection area: (Less than 200 feet from a private domestic water source, or less than 1000 feet from all other water sources.)	Yes (20 points) No (0 points) <u>0</u>
Distance to surface water: (Horizontal distance to all wetlands, playas, irrigation canals, ditches, and perennial and ephemeral watercourses.)	Less than 200 feet (20 points) 200 feet to 1,000 feet (10 points) <u>0</u> Greater than 1,000 feet (0 points)
Ranking Score (TOTAL POINTS): <u>0</u>	

If this is a pit closure: (1) Attach a diagram of the facility showing the pit's relationship to other equipment and tanks. (2) Indicate disposal location: (check the onsite box if you are burying in place) onsite ☒ offsite ☐ If offsite, name of facility \_\_\_\_\_. (3) Attach a general description of remedial action taken including remediation start date and end date. (4) Groundwater encountered: No ☒ Yes ☐ If yes, show depth below ground surface \_\_\_\_\_ ft. and attach sample results. (5) Attach soil sample results and a diagram of sample locations and excavations.

Additional Comments:

Risk

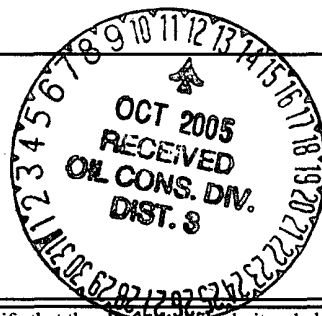

I hereby certify that the information above is true and complete to the best of my knowledge and belief. I further certify that the above described pit or below-grade tank has been/will be constructed or closed according to NMOCD guidelines ☐, a general permit ☐, or an (attached) alternative OCD-approved plan ☒

Date: 9/9/05

Printed Name/Title Mark Harvey for Williams Field Services Signature Mark Harvey FOR WFS

Your certification and NMOCD approval of this application/closure does not relieve the operator of liability should the contents of the pit or tank contaminate ground water or otherwise endanger public health or the environment. Nor does it relieve the operator of its responsibility for compliance with any other federal, state, or local laws and/or regulations.

Approval:

Printed Name/Title DEPUTY OIL & GAS INSPECTOR, DIST. 4

Signature Henry Terry

Date: OCT 12 2005

# **ADDENDUM TO OCD FORM C-144**

**Operator:** BURLINGTON RESOURCES OIL & GAS COMPANY LP

**API:** 30-045-08121

**Well Name:** HARE #019

**Meter:** 32707

**Facility Diagram:**

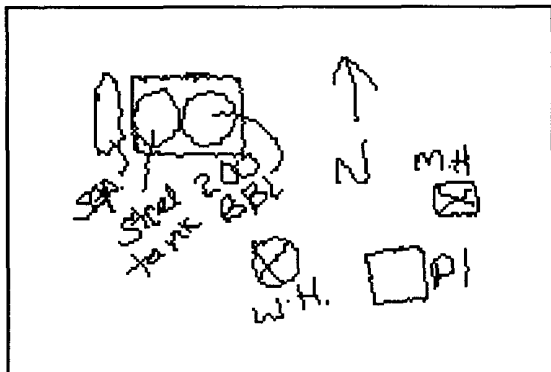

**Sampling Diagram:**

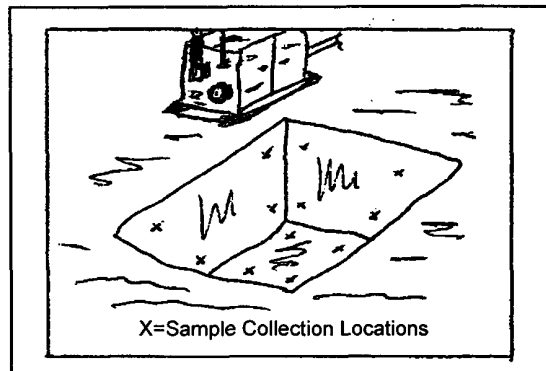

**Pit Dimensions**

Length 12 Ft.

Width 12 Ft.

Depth 3 Ft.

**Location of Pit Center**

Latitude 36.71562

Longitude -107.84857

(NAD 1927)

**Pit ID**

327071

**Pit Type**

Glycol Dehydrator

**Date Closure Started:** 4/4/03

**Date Closure Completed:** 4/4/03

**Closure Method:** Excavated, Blended, Treated Soil Returned

**Bedrock Encountered ?** ☐

**Cubic Yards Excavated:** 96

**Vertical Extent of Equipment Reached ?** ☒

**Description Of Closure Action:**

Contaminated soil was removed and treated then returned to the excavation following sampling of the walls and floor.

Vertical extent of excavation limited by equipment

**Pit Closure Sampling:**

Sample ID	Sample Date	Head Space	BTEX Total (mg/kg)	Benzene (mg/kg)	TPH DRO (mg/kg)	Purpose	Location	Depth	
112806AUG02	8/6/02		628	48	620	ASSESS		3	
122604APR03	4/4/03	1520	59.1	1	40	EX Confirm	Flr	12	See Risk Analysis
123104APR03	4/4/03	2.2	0.064	0	0	EX Confirm	Walls	12	

Lab Project Number: 6061563

Client Project ID: NM PIT ASSESSMENTS

Solid results are reported on a dry weight basis

Lab Sample No: 605337484  
Client Sample ID: 112806AUG02

Project Sample Number: 6061563-001  
Matrix: Soil

Date Collected: 08/06/02 11:28  
Date Received: 08/09/02 09:05

Parameters	Results	Units	Report Limit	DF	Analyzed	By	CAS No.	Qual	RegLmt
<b>GC Semivolatiles</b>									
Total Extractable Hydrocarbons	Prep/Method: OA2 / OA2								
Mineral Spirits	ND	mg/kg	11.		1.1 08/21/02 10:39 MIM				
Jet Fuel	ND	mg/kg	11.		1.1 08/21/02 10:39 MIM				
Kerosene	ND	mg/kg	11.		1.1 08/21/02 10:39 MIM				
Diesel Fuel	620	mg/kg	11.		1.1 08/21/02 10:39 MIM		68334-30-5	1	
Fuel Oil	ND	mg/kg	11.		1.1 08/21/02 10:39 MIM		68334-30-5		
Motor Oil	ND	mg/kg	11.		1.1 08/21/02 10:39 MIM				
n-Tetracosane (S)	109	%			1.0 08/21/02 10:39 MIM		646-31-1		
p-Terphenyl (S)	113	%			1.0 08/21/02 10:39 MIM		92-94-4		
Date Extracted					08/14/02				

#### Organics Prep

Percent Moisture	Method:								
Percent Moisture	13.6	%			1.0 08/15/02	JLC1			

#### GC Volatiles

Aromatic Volatile Organics	Prep/Method: EPA 5030 Medium Soil / EPA 8021								
Benzene	48000	ug/kg	4600		91.5 08/15/02 17:37		71-43-2		
Ethylbenzene	29000	ug/kg	4600		91.5 08/15/02 17:37		100-41-4		
Toluene	41000	ug/kg	4600		91.5 08/15/02 17:37		108-88-3		
Xylene (Total)	510000	ug/kg	12000		91.5 08/15/02 17:37		1330-20-7		
a,a,a-Trifluorotoluene (S)	103	%			1.0 08/15/02 17:37		98-08-8		

Comments : Elevated quantitation limits resulting from a dilution.

## REPORT OF LABORATORY ANALYSIS

This report shall not be reproduced, except in full,  
without the written consent of Pace Analytical Services, Inc.

Lab Project Number: 6069637  
Client Project ID: NM Pits

Lab Sample No: 606002277      Project Sample Number: 6069637-009      Date Collected: 04/04/03 12:26  
Client Sample ID: 122604APR03      Matrix: Soil      Date Received: 04/18/03 11:07

Parameters	Results	Units	Report Limit	DF	Analyzed	By	CAS No.	Qual	RegLmt
<b>GC Semivolatiles</b>									
Total Extractable Hydrocarbons	Prep/Method: OA2 / OA2								
Mineral Spirits	ND	mg/kg	11.	1.1	04/23/03 17:18	MIM			
Jet Fuel	ND	mg/kg	11.	1.1	04/23/03 17:18	MIM			
Kerosene	ND	mg/kg	11.	1.1	04/23/03 17:18	MIM			
Diesel Fuel	40.	mg/kg	11.	1.1	04/23/03 17:18	MIM	68334-30-5	2	
Fuel Oil	ND	mg/kg	11.	1.1	04/23/03 17:18	MIM	68334-30-5		
Motor Oil	ND	mg/kg	11.	1.1	04/23/03 17:18	MIM			
n-Tetracosane (S)	89	%		1.0	04/23/03 17:18	MIM	646-31-1		
p-Terphenyl (S)	81	%		1.0	04/23/03 17:18	MIM	92-94-4		
Date Extracted	04/21/03				04/21/03				

### Organics Prep

Percent Moisture	Method: SM 2540G								
Percent Moisture	5.4	%		1.0	04/22/03	MAM			

### GC Volatiles

Aromatic Volatile Organics	Prep/Method: EPA 5030 Medium Soil / EPA 8021								
Benzene	1000	ug/kg	390	7.8	04/24/03 15:44		71-43-2		
Ethylbenzene	2100	ug/kg	390	7.8	04/24/03 15:44		100-41-4		
Toluene	26000	ug/kg	390	7.8	04/24/03 15:44		108-88-3		
Xylene (Total)	30000	ug/kg	990	7.8	04/24/03 15:44		1330-20-7		
a,a,a-Trifluorotoluene (S)	108	%		1.0	04/24/03 15:44		98-08-8		

## REPORT OF LABORATORY ANALYSIS

This report shall not be reproduced, except in full,  
without the written consent of Pace Analytical Services, Inc.

Lab Project Number: 6069637  
Client Project ID: NM Pits

Lab Sample No: 606002285      Project Sample Number: 6069637-010      Date Collected: 04/04/03 12:31  
Client Sample ID: 123104APR03      Matrix: Soil      Date Received: 04/18/03 11:07

Parameters	Results	Units	Report Limit	DF	Analyzed	By	CAS No.	Qual	RegLmt
------------	---------	-------	--------------	----	----------	----	---------	------	--------

#### GC Semivolatiles

Total Extractable Hydrocarbons Prep/Method: OA2 / OA2

Mineral Spirits	ND	mg/kg	10.		1.0 04/23/03 17:47	MIM			
Jet Fuel	ND	mg/kg	10.		1.0 04/23/03 17:47	MIM			
Kerosene	ND	mg/kg	10.		1.0 04/23/03 17:47	MIM			
Diesel Fuel	ND	mg/kg	10.		1.0 04/23/03 17:47	MIM	68334-30-5		
Fuel Oil	ND	mg/kg	10.		1.0 04/23/03 17:47	MIM	68334-30-5		
Motor Oil	ND	mg/kg	10.		1.0 04/23/03 17:47	MIM			
n-Tetracosane (S)	81	%			1.0 04/23/03 17:47	MIM	646-31-1		
p-Terphenyl (S)	78	%			1.0 04/23/03 17:47	MIM	92-94-4		
Date Extracted	04/21/03				04/21/03				

#### Organics Prep

Percent Moisture Method: SM 2540G  
Percent Moisture 5.5 % 1.0 04/22/03 MAM

#### GC Volatiles

Aromatic Volatile Organics Prep/Method: EPA 5030 Medium Soil / EPA 8021

Benzene	ND	ug/kg	52.		1.1 04/24/03 16:13		71-43-2		
Ethylbenzene	ND	ug/kg	52.		1.1 04/24/03 16:13		100-41-4		
Toluene	64.	ug/kg	52.		1.1 04/24/03 16:13		108-88-3		
Xylene (Total)	ND	ug/kg	130		1.1 04/24/03 16:13		1330-20-7		
a,a,a-Trifluorotoluene (S)	98	%			1.0 04/24/03 16:13		98-08-8		

## REPORT OF LABORATORY ANALYSIS

This report shall not be reproduced, except in full,  
without the written consent of Pace Analytical Services, Inc.