

Submit 3 Copies To Appropriate District Office
 District I
 1625 N. French Dr., Hobbs, NM 88240
 District II
 1301 W. Grand Ave., Artesia, NM 88210
 District III
 1000 Rio Brazos Rd., Aztec, NM 87410
 District IV
 1220 S. St. Francis Dr., Santa Fe, NM 87505

State of New Mexico
 Energy, Minerals and Natural Resources

Form C-103
 May 27, 2004

OIL CONSERVATION DIVISION
 1220 South St. Francis Dr.
 Santa Fe, NM 87505

WELL API NO. 30-039-21270
5. Indicate Type of Lease STATE <input type="checkbox"/> FEE <input type="checkbox"/>
6. State Oil & Gas Lease No. Jicarilla Indian #412
7. Lease Name or Unit Agreement Name Chacon Jicarilla Apache "D"
8. Well Number No. 5
9. OGRID Number 006911
10. Pool name or Wildcat LINDRITH GALLUP-DAKOTA WEST

SUNDRY NOTICES AND REPORTS ON WELLS
 (DO NOT USE THIS FORM FOR PROPOSALS TO DRILL OR TO DEEPEN OR PLUG BACK TO A DIFFERENT RESERVOIR. USE "APPLICATION FOR PERMIT" (FORM C-101) FOR SUCH PROPOSALS.)

1. Type of Well: Oil Well Gas Well Other

2. Name of Operator
 Roddy Production Company, Inc.

3. Address of Operator
 P.O. Box 2221, Farmington, NM 87499

4. Well Location
 Unit Letter C : 330 feet from the NORTH line and 2310 feet from the WEST line
 Section 16 Township 23N Range 3W NMPM RIO ARRIBA County

11. Elevation (Show whether DR, RKB, RT, GR, etc.)
7359' GR, 7372' DF, 7373' KB

Pit or Below-grade Tank Application or Closure

Pit type cement circulation Depth to Groundwater 100' Distance from nearest fresh water well >1000' Distance from nearest surface water >1000'

Pit Liner Thickness: 12 mil Below-Grade Tank: Volume _____ bbls; Construction Material on-site materials

12. Check Appropriate Box to Indicate Nature of Notice, Report or Other Data

NOTICE OF INTENTION TO:

- PERFORM REMEDIAL WORK PLUG AND ABANDON
 TEMPORARILY ABANDON CHANGE PLANS
 PULL OR ALTER CASING MULTIPLE COMPL

OTHER: Construct earthen workover pit

SUBSEQUENT REPORT OF:

- REMEDIAL WORK ALTERING CASING
 COMMENCE DRILLING OPNS. P AND A
 CASING/CEMENT JOB

OTHER:

13. Describe proposed or completed operations. (Clearly state all pertinent details, and give pertinent dates, including estimated date of starting any proposed work). SEE RULE 1103. For Multiple Completions: Attach wellbore diagram of proposed completion or recompletion.

Roddy Production Company, Inc. intends to construct an earthen pit for workover operations on the above referenced well. The pit will be a lined earthen pit with the dimensions of 8' x 15' (see attached diagram). After the workover operations are completed, the pit will be closed per NMOCD guide lines. The anticipated workover start date is November 17, 2005. A diagram showing the location of the pit is attached.

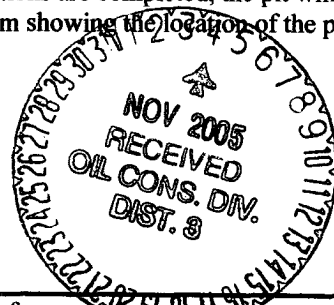

I hereby certify that the information above is true and complete to the best of my knowledge and belief. I further certify that any pit or below-grade tank has been/will be constructed or closed according to NMOCD guidelines , a general permit or an (attached) alternative OCD-approved plan .

SIGNATURE Robert R. Griffiee TITLE Operations Manager DATE 11-3-05

Type or print name Robert R. Griffiee E-mail address: bgriffieerpc@qwest.net Telephone No. (505) 326-6813

For State Use Only

APPROVED BY: W. Jerry Zent TITLE DEPUTY OIL & GAS INSPECTOR, DIST. 3 DATE NOV 04 2005
 Conditions of Approval (if any): _____

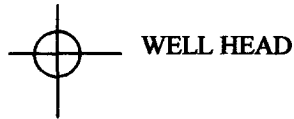
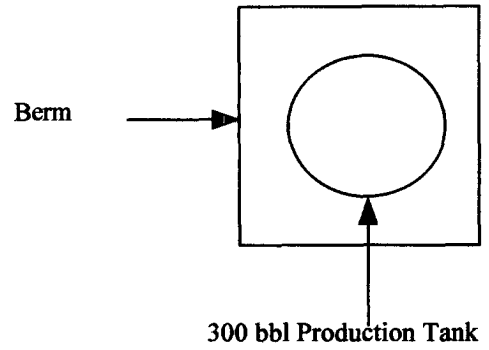
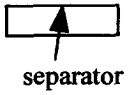

8' x 15' lined earthen pit



Roddy Production Company, Inc
2600 Farmington Ave., Suite B
Farmington, NM 87499
OFFICE: 9505) 326-6813
fax: (505) 326-6814

Prepared by: Donal Key
11-04-05

Pit Location Map
Chacon Jicarilla Apache "D" # 5
330' FNLx 2310' FWL
Section 16, T23N, R3W
Rio Arriba County, NM

MEXICO OIL CONSERVATION COMMISS
WELL LOCATION AND ACREAGE DEDICATION PLAT

Form C-102
Supersedes C-128
Effective 1-1-77

All distances must be from the outer boundaries of the Section.

Operator Dave M. Thomas Jr.		Lease Chacon Jicarilla Apache "D"			Well No. 5
Unit Letter C	Section 16	Township 23N	Range 3W	County Rio Arriba	
Actual Footage Location of Well: 330 feet from the North line and 2310 feet from the West line					
Ground Level Elev. 7359	Producing Formation Dakota		Pool Chacon Dakota		Dedicated Acreage Acres

1. Outline the acreage dedicated to the subject well by colored pencil or hachure marks on the plat below.
2. If more than one lease is dedicated to the well, outline each and identify the ownership thereof (both as to working interest and royalty).
3. If more than one lease of different ownership is dedicated to the well, have the interests of all owners been consolidated by communitization, unitization, force-pooling, etc?

Yes No If answer is "yes," type of consolidation _____

If answer is "no," list the owners and tract descriptions which have actually been consolidated. (Use reverse side of this form if necessary.) _____

No allowable will be assigned to the well until all interests have been consolidated (by communitization, unitization, forced-pooling, or otherwise) or until a non-standard unit, eliminating such interests, has been approved by the Commission.

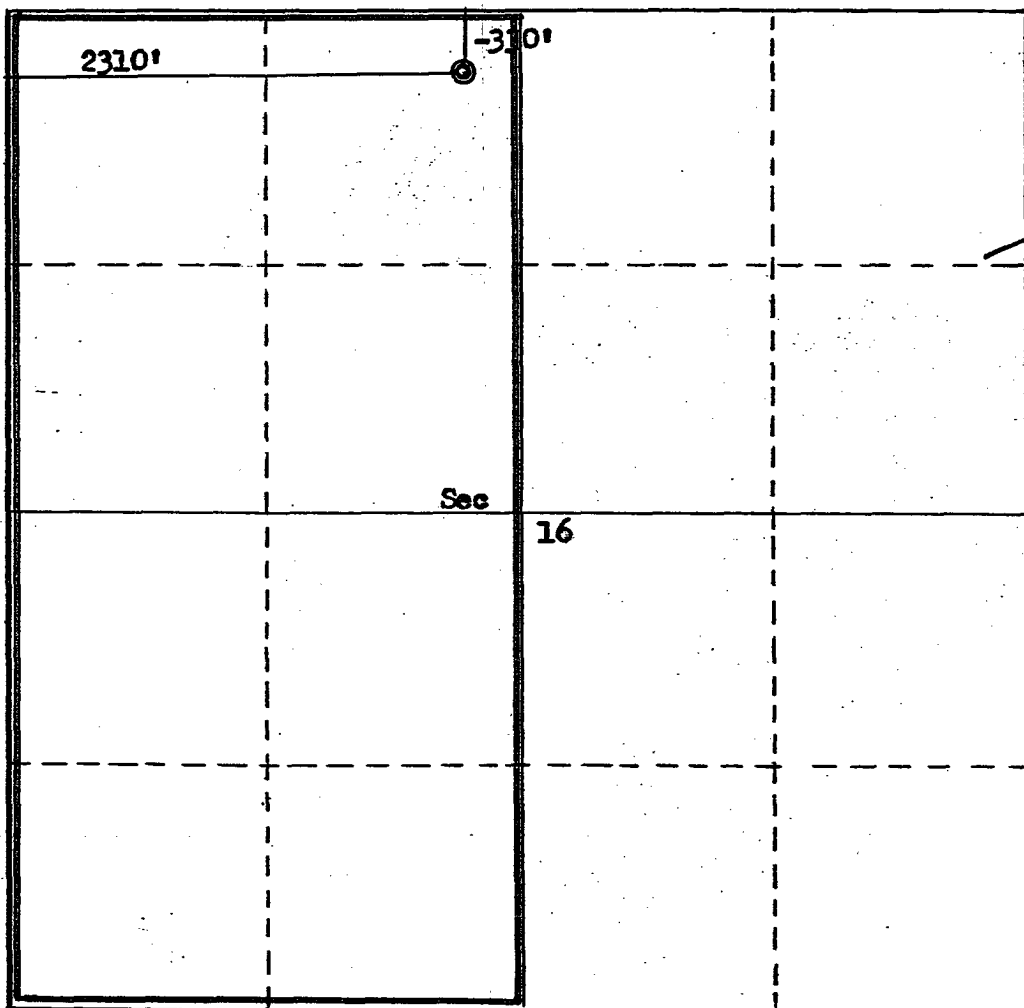

CERTIFICATION

I hereby certify that the information contained herein is true and complete to the best of my knowledge and belief.

For: **Dave M. Thomas Jr.**

Ewell N. Walsh, P.E.

Position

President, Walsh Engr.

Company

& Production Corporation

Date

February 13, 1978

I hereby certify that the well location shown on this plat was plotted from field notes of actual surveys made by me or under my supervision, and that the same is true and correct to the best of my knowledge and belief.

Date Surveyed

March 10, 1976

Registered Professional Engineer and/or Land Surveyor

Fred B. Kerr Jr.

Certificate No.

3950

