

District I  
1625 N. French Dr., Hobbs, NM 88240  
District II  
1301 W. Grand Avenue, Artesia, NM 88210  
District III  
1000 Rio Brazos Road, Aztec, NM 87410  
District IV  
1220 S. St. Francis Dr., Santa Fe, NM 87505

State of New Mexico  
Energy Minerals and Natural Resources

Form C-144  
June 1, 2004

Oil Conservation Division  
1220 South St. Francis Dr.  
Santa Fe, NM 87505

For drilling and production facilities, submit to appropriate NMOCD District Office.  
For downstream facilities, submit to Santa Fe office

**Pit or Below-Grade Tank Registration or Closure**

Is pit or below-grade tank covered by a "general plan"? Yes ☒ No ☐

Type of action: Registration of a pit or below-grade tank ☐ Closure of a pit or below-grade tank ☒

|                                                                                                                                                                                                                                                                                                                                                                                                               |                                                                                                                                                                                                      |             |
|---------------------------------------------------------------------------------------------------------------------------------------------------------------------------------------------------------------------------------------------------------------------------------------------------------------------------------------------------------------------------------------------------------------|------------------------------------------------------------------------------------------------------------------------------------------------------------------------------------------------------|-------------|
| Operator: <u>BP America Production Company</u> Telephone: <u>(505)326-9200</u> e-mail address: _____                                                                                                                                                                                                                                                                                                          |                                                                                                                                                                                                      |             |
| Address: <u>200 Energy Ct, Farmington, NM 87401</u>                                                                                                                                                                                                                                                                                                                                                           |                                                                                                                                                                                                      |             |
| Facility or well name: <u>SCHWEDTFEGER 8 #1A</u> API #: <u>3004522426</u> U/L or Qtr/Qtr <u>0</u> Sec <u>27</u> T <u>31</u> N R <u>9 W</u>                                                                                                                                                                                                                                                                    |                                                                                                                                                                                                      |             |
| County: <u>San Juan</u> Latitude _____ Longitude _____ NAD: 1927 <input type="checkbox"/> 1983 <input type="checkbox"/>                                                                                                                                                                                                                                                                                       |                                                                                                                                                                                                      |             |
| Surface Owner: Federal <input type="checkbox"/> State <input type="checkbox"/> Private <input type="checkbox"/> Indian <input type="checkbox"/>                                                                                                                                                                                                                                                               |                                                                                                                                                                                                      |             |
| <b>Pit</b><br>Type: Drilling <input type="checkbox"/> Production <input type="checkbox"/> Disposal <input checked="" type="checkbox"/><br>Workover <input type="checkbox"/> Emergency <input type="checkbox"/><br>Lined <input type="checkbox"/> Unlined <input type="checkbox"/><br>Liner type: Synthetic <input type="checkbox"/> Thickness _____ mil Clay <input type="checkbox"/><br>Pit Volume _____ bbl | <b>Below-grade tank</b><br>Volume: _____ bbl Type of fluid: _____<br>Construction material: _____<br>Double-walled, with leak detection? Yes <input type="checkbox"/> If not, explain why not: _____ |             |
| Depth to ground water (vertical distance from bottom of pit to seasonal high water elevation of ground water.)                                                                                                                                                                                                                                                                                                | Less than 50 feet                                                                                                                                                                                    | (20 points) |
|                                                                                                                                                                                                                                                                                                                                                                                                               | 50 feet or more, but less than 100 feet                                                                                                                                                              | (10 points) |
|                                                                                                                                                                                                                                                                                                                                                                                                               | 100 feet or more                                                                                                                                                                                     | ( 0 points) |
| Wellhead protection area: (Less than 200 feet from a private domestic water source, or less than 1000 feet from all other water sources.)                                                                                                                                                                                                                                                                     | Yes                                                                                                                                                                                                  | (20 points) |
|                                                                                                                                                                                                                                                                                                                                                                                                               | No                                                                                                                                                                                                   | ( 0 points) |
| Distance to surface water: (horizontal distance to all wetlands, playas, irrigation canals, ditches, and perennial and ephemeral watercourses.)                                                                                                                                                                                                                                                               | Less than 200 feet                                                                                                                                                                                   | (20 points) |
|                                                                                                                                                                                                                                                                                                                                                                                                               | 200 feet or more, but less than 1000 feet                                                                                                                                                            | (10 points) |
|                                                                                                                                                                                                                                                                                                                                                                                                               | 1000 feet or more                                                                                                                                                                                    | ( 0 points) |
| Ranking Score (Total Points)                                                                                                                                                                                                                                                                                                                                                                                  |                                                                                                                                                                                                      |             |

If this is a pit closure: (1) Attach a diagram of the facility showing the pit's relationship to other equipment and tanks. (2) Indicate disposal location: (check the onsite box if you are burying in place) onsite ☐ offsite ☐ If offsite, name of facility \_\_\_\_\_. (3) Attach a general description of remedial action taken including remediation start date and end date. (4) Groundwater encountered: No ☐ Yes ☐ If yes, show depth below ground surface \_\_\_\_\_ ft. and attach sample results.

(5) Attach soil sample results and a diagram of sample locations and excavations.

Additional Comments:

See Attached Documentation

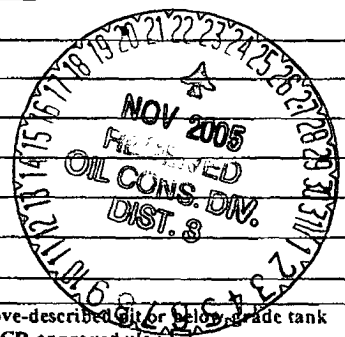

I hereby certify that the information above is true and complete to the best of my knowledge and belief. I further certify that the above-described pit or below-grade tank has been/will be constructed or closed according to NMOCD guidelines ☒, a general permit ☐, or an (attached) alternative OCD-approved plan ☐.

Date: 11/01/2005

Printed Name/Title Jeffrey C. Blagg, Agent

Signature Jeffrey C. Blagg

Your certification and NMOCD approval of this application/closure does not relieve the operator of liability should the contents of the pit or tank contaminate ground water or otherwise endanger public health or the environment. Nor does it relieve the operator of its responsibility for compliance with any other federal, state, or local laws and/or regulations.

Approval: **DEPUTY OIL & GAS INSPECTOR, DIST. 8**

Printed Name/Title \_\_\_\_\_

Signature Denny R. [Signature]

Date: NOV 23 2005

District I  
P.O. Box 1980, Hobbs, NM  
District II  
P.O. Drawer DD, Artesia, NM 88211  
District III  
1000 Rio Brazos Rd, Aztec, NM 87410

State of New Mexico  
Energy, Minerals and Natural Resources Department

OIL CONSERVATION DIVISION  
P.O. Box 2088  
Santa Fe, New Mexico 87504-2088

SUBMIT 1 COPY TO  
APPROPRIATE  
DISTRICT OFFICE  
AND 1 COPY TO  
SANTA FE OFFICE

## PIT REMEDIATION AND CLOSURE REPORT

Operator: Amoco Production Company Telephone: (505) - 326-9200  
Address: 200 Amoco Court, Farmington, New Mexico 87401  
Facility Or: SCHWERTFEGER B # 1A  
Well Name \_\_\_\_\_  
Location: Unit or Qtr/Qtr Sec 0 Sec 27 T31N R 9W County SAN JUAN  
Pit Type: <sup>ABANDONED</sup> Separator ☒ / <sup>ABANDONED</sup> Dehydrator ☒ Other \_\_\_\_\_  
Land Type: BLM ☒, State \_\_\_\_\_, Fee \_\_\_\_\_, Other \_\_\_\_\_

Pit Location: Pit dimensions: length 27', width 30', depth 15'  
(Attach diagram) Reference: wellhead ☒, other \_\_\_\_\_  
Footage from reference: 54'  
Direction from reference: 52 Degrees East North ☒  
of  
☒ West South \_\_\_\_\_

Depth To Ground Water: Less than 50 feet (20 points)  
(Vertical distance from 50 feet to 99 feet (10 points)  
contaminants to seasonal Greater than 100 feet (0 Points) 0  
high water elevation of  
ground water)

Wellhead Protection Area: Yes (20 points)  
(Less than 200 feet from a private No (0 points) 0  
domestic water source, or; less than  
1000 feet from all other water sources)

Distance To Surface Water: Less than 200 feet (20 points)  
(Horizontal distance to perennial 200 feet to 1000 feet (10 points)  
lakes, ponds, rivers, streams, creeks, Greater than 1000 feet (0 points) 0  
irrigation canals and ditches)

RANKING SCORE (TOTAL POINTS): 0

80822 ABAN. SEP/DEHY

Date Remediation Started: \_\_\_\_\_ Date Completed: 12/13/00

Remediation Method: Excavation ☒ Approx. cubic yards 400  
 (Check all appropriate sections) Landfarmed ☒ Insitu Bioremediation \_\_\_\_\_  
 Other \_\_\_\_\_

Remediation Location: Onsite \_\_\_\_\_ Offsite ☒ PRITCHARD #5 (B-34-31-9)  
 (ie. landfarmed onsite, name and location of offsite facility)

General Description Of Remedial Action: \_\_\_\_\_

Excavation .

Ground Water Encountered: No ☒ Yes \_\_\_\_\_ Depth \_\_\_\_\_

Final Pit: Sample location see Attached Documents

Closure Sampling:  
 (if multiple samples, attach sample results and diagram of sample locations and depths)  
 Sample depth 16' (PTT Bottom)  
 Sample date 12/12/00 Sample time 1130

Sample Results

Benzene(ppm) 0.0177

Total BTEX(ppm) 4.990

Field headspace(ppm) 114.1

TPH 325 ppm

Ground Water Sample: Yes \_\_\_\_\_ No ☒ (If yes, attach sample results)

I HEREBY CERTIFY THAT THE INFORMATION ABOVE IS TRUE AND COMPLETE TO THE BEST OF MY KNOWLEDGE AND BELIEF

DATE 12/13/00

SIGNATURE

*Buddy D. Shaw*

PRINTED NAME  
AND TITLE

*Buddy D. Shaw*  
Environmental Coordinator

3004522426

|                      |                                                                                |                                                  |
|----------------------|--------------------------------------------------------------------------------|--------------------------------------------------|
| CLIENT: <u>AMOCO</u> | BLAGG ENGINEERING, INC.<br>P.O. BOX 87, BLOOMFIELD, NM 87413<br>(505) 632-1199 | LOCATION NO: <u>B0822</u><br>CDD NO: <u>8264</u> |
|----------------------|--------------------------------------------------------------------------------|--------------------------------------------------|

## FIELD REPORT: CLOSURE VERIFICATION

PAGE No: 1 of 1

|                                                                                                               |                                     |
|---------------------------------------------------------------------------------------------------------------|-------------------------------------|
| LOCATION: NAME: <u>SCHWERTFEGER</u> <u>8</u> WELL #: <u>1A</u> PIT: <u>ABAND. SEP/OEHY</u>                    | DATE STARTED: <u>12/12/00</u>       |
| QUAD/UNIT: <u>0</u> SEC: <u>27</u> TWP: <u>31N</u> RNG: <u>9W</u> PM: <u>NM</u> CNTY: <u>ST</u> ST: <u>NM</u> | DATE FINISHED: _____                |
| QTR/FOOTAGE: <u>850'S</u> <u>1850'E</u> SWSE CONTRACTOR: <u>FLINT</u>                                         | ENVIRONMENTAL SPECIALIST: <u>NU</u> |

EXCAVATION APPROX. 27 FT. x 30 FT. x 15 FT. DEEP. CUBIC YARDAGE 400

DISPOSAL FACILITY: PRITCHARD #5 B-34-31-9 REMEDIATION METHOD: LANDFARMED

LAND USE: RANGE LEASE: NM 013685 FORMATION: MV

|                                                                                                             |                                                                                                                                                                       |
|-------------------------------------------------------------------------------------------------------------|-----------------------------------------------------------------------------------------------------------------------------------------------------------------------|
| FIELD NOTES & REMARKS: PIT LOCATED APPROXIMATELY <u>54</u> FT. <u>N52W</u> FROM WELL HEAD                   |                                                                                                                                                                       |
| DEPTH TO GROUNDWATER: <u>2100'</u> NEAREST WATER SOURCE: <u>21000'</u> NEAREST SURFACE WATER: <u>21000'</u> |                                                                                                                                                                       |
| NMOCB RANKING SCORE: <u>0</u> NMOCB TPH CLOSURE STD: <u>5000</u> PPM                                        | CHECK ONE<br><input checked="" type="checkbox"/> PIT ABANDONED<br><input type="checkbox"/> STEEL TANK INSTALLED<br><input type="checkbox"/> FIBERGLASS TANK INSTALLED |
| SOIL AND EXCAVATION DESCRIPTION:                                                                            | OVM CALIB. READ: <u>51.2</u> ppm<br>TIME: <u>0850</u> <u>QD</u> /pm <u>12/12/00</u>                                                                                   |

SIDEWALLS MOSTLY DR. YELL. ORANGE SAND, PIT BOTTOM MED. GRAY SAND, NON COHESIVE, SLIGHTLY MOIST, LOOSE TO FIRM, VERY SMALL ISOLATED PATCHES OF STAINING/DISCOLORATION OBSERVED MAINLY ON THE SOUTH SIDEWALL & SW CORNER, HC 000R DETECTED IN PIT BOTTOM OVM SAMPLE ONLY.

CLOSED

## FIELD 418.1 CALCULATIONS

| TIME | SAMPLE I.D. | LAB No: | WEIGHT (g) | mL. FREON | DILUTION | READING | CALC. ppm |
|------|-------------|---------|------------|-----------|----------|---------|-----------|
| 1130 |             |         |            |           |          |         |           |
|      |             |         |            |           |          |         |           |
|      |             |         |            |           |          |         |           |

SCALE



0 FT

PIT PERIMETER

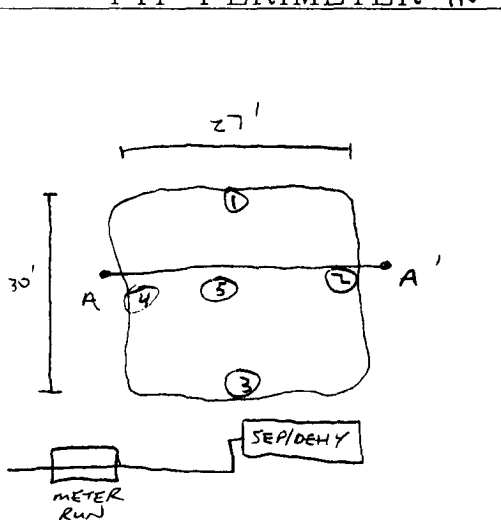

## OVM RESULTS

| SAMPLE ID | FIELD HEADSPACE PID (ppm) |
|-----------|---------------------------|
| 1 @ 8'    | 16.1                      |
| 2 @ 8'    | 0.0                       |
| 3 @ 8'    | 2.9                       |
| 4 @ 9'    | 0.0                       |
| 5 @ 12'   | 114.1                     |

## LAB SAMPLES

| SAMPLE ID   | ANALYSIS    | TIME |
|-------------|-------------|------|
| 5 @ 12'     | TPH (8015)  | 1130 |
| "           | BTEX (8020) | "    |
| BOTH PASSED |             |      |

PIT PROFILE

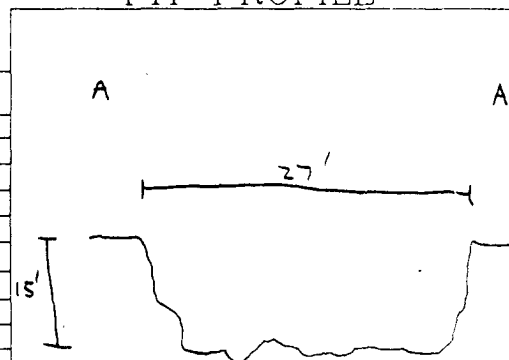

TRAVEL NOTES:

CALLOUT: 12/12/00 - MORN.ONSITE: 12/12/00 - MORN.

# ENVIROTECH LABS

PRACTICAL SOLUTIONS FOR A BETTER TOMORROW

## EPA METHOD 8015 Modified Nonhalogenated Volatile Organics Total Petroleum Hydrocarbons

|                      |                 |                     |          |
|----------------------|-----------------|---------------------|----------|
| Client:              | Blagg / BP      | Project #:          | 403410   |
| Sample ID:           | 5 @ 16'         | Date Reported:      | 12-13-00 |
| Laboratory Number:   | 18990           | Date Sampled:       | 12-12-00 |
| Chain of Custody No: | 8264            | Date Received:      | 12-12-00 |
| Sample Matrix:       | Soil            | Date Extracted:     | 12-13-00 |
| Preservative:        | Cool            | Date Analyzed:      | 12-13-00 |
| Condition:           | Cool and Intact | Analysis Requested: | 8015 TPH |

| Parameter                    | Concentration<br>(mg/Kg) | Det.<br>Limit<br>(mg/Kg) |
|------------------------------|--------------------------|--------------------------|
| Gasoline Range (C5 - C10)    | 149                      | 0.2                      |
| Diesel Range (C10 - C28)     | 176                      | 0.1                      |
| Total Petroleum Hydrocarbons | 325                      | 0.1                      |

ND - Parameter not detected at the stated detection limit.

References: Method 8015B, Nonhalogenated Volatile Organics, Test Methods for Evaluating Solid Waste, SW-846, USEPA, December 1996.

Comments: **Schwerdtfeger B #2A Abandoned Separator / Dehydrator Pit.**

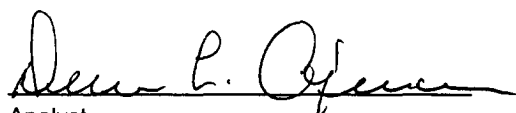
  
Analyst

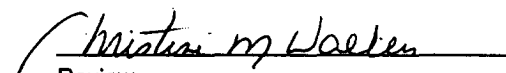
  
Review

# ENVIROTECH LABS

PRACTICAL SOLUTIONS FOR A BETTER TOMORROW

## EPA METHOD 8021 AROMATIC VOLATILE ORGANICS

|                    |               |                     |          |
|--------------------|---------------|---------------------|----------|
| Client:            | Blagg / BP    | Project #:          | 403410   |
| Sample ID:         | 5 @ 16'       | Date Reported:      | 12-13-00 |
| Laboratory Number: | 18990         | Date Sampled:       | 12-12-00 |
| Chain of Custody:  | 8264          | Date Received:      | 12-12-00 |
| Sample Matrix:     | Soil          | Date Analyzed:      | 12-13-00 |
| Preservative:      | Cool          | Date Extracted:     | 12-13-00 |
| Condition:         | Cool & Intact | Analysis Requested: | BTEX     |

| Parameter    | Concentration<br>(ug/Kg) | Det.<br>Limit<br>(ug/Kg) |
|--------------|--------------------------|--------------------------|
| Benzene      | 17.7                     | 1.8                      |
| Toluene      | 844                      | 1.7                      |
| Ethylbenzene | 631                      | 1.5                      |
| p,m-Xylene   | 2,380                    | 2.2                      |
| o-Xylene     | 1,120                    | 1.0                      |
| Total BTEX   | 4,990                    |                          |

ND - Parameter not detected at the stated detection limit.

| Surrogate Recoveries: | Parameter          | Percent Recovery |
|-----------------------|--------------------|------------------|
|                       | Trifluorotoluene   | 100 %            |
|                       | Bromofluorobenzene | 100 %            |

References: Method 5030B, Purge-and-Trap, Test Methods for Evaluating Solid Waste, SW-846, USEPA, December 1996.

Method 8021B, Aromatic Volatile Organics, Test Methods for Evaluating Solid Waste, SW-846, USEPA, December 1996.

Comments: **Schwerdtfeger B # 2A Abandoned Separator / Dehydrator Pit.**

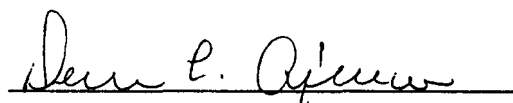
  
Analyst

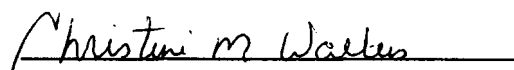
  
Review

|                   |                                                                                |                                                |
|-------------------|--------------------------------------------------------------------------------|------------------------------------------------|
| CLIENT: <u>BP</u> | BLAGG ENGINEERING, INC.<br>P.O. BOX 87, BLOOMFIELD, NM 87413<br>(505) 632-1199 | LOCATION NO <u>80279</u><br>COC NO <u>9729</u> |
|-------------------|--------------------------------------------------------------------------------|------------------------------------------------|

## FIELD REPORT: LANDFARM/COMPOST PILE CLOSURE VERIFICATION

|                                              |                          |                                    |                             |
|----------------------------------------------|--------------------------|------------------------------------|-----------------------------|
| LOCATION: NAME: <u>PRITCHARD</u>             | WELL #: <u>5</u>         | PITS: <u>DEMY</u>                  | DATE STARTED <u>2/26/02</u> |
| QUAD/UNIT: <u>8 SEC: 34 TWP: 31N RNG: 9W</u> | PM: <u>NM CNTY: SJ</u>   | ST: <u>NM</u>                      | DATE FINISHED _____         |
| QTR/FOOTAGE: <u>NW 1/4</u>                   | CONTRACTOR: <u>FLIST</u> | ENVIRONMENTAL SPECIALIST <u>NV</u> |                             |

### SOIL REMEDIATION:

REMEDICATION SYSTEM: LANDFARM

APPROX. CUBIC YARDAGE: 430

LAND USE: RANGE - BLM

LIFT DEPTH (ft): 1-1.5

### FIELD NOTES & REMARKS:

NMOCB RANKING SCORE: 0 NMOCB TPH CLOSURE STD: 100 ppm

DEPTH TO GROUNDWATER: <50' NEAREST WATER SOURCE: >1000' NEAREST SURFACE WATER: <1000'

SOIL TYPE: (SAND) / SILTY SAND / SILT / SILTY CLAY / CLAY / GRAVEL / OTHER \_\_\_\_\_  
SOIL COLOR: OK. YELL. ORANGE TO DK. YELL.

COHESION (ALL OTHERS): (NON COHESIVE) / SLIGHTLY COHESIVE / COHESIVE / HIGHLY COHESIVE

CONSISTENCY (NON COHESIVE SOILS): (LOOSE) / (FIRM) / DENSE / VERY DENSE

PLASTICITY (CLAYS): NON PLASTIC / SLIGHTLY PLASTIC / COHESIVE / MEDIUM PLASTIC / HIGHLY PLASTIC

DENSITY (COHESIVE CLAYS & SILTS): SOFT / FIRM / STIFF / VERY STIFF / HARD

MOISTURE: DRY / (SLIGHTLY MOIST) / MOIST / WET / SATURATED / SUPER SATURATED

DISCOLORATION/STAINING OBSERVED: (YES) / NO EXPLANATION - SURFACE STAINING (SEE SKETCH)

HC ODOR DETECTED: YES / (NO) EXPLANATION - \_\_\_\_\_

SAMPLING DEPTHS (LANDFARMS): 8-15 (INCHES)

SAMPLE TYPE: GRAB / (COMPOSITE) - # OF PTS. 5

ADDITIONAL COMMENTS: 400 C.Y. DEPOSITED FROM SCHWARTZFEGER & BIA (0-27-31-9), AFTER SAMPLING MATERIAL WAS THEN MOVED BACK TO SCHWARTZ & BIA (STANDARD 5,000 ppm)

### FIELD 418.1 CALCULATIONS

| SAMP. TIME | SAMPLE I.D. | LAB No. | WEIGHT (g) | mL. FREON | DILUTION | READING | CALC. ppm |
|------------|-------------|---------|------------|-----------|----------|---------|-----------|
|            |             |         |            |           |          |         |           |
|            |             |         |            |           |          |         |           |
|            |             |         |            |           |          |         |           |

### SKETCH/SAMPLE LOCATIONS

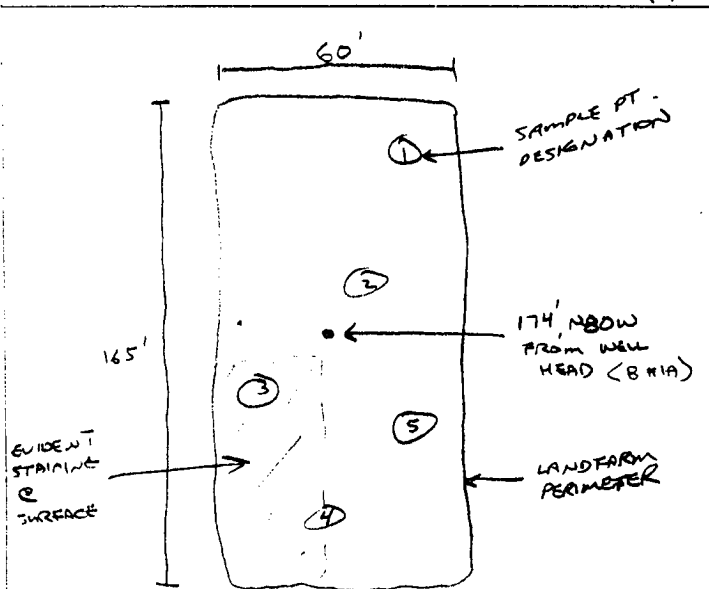

OVM CALIB. READ. 52.3 ppm  
OVM CALIB. GAS = 100 ppm; RF = 0.52  
TIME: 9:05 am DATE: 2/26/02

### OVM RESULTS

### LAB SAMPLES

| SAMPLE ID | FIELD HEADSPACE PID (ppm) | SAMPLE ID | ANALYSIS    | TIME | RESULTS |
|-----------|---------------------------|-----------|-------------|------|---------|
| LF-1      | 1.1                       | LF-1      | TPH (20158) | 1230 | 2,180   |
|           |                           |           |             |      |         |
|           |                           |           |             |      |         |
|           |                           |           |             |      |         |
|           |                           |           |             |      |         |
|           |                           |           |             |      |         |

### SCALE



0 FT

TRAVEL NOTES: CALLOUT: N/A

ONSITE: 2/26/02

revised: 07/16/01

bei1006A.skd

# ENVIROTECH LABS

PRACTICAL SOLUTIONS FOR A BETTER TOMORROW

## EPA METHOD 8015 Modified Nonhalogenated Volatile Organics Total Petroleum Hydrocarbons

|                      |                 |                     |           |
|----------------------|-----------------|---------------------|-----------|
| Client:              | Blagg / BP      | Project #:          | 94034-010 |
| Sample ID:           | LF-1            | Date Reported:      | 02-27-02  |
| Laboratory Number:   | 22104           | Date Sampled:       | 02-26-02  |
| Chain of Custody No: | 9729            | Date Received:      | 02-27-02  |
| Sample Matrix:       | Soil            | Date Extracted:     | 02-27-02  |
| Preservative:        | Cool            | Date Analyzed:      | 02-27-02  |
| Condition:           | Cool and Intact | Analysis Requested: | 8015 TPH  |

| Parameter                    | Concentration<br>(mg/Kg) | Det.<br>Limit<br>(mg/Kg) |
|------------------------------|--------------------------|--------------------------|
| Gasoline Range (C5 - C10)    | 7.1                      | 0.2                      |
| Diesel Range (C10 - C28)     | 2,170                    | 0.1                      |
| Total Petroleum Hydrocarbons | 2,180                    | 0.2                      |

ND - Parameter not detected at the stated detection limit.

References: Method 8015B, Nonhalogenated Volatile Organics, Test Methods for Evaluating Solid Waste, SW-846, USEPA, December 1996.

Comments: Pritchard #5 Landfarm 5 Pt. Composite.

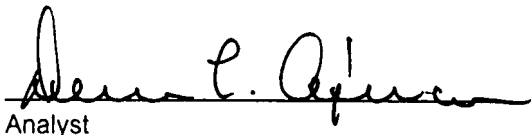
  
Analyst

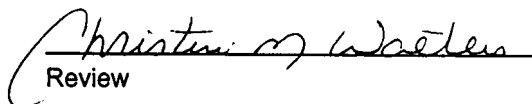
  
Review