

District I  
1625 N. French Dr., Hobbs, NM 88240  
District II  
1301 W. Grand Avenue, Artesia, NM 88210  
District III  
1000 Rio Brazos Road, Aztec, NM 87410  
District IV  
1220 S. St. Francis Dr., Santa Fe, NM 87505

State of New Mexico  
Energy Minerals and Natural Resources

Form C-144  
June 1, 2004

Oil Conservation Division  
1220 South St. Francis Dr.  
Santa Fe, NM 87505

For drilling and production facilities, submit to appropriate NMOCD District Office.  
For downstream facilities, submit to Santa Fe office

**Pit or Below-Grade Tank Registration or Closure**

Is pit or below-grade tank covered by a "general plan"? Yes ☒ No ☐

Type of action: Registration of a pit or below-grade tank ☐ Closure of a pit or below-grade tank ☒

Operator: BP America Production Company Telephone: (505)326-9200 e-mail address: \_\_\_\_\_  
Address: 200 Energy Ct, Farmington, NM 87401  
Facility or well name: GCU # 186E API #: 3004525203 U/L or Qtr/Qtr N Sec 33 T8N R12W  
County: San Juan Latitude \_\_\_\_\_ Longitude \_\_\_\_\_ NAD: 1927 ☐ 1983 ☐  
Surface Owner: Federal ☐ State ☐ Private ☐ Indian ☐

**Pit**

Type: Drilling ☐ Production ☐ Disposal ☒

Workover ☐ Emergency ☐

Lined ☐ Unlined ☐

Liner type: Synthetic ☐ Thickness \_\_\_\_\_ mil Clay ☐

Pit Volume \_\_\_\_\_ bbl

**Below-grade tank**

Volume: \_\_\_\_\_ bbl Type of fluid: \_\_\_\_\_

Construction material: \_\_\_\_\_

Double-walled, with leak detection? Yes ☐ If not, explain why not. \_\_\_\_\_

Depth to ground water (vertical distance from bottom of pit to seasonal high water elevation of ground water.)

Less than 50 feet (20 points)  
50 feet or more, but less than 100 feet (10 points)  
100 feet or more (0 points)

Wellhead protection area: (Less than 200 feet from a private domestic water source, or less than 1000 feet from all other water sources.)

Yes (20 points)  
No (0 points)

Distance to surface water: (horizontal distance to all wetlands, playas, irrigation canals, ditches, and perennial and ephemeral watercourses.)

Less than 200 feet (20 points)  
200 feet or more, but less than 1000 feet (10 points)  
1000 feet or more (0 points)

**Ranking Score (Total Points)**

If this is a pit closure: (1) Attach a diagram of the facility showing the pit's relationship to other equipment and tanks. (2) Indicate disposal location: (check the onsite box if you are burying in place) onsite ☐ offsite ☐ If offsite, name of facility \_\_\_\_\_. (3) Attach a general description of remedial action taken including remediation start date and end date. (4) Groundwater encountered: No ☐ Yes ☐ If yes show depth below ground surface \_\_\_\_\_ ft. and attach sample results. (5) Attach soil sample results and a diagram of sample locations and excavations.

Additional Comments:

See Attached Documentation

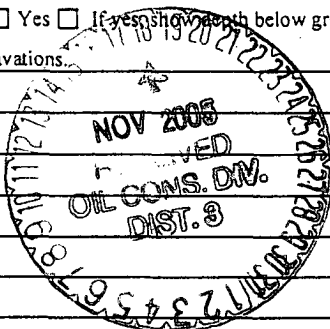

2nd pit

I hereby certify that the information above is true and complete to the best of my knowledge and belief. I further certify that the above-described pit or below-grade tank has been/will be constructed or closed according to NMOCD guidelines ☒, a general permit ☐, or an (attached) alternative OCD-approved plan ☐.

Date: 11/01/2005

Printed Name/Title Jeffrey C. Blagg, Agent

Signature Jeffrey C. Blagg

Your certification and NMOCD approval of this application/closure does not relieve the operator of liability should the contents of the pit or tank contaminate ground water or otherwise endanger public health or the environment. Nor does it relieve the operator of its responsibility for compliance with any other federal, state, or local laws and/or regulations.

Approval:

Printed Name/Title \_\_\_\_\_

Signature Jeffrey C. Blagg

Date: \_\_\_\_\_

District I  
P.O. Box 1980, Hobbs, NM  
District II  
P.O. Drawer DD, Artesia, NM 88211  
District III  
1000 Rio Brazos Rd, Aztec, NM 87410

State of New Mexico  
Energy, Minerals and Natural Resources Department

OIL CONSERVATION DIVISION  
P.O. Box 2088  
Santa Fe, New Mexico 87504-2088

SUBMIT 1 COPY TO  
APPROPRIATE  
DISTRICT OFFICE  
AND 1 COPY TO  
SANTA FE OFFICE

## PIT REMEDIATION AND CLOSURE REPORT

Operator: Amoco Production Company Telephone: (505) - 326-9200  
Address: 200 Amoco Court, Farmington, New Mexico 87401  
Facility Or: GC #186E  
Well Name \_\_\_\_\_  
Location: Unit or Qtr/Qtr Sec N Sec 33 T 28N R 12W County SAN JUAN  
Pit Type: Separator ABANDONED Dehydrator ☒ Other \_\_\_\_\_  
Land Type: BLM ☒, State \_\_\_\_\_, Fee \_\_\_\_\_, Other \_\_\_\_\_

Pit Location: Pit dimensions: length 15', width 14', depth 8'  
(attach diagram) Reference: wellhead ☒, other \_\_\_\_\_  
Footage from reference: 138'  
Direction from reference: 34 Degrees ☒ East North \_\_\_\_\_  
of \_\_\_\_\_ West South ☒

Depth To Ground Water: Less than 50 feet (20 points)  
(Vertical distance from 50 feet to 99 feet (10 points)  
contaminants to seasonal Greater than 100 feet (0 Points) 0  
high water elevation of  
ground water)

Wellhead Protection Area: Yes (20 points)  
(Less than 200 feet from a private No (0 points) 0  
domestic water source, or; less than  
1000 feet from all other water sources)

Distance To Surface Water: Less than 200 feet (20 points)  
(Horizontal distance to perennial 200 feet to 1000 feet (10 points)  
lakes, ponds, rivers, streams, creeks, Greater than 1000 feet (0 points) 0  
irrigation canals and ditches)

RANKING SCORE (TOTAL POINTS): 0

Date Remediation Started: \_\_\_\_\_ Date Completed: 4/1/00

Remediation Method: Excavation ☒ Approx. cubic yards 50  
 (Check all appropriate sections) Landfarmed ☒ Insitu Bioremediation \_\_\_\_\_  
 Other \_\_\_\_\_

Remediation Location: Onsite ☒ Offsite \_\_\_\_\_  
 (ie. landfarmed onsite, name and location of offsite facility)

General Description Of Remedial Action: \_\_\_\_\_

Excavation, RISK ASSESSED

Ground Water Encountered: No ☒ Yes \_\_\_\_\_ Depth \_\_\_\_\_

Final Pit: Sample location see Attached Documents

Closure Sampling: (if multiple samples, attach sample results and diagram of sample locations and depths)

Sample depth 9' (PIT BOTTOM)

Sample date 3/17/00 Sample time 0905

#### Sample Results

Benzene(ppm) ND

Total BTEX(ppm) 935

Field headspace(ppm) 77.2

TPH 7750 ppm

Ground Water Sample: Yes \_\_\_\_\_ No ☒ (If yes, attach sample results)

I HEREBY CERTIFY THAT THE INFORMATION ABOVE IS TRUE AND COMPLETE TO THE BEST OF MY KNOWLEDGE AND BELIEF

DATE 4/1/00  
 SIGNATURE B. Shaw PRINTED NAME AND TITLE Buddy D. Shaw  
ENVIRONMENTAL COORDINATOR

3004525203

CLIENT: <u>AMOCO</u>	BLAGG ENGINEERING, INC. P.O. BOX 87, BLOOMFIELD, NM 87413 (505) 632-1199	LOCATION NO: <u>85724</u> C.O.C. NO: <u>10371</u>
----------------------	--	--

## FIELD REPORT: CLOSURE VERIFICATION

PAGE No: 1 of 1

LOCATION: NAME: <u>GCU</u>	WELL #: <u>186E</u>	PIT: <u>ABAND. DEHY</u>	DATE STARTED: <u>3/17/00</u>
QUAD/UNIT: <u>N</u> SEC: <u>33</u> TWP: <u>28N</u> RNG: <u>12W</u> PM: <u>NM</u> CNTY: <u>ST. NM</u>			DATE FINISHED: _____
QTR/FOOTAGE: <u>1250' FSL / 1860' FWL</u>	CONTRACTOR: <u>FLINT</u>		ENVIRONMENTAL SPECIALIST: <u>NV</u>

EXCAVATION APPROX. 15 FT. x 14 FT. x 8 FT. DEEP. CUBIC YARDAGE: 50

DISPOSAL FACILITY: ON-SITE REMEDIATION METHOD: LANDFARM

LAND USE: NAPL (AGRIC.) LEASE: 892000844F FORMATION: OK

FIELD NOTES & REMARKS:	PIT LOCATED APPROXIMATELY <u>138</u> FT. <u>534E</u> FROM WELLHEAD.		
DEPTH TO GROUNDWATER: <u>&gt;100'</u>	NEAREST WATER SOURCE: <u>&gt;1000'</u>	NEAREST SURFACE WATER: <u>&gt;1000'</u>	
NMOC D RANKING SCORE: <u>0</u>	NMOC D TPH CLOSURE STD: <u>5000</u> PPM	CHECK ONE:	
SOIL AND EXCAVATION DESCRIPTION:	OVM CALIB. READ. <u>52.5</u> ppm	<input checked="" type="checkbox"/> PIT ABANDONED	
	TIME: <u>8:54</u> am/pm	<input type="checkbox"/> STEEL TANK INSTALLED	
		<input type="checkbox"/> FIBERGLASS TANK INSTALLED	

mod. TO OK. YEL. BROWN SAND, NON COHESIVE, SLIGHTLY MOIST, FIRM, NO APPARENT DISCOLORATION OBSERVED, STRONG HC ODOR DETECTED IN PIT BOTTOM OVM SAMPLE ONLY.

RISK ASSESSED

## FIELD 418.1 CALCULATIONS

TIME	SAMPLE I.D.	LAB No:	WEIGHT (g)	mL. FREON	DILUTION	READING	CALC. ppm

SCALE



0 FT

PIT PERIMETER

PIT PROFILE

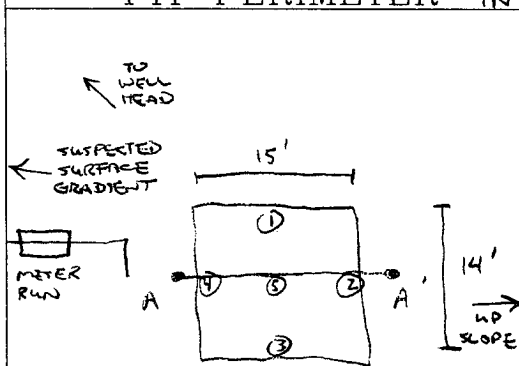

## OVM RESULTS

SAMPLE ID	FIELD HEADSPACE PID (ppm)
1 @ 5'	2.1
2 @ 4'	0.0
3 @ 4'	0.0
4 @ 5'	0.0
5 @ 9'	772

## LAB SAMPLES

SAMPLE ID	ANALYSIS	TIME
⑥ @ 9'	TPH (8015)	0905
"	BTEX (8021)	"

TRAVEL NOTES:

CALLOUT: 3/16/00 - AFTER.ONSITE: 3/17/00 - MORN.

OFF: (505) 325-5667



LAB: (505) 325-1556

# ANALYTICAL REPORT

Date: 29-Mar-00

<b>Client:</b>	Blagg Engineering	<b>Client Sample Info:</b>	GCU 186E Dehy Pit
<b>Work Order:</b>	0003030	<b>Client Sample ID:</b>	Sample @ 9 ft
<b>Lab ID:</b>	0003030-01A	<b>Matrix:</b>	SOIL
<b>Project:</b>	BP Amoco; GCU 186E Abnd. Dehy Pit	<b>Collection Date:</b>	3/17/2000 9:05:00 AM
		<b>COC Record:</b>	10371

Parameter	Result	PQL	Qual	Units	DF	Date Analyzed
<b>DIESEL RANGE ORGANICS</b>		<b>SW8015B</b>				Analyst: DM
T/R Hydrocarbons: C10-C28	930	25		mg/Kg	1	3/24/2000
<b>GASOLINE RANGE ORGANICS</b>		<b>SW8015B</b>				Analyst: DM
T/R Hydrocarbons: C6-C10	6820	450		mg/Kg	2500	3/20/2000
<b>AROMATIC VOLATILES BY GC/PID</b>		<b>SW8021B</b>				Analyst: DM
Benzene	ND	2500		µg/Kg	2500	3/21/2000
Toluene	42000	5000		µg/Kg	2500	3/21/2000
Ethylbenzene	13000	2500		µg/Kg	2500	3/21/2000
m,p-Xylene	720000	5000		µg/Kg	2500	3/21/2000
o-Xylene	160000	2500		µg/Kg	2500	3/21/2000

**Qualifiers:**

PQL - Practical Quantitation Limit

S - Spike Recovery outside accepted recovery limits

ND - Not Detected at Practical Quantitation Limit

R - RPD outside accepted recovery limits

J - Analyte detected below Practical Quantitation Limit

E - Value above quantitation range

B - Analyte detected in the associated Method Blank

Surr: - Surrogate

1 of 1

P.O. BOX 2606 • FARMINGTON, NM 87499

- TECHNOLOGY BLENDING INDUSTRY WITH THE ENVIRONMENT -

UNITED STATES  
DEPARTMENT OF THE INTERIOR  
BUREAU OF LAND MANAGEMENTFORM APPROVED  
Budget Bureau No. 1004-0135  
Expires: March 31, 1993

## SUNDRY NOTICES AND REPORTS ON WELLS

Do not use this form for proposals to drill or to deepen or reentry to a different reservoir.  
Use "APPLICATION FOR PERMIT—" for such proposals

## SUBMIT IN TRIPLICATE

1. Type of Well <input type="checkbox"/> Oil Well <input checked="" type="checkbox"/> Gas Well <input type="checkbox"/> Other	7. If Unit or <u>CA</u> Agreement Designation 892000844F
2. Name of Operator Amoco Production Company	8. Well Name and No. Gen #186E
3. Address and Telephone No. 200 Amoco Court, Farmington, N.M. 87401 Tel: (505) 326-9200	9. API Well No. 3004525203
4. Location of Well (Footage, Sec., T., R., M., or Survey Description) SE/4 SW/4, SEC. 33, T 28 N, R 12 W, N.M.P.M. 1250' FSL / 1860' FWL	10. Field and Pool, or Exploratory Area BASIN DAKOTA
	11. County or Parish, State SAN JUAN, NM

## 12. CHECK APPROPRIATE BOX(s) TO INDICATE NATURE OF NOTICE, REPORT, OR OTHER DATA

TYPE OF SUBMISSION	TYPE OF ACTION
<input type="checkbox"/> Notice of Intent	<input type="checkbox"/> Abandonment
<input checked="" type="checkbox"/> Subsequent Report	<input type="checkbox"/> Recompletion
<input type="checkbox"/> Final Abandonment Notice	<input type="checkbox"/> Plugging Back
	<input type="checkbox"/> Casing Repair
	<input type="checkbox"/> Altering Casing
	<input checked="" type="checkbox"/> Other <u>Pit closure</u>
	<input type="checkbox"/> Change of Plans
	<input type="checkbox"/> New Construction
	<input type="checkbox"/> Non-Routine Fracturing
	<input type="checkbox"/> Water Shut-Off
	<input type="checkbox"/> Conversion to Injection
	<input type="checkbox"/> Dispose Water

(Note: Report results of multiple completion on Well Completion or Recompletion Report and Log form.)

13. Describe Proposed or Completed Operations (Clearly state all pertinent details, and give pertinent dates, including estimated date of starting any proposed work. If well is directionally drilled give subsurface locations and measured and true vertical depths for all markers and zones pertinent to this work.)\*

Pit closure verification - see attached documentation.

① ABANDONED BLOW PIT - ABANDONED, PERMANENT CLOSURE REQUESTED.

② ABANDONED DEHYDRATOR PIT - ABANDONED, RISK ASSESSED.

14. I hereby certify that the foregoing is true and correct

Signed

B. Shaw

Title

Enviro. Coordinator

Date

4/1/00

(This space for Federal or State office use)

Approved by

Title

Date

Conditions of approval, if any:

CLIENT: <u>BP</u>	<b>BLAGG ENGINEERING, INC.</b> P.O. BOX 87, BLOOMFIELD, NM 87413 (505) 632-1199	LOCATION NO: <u>80724</u> C.O.C. NO: <u>9806</u>
-------------------	---	---

## FIELD REPORT: LANDFARM/COMPOST PILE CLOSURE VERIFICATION

LOCATION: NAME: <u>GCU</u>	WELL #: <u>186E</u> PITS: <u>DEHY</u>	DATE STARTED: <u>3/26/02</u>
QUAD/UNIT: <u>N</u> SEC: <u>33</u> TWP: <u>28N</u> RNG: <u>12W</u> PM: <u>NM</u> CNTY: <u>SJ</u> ST: <u>NM</u>		DATE FINISHED: _____
QTR/FOOTAGE: <u>SE/SW</u>	CONTRACTOR: <u>FLINT</u>	ENVIRONMENTAL SPECIALIST: <u>NV</u>

### SOIL REMEDIATION:

 REMEDIATION SYSTEM: LANDFARM

 APPROX. CUBIC YARDAGE: 70

 LAND USE: RANGE - BLM

 LIFT DEPTH (ft): <0.5

### FIELD NOTES & REMARKS:

 NMOC D RANKING SCORE: 0 NMOC D TPH CLOSURE STD: 5000 PPM

 DEPTH TO GROUNDWATER: >100' NEAREST WATER SOURCE: >1000' NEAREST SURFACE WATER: >1000'

SOIL TYPE: SAND / SILTY SAND / SILT / SILTY CLAY / CLAY / GRAVEL / OTHER \_\_\_\_\_  
 SOIL COLOR: OK. YELL. ORANGE  
 COHESION (ALL OTHERS): NON COHESIVE / SLIGHTLY COHESIVE / COHESIVE / HIGHLY COHESIVE  
 CONSISTENCY (NON COHESIVE SOILS): LOOSE / IRM / DENSE / VERY DENSE  
 PLASTICITY (CLAYS): NON PLASTIC / SLIGHTLY PLASTIC / COHESIVE / MEDIUM PLASTIC / HIGHLY PLASTIC  
 DENSITY (COHESIVE CLAYS & SILTS): SOFT / FIRM / STIFF / VERY STIFF / HARD  
 MOISTURE: DRY / SLIGHTLY MOIST / MOIST / WET / SATURATED / SUPER SATURATED  
 DISCOLORATION/STAINING OBSERVED: YES / NO EXPLANATION - \_\_\_\_\_  
 HC ODOR DETECTED: YES / NO EXPLANATION - \_\_\_\_\_  
 SAMPLING DEPTHS (LANDFARMS): 3-6 (INCHES)  
 SAMPLE TYPE: GRAB / COMPOSITE # OF PTS. 5  
 ADDITIONAL COMMENTS: \_\_\_\_\_

### FIELD 418.1 CALCULATIONS

SAMP. TIME	SAMPLE I.D.	LAB No:	WEIGHT (g)	mL. FREON	DILUTION	READING	CALC. ppm

### SKETCH/SAMPLE LOCATIONS

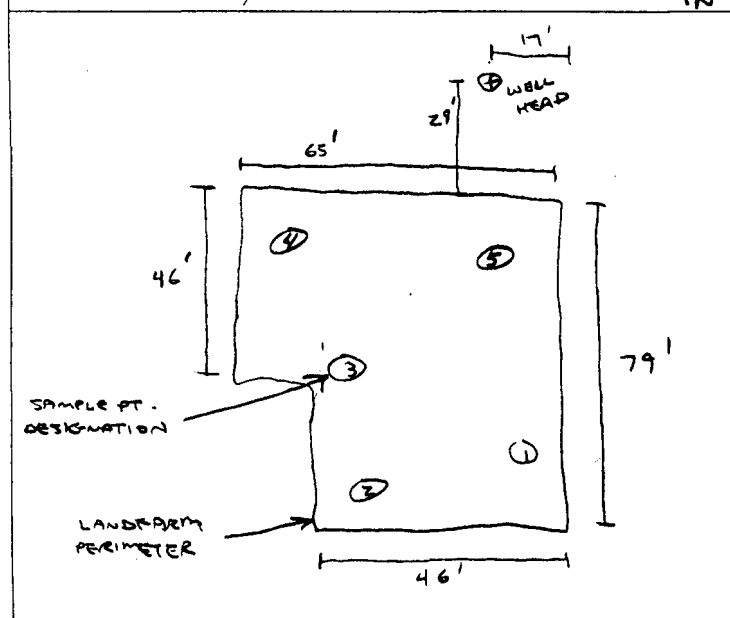

DVM CALIB. READ. 53.0 ppm  
 DVM CALIB. GAS = 100 ppm; RF = 0.52  
 TIME: 9:42 am DATE: 3/26/02

### OVM RESULTS

### LAB SAMPLES

SAMPLE ID	FIELD HEADSPACE PID (ppm)	SAMPLE ID	ANALYSIS	TIME	RESULTS
<u>LF-1</u>	<u>0.0</u>	<u>LF-1</u>	<u>TPH (20158)</u>	<u>1000</u>	<u>ND</u>

P.C. - 3/17/00

### SCALE

0  FT

 TRAVEL NOTES: CALLOUT: N/A

 ONSITE: 3/26/02

# ENVIROTECH LABS

PRACTICAL SOLUTIONS FOR A BETTER TOMORROW

## EPA METHOD 8015 Modified Nonhalogenated Volatile Organics Total Petroleum Hydrocarbons

Client:	Blagg / BP	Project #:	94034-010
Sample ID:	LF - 1	Date Reported:	03-28-02
Laboratory Number:	22391	Date Sampled:	03-26-02
Chain of Custody No:	9806	Date Received:	03-26-02
Sample Matrix:	Soil	Date Extracted:	03-28-02
Preservative:	Cool	Date Analyzed:	03-28-02
Condition:	Cool and Intact	Analysis Requested:	8015 TPH

Parameter	Concentration (mg/Kg)	Det. Limit (mg/Kg)
Gasoline Range (C5 - C10)	ND	0.2
Diesel Range (C10 - C28)	ND	0.1
Total Petroleum Hydrocarbons	ND	0.2

ND - Parameter not detected at the stated detection limit.

References: Method 8015B, Nonhalogenated Volatile Organics, Test Methods for Evaluating Solid Waste, SW-846, USEPA, December 1996.

Comments: GCU #186E Landfarm 5 Pt. Composite.

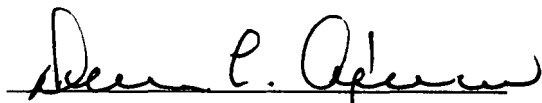
  
Analyst

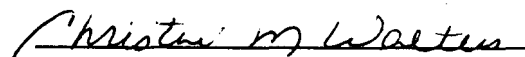
  
Review