

District I  
1625 N. French Dr., Hobbs, NM 88240  
District II  
1301 W. Grand Avenue, Artesia, NM 88210  
District III  
1000 Rio Brazos Road, Aztec, NM 87410  
District IV  
1220 S. St. Francis Dr., Santa Fe, NM 87505

State of New Mexico  
Energy Minerals and Natural Resources

Form C-144  
June 1, 2004

Oil Conservation Division

1220 South St. Francis Dr.  
Santa Fe, NM 87505

For drilling and production facilities, submit to  
appropriate NMOCD District Office.  
For downstream facilities, submit to Santa Fe  
office

**Pit or Below-Grade Tank Registration or Closure**

Is pit or below-grade tank covered by a "general plan"? Yes ☒ No ☐  
Type of action: Registration of a pit or below-grade tank ☐ Closure of a pit or below-grade tank ☒

Operator: BURLINGTON RESOURCES OIL & GAS COMPANY LP Telephone: 505-326-9700 e-mail address: pthompson@br-inc.com  
Address: 3401 E. 30TH STREET, FARMINGTON, NM 87402 Formation: Fruitland Coal  
Facility or well name: Culpepper Martin #6S API #: 30-045-32866 U/L or Qtr/Qtr F Sec 31 T 32N R 12W  
County: San Juan Latitude 36.944708' N Longitude 108.08.138533' W NAD: 1927 ☒ 1983 ☐ Surface Owner Federal ☐ State ☐ Private ☒ Indian ☐

**Pit**

Type: Drilling ☒ Production ☐ Disposal ☐  
Workover ☐ Emergency ☐  
Lined ☒ Unlined ☐  
Liner type: Synthetic ☐ Thickness 12 mil Clay ☐  
Pit Volume                      bbl

**Below-grade tank**

Volume:            bbl Type of fluid:                       
Construction material:                       
Double-walled, with leak detection? Yes ☐ If not, explain why not.                     

Depth to ground water (vertical distance from bottom of pit to seasonal high water elevation of ground water.)	Less than 50 feet	(20 points)	
	50 feet or more, but less than 100 feet	(10 points)	
	100 feet or more	( 0 points)	
Wellhead protection area: (Less than 200 feet from a private domestic water source, or less than 1000 feet from all other water sources.)	Yes	(20 points)	0
	No	( 0 points)	
Distance to surface water: (horizontal distance to all wetlands, playas, irrigation canals, ditches, and perennial and ephemeral watercourses.)	Less than 200 feet	(20 points)	0
	200 feet or more, but less than 1000 feet	(10 points)	
	1000 feet or more	( 0 points)	
Ranking Score (Total Points)		20	

If this is a pit closure: (1) attach a diagram of the facility showing the pit's relationship to other equipment and tanks. (2) Indicate disposal location: (check the onsite box if you are burying in place) onsite ☐ offsite ☐ If offsite, name of facility                     . (3) Attach a general description of remedial action taken including remediation start date and end date. (4) Groundwater encountered: No ☐ Yes ☐ If yes, show depth below ground surface            ft. and attach sample results. (5) Attach soil sample results and a diagram of sample locations and excavations. (6) The pit closure date was                     

**Additional Comments:**

The cut & fill diagram was submitted with the C103 for the pit, which indicated direction and distance the pit was from the wellhead.

I hereby certify that the information above is true and complete to the best of my knowledge and belief. I further certify that the above-described pit or below-grade tank has been/will be constructed or closed according to NMOCD guidelines ☐, a general permit ☒, or an (attached) alternative OCD-approved plan ☐.

Date: 12/6/2005

Printed Name/Title Philana Thompson/ Regulatory Associate II

Signature Philana Thompson

Your certification and NMOCD approval of this application/closure does not relieve the operator of liability should the contents of the pit or tank contaminate ground water or otherwise endanger public health or the environment. Nor does it relieve the operator of its responsibility for compliance with any other federal, state, or local laws and/or regulations.

**Approval:**

DEPUTY OIL & GAS INSPECTOR, DIST. #1

Printed Name/Title                     

Signature Wenny

Date: JAN 26 2006

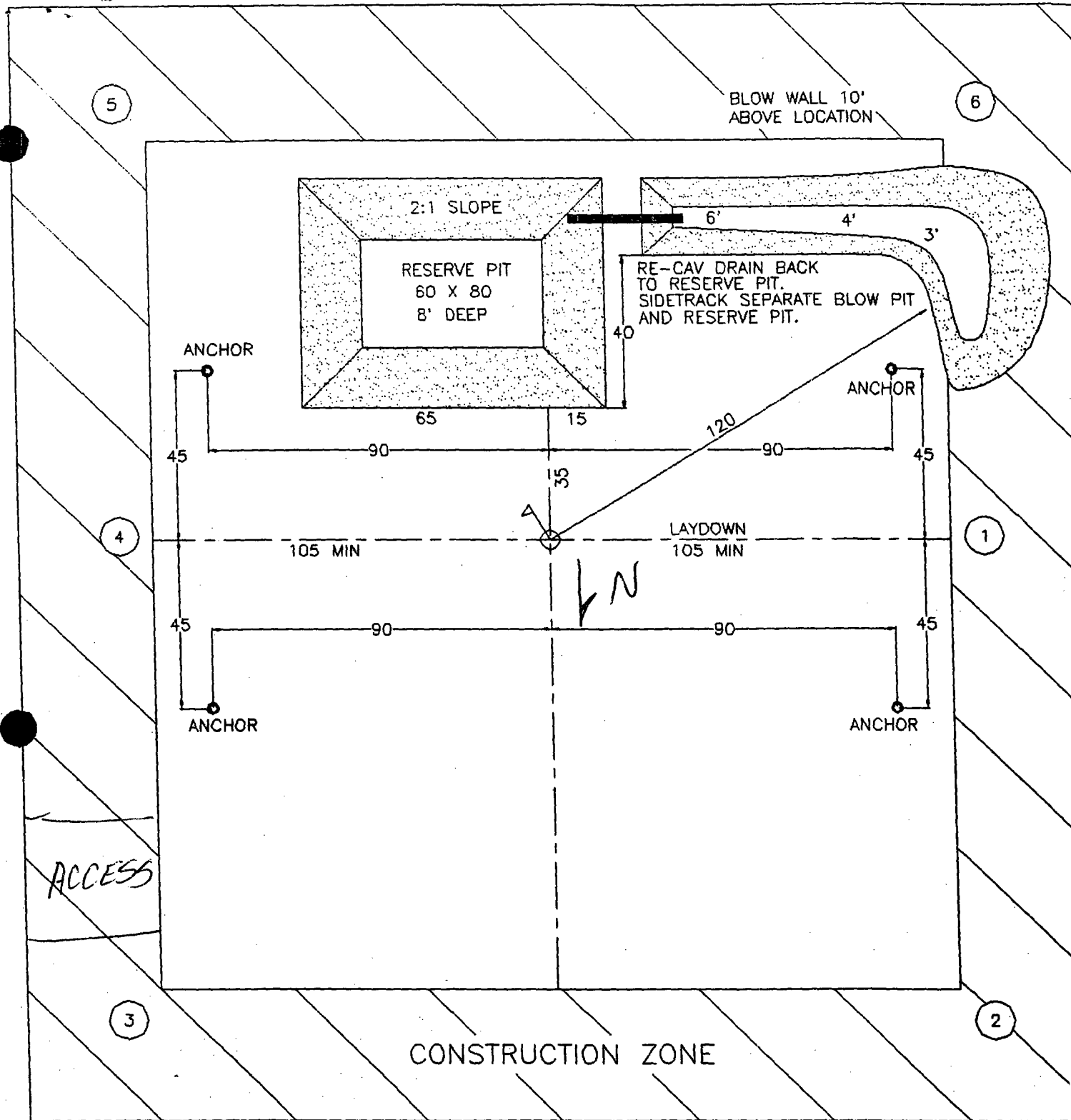

Blow pit overflow dike halfway between top and bottom and extend over plastic liner and into blow pit.