

Submit 3 Copies To Appropriate District Office
 District I
 1625 N. French Dr., Hobbs, NM 88240
 District II
 1301 W. Grand Ave., Artesia, NM 88210
 District III
 1000 Rio Brazos Rd., Aztec, NM 87410
 District IV
 1220 S. St. Francis Dr., Santa Fe, NM 87505

State of New Mexico
 Energy, Minerals and Natural Resources

Form C-103
 May 27, 2004

OIL CONSERVATION DIVISION
 1220 South St. Francis Dr.
 Santa Fe, NM 87505

WELL API NO.	30-045- 33581
5. Indicate Type of Lease	STATE <input type="checkbox"/> FEE <input checked="" type="checkbox"/>
6. State Oil & Gas Lease No.	
7. Lease Name or Unit Agreement Name	Standard Oil Com
8. Well Number	#100S
9. OGRID Number	14538
10. Pool name or Wildcat	Basin Fruitland Coal

SUNDRY NOTICES AND REPORTS ON WELLS
 (DO NOT USE THIS FORM FOR PROPOSALS TO DRILL OR TO DEEPEN OR PLUG BACK TO A DIFFERENT RESERVOIR. USE "APPLICATION FOR PERMIT" (FORM C-101) FOR SUCH PROPOSALS.)

1. Type of Well:
 Oil Well Gas Well Other

2. Name of Operator
 BURLINGTON RESOURCES OIL & GAS COMPANY LP

3. Address of Operator
 3401 E. 30TH STREET, FARMINGTON, NM 87402

4. Well Location
 Unit Letter O : 660 feet from the South line and 2620 feet from the East line
 Section 36 Township 29N Range 9W NMPM County San Juan

11. Elevation (Show whether DR, RKB, RT, GR, etc.)
 5698'

Pit or Below-grade Tank Application or Closure

Pit type New Drill Depth to Groundwater >100' Distance from nearest fresh water well >1000' Distance from nearest surface water <1000'

Pit Liner Thickness: 12 mil Below-Grade Tank: Volume bbbs; Construction Material _____

12. Check Appropriate Box to Indicate Nature of Notice, Report or Other Data

NOTICE OF INTENTION TO:		SUBSEQUENT REPORT OF:	
PERFORM REMEDIAL WORK <input type="checkbox"/>	PLUG AND ABANDON <input type="checkbox"/>	REMEDIAL WORK <input type="checkbox"/>	ALTERING CASING <input type="checkbox"/>
TEMPORARILY ABANDON <input type="checkbox"/>	CHANGE PLANS <input type="checkbox"/>	COMMENCE DRILLING OPNS. <input type="checkbox"/>	P AND A <input type="checkbox"/>
PULL OR ALTER CASING <input type="checkbox"/>	MULTIPLE COMPL <input type="checkbox"/>	CASING/CEMENT JOB <input type="checkbox"/>	
OTHER: <u>New Drill</u> <input checked="" type="checkbox"/>		OTHER: <input type="checkbox"/>	

13. Describe proposed or completed operations. (Clearly state all pertinent details, and give pertinent dates, including estimated date of starting any proposed work). SEE RULE 1103. For Multiple Completions: Attach wellbore diagram of proposed completion or recompletion.

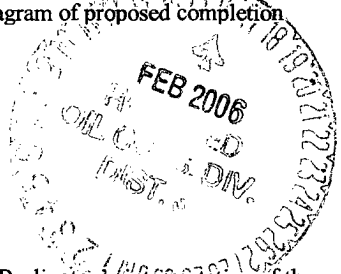

New Drill, Lined:

Burlington Resources proposes to construct a new drilling pit and an associated vent/flare pit. Based on Burlington's interpretation of the Ecosphere's risk ranking criteria, the new drilling pit will be a lined pit as detailed in Burlington's Revised Drilling / Workover Pit Construction / Operation Procedures dated November 11, 2004 on file at the NMOCD office. A portion of the vent/flare pit will be designed to manage fluids and that portion will be lined as per the risk ranking criteria. Burlington Resources anticipates closing these pits according to the Drilling / Workover Pit Closure Procedure dated August 2, 2004 on file at the NMOCD office

I hereby certify that the information above is true and complete to the best of my knowledge and belief. I further certify that any pit or below-grade tank has been/will be constructed or closed according to NMOCD guidelines , a general permit or an (attached) alternative OCD-approved plan .

SIGNATURE Amanda Sandoval TITLE Regulatory Assistant III DATE 2/8/2006

Type or print name Amanda Sandoval E-mail address: asandoval@br-inc.com Telephone No. 505-326-9891

APPROVED BY Jerry Teut TITLE DEPUTY OIL & GAS INSPECTOR, DIST. IV DATE FEB 16 2006
 Conditions of Approval (if any): _____

**BURLINGTON RESOURCES OIL & GAS COMPANY STANDARD OIL COM #100S
 660' FSL & 2620' FEL, SECTION 36, T29N, R9W, NMPM, SAN JUAN COUNTY, NM
 GROUND ELEVATION: 5698' DATE: JANUARY 6, 2006**

205' X 240' 305' X 340' = 2.38 ACRES

**LATITUDE: 36.67740° N
 LONGITUDE: 107.73421° W
 DATUM: NAD1983**

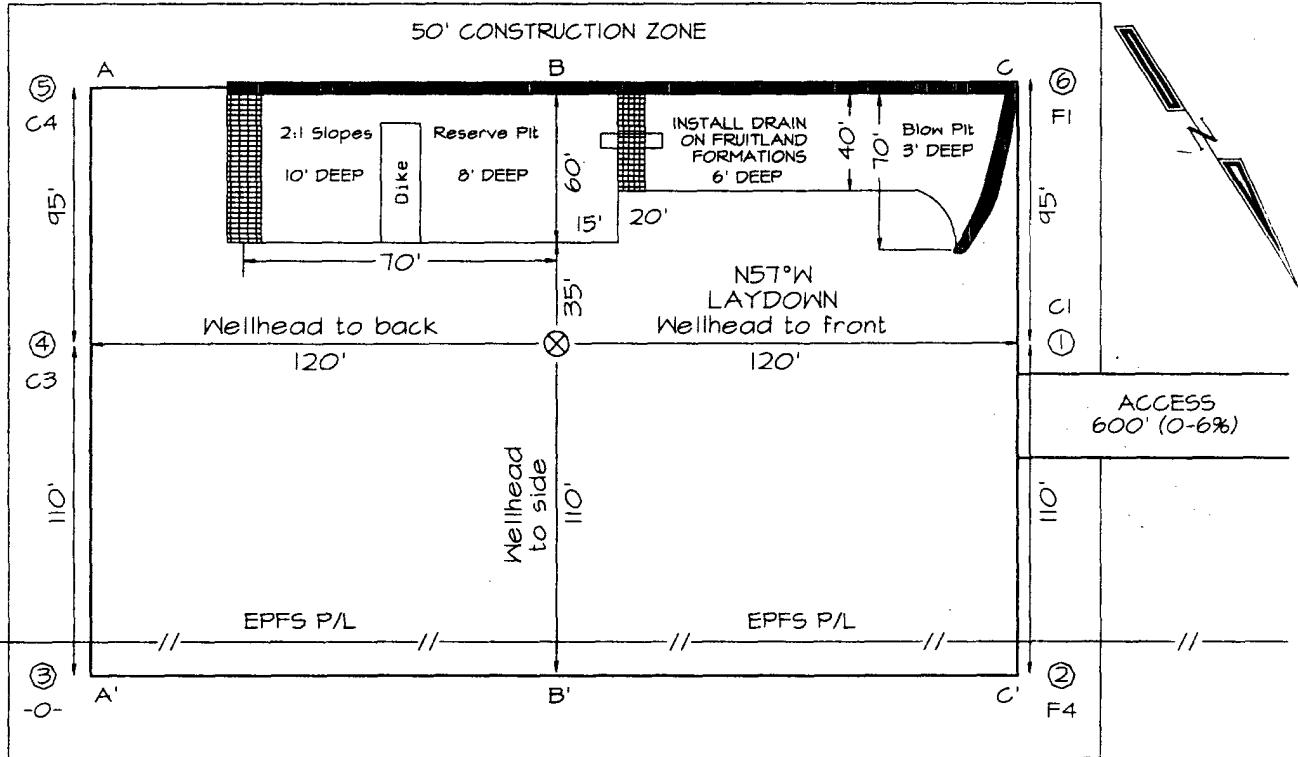

Reserve Pit Dike: to be 8' above Deep side (overflow - 3' wide and 1' above shallow side).
 Blow Pit: overflow pipe halfway between top and bottom and to extend over plastic liner and into blow pit.

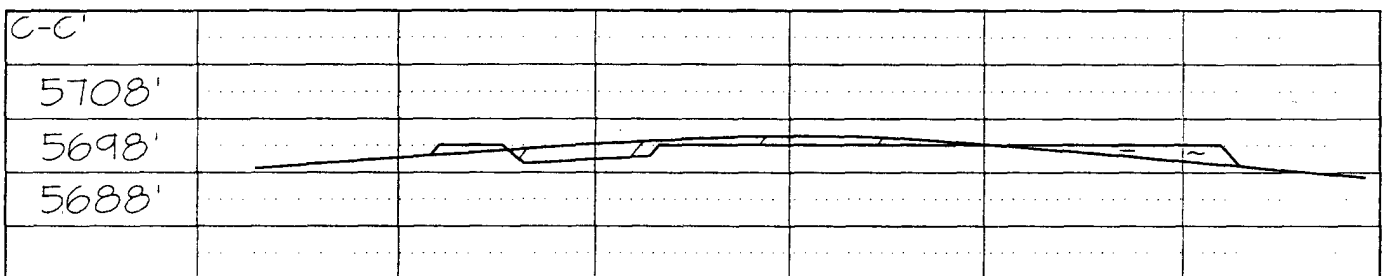
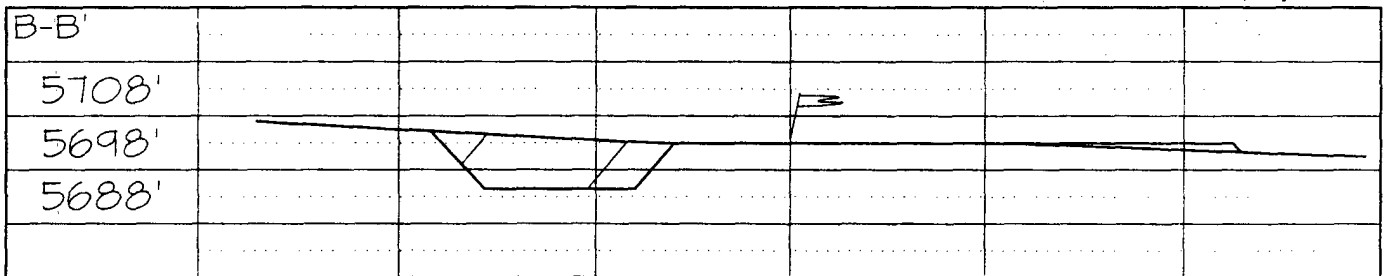
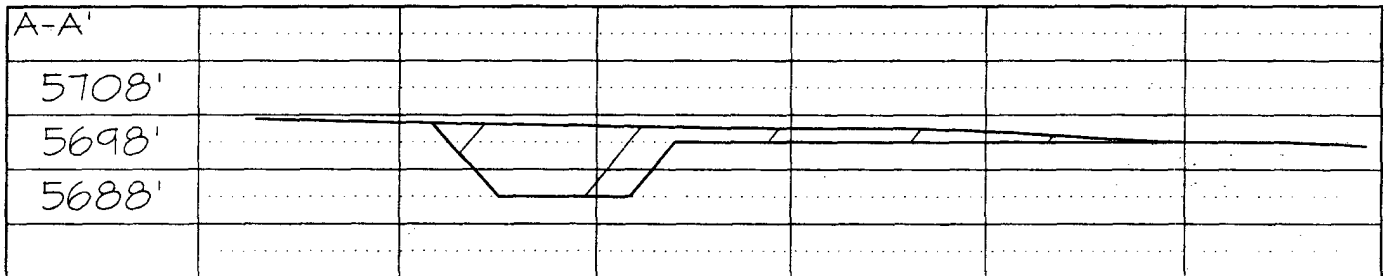

Note: Contractor should call One-Call for location of any marked or unmarked buried pipelines or cables on well pad and/or access road at least two (2) working days prior to construction