

UNITED STATES
DEPARTMENT OF THE INTERIOR
BUREAU OF LAND MANAGEMENT

FORM APPROVED
Budget Bureau No. 1004-0135
Expires March 31, 1993

SUNDRY NOTICES AND REPORTS ON WELLS

Do not use this form for proposals to drill or to deepen or reentry to a different reservoir
Use "APPLICATION FOR PERMIT -" for such proposals

5. Lease Designation and Serial No.

NMNM-03877

6. If Indian, Allottee or Tribe Name

7. If Unit or CA, Agreement Designation

8. Well Name and No.

Duff 29-11-8 # 104

9. API Well No.

30-045-33350

10. Field and Pool, or Exploratory

Basin Fruitland Coal

11. County or Parish, State

San Juan County
New Mexico

1. Type of Well

☐

Oil Well

☒

Gas Well

☐

Other

2. Name of Operator

Synergy Operating, LLC (163458)

OGRID # 163458

3. Address and Telephone No.

PO Box 5513

(505) 325-5549

Farmington, NM 87499

4. Location of Well (Footage, Sec, T. R., M, or Survey Description)

Unit D, 955' FNL, 885' FWL, Sec 08, T29N - R11W

320 acres (W/2)

12. CHECK APPROPRIATE BOX(S) TO INDICATE NATURE OF NOTICE, REPORT, OR OTHER DATA

TYPE OF SUBMISSION

TYPE OF ACTION

☐

Notice of Intent

☒

Subsequent Report

☐

Final Abandonment Notice

☐

Abandonment

☐

Recompletion

☐

Plugging Back

☐

Casing Repair

☐

Altering Casing

☐

Other

☒

Change of Plans

☐

New Construction

☐

Non-Routine Fracturing

☐

Water Shut-Off

☐

Conversion to Injection

☐

Dispose Water

(Note: Report results of multiple completion on Well
Completion or recompletion Report and Log Form)

13. Describe Proposed or Completed Operations (Clearly state all pertinent details, and give pertinent dates, including, estimated date of starting work.

If well is directionally drilled give subsurface locations and measured and true vertical depths for all markers and zones of pertinent to this work.

02-13-2006

SYNERGY OPERATING NOTIFIED BOTH THE BLM AND NMOC D OF IMPENDING SPUD ON 02-13-2006.

MIRU D&D DRILLING RIG # 1. SPUD 12-1/4" SURFACE HOLE AT 07:30 HRS ON 02-14-2006.

02-14-2006

SM. Spud 12-1/4" Surface hole at 7:30 hrs on 2/14/2006. Drill 12-1/4" hole to 178'. Circulate Clean. COOH.
MU 8-5/8" 24# K-55 Production Casing. Run and Cement Casing at 174' KB. Note APD indicates 220'. No extra casing
on location. Will ensure cement to surface on 5-1/2" and run CBL to indicate such. Cement 8-5/8" casing with
125 sxs (147.5 ft3) Class B Cement w/ 2% CaCl at 15.6 ppg. Circulate good cement to surface. Displace w/ 9.5 bbls
fresh water. Close in 8-5/8" casing. Circulated 9.5 bbls good cement to surface. No cement fall-back. WOC.

Offset PC/FTC Surface Casing Depths at 130' +/- See attached Map.

14. I hereby certify that the foregoing is true and correct

Signed:

Thomas E. Mullins

Title: Engineering Manager

Date:

02-15-2006

Telephone: (505) 566-3725

This space for federal or state office use

Approved by:

Title:

Date:

FEB 15 2006

Conditions of approval if any

FARMINGTON FIELD OFFICE

NMOC D

Date: 2/15/2006
Time: 12:35 PM

Duff # 104
Surface CASING
REVIEW

PI/Dwights PLUS on CD Map Report

Z4-N

11-W

sec 8

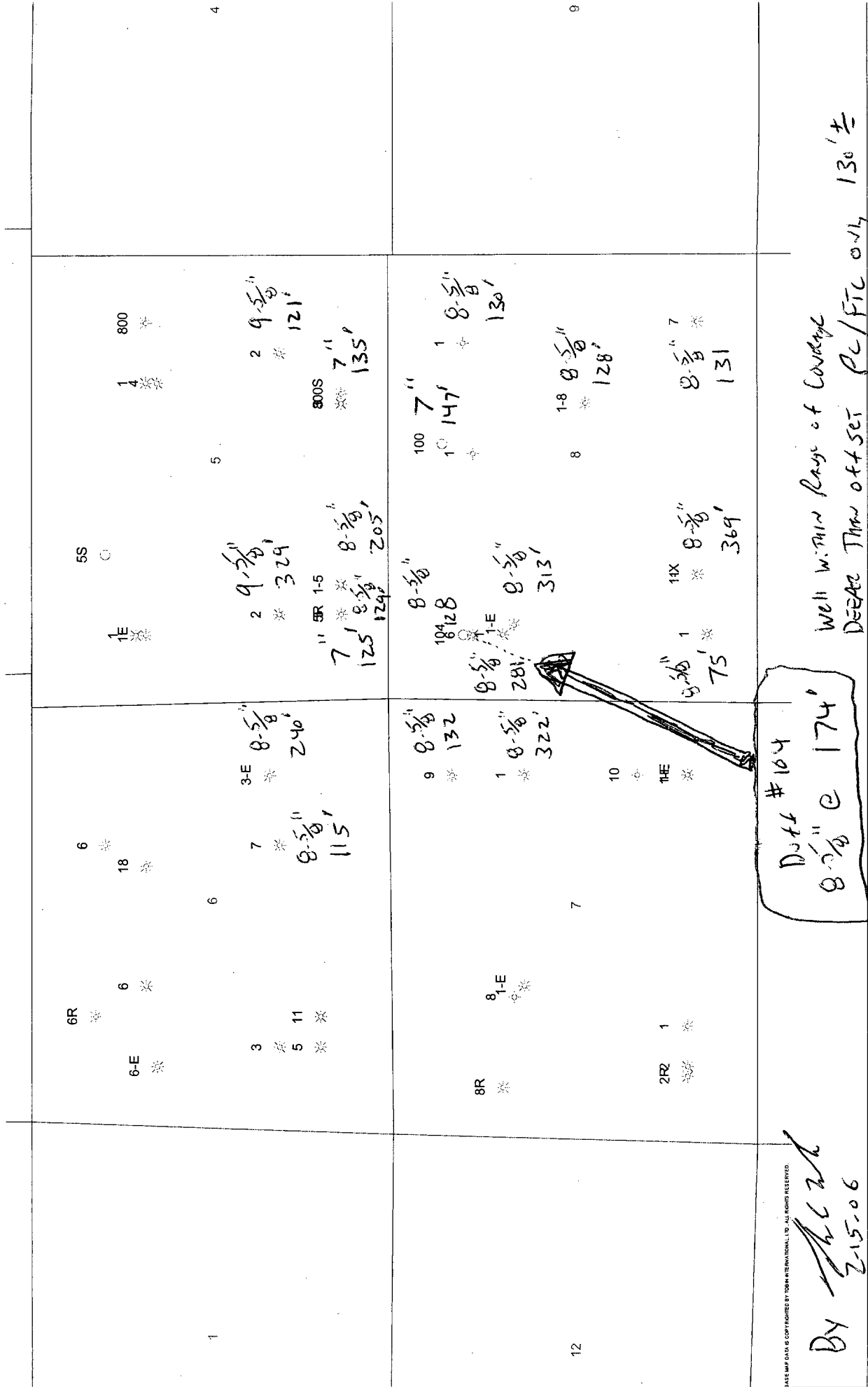

By *hcl*
2-15-06