

UNITED STATES
DEPARTMENT OF THE INTERIOR
BUREAU OF LAND MANAGEMENT

APPLICATION FOR PERMIT TO DRILL, DEEPEN, OR PLUG BACK

1a. Type of Work DRILL	5. Lease Number NMSF-078423 Unit Reporting Number 070 FARMINGTON NM
1b. Type of Well GAS	6. If Indian, All. or Tribe
2. Operator BURLINGTON RESOURCES Oil & Gas Company	7. Unit Agreement Name San Juan 29-7 Unit
3. Address & Phone No. of Operator PO Box 4289, Farmington, NM 87499 (505) 326-9700	8. Farm or Lease Name
4. Location of Well Unit M, 590' FSL & 375' FWL, Latitude 36° 44.0819'N Longitude 107° 35.0064'W	9. Well Number #5498
	10. Field, Pool, Wildcat Basin Fruitland Coal Blanco Pictured cliffs 11. Sec., Twn, Rge, Mer. (NMPM) Sec. 9, T29N, R7W API # 30-039-29744
14. Distance in Miles from Nearest Town 15+ miles from Bloomfield, NM	12. County Rio Arriba
	13. State NM
15. Distance from Proposed Location to Nearest Property or Lease Line 375'	
16. Acres in Lease	17. Acres Assigned to Well 320 acres W/2
18. Distance from Proposed Location to Nearest Well, Drig, Compl, or Applied for on this Lease Twinned with SJ 29-7 Unit #80M	
19. Proposed Depth 3720'	20. Rotary or Cable Tools Rotary
21. Elevations (DF, FT, GR, Etc.) 6720' GL	22. Approx. Date Work will Start
23. Proposed Casing and Cementing Program See Operations Plan attached	
24. Authorized by: <u>Patsy Clugst</u> Sr. Regulatory Specialist	Date <u>1/10/06</u>

PERMIT NO. _____ APPROVAL DATE _____
APPROVED BY [Signature] TITLE AFM DATE 2/13/06

Archaeological Report attached

Threatened and Endangered Species Report attached

NOTE: This format is issued in lieu of U.S. BLM Form 3160-3

Title 18 U.S.C. Section 1001, makes it a crime for any person knowingly and willfully to make to any department or agency of the United States any false, fictitious or fraudulent statements or presentations as to any matter within its jurisdiction.

This is NOT an NPA well
SUBJECT TO COMPLIANCE WITH ATTACHED
"GENERAL REQUIREMENTS".

This action is subject to technical and
procedural review pursuant to 43 CFR 3165.3
and appeal pursuant to 43 CFR 3165.4

NMOC

DISTRICT I
1825 N. French Dr., Hobbs, N.M. 88240

DISTRICT II
1301 W. Grand Ave., Artesia, N.M. 88210

DISTRICT III
1000 Rio Brazos Rd., Aztec, N.M. 87410

DISTRICT IV
1220 South St. Francis Dr., Santa Fe, NM 87505

State of New Mexico
Energy, Minerals & Natural Resources Department

OIL CONSERVATION DIVISION

1220 South St. Francis Dr.
Santa Fe, NM 87505

Form C-102

Revised June 10, 2003

Submit to Appropriate District Office

State Lease - 4 Copies

Fee Lease - 3 Copies

☐ AMENDED REPORT

2006 JAN 11 AM 8 10

WELL LOCATION AND ACREAGE DEDICATION PLAT

*API Number 30-039-29744		*Pool Code 71629/72400	*Pool Name Basin Fruitland Coal / Blanco Pictured Cliffs
*Property Code 7465	*Property Name SAN JUAN 29-7 UNIT		*Well Number 549S
*GRID No. 14538	*Operator Name BURLINGTON RESOURCES OIL & GAS COMPANY LP		*Elevation 6720'

¹⁰ Surface Location

UL or lot no.	Section	Township	Range	Lot Idn	Feet from the	North/South line	Feet from the	East/West line	County
M	9	29-N	7-W		590	SOUTH	375	WEST	RIO ARriba

¹¹ Bottom Hole Location If Different From Surface

UL or lot no.	Section	Township	Range	Lot Idn	Feet from the	North/South line	Feet from the	East/West line	County
M									
¹² Dedicated Acres FC-320 W/2 PC-160 SW/4			¹³ Joint or Infill		¹⁴ Consolidation Code		¹⁵ Order No.		

NO ALLOWABLE WILL BE ASSIGNED TO THIS COMPLETION UNTIL ALL INTERESTS HAVE BEEN CONSOLIDATED
OR A NON-STANDARD UNIT HAS BEEN APPROVED BY THE DIVISION

<p>¹⁶</p> <p>PABLO CANDELARIA, ET UX</p> <p>FC</p> <p>USA SF-078423</p> <p>FD 2 1/2" U.S.G.L.O. BC. 1914</p> <p>N 00-04-59 E 2644.38'</p> <p>PC</p> <p>LAT. 36°44.0819 N. (NAD 27) LONG. 107°35.0064 W. (NAD27)</p> <p>375'</p> <p>590'</p> <p>FD 2 1/2" U.S.G.L.O. BC. 1914</p> <p>N 89-41-58 W 5276.79' (M)</p> <p>FD 2 1/2" U.S.G.L.O. BC. 1914</p>	<p>¹⁷ OPERATOR CERTIFICATION</p> <p>I hereby certify that the information contained herein is true and complete to the best of my knowledge and belief.</p> <p><i>Patsy Clugston</i></p> <p>Signature</p> <p>Patsy Clugston</p> <p>Printed Name</p> <p>Sr. Regulatory Speicalsit</p> <p>Title</p> <p>10/6/05</p> <p>Date</p>
	<p>¹⁸ SURVEYOR CERTIFICATION</p> <p>I hereby certify that the well location shown on this plat was plotted from field notes of actual surveys made by me or under my supervision, and that the same is true and correct to the best of my belief.</p> <p>DATE: 10/6/2005</p> <p>Signature: <i>JOHN A. VORONICH</i></p> <p>Signature of Registered Professional Surveyor:</p> <p>14831</p> <p>14831</p> <p>REGISTERED PROFESSIONAL SURVEYOR</p> <p>Certificate Number</p>

Office

Energy, Minerals and Natural Resources

May 27, 2004

District I

1625 N. French Dr., Hobbs, NM 88240

District II

1301 W. Grand Ave., Artesia, NM 88210

District III

1000 Rio Brazos Rd., Aztec, NM 87410

District IV

1220 S. St. Francis Dr., Santa Fe, NM 87505

OIL CONSERVATION DIVISION

1220 South St. Francis Dr.

Santa Fe, NM 87505

WELL API NO. 30-039-29744

5. Indicate Type of Lease

STATE ☐FEE ☐

6. State Oil & Gas Lease No.

Federal Lease NMSF-078423

7. Lease Name or Unit Agreement Name

San Juan 29-7 Unit

8. Well Number

#549S

9. OGRID Number

14538

10. Pool name or Wildcat

Blanco Pictured Cliffs / Basin Fruitland Coal

SUNDRY NOTICES AND REPORTS ON WELLS
(DO NOT USE THIS FORM FOR PROPOSALS TO DRILL OR TO DEEPEN OR PLUG BACK TO A
DIFFERENT RESERVOIR. USE "APPLICATION FOR PERMIT" (FORM C-101) FOR SUCH
PROPOSALS.)

1. Type of Well:

Oil Well ☐Gas Well ☒

Other

2. Name of Operator

BURLINGTON RESOURCES OIL & GAS COMPANY LP

3. Address of Operator

3401 E. 30TH STREET, FARMINGTON, NM 87402

4. Well Location

Unit Letter M : 590 feet from the South line and 375 feet from the West line
Section 9 Township 29N Range 7W NMPM County Rio Arriba

11. Elevation (Show whether DR, RKB, RT, GR, etc.)

6720' GL

Pit or Below-grade Tank Application

☐ or Closure ☐

Pit type

New Drill

Depth to Groundwater

>100'

Distance from nearest fresh water well

>1000'

Distance from nearest surface water

>1000'

Pit Liner Thickness:

n/a

mil

Below-Grade Tank:

Volume

bbbs;

Construction Material

12. Check Appropriate Box to Indicate Nature of Notice, Report or Other Data

NOTICE OF INTENTION TO:

PERFORM REMEDIAL WORK ☐TEMPORARILY ABANDON ☐PULL OR ALTER CASING ☐PLUG AND ABANDON ☐CHANGE PLANS ☐MULTIPLE COMPL ☐

SUBSEQUENT REPORT OF:

REMEDIAL WORK ☐COMMENCE DRILLING OPNS. ☐CASING/CEMENT JOB ☐ALTERING CASING ☐P AND A ☐

OTHER:

New Drill Pit ☒OTHER: ☐

13. Describe proposed or completed operations. (Clearly state all pertinent details, and give pertinent dates, including estimated date of starting any proposed work). SEE RULE 1103. For Multiple Completions: Attach wellbore diagram of proposed completion or recompletion.

New Drill, Unlined:

Burlington Resources proposes to construct a new drilling pit and an associated vent/flare pit. Based on Burlington's interpretation of the Ecosphere's risk ranking criteria, the new drilling pit and vent/flare pit will be an unlined pit as detailed in Burlington's Revised Drilling / Workover Pit Construction / Operation Procedures dated November 11, 2004 on file at the NMOCD office. A portion of the vent/flare pit will be designed to manage fluids, and that portion will be unlined, as per the risk ranking criteria. Burlington Resources anticipates closing these pits according to the Drilling / Workover Pit Closure Procedure dated August 2, 2004 on file at the NMOCD office.

I hereby certify that the information above is true and complete to the best of my knowledge and belief. I further certify that any pit or below-grade tank has been/will be constructed or closed according to NMOCD guidelines ☐, a general permit ☒ or an (attached) alternative OCD-approved plan ☐.

SIGNATURE

TITLE

Senior Regulatory Specialist

DATE

11/2/2005

Type or print name

Patsy Clugston

E-mail address:

pclugston@br-inc.com

Telephone No.

505-326-9518

For State Use Only

APPROVED BY

TITLE

DEPUTY OIL & GAS INSPECTOR, DIST. 3

DATE

FEB 15 2006

Conditions of Approval (if any):

BURLINGTON RESOURCES OIL & GAS COMPANY LP
SAN JUAN 29-7 UNIT No. 549S, 590 FSL 375 FWL
SECTION 9, T-29-N, R-7-W, N.M.P.M., RIO ARriba COUNTY, NEW MEXICO
GROUND ELEVATION: 6720, DATE: SEPTEMBER 15, 2005

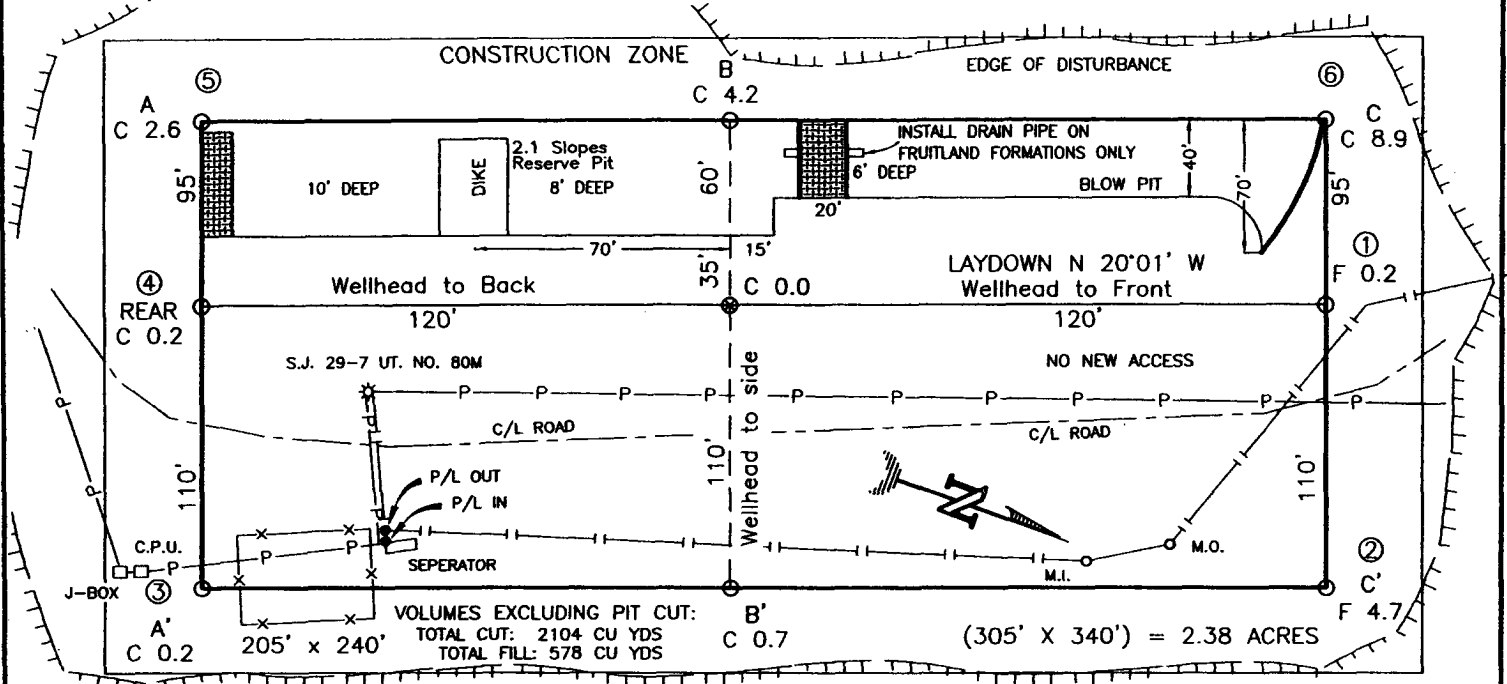

RESERVE PIT DIKE: TO BE 8' ABOVE DEEP SIDE (OVERFLOW - 3' WIDE AND 1' ABOVE SHALLOW SIDE).
 BLOW PIT: OVERFLOW PIPE HALFWAY BETWEEN TOP AND BOTTOM AND TO EXTEND OVER PLASTIC LINER AND INTO BLOW PIT.
 NOTE: - ESTIMATED VOLUMES CALCULATED BY AVERAGE END AREA AT CROSS-SECTION SHOWN

NOTE: DAGGETT ENTERPRISES, INC. IS NOT LIABLE FOR UNDERGROUND UTILITIES OR PIPELINES. NEW MEXICO ONE CALL TO BE NOTIFIED 48 HOURS PRIOR TO EXCAVATION OR CONSTRUCTION.

ELEV. A-A' C/L

6730					
6720					
6710					
6700					

ELEV. B-B' C/L

6730					
6720					
6710					
6700					

ELEV. C-C' C/L

6730					
6720					
6710					
6700					

NOTE: CONTRACTOR SHOULD CALL ONE-CALL FOR LOCATION OF ANY MARKED OR UNMARKED BURIED PIPELINES OR CABLES ON WELL PAD AND OR ACCESS ROAD AT LEAST TWO (2) WORKING DAYS PRIOR TO CONSTRUCTION.

REVISION: RESAKE AND NAME CHANGE

DATE: 09/27/05

REVIEWED BY: G.V.

Daggett Enterprises, Inc.
 Surveying and Oil Field Services
 P. O. Box 15068 • Farmington, NM 87401
 Phone (505) 326-1772 • Fax (505) 326-8019
 NEW MEXICO L.S. No. 14831

DRAWN BY: B.L.

NOVA: BR487

CORFILE: BR487CF8

DATE: 11/17/03

OPERATIONS PLAN

Well Name: San Juan 29-7 Unit #549S
Location: Unit M (SWSW), 590' FSL & 375' FWL, Section 9, T29N, R7W
 Rio Arriba County, New Mexico
 Latitude 36° 44.0819'N; Longitude 107° 35.0064'W
Formation: Basin Fruitland Coal/ Blanco Pictured Cliffs East
Elevation: 6720' GR

Formation:	Top	Bottom	Contents
Surface	San Jose	2581'	
Ojo Alamo	2581'	2697'	
Kirtland	2697'	3246'	gas
T/Fruitland	3246'	3520'	gas
Pictured Cliffs	3520'		
Total Depth	3720'		

Logging Program: Cased hole GR/CBL

Mud Program:

<u>Interval</u>	<u>Type</u>	<u>Weight</u>	<u>Vis. Fluid Loss</u>
0- 120'	Spud/Air/Air Mist	8.4-8.9	40-50 no control
120-3720'	Non-dispersed	8.4-9.5	30-60 no control

Casing Program:

<u>Hole Size</u>	<u>Depth Interval</u>	<u>Csg.Size</u>	<u>Wt.</u>	<u>Grade</u>
8 $\frac{3}{4}$ "	0 - 120'	7"	20.0#	J-55
6 $\frac{1}{4}$ "	0 - 3720'	4 1/2"	10.5#	J/K-55

Tubing Program:

0 - 3720'	2 3/8"	4.7#	J-55
-----------	--------	------	------

Float Equipment: 7" surface casing - guide shoe. Centralizers will be run in accordance with Onshore Order #2.

4 1/2" production casing - float shoe and float collar on bottom. Centralizers run every third joint above shoe to the base of the Ojo Alamo @ 2697'. Two turbolizing type centralizers - one below and one into the base of the Ojo Alamo @ 2697'. Standard centralizers thereafter every fourth joint up to the base of the surface pipe.

Wellhead Equipment: 7" x 4 1/2" x 2 3/8" x 11" 2000 psi xmas tree assembly.

November 2, 2005

Cementing:

7" surface casing Pre-Set Drilled - Cement with Type I, II cement with 20% flyash mixed at 14.5 ppg, 1.61 cu ft per sack yield. (Bring cement to surface). Wait on cement for 24 hours for pre-set holes before pressure testing or drilling out from under surface.

7" surface casing - Cement with 42 sx Type III cement with 0.25 pps Celloflake, 3% CaCl. (54cu ft of slurry @ 1.28 yield). 200% excess, bring cement to surface. Wait on cement for 8 hrs for conventionally set holes before pressure testing or drilling out from under surface. **WOC until cement establishes 250 psi compressive strength prior to NU of BOPE.**

4 1/2" production casing - Cement with 210 sx (448 cu ft of slurry @ 2.13 yield) Premium Lite with 3% calcium chloride, 5 pps LCM-1, and 1/4#/sack celloflake, 0.4% FL-52, & 0.4% SMS. Tail with 90sx (124cu ft of slurry @ 1.38 yield) Type III cmt with 1% calcium chloride, 1/4#/sack Celloflake and 0.2% FL-52. Total of 572 cf - 50% excess to circulate to surface.

BOP and tests:

Surface to TD - 11" 2000 psi (minimum double gate BOP stack (Reference Figure #1 and #2). Prior to drilling out surface casing, test rams to 600 psi/30 min.

Completion - 6" 2000 psi (minimum) double gate BOP stack (Reference Figure #2). Prior to completion operations, test rams and casing to 1500 psi/30 min.

From surface to TD - choke manifold (Reference Figure #3).

Pipe rams will be actuated at least once each day and blind rams actuated once each trip to test proper functioning. An upper kelly cock valve with handle and drill string safety valves to fit each drill string will be maintained and available on the rig floor.

Additional information:

- * The Fruitland Coal & Pictured Cliffs formations will be completed.
- * Anticipated pore pressure for the Fruitland is between 600 - 700 psi.
- * This gas is dedicated.
- * The west half of the section is dedicated to Fruitland Coal and Pictured Cliffs.
- * New casing will be utilized.
- * Pipe movement (either rotation or reciprocation) will be done if hole conditions permit.

Drilling Engineer 

11/30/05
Date

