

District I
1625 N. French Dr., Hobbs, NM 88240
District II
1301 W. Grand Avenue, Artesia, NM 88210
District III
1000 Rio Brazos Road, Aztec, NM 87410
District IV
1220 S. St. Francis Dr., Santa Fe, NM 87505

State of New Mexico
Energy Minerals and Natural Resources

Oil Conservation Division
1220 South St. Francis Dr.
Santa Fe, NM 87505

Form C-144
June 1, 2004

For drilling and production facilities, submit to appropriate NMOCD District Office.
For downstream facilities, submit to Santa Fe office

Pit or Below-Grade Tank Registration or Closure

Is pit or below-grade tank covered by a "general plan"? Yes ☒ No ☐

WFS CLOSURE

Type of action: Registration of a pit or below-grade tank ☐

Closure of a pit or below-grade tank ☒

Operator: BURLINGTON RESOURCES OIL & GAS CO Telephone:

e-mail address:

Address: 801 CHERRY ST FORT WORTH, TX 76102

Facility or well name: NORDHAUS #005A

API #: 30-045-24369

U/L or Qtr/Qtr E SEC 12 T 31N R 9W

County: SAN JUAN

Latitude 36.91522

Longitude -107.73549

NAD: 1927 ☒ 1983 ☐

Surface Owner: Federal ☒ State ☐ Private ☐ Indian ☐

Pit

Type: Drilling ☐ Production ☒ Disposal ☐

Workover ☐ Emergency ☐

Lined ☐ Unlined ☒

Liner Type: Synthetic ☐ Thickness mil Clay ☐

Pit Volume 70 bbl

Below-grade tank

Volume: bbl Type of fluid:

Construction Material:

Double-walled, with leak detection? Yes ☐ If not, explain why not

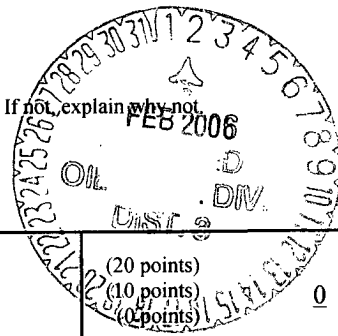

Depth to ground water (vertical distance from bottom of pit to seasonal high water elevation of ground water.)

Less than 50 feet
50 feet or more, but less than 100 feet
100 feet or more

(20 points)
(10 points)
(0 points)

0

Wellhead protection area: (Less than 200 feet from a private domestic water source, or less than 1000 feet from all other water sources.)

Yes
No

(20 points)
(0 points)

0

Distance to surface water: (Horizontal distance to all wetlands, playas, irrigation canals, ditches, and perennial and ephemeral watercourses.)

Less than 200 feet
200 feet to 1,000 feet
Greater than 1,000 feet

(20 points)
(10 points)
(0 points)

0

Ranking Score (TOTAL POINTS):

0

If this is a pit closure: (1) Attach a diagram of the facility showing the pit's relationship to other equipment and tanks. (2) Indicate disposal location: (check the onsite box if you are burying in place) onsite ☒ offsite ☐ If offsite, name of facility (3) Attach a general description of remedial action taken including remediation start date and end date. (4) Groundwater encountered: No ☒ Yes ☐ If yes, show depth below ground surface ft. and attach sample results. (5) Attach soil sample results and a diagram of sample locations and excavations.

Additional Comments:

Meter: 34933

Steel and in earthen containment set next to out of service pit - some standing water - excavate test trench and find no hydrocarbon impact - 0 ppm HS - push in berms and return to grade - no samples

I hereby certify that the information above is true and complete to the best of my knowledge and belief. I further certify that the above-described pit or below-grade tank has been/will be constructed or closed according to NMOCD guidelines ☐ , a general permit ☐ , or an (attached) alternative OCD-approved plan ☒

Date: 1/31/06

Printed Name/Title Mark Harvey for Williams Field Services

Signature Mr. Harvey, for WFS

Your certification and NMOCD approval of this application/closure does not relieve the operator of liability should the contents of the pit or tank contaminate ground water or otherwise endanger public health or the environment. Nor does it relieve the operator of its responsibility for compliance with any other federal, state, or local laws and/or regulations.

Approval:

Printed Name/Title DEPUTY OIL & GAS INSPECTOR, DIST. 3

Signature Wendy Reed

Date: FEB 02 2006

ADDENDUM TO OCD FORM C-144

Operator: BURLINGTON RESOURCES OIL & GAS COMPANY LP

API 30-045-24369

Well Name: NORDHAUS #005A

Meter: 34933

Facility Diagram:

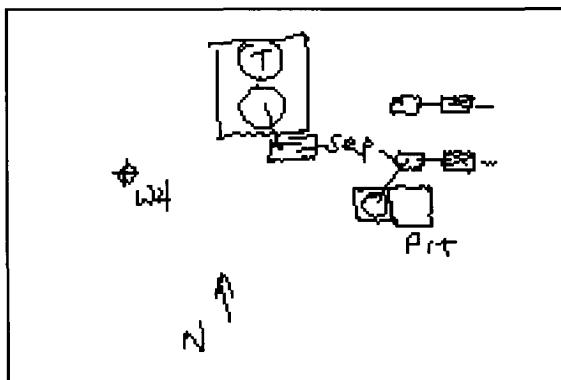

Sampling Diagram:

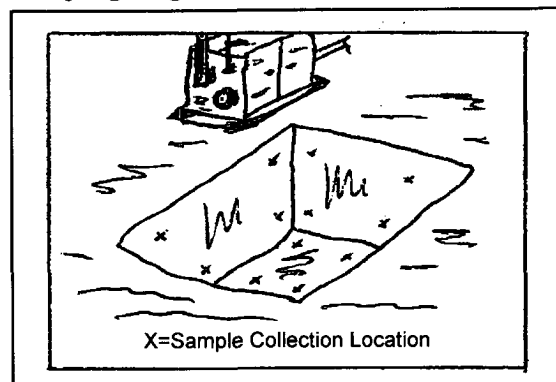

Pit Dimensions

Length 14 Ft.

Width 14 Ft.

Depth 2 Ft.

Location of Pit Center

Latitude 36.91552

Longitude -107.73519

(NAD 1927)

Pit ID

349331

Pit Type

Separator

Date Closure Started: 4/18/05

Closure Method: Pushed In

Date Closure Completed: 4/18/05

Bedrock Encountered ? ☐

Cubic Yards Excavated:

Vertical Extent of Equipment Reached ? ☐

Description Of Closure Action:

The pit was assessed and sampled in accordance with NMOCD guidelines. Based on assessment findings, the pit was backfilled.

Pit Closure Sampling:

[illegible]