



RECEIVED

JUN 17 AM 11:03

FORM APPROVED
OMB NO. 1004-0136
Expires: November 30, 2000

UNITED STATES DIST. 3
DEPARTMENT OF THE INTERIOR
BUREAU OF LAND MANAGEMENT
APPLICATION FOR PERMIT TO DRILL OR REENTER

070 Farmington, NM

Lease Serial No.	NMNM 094069
6. If Indian, Allottee or Tribe Name	
7. If Unit or CA Agreement, Name and No.	28996
8. Lease Name and Well No.	Legend Com #1S
9. API Well No.	30045 31733
10. Field and Pool, or Exploratory	Basin Fruitland Coal
11. Sec., T., R., M., or Blk. And Survey or Area	E Section 25, T26N, R12W
12. County or Parish	San Juan
13. State	NM
15. Distance from proposed* location to nearest property or lease line, ft. (Also to nearest drlg unit line, if any)	840
16. No. of Acres in lease	160
17. Spacing Unit dedicated to this well	320 ACRES N/2
18. Distance from proposed location* to nearest well, drilling, completed, applied for, on this lease, ft.	NA
19. Proposed Depth	1410
20. BLM/ BIA Bond No. on file	BLM Blanket Bond #08510612
21. ELEVATIONS (Show whether DF, RT, GR, etc.)	6186'
22. Approximate date work will start*	August-03
23. Estimated Duration	2 Weeks

1a. TYPE OF WORK ☒ DRILL ☐ REENTER
b. TYPE OF WELL ☐ OIL ☒ GAS WELL ☐ OTHER ☐ SINGLE ZONE ☐ MULTIPLE ZONE

2. Name of Operator
Coleman Oil & Gas, Inc.

3a. Address
P.O. Drawer 3337, Farmington N.M. 87499
3b. Phone No. (include area code)
(505) 327-0356

4. Location of well (Report location clearly and in accordance with any State requirements. *)
At surface
1800' FNL, 1100' FWL Latitude 36° 27' 41", Longitude 108° 04' 03"
At proposed prod. zone

14. DISTANCE IN MILES AND DIRECTION FROM NEAREST TOWN OR POST OFFICE*
South East of Farmington New Mexico on County RD. 7120 approximately 30 miles.

15. Distance from proposed* location to nearest property or lease line, ft. (Also to nearest drlg unit line, if any)
840

18. Distance from proposed location* to nearest well, drilling, completed, applied for, on this lease, ft.
NA

21. ELEVATIONS (Show whether DF, RT, GR, etc.)
6186'

24. Attachments

The following, completed in accordance with the requirements of Onshore Oil and Gas Order No. 1 shall be attached to this form:

- Well plat certified by a registered surveyor.
- A Drilling Plan.
- A Surface Use Plan (if the location is on National Forest System Lands, the SUPO shall be filed with the appropriate Forest Service Office).
- Bond to cover the operations unless covered by existing bond on file (see item 20 above).
- Operator certification.
- Such other site specific information and/ or plans as may be required by the authorized officer.

25. Signature *Michael T. Hanson* Name (Printed/ Typed) Michael T. Hanson DATE 3-Jun-03

Title Operations Engineer

Approved By (Signature) *David J. Mankiewicz* Name (Printed/ Typed) David J. Mankiewicz DATE JUL 14 2003

Title Office

Application approval does not warrant or certify that the applicant holds legal or equitable title to those rights in the subject lease which would entitle the applicant to conduct operations thereon.

Conditions of approval, if any, are attached.

Title 18 U.S.C. Section 1001 and Title 43 U.S.C. Section 1212, make it a crime for any person knowingly and willfully to make to any department or agency of the United States any false, fictitious or fraudulent statements or representations as to any matter within its jurisdiction.

*See Instructions On Reverse Side

This action is subject to technical and procedural review pursuant to 43 CFR 3165.3 and appeal pursuant to 43 CFR 3165.4

DRILLING OPERATIONS AUTHORIZED ARE
SUBJECT TO COMPLIANCE WITH ATTACHED
*GENERAL REQUIREMENTS

NMOC

District I
PO Box 1980, Hobbs, NM 88241-1980

District II
PO Drawer DD, Artesia, NM 88211-0719

District III
1000 Rio Brazos Rd., Aztec, NM 87410

District IV
PO Box 2088, Santa Fe, NM 87504-2088

State of New Mexico
Energy, Minerals & Natural Resources Department

OIL CONSERVATION DIVISION
PO Box 2088
Santa Fe, NM 87504-2088

Form C-102
Revised February 21, 1994
Instructions on back
Submit to Appropriate District Office
State Lease - 4 Copies
Fee Lease - 3 Copies

☐ AMENDED REPORT

WELL LOCATION AND ACREAGE DEDICATION PLAT

¹ API Number 30-045-31733	² Pool Code 71629	³ Pool Name BASIN FRUITLAND COAL
⁴ Property Code 28996	⁵ Property Name LEGEND COM	⁶ Well Number 1S
⁷ GRID No. 4838	⁸ Operator Name COLEMAN OIL & GAS, INC.	⁹ Elevation 6186'

¹⁰ Surface Location

UL or lot no.	Section	Township	Range	Lot Idn	Feet from the	North/South line	Feet from the	East/West line	County
E	25	26N	12W		1800	NORTH	1100	WEST	SAN JUAN

¹¹ Bottom Hole Location If Different From Surface

UL or lot no.	Section	Township	Range	Lot Idn	Feet from the	North/South line	Feet from the	East/West line	County
¹² Dedicated Acres 320.0 Acres - (N/2)					¹³ Joint or Infill		¹⁴ Consolidation Code		¹⁵ Order No.

NO ALLOWABLE WILL BE ASSIGNED TO THIS COMPLETION UNTIL ALL INTERESTS HAVE BEEN CONSOLIDATED
OR A NON-STANDARD UNIT HAS BEEN APPROVED BY THE DIVISION

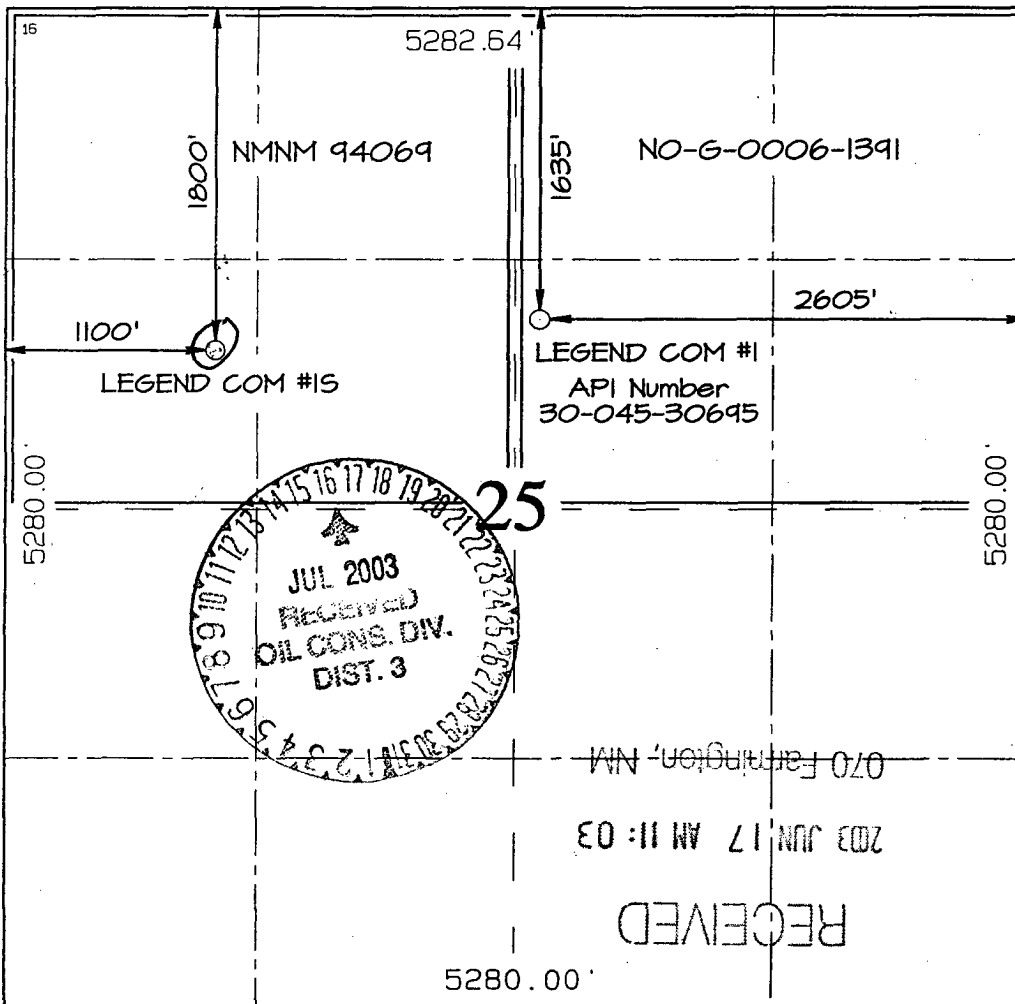

¹⁷ OPERATOR CERTIFICATION

I hereby certify that the information contained herein is true and complete to the best of my knowledge and belief

Michael T. Hanson
Signature
Michael T. Hanson
Printed Name
Engineer
Title
6/15/03
Date

¹⁸ SURVEYOR CERTIFICATION

I hereby certify that the well location shown on this plat was plotted from field notes of actual surveys made by me or under my supervision, and that the same is true and correct to the best of my belief.

Survey Date: JANUARY 24, 2003

Signature and Seal of Professional Surveyor



JASON C. EDWARDS
Certificate Number 15269

Tuesday, June 03, 2003

OPERATIONS PLAN

Well Name: Legend Com #1S
Location: 1800' FNL, 1100' FWL Section 25, T-26-N, R-12-W, NMPM
San Juan County, NM
Formation: Basin Fruitland Coal
Elevation: 6186' GL

Formation:	Top	Bottom	Contents
Nacimiento	Surface	245'	aquifer
Ojo Alamo	245'	335'	aquifer
Kirtland	335'	985'	
Fruitland	985'	1235'	gas
Basal Coal	1235'	1260'	gas
Pictured Cliffs	1260'	1410'	gas
Total Depth	1410'		

Drilling Contractor: Availability

Mud Program:

Interval	Type	Weight	Vis.	Fluid Loss
0 - 120'	Spud	8.4 - 9.0	40 - 50	no control
120 - 1410'	Non-dispersed	8.4 - 9.0	30 - 60	6cc or less

Logging Program: Porosity Log - Triple Litho Density W/ GR and CAL.
Induction Log - Array Induction W/ GR and SP

Coring Program: None

Casing Program:

Hole Size	Depth Interval	Csg. Size	Wt.	Grade
8 3/4"	0' - 120'	7"	20#	J-55 or K-55
6 1/4"	120' - 1410'	4 1/2"	10.5#	J-55 or K-55

Tubing Program:

0' - 1350'	2 3/8"	4.50#	J-55
------------	--------	-------	------

Float Equipment:

7" surface casing - saw tooth guide shoe. One Centralizer.

4 1/2" production casing - Cement guide shoe and self fill insert float collar. Place float one joint above shoe. Five centralizers spaced every other joint above shoe and five turbolizers every other joint from top of well.

Wellhead Equipment: 7" x 4 1/2" Braiden Head and 4 1/2" x 2 3/8" Tubing Head.
Independent Well Head assembly with a minimum rated working pressure of 1000 psig.

Cementing:**7" Surface Casing -**

Cement with 30 sacks Class "B" cement with 1/4# celloflake/sx and 2% calcium chloride (36.07 cu. ft. of slurry, 100% excess to circulate to surface). WOC 12 hrs. Test casing to 600 psi/30 minutes.

4 1/2" Production Casing -

Before cementing circulate hole with at least 1 1/2 hole volumes of mud. Precede cement with 30 bbls of fresh water. Lead with 110 sx (226.60 cu. ft.) of CI "B" with 2% metasilicate and 1/4#/sk celloflake. (Yield = 2.06 cu. ft. /sk; slurry weight = 12.5 PPG). Tail with 50 sx (59.00 cu. ft.) of CI "B" with 2% CaC1 and 1/4#/sk celloflake. (Yield = 1.18 cu. ft. / sk; slurry weight = 15.6 PPG). Total cement volume is 285.60 cu. ft. (100% excess on open hole, calculated on cement volumes). WOC 12 hrs. Test casing to 600 psi/30 minutes.

BOP and Tests:

Surface to surface TD – None

Surface TD to Total Depth – Annular or Double Ram type 2000 psi (minimum) double gate BOP stack (Reference Exhibit #1, #2 and #3). Prior to drilling out surface casing, test blind rams and casing to 600 psig for 30 minutes; all pipe rams and choke assembly to 600 psig for 15 minutes each.

From surface pipe to TD – choke manifold (Reference Exhibit #2).

Pipe rams will be actuated at least once each day and blind rams actuated once each trip to test proper functioning. An upper kelly cock valve with handle and drill string safety valves to fit each drill string will be maintained and available on the rig floor.

Additional information:

- The Basin Fruitland Coal formation will be completed.
- Anticipated pore pressure for the Basin Fruitland Coal is 100 psi.
- New casing will be utilized.
- Pipe movement (either rotation or reciprocation) will be done if hole conditions permit.

Date:

6/15/2003

Drilling Engineer:

Michael T. Janor