

UNITED STATES  
DEPARTMENT OF THE INTERIOR  
BUREAU OF LAND MANAGEMENT

**SUNDRY NOTICES AND REPORTS ON WELLS**  
*Do not use this form for proposals to drill or to re-enter an abandoned well. Use Form 3160-3 (APD) for such proposals.*

FORM APPROVED  
OMB No. 1004-0135  
Expires: January 31, 2004

5. Lease Serial No.

MMSF-079968

6. If Indian, Allottee or Tribe Name

7. If Unit or CA/Agreement, Name and/or No.

8. Well Name and No.

Ropco 10 #1

9. API Well No.

30-045-30344

10. Field and Pool, or Exploratory Area

Basin Fruitland Coal

11. County or Parish, State

San Juan

**12. CHECK APPROPRIATE BOX(ES) TO INDICATE NATURE OF NOTICE, REPORT, OR OTHER DATA**

TYPE OF SUBMISSION	TYPE OF ACTION			
<input checked="" type="checkbox"/> Notice of Intent	<input type="checkbox"/> Acidize	<input type="checkbox"/> Deepen	<input type="checkbox"/> Production (Start/Resume)	<input type="checkbox"/> Water Shut-Off
<input type="checkbox"/> Subsequent Report	<input type="checkbox"/> Alter Casing	<input type="checkbox"/> Fracture Treat	<input type="checkbox"/> Reclamation	<input type="checkbox"/> Well Integrity
<input type="checkbox"/> Final Abandonment Notice	<input type="checkbox"/> Casing Repair	<input type="checkbox"/> New Construction	<input type="checkbox"/> Recomplete	<input checked="" type="checkbox"/> Other Add a zone
	<input type="checkbox"/> Change Plans	<input type="checkbox"/> Plug and Abandon	<input type="checkbox"/> Temporarily Abandon	
	<input type="checkbox"/> Convert to Injection	<input type="checkbox"/> Plug Back	<input type="checkbox"/> Water Disposal	

3. Describe Proposed or Completed Operation (clearly state all pertinent details, including estimated starting date of any proposed work and approximate duration thereof. If the proposal is to deepen directionally or recompleat horizontally, give subsurface locations and measured and true vertical depths of all pertinent markers and zones. Attach the Bond under which the work will be performed or provide the Bond No. on file with BLM/BIA. Required subsequent reports shall be filed within 30 days following completion of the involved operations. If the operation results in a multiple completion or recompleat in a new interval, a Form 3160-4 shall be filed once testing has been completed. Final Abandonment Notices shall be filed only after all requirements, including reclamation, have been completed, and the operator has determined that the site is ready for final inspection.)

Richardson Operating Company proposes adding the Basin Fruitland Coal (71629) pursuant to New Mexico Oil Conservation Division Order No. R-8768-C.

Please find the attached plat for the subject well (Ropco 10 #1) with the original Basin Fruitland well in the dedicated acreage (Ropco 10 #2) depicted on the same plat.

RECEIVED  
2003 MAY 23 AM 10:30  
070 Farmington, NM

14. I hereby certify that the foregoing is true and correct  
Name (Printed/Typed)

Drew Carnes

Title Operations Manager

Signature

Date 12-31-02

**THIS SPACE FOR FEDERAL OR STATE OFFICE USE**

Approved by (Signature)

/s/ Jim Lovato

Name  
(Printed/Typed)

Title

Conditions of approval, if any, are attached. Approval of this notice does not warrant or certify that the applicant holds legal or equitable title to those rights in the subject lease which would entitle the applicant to conduct operations thereon.

Office

Date

Title 18 U.S.C. Section 1001 and Title 43 U.S.C. Section 1212, make it a crime for any person knowingly and willfully to make to any department or agency of the United States any false, fictitious or fraudulent statements or representations as to any matter within its jurisdiction.

(Continued on next page)

NMOCD

State of New Mexico  
Energy, Minerals & Mining Resources Department

Form C - 102

OIL CONSERVATION DIVISION  
2040 South Pacheco  
Santa Fe, NM 87505

200 NOV 30 AM 9:51

☒ AMENDED REPORT

WELL LOCATION AND ACREAGE DEDICATION PLAT

APA Number	Pool Code 71629/86620	Pool Name Basin Fruitland Coal & Twin Mounds Pictured Cliffs
Property Code	Property Name ROPCO	Well Number 10 - 1
OGRID No. 019219	Operator Name RICHARDSON OPERATING COMPANY	Elevation 5400'

Surface Location									
UL or Lot D	Sec. 10	Twp. 29. N.	Rge. 14 W.	Lot lch.	Feet from > .1272	North/South NORTH	Feet from > 673.	East/West WEST	County SAN JUAN

Bottom Hole Location If Different From Surface									
UL or Lot	Sec.	Twp.	Rge.	Lot lch.	Feet from >	North/South	Feet from >	East/West	County
Dedication	Joint ?	Consolidation	Order No.						

NO ALLOWABLE WILL ASSIGNED TO THIS COMPLETION UNTIL ALL INTERESTS HAVE BEEN CONSOLIDATED  
OR A NON-STANDARD UNIT HAS BEEN APPROVED BY THE DIVISION

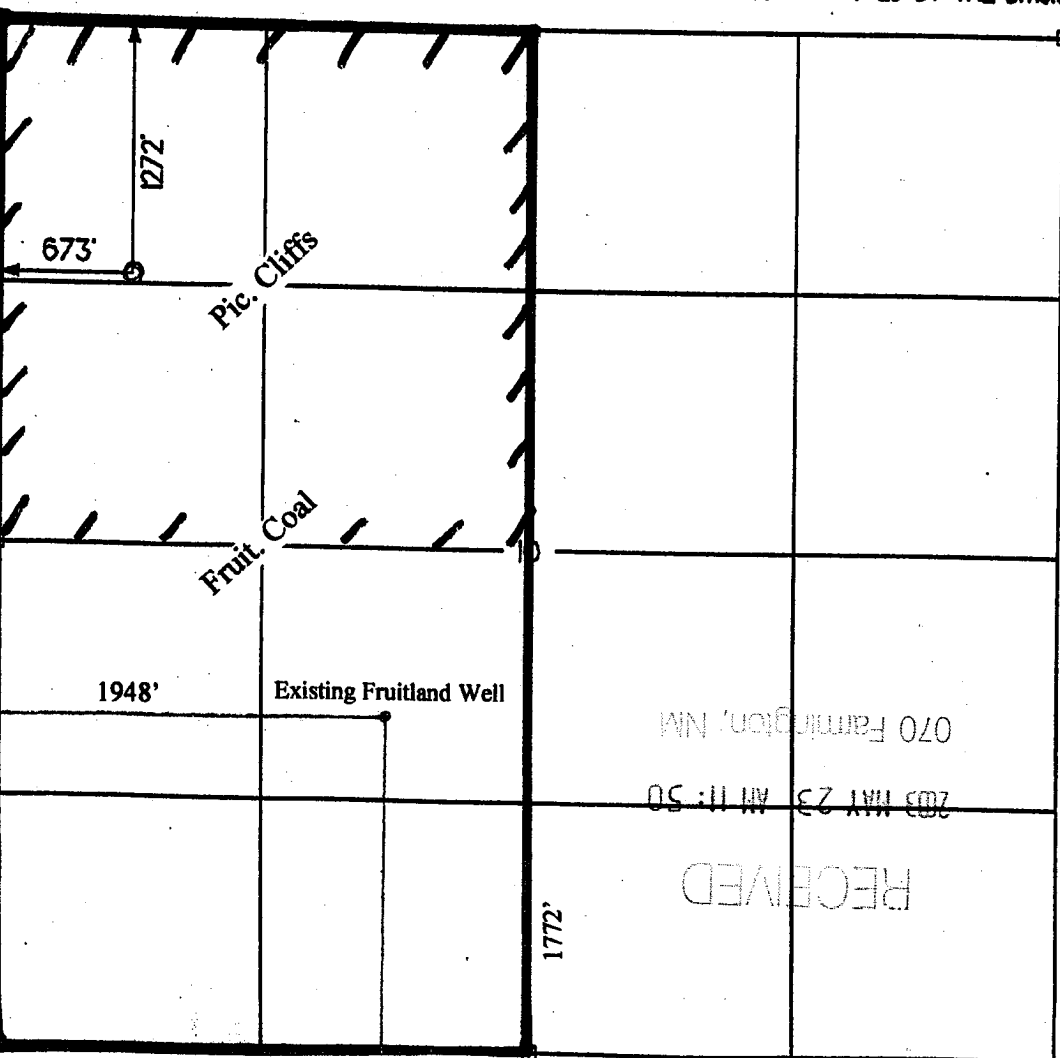

<b>OPERATOR CERTIFICATION</b>	
I hereby certify that the information contained herein is true and complete to the best of my knowledge and belief.	
Signature	<i>Brian Wood</i>
Printed Name	BRIAN WOOD
Title	CONSULTANT
Date	NOV. 25, 2000
<b>SURVEYOR CERTIFICATION</b>	
I hereby certify that the well location on this plat was plotted from field notes of actual surveys made by me or under my supervision, and that the same is true and correct to the best of my belief.	
Date of Survey	
Signature	<i>[Signature]</i>
Professional Surveyor	6844