

UNITED STATES  
DEPARTMENT OF THE INTERIOR  
BUREAU OF LAND MANAGEMENT

FORM APPROVED  
OMB No. 1004-0135  
Expires: January 31, 2004

**SUNDRY NOTICES AND REPORTS ON WELLS**  
*Do not use this form for proposals to drill or to re-enter an abandoned well. Use Form 3160-3 (APD) for such proposals.*

**SUBMIT IN TRIPLICATE - Other instructions on reverse side**

1. Type of Well

☐ Oil Well ☒ Gas Well ☐ Other

2. Name of Operator

Richardson Operating Company

3a. Address

3100 La Plata Highway Farmington, NM 87401

3b. Phone No. (include area code)

505-564-3100

4. Location of Well (Footage, Sec., T, R., M., or Survey Description)

1021' FNL & 1940' FWL

Sec. 27, T30N, R14W NMPM

5. Lease Serial No.

NMNM 97841

6. If Indian, Allottee or Tribe Name

7. If Unit or CA/Agreement, Name and/or No.

8. Well Name and No.

WF Federal 27 #2

9. API Well No.

30-045-30689

10. Field and Pool, or Exploratory Area

Basin Fruitland Coal

11. County or Parish, State

San Juan

**12. CHECK APPROPRIATE BOX(ES) TO INDICATE NATURE OF NOTICE, REPORT, OR OTHER DATA**

TYPE OF SUBMISSION

☒ Notice of Intent

☐ Subsequent Report

☐ Final Abandonment Notice

TYPE OF ACTION

☐ Acidize

☐ Alter Casing

☐ Casing Repair

☐ Change Plans

☐ Convert to Injection

☐ Deepen

☐ Fracture Treat

☐ New Construction

☐ Plug and Abandon

☐ Plug Back

☒ Production (Start/Resume)

☐ Reclamation

☐ Recomplete

☐ Temporarily Abandon

☐ Water Disposal

☐ Water Shut-Off

☐ Well Integrity

☒ Other Add a zone

3. Describe Proposed or Completed Operation (clearly state all pertinent details, including estimated starting date of any proposed work and approximate duration thereof. If the proposal is to deepen directionally or recompleat horizontally, give subsurface locations and measured and true vertical depths of all pertinent markers and zones. Attach the Bond under which the work will be performed or provide the Bond No. on file with BLM/BIA. Required subsequent reports shall be filed within 30 days following completion of the involved operations. If the operation results in a multiple completion or recompleat in a new interval, a Form 3160-4 shall be filed once testing has been completed. Final Abandonment Notices shall be filed only after all requirements, including reclamation, have been completed, and the operator has determined that the site is ready for final inspection.)

Richardson Operating Company proposes adding the Basin Fruitland Coal (71629) pursuant to New Mexico Oil Conservation Division Order No. R-8768-C.

Please find the attached plats for both the subject well (WF Federal 27 #2) and the original Basin Fruitland Coal well in this spacing unit (WF Federal 27 #3). The Basin Fruitland Coal allocation is defined on both plats (West 1/2 of section).

14. I hereby certify that the foregoing is true and correct

Name (Printed/Typed)

Drew Carnes

Title Operations Manager

Signature

Date 12-18-02

**THIS SPACE FOR FEDERAL OR STATE OFFICE USE**

Approved by (Signature)

/s/ Jim Lovato

Name

(Printed/Typed)

Title

Conditions of approval, if any, are attached. Approval of this notice does not warrant or certify that the applicant holds legal or equitable title to those rights in the subject lease which would entitle the applicant to conduct operations thereon.

Office

Date

Title 18 U.S.C. Section 1001 and Title 43 U.S.C. Section 1212, make it a crime for any person knowingly and willfully to make to any department or agency of the United States any false, fictitious or fraudulent statements or representations as to any matter within its jurisdiction.

(Continued on next page)

NMOC

RECEIVED  
2003 MAY 23 AM 10:31  
070 Farmington, NM

JUN - 2 2003

State of New Mexico  
Energy, Minerals & Mining Resources Department

Form C - 102

OIL CONSERVATION DIVISION 2001 JUN -5 PM 4: 01  
2040 South Pacheco  
Santa Fe, NM 87505

☐ AMENDED REPORT

WELL LOCATION AND ACREAGE DEDICATION PLAT

|                     |   |                            |   |
|---------------------|---|----------------------------|---|
| APA Number          |   | Pool Code<br>71629 & 78160 | Prd Name<br>Basin Fruitland Coal & Harper Hill PC |
| Property Code       | Property Name<br>WF FEDERAL                   |                            | Well Number<br>27 - 2                             |
| OGRID No.<br>019219 | Operator Name<br>RICHARDSON OPERATING COMPANY |                            | Elevation<br>5532                                 |

| Surface Location |            |               |               |          |                   |                      |                   |                   |                    |
|------------------|------------|---------------|---------------|----------|-------------------|----------------------|-------------------|-------------------|--------------------|
| UL or Lot<br>C   | Sec.<br>27 | Twp.<br>30-N. | Rge.<br>14-W. | Lot Lch. | Feet from<br>1021 | North/South<br>NORTH | Feet from<br>1940 | East/West<br>WEST | County<br>SAN JUAN |

| Bottom Hole Location If Different From Surface |         |               |      |           |           |             |           |           |        |
|--|---------|---------------|------|-----------|-----------|-------------|-----------|-----------|--------|
| UL or Lot                                      | Sec.    | Twp.          | Rge. | Lot Lch.  | Feet from | North/South | Feet from | East/West | County |
| Dedication                                     | Joint ? | Consolidation |      | Order No. |           |             |           |           |        |

NO ALLOWABLE WILL ASSIGNED TO THIS COMPLETION UNTL ALL INTERESTS HAVE BEEN CONSOLIDATED  
OR A NON-STANDARD UNIT HAS BEEN APPROVED BY THE DMSION

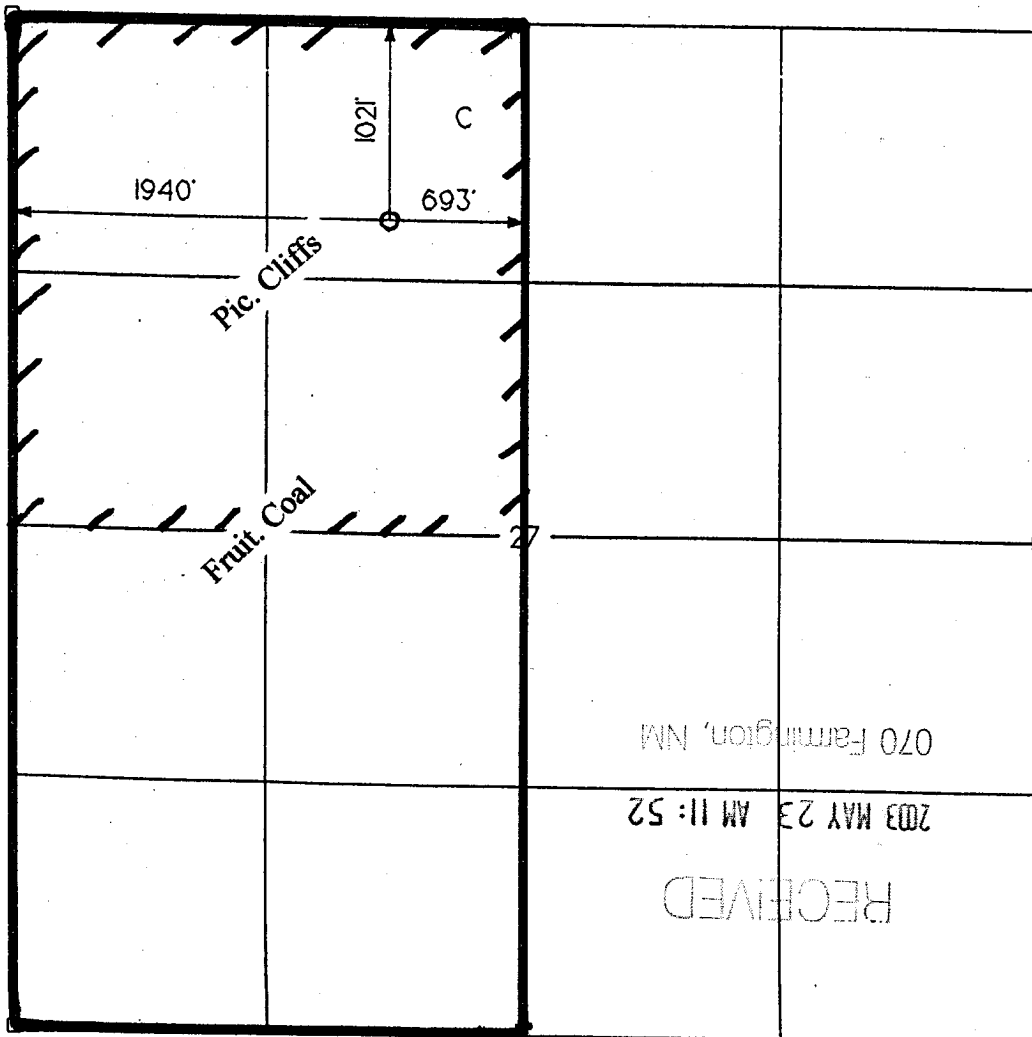

|   |  |
|---|--|
| <b>OPERATOR CERTIFICATION</b><br>I hereby certify that the information contained herein is true and complete to the best of my knowledge and belief.<br>Signature <i>Brian Wood</i><br>Printed Name <b>BRIAN WOOD</b><br>Title <b>CONSULTANT</b><br>Date <b>JUNE 2, 2001</b>  |  |
| <b>SURVEYOR CERTIFICATION</b><br>I hereby certify that the well location on this plat was plotted from field notes of actual surveys made by me or under my supervision, and that the same is true and correct to the best of my belief.<br>Date of Survey<br><b>17 JANUARY 2001</b><br>Signature and Seal of Professional Surveyor<br><i>[Signature]</i><br>6844<br>REGISTERED LAND SURVEYOR |  |

State of New Mexico  
Energy, Minerals & Mining Resources Department

Form C - 102

OIL CONSERVATION DIVISION  
2040 South Pacheco  
Santa Fe, NM 87505

☐ AMENDED REPORT

WELL LOCATION AND ACREAGE DEDICATION PLAT <sup>27</sup> 3: 06

|               |                              |                    |
|---------------|------------------------------|--------------------|
| APA Number    | Pool Code                    | Pool Name          |
|               | 71629 & 78160                | 070 FARMINGTON, NM |
| Property Code | Property Name                | Well Number        |
|               | WF FEDERAL                   | 27 - 3             |
| GRID No.      | Operator Name                | Elevation          |
| 019219        | RICHARDSON OPERATING COMPANY | 5500'              |

| Surface Location |      |       |       |         |           |             |           |           |          |
|------------------|------|-------|-------|---------|-----------|-------------|-----------|-----------|----------|
| UL or Lat        | Sec. | Twp.  | Rge.  | Lot Id. | Feet from | North/South | Feet from | East/West | County   |
| K                | 27   | 30 N. | 14 W. |         | 1775      | SOUTH       | 1400      | WEST      | SAN JUAN |

| Bottom Hole Location If Different From Surface |      |      |      |         |           |             |           |           |        |
|--|------|------|------|---------|-----------|-------------|-----------|-----------|--------|
| UL or Lat                                      | Sec. | Twp. | Rge. | Lot Id. | Feet from | North/South | Feet from | East/West | County |
|  |      |      |      |         |           |             |           |           |        |

|            |         |               |           |
|------------|---------|---------------|-----------|
| Dedication | Joint ? | Consolidation | Order No. |
|            |         |               |           |

NO ALLOWABLE WILL ASSIGNED TO THIS COMPLETION UNTIL ALL INTERESTS HAVE BEEN CONSOLIDATED  
OR A NON-STANDARD UNIT HAS BEEN APPROVED BY THE DIVISION

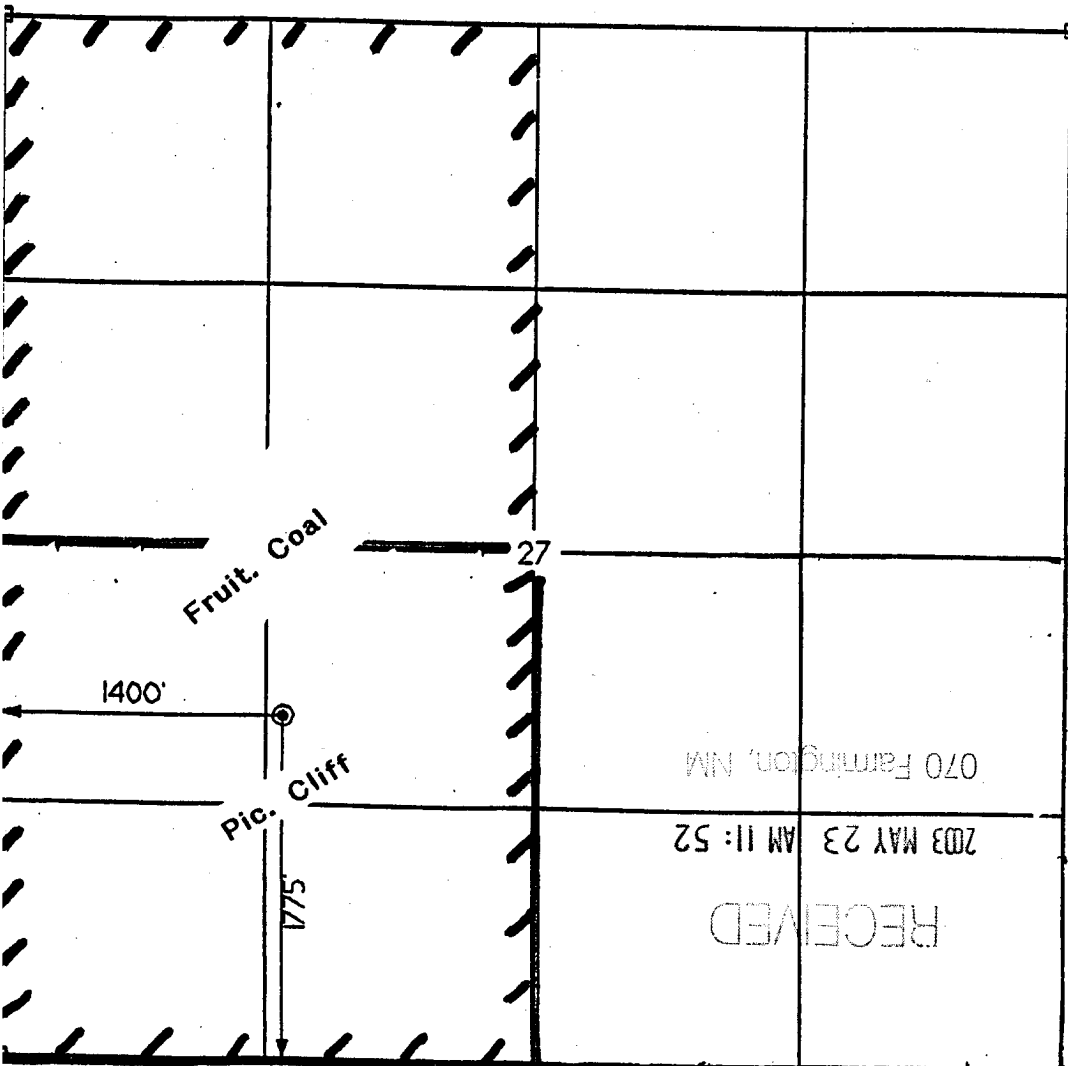

|  |  |
|--|--|
| <b>OPERATOR CERTIFICATION</b><br>I hereby certify that the information contained herein is true and complete to the best of my knowledge and belief.<br>Signature <i>Brian Wood</i>  |  |
| Printed Name<br><b>BRIAN WOOD</b>  |  |
| Title<br><b>CONSULTANT</b>   |  |
| Date<br><b>OCT. 7, 2000</b>  |  |
| <b>SURVEYOR CERTIFICATION</b><br>I hereby certify that the well location on this plat was plotted from field notes of actual surveys made by me or under my supervision, and that the same is true and correct to the best of my belief.<br>Date of Survey<br><b>JULY 2000</b> |  |
| Signature and Seal of Professional Surveyor<br>  |  |