

State of New Mexico

Energy, Minerals and Natural Resources

OIL CONSERVATION DIVISION

1220 South St. Francis Dr.
Santa Fe, NM 87505

SUNDRY NOTICES AND REPORTS ON WELLS (DO NOT USE THIS FORM FOR PROPOSALS TO DRILL OR TO DEEPEN OR PLUG BACK TO A DIFFERENT RESERVOIR. USE "APPLICATION FOR PERMIT" (FORM C-101) FOR SUCH PROPOSALS.)		WELL API NO. 30-039-29606
1. Type of Well: Oil Well <input type="checkbox"/> Gas Well <input checked="" type="checkbox"/> Other		5. Indicate Type of Lease STATE <input type="checkbox"/> FEE <input checked="" type="checkbox"/>
2. Name of Operator ConocoPhillips Company		6. State Oil & Gas Lease No.
3. Address of Operator 3401 E. 30TH STREET, FARMINGTON, NM 87402		7. Lease Name or Unit Agreement Name San Juan 29-6 Unit
4. Well Location Unit Letter <u>J</u> : <u>1800'</u> feet from the <u>South</u> line and <u>1600'</u> feet from the <u>East</u> line Section <u>20</u> Township <u>29N</u> Rng <u>6W</u> NMPM County <u>Rio Arriba</u>		8. Well Number 211A
11. Elevation (Show whether DR, RKB, RT, GR, etc.) 6421'		9. OGRID Number 217817
Pit or Below-grade Tank Application <input type="checkbox"/> or Closure <input type="checkbox"/>		10. Pool name or Wildcat Basin Fruitland Coal
Pit type <u>Drill</u> Depth to Groundwater <u>50-100'</u> Distance from nearest fresh water well <u>>1000'</u> Distance from nearest surface water <u>200-1000'</u> Pit Liner Thickness: <u>12</u> mil Below-Grade Tank: Volume <u>4,400</u> bbls; Construction Material <u>Synthetic</u>		

12. Check Appropriate Box to Indicate Nature of Notice, Report or Other Data

NOTICE OF INTENTION TO:

PERFORM REMEDIAL WORK ☐
 TEMPORARILY ABANDON ☐
 PULL OR ALTER CASING ☐
 PLUG AND ABANDON ☐
 CHANGE PLANS ☐
 MULTIPLE COMPL ☐

OTHER:

Drill Pit ☒

SUBSEQUENT REPORT OF:

REMEDIAL WORK ☐
 COMMENCE DRILLING OPNS. ☐
 CASING/CEMENT JOB ☐
 ALTERING CASING ☐
 P AND A ☐

OTHER: ☐

13. Describe proposed or completed operations. (Clearly state all pertinent details, and give pertinent dates, including estimated date of starting any proposed work). SEE RULE 1103. For Multiple Completions: Attach wellbore diagram of proposed completion or recompletion.

This drill pit was constructed in accordance with Rule 50 and as per COPC June 2005 General Pit Plan on file with NMOCD. Pit data was included during electronic submittal of original APD. COPC is submitting this C-103 in support of that data and to insure proper recording of pit applications.

I hereby certify that the information above is true and complete to the best of my knowledge and belief. I further certify that any pit or below-grade tank has been/will be constructed or closed according to NMOCD guidelines ☐, a general permit ☒ or an (attached) alternative OCD-approved plan ☐.

SIGNATURE Juanita Farrell TITLE Regulatory Specialist DATE 6/12/2006

Type or print name Juanita Farrell E-mail address: juanita.r.farrell@conocophillips.com Telephone No. 505-326-9597

For State Use Only

APPROVED BY Jerry Farrel TITLE DEPUTY OIL & GAS INSPECTOR, DIST. 4 DATE 6-7-2006

Conditions of Approval (if any):

CONOCOPHILLIPS COMPANY SAN JUAN 29-6 UNIT #211A
1800' FSL & 1600' FEL, SECTION 20, T29N, R6W, NMPM
RIO ARriba COUNTY, NEW MEXICO ELEVATION: 6421'

100' TOTAL ACCESS
 440' FEE: PAT SMITH
 210' RICHARD HODGSON

ACCESS
 700' (0-6%)

50' CONSTRUCTION ZONE

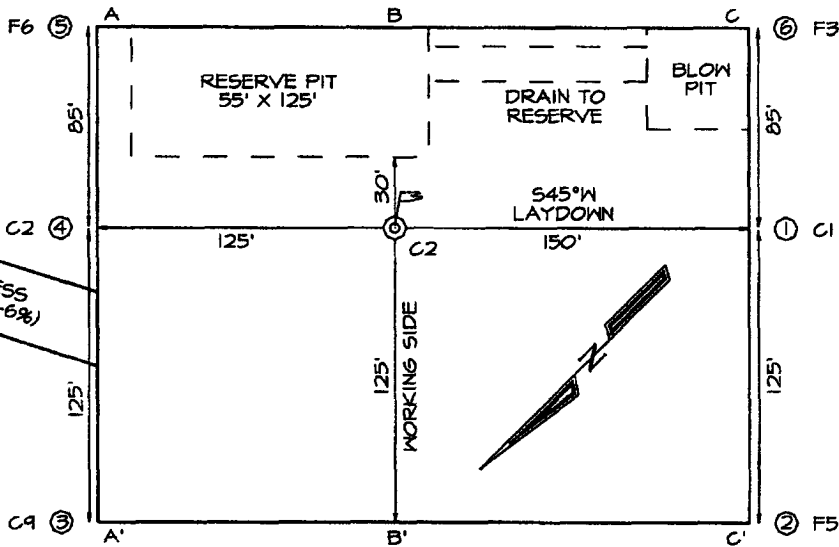

LATITUDE: 36.70888° N
LONGITUDE: 107.48218° W
 DATUM: NAD1927

PLAT NOTE:

FEE SURFACE OWNER
 Richard Hodgson

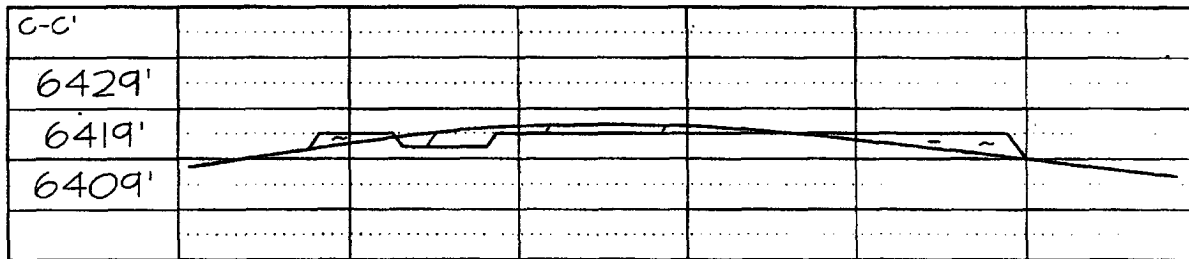
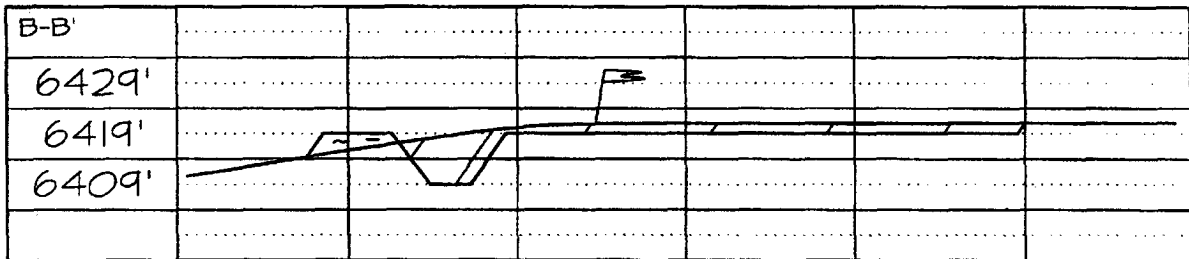
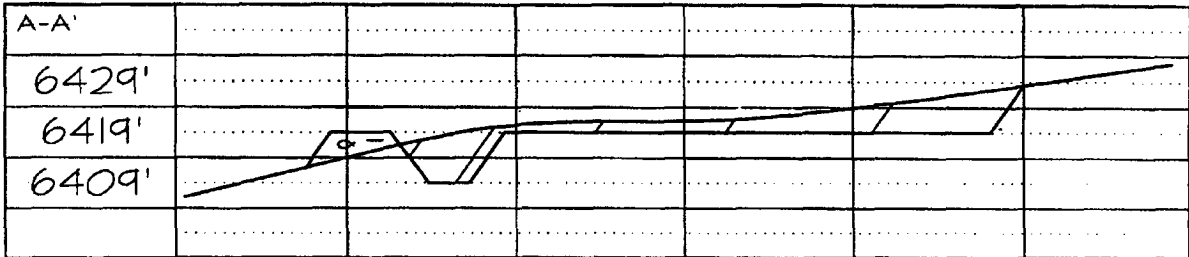

FILENAME: 24620JT

SHEET 2 OF 6

NCE SURVEYS, INC.

DRAWN BY: EDO

CHECKED BY: JCE