

Submit 3 Copies To Appropriate District
Office
District I
1625 N. French Dr., Hobbs, NM 88240
District II
1301 W. Grand Ave., Artesia, NM 88210
District III
1000 Rio Brazos Rd., Aztec, NM 87410
District IV
1220 S. St. Francis Dr., Santa Fe, NM 87505

State of New Mexico
Energy, Minerals and Natural Resources

Form C-103
May 27, 2004

OIL CONSERVATION DIVISION
1220 South St. Francis Dr.
Santa Fe, NM 87505

WELL API NO.	30-045-33334
5. Indicate Type of Lease	STATE <input type="checkbox"/> FEE <input checked="" type="checkbox"/>
6. State Oil & Gas Lease No.	
7. Lease Name or Unit Agreement Name	Newberry Com
8. Well Number	1C
9. OGRID Number	217817
10. Pool name or Wildcat	Blanco Mesaverde

SUNDRY NOTICES AND REPORTS ON WELLS
(DO NOT USE THIS FORM FOR PROPOSALS TO DRILL OR TO DEEPEN OR PLUG BACK TO A DIFFERENT RESERVOIR. USE "APPLICATION FOR PERMIT" (FORM C-101) FOR SUCH PROPOSALS.)

1. Type of Well: Oil Well <input type="checkbox"/> Gas Well <input checked="" type="checkbox"/> Other
2. Name of Operator ConocoPhillips Company
3. Address of Operator 3401 E. 30TH STREET, FARMINGTON, NM 87402
4. Well Location Unit Letter <u>A</u> : <u>1015'</u> feet from the <u>North</u> line and <u>660'</u> feet from the <u>East</u> line Section <u>5</u> Township <u>31N</u> Rng <u>12W</u> NMPM County <u>San Juan</u>
11. Elevation (Show whether DR, RKB, RT, GR, etc.) 5949'

Pit or Below-grade Tank Application	<input type="checkbox"/> or Closure <input type="checkbox"/>
Pit type <u>Drill</u> Depth to Groundwater <u>0-50'</u> Distance from nearest fresh water well <u>>1000'</u> Distance from nearest surface water <u>200-1000'</u>	
Pit Liner Thickness: <u>12</u> mil Below-Grade Tank: Volume <u>4,400</u> bbls; Construction Material <u>Synthetic</u>	

12. Check Appropriate Box to Indicate Nature of Notice, Report or Other Data

NOTICE OF INTENTION TO:		SUBSEQUENT REPORT OF:	
PERFORM REMEDIAL WORK <input type="checkbox"/>	PLUG AND ABANDON <input type="checkbox"/>	REMEDIAL WORK <input type="checkbox"/>	ALTERING CASING <input type="checkbox"/>
TEMPORARILY ABANDON <input type="checkbox"/>	CHANGE PLANS <input type="checkbox"/>	COMMENCE DRILLING OPNS. <input type="checkbox"/>	P AND A <input type="checkbox"/>
PULL OR ALTER CASING <input type="checkbox"/>	MULTIPLE COMPL <input type="checkbox"/>	CASING/CEMENT JOB <input type="checkbox"/>	
OTHER: <u>Drill Pit</u> <input checked="" type="checkbox"/>		OTHER: <input type="checkbox"/>	

13. Describe proposed or completed operations. (Clearly state all pertinent details, and give pertinent dates, including estimated date of starting any proposed work). SEE RULE 1103. For Multiple Completions: Attach wellbore diagram of proposed completion or recompletion.

This drill pit was constructed in accordance with Rule 50 and as per COPC June 2005 General Pit Plan on file with NMOCD. Pit data was included during electronic submittal of original APD. COPC is submitting this C-103 in support of that data and to insure proper recording of pit applications.

I hereby certify that the information above is true and complete to the best of my knowledge and belief. I further certify that any pit or below-grade tank has been/will be constructed or closed according to NMOCD guidelines ☐, a general permit ☒ or an (attached) alternative OCD-approved plan ☐.

SIGNATURE <u>Juanita Farrell</u>	TITLE <u>Regulatory Specialist</u>	DATE <u>6/12/2006</u>
Type or print name <u>Juanita Farrell</u>	E-mail address: <u>juanita.r.farrell@conocophillips.com</u>	Telephone No. <u>505-326-9597</u>
For State Use Only		
APPROVED BY <u>Jerry Farrell</u>	TITLE <u>DEPUTY OIL & GAS INSPECTOR, DIST. 5</u>	DATE <u>JUN 27 2006</u>
Conditions of Approval (if any):		

CONOCOPHILLIPS COMPANY NEWBERRY COM #1C
1015' FNL & 660' FEL, SECTION 5, T31N, R12W, NMPM
SAN JUAN COUNTY, NEW MEXICO ELEVATION: 5949'

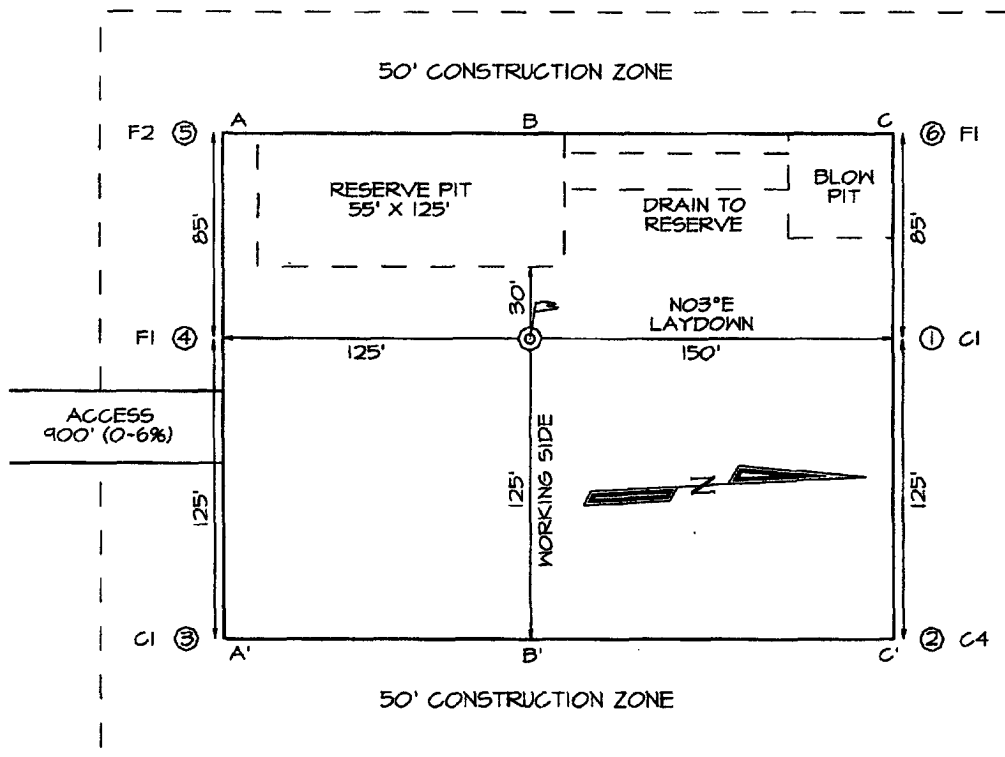

LATITUDE: 36.93224° N
LONGITUDE: 108.11132° W
 DATUM: NAD1927

PLAT NOTE:
 SURFACE OWNER
 Montoya Sheep and
 Cattle Company

