

Submit 3 Copies To Appropriate District Office  
District I  
1625 N. French Dr., Hobbs, NM 88240  
District II  
1301 W. Grand Ave., Artesia, NM 88210  
District III  
1000 Rio Brazos Rd., Aztec, NM 87410  
District IV  
1220 S. St. Francis Dr., Santa Fe, NM 87505

State of New Mexico  
Energy, Minerals and Natural Resources

Form C-103  
May 27, 2004

OIL CONSERVATION DIVISION  
1220 South St. Francis Dr.  
Santa Fe, NM 87505

WELL API NO. 30-045-33048
5. Indicate Type of Lease STATE <input type="checkbox"/> FEE <input type="checkbox"/>
6. State Oil & Gas Lease No. Federal NMNM 104606
7. Lease Name or Unit Agreement Name Juniper 8
8. Well Number #33
9. OGRID Number 004838
10. Pool name or Wildcat Basin Fruitland Coal

SUNDRY NOTICES AND REPORTS ON WELLS  
(DO NOT USE THIS FORM FOR PROPOSALS TO DRILL OR TO DEEPEN OR PLUG BACK TO A DIFFERENT RESERVOIR. USE "APPLICATION FOR PERMIT" (FORM C-101) FOR SUCH PROPOSALS.)

1. Type of Well: Oil Well ☐ Gas Well ☒ Other

2. Name of Operator  
Coleman Oil & Gas, Inc.

3. Address of Operator  
P.O. Drawer 3337 Farmington, NM 87499

4. Well Location

Unit Letter : J : 1700 feet from the South line and 1700 feet from the East line

Section 8 Township 24N Range 10W NMPM County San Juan

11. Elevation (Show whether DR, RKB, RT, GR, etc.)  
6771' GR.

Pit or Below-grade Tank Application ☒ or Closure ☒

Pit type: LINED EARTHEN Depth to Groundwater: 450 feet. Distance from nearest fresh water well 3 miles. Distance from nearest surface water 2600 feet.

Pit Liner Thickness: 12 mil Below-Grade Tank: Volume bbls: Construction Material

12. Check Appropriate Box to Indicate Nature of Notice, Report or Other Data

NOTICE OF INTENTION TO:

PERFORM REMEDIAL WORK ☐ PLUG AND ABANDON ☐  
TEMPORARILY ABANDON ☐ CHANGE PLANS ☐  
PULL OR ALTER CASING ☐ MULTIPLE COMPL ☐

OTHER: Construct and Reclaim Reserve Pit ☒

SUBSEQUENT REPORT OF:

REMEDIAL WORK ☐ ALTERING CASING ☐  
COMMENCE DRILLING OPNS. ☐ P AND A ☐  
CASING/CEMENT JOB ☐

OTHER: Reclaimed reserve pit ☐

13. Describe proposed or completed operations. (Clearly state all pertinent details, and give pertinent dates, including estimated date of starting any proposed work). SEE RULE 1103. For Multiple Completions: Attach wellbore diagram of proposed completion or recompletion.

Dig Earthen pit and line with 12 mil thick reinforced plastic for drilling reserve pit as per approved Federal APD. See attached.

Coleman Oil & Gas, Inc. plans on reclaiming reserve pit as soon as possible. Free liquids will be pulled and disposed of. Liner will be cut off at mud line. Excess plastic will be hauled off and disposed of. Reserve pit will be backfilled and reclaimed.

I hereby certify that the information above is true and complete to the best of my knowledge and belief. I further certify that any pit or below-grade tank has been/will be constructed and closed according to NMOCD guidelines ☒, a general permit ☐ or an (attached) alternative OCD-approved plan ☐.

SIGNATURE Michael T. Hanson TITLE: Operations Engineer DATE: September 13, 2006

Michael T. Hanson [cogmhanson@sprynet.com](mailto:cogmhanson@sprynet.com) (505) 327-0356

For State Use Only

APPROVED BY: Brandon Beck TITLE: DEPUTY OIL & GAS INSPECTOR, DIST. 3 DATE: SEP 14 2006  
Conditions of Approval (if any):

**COLEMAN OIL & GAS, INC. JUNIPER COM 8 #33**  
**1700' FSL & 1700' FEL, SECTION 8, T24N, R10W, NMPM**  
**SAN JUAN COUNTY, NEW MEXICO GROUND ELEVATION: 6771'**

**LATITUDE: 36°19'31"**  
**LONGITUDE: 107°54'54"**  
 DATUM: NAD1927

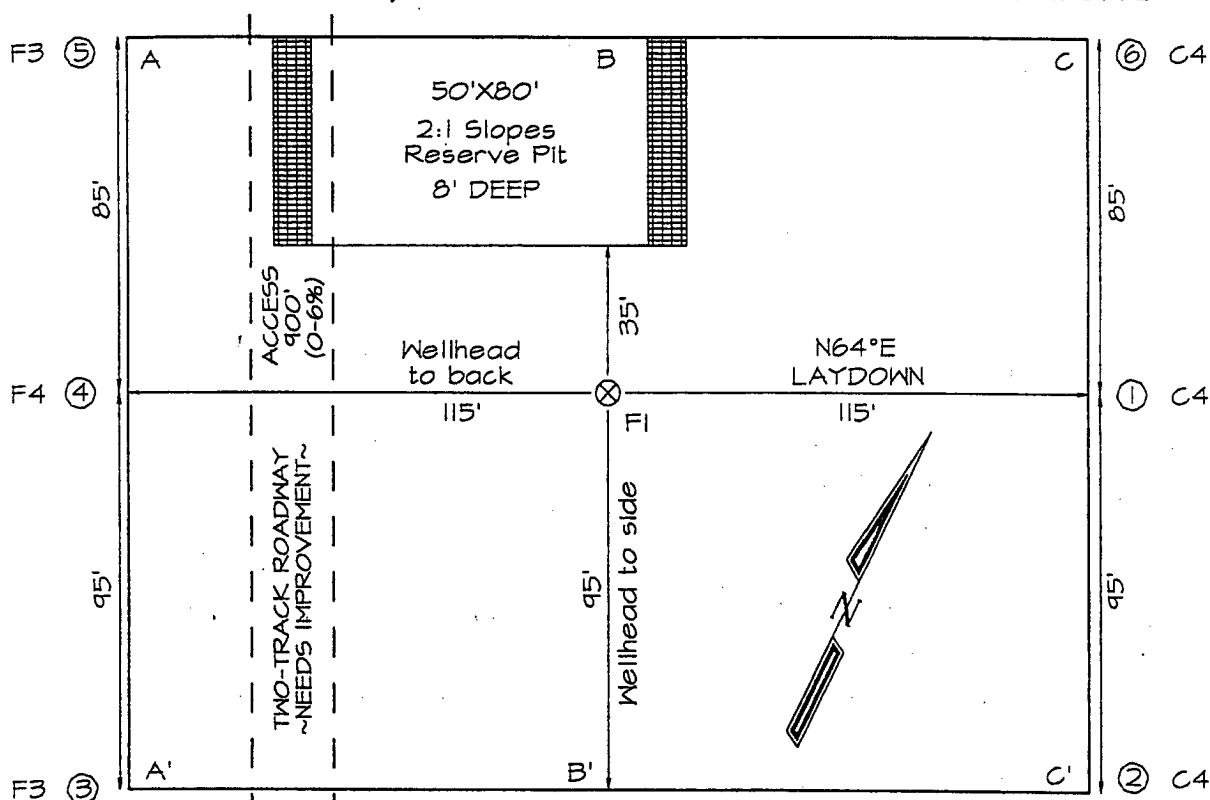

COLEMAN JUNIPER COM 8 #33 PRELIMINARY SURVEY

NTUA DOMESTIC WATER-LINE

A-A'						
6782'						
6772'						
6762'						

B-B'						
6782'						
6772'						
6762'						

C-C'						
6782'						
6772'						
6762'						

Note: Contractor should call One-Call for location of any marked or unmarked buried pipelines or cables on well pad and/or access road at least two (2) working days prior to construction

