

District I  
1625 N. French Dr., Hobbs, NM 88240  
District II  
1301 W. Grand Avenue, Artesia, NM 88210  
District III  
1000 Rio Brazos Road, Aztec, NM 87410  
District IV  
1220 S. St. Francis Dr., Santa Fe, NM 87505

State of New Mexico  
Energy Minerals and Natural Resources

Oil Conservation Division  
1220 South St. Francis Dr.  
Santa Fe, NM 87505

For drilling and production facilities, submit to  
appropriate NMOCD District Office.  
For downstream facilities, submit to Santa Fe  
office

Form C-144  
June 1, 2004

BOUND 10423107  
OIL CONS. DIV.  
DIST. 3

**Pit or Below-Grade Tank Registration or Closure**

Is pit or below-grade tank covered by a "general plan"? Yes ☒ No ☐

Type of action: Registration of a pit or below-grade tank ☐ Closure of a pit or below-grade tank ☒

Operator: BP America Production Company Telephone: (505)326-9200 e-mail address: \_\_\_\_\_  
Address: 200 Energy Ct. Farmington, NM 87401  
Facility or well name: GU R158E API #: 30045 25138 U/L or Qtr/Qtr G Sec 36 T 28 N R 13 W  
County: San Juan Latitude \_\_\_\_\_ Longitude \_\_\_\_\_ NAD: 1927 ☐ 1983 ☒  
Surface Owner: Federal ☐ State ☐ Private ☐ Indian ☒

<b>Pit</b> Type: Drilling <input type="checkbox"/> Production <input checked="" type="checkbox"/> Disposal <input type="checkbox"/> Workover <input type="checkbox"/> Emergency <input type="checkbox"/> Lined <input type="checkbox"/> Unlined <input type="checkbox"/> Liner type: Synthetic <input type="checkbox"/> Thickness _____ mil Clay <input type="checkbox"/> Pit Volume _____ bbl	<b>Below-grade tank</b> Volume: _____ bbl Type of fluid: <u>M</u> Construction material: <u>M</u> Double-walled, with leak detection? Yes <input type="checkbox"/> If not, explain why not. <u>M</u>
Depth to ground water (vertical distance from bottom of pit to seasonal high water elevation of ground water.)	Less than 50 feet (20 points) 50 feet or more, but less than 100 feet (10 points) 100 feet or more (0 points)
Wellhead protection area: (Less than 200 feet from a private domestic water source, or less than 1000 feet from all other water sources.)	Yes (20 points) No (0 points)
Distance to surface water: (horizontal distance to all wetlands, playas, irrigation canals, ditches, and perennial and ephemeral watercourses.)	Less than 200 feet (20 points) 200 feet or more, but less than 1000 feet (10 points) 1000 feet or more (0 points)
Ranking Score (Total Points)	

If this is a pit closure: (1) Attach a diagram of the facility showing the pit's relationship to other equipment and tanks. (2) Indicate disposal location: (check the onsite box if you are burying in place) onsite ☒ offsite ☐ If offsite, name of facility \_\_\_\_\_. (3) Attach a general description of remedial action taken including remediation start date and end date. (4) Groundwater encountered: No ☒ Yes ☐ If yes, show depth below ground surface \_\_\_\_\_ ft. and attach sample results. (5) Attach soil sample results and a diagram of sample locations and excavations.

Additional Comments:

See Attached Documentation

I hereby certify that the information above is true and complete to the best of my knowledge and belief. I further certify that the above-described pit or below-grade tank has been/will be constructed or closed according to NMOCD guidelines ☒, a general permit ☐, or an (attached) alternative OCD-approved plan ☐.

Date: 11/01/2005

Printed Name/Title Jeffrey C. Blagg, Agent

Signature Jeffrey C. Blagg

Your certification and NMOCD approval of this application/closure does not relieve the operator of liability should the contents of the pit or tank contaminate ground water or otherwise endanger public health or the environment. Nor does it relieve the operator of its responsibility for compliance with any other federal, state, or local laws and/or regulations.

Approval:

DEPUTY OIL & GAS INSPECTOR, DIST. 3

Printed Name/Title

Signature Bob Bell

Date:

JAN 23 2007

CLIENT: BP**BLAGG ENGINEERING, INC.**  
**P.O. BOX 87, BLOOMFIELD, NM 87413**  
**(505) 632-1199**LOCATION NO: 81165  
COCR NO: 12160  
HALL**FIELD REPORT: PIT CLOSURE VERIFICATION**PAGE No: 1 of 1LOCATION: NAME: GCU WELL#: 158E TYPE: SEP.  
QUAD/UNIT: G SEC: 36 TWP: 28N RNG: 13W PM: NM CNTY: ST ST: NM  
QTR/FOOTAGE: 1570'N/1760'E SWINE CONTRACTOR: FLINT (BEN)DATE STARTED: 3/11/03  
DATE FINISHED: \_\_\_\_\_  
ENVIRONMENTAL SPECIALIST: NVEXCAVATION APPROX. 14 FT. x 16 FT. x 10 FT. DEEP. CUBIC YARDAGE: 80DISPOSAL FACILITY: ON-SITE REMEDIATION METHOD: LANDFARM  
LAND USE: RANGE SURF. USE: FEE LEASE: NAVAJO FORMATION: DRFIELD NOTES & REMARKS: PIT LOCATED APPROXIMATELY 141 FT. 585W FROM WELLHEAD.DEPTH TO GROUNDWATER: >100' NEAREST WATER SOURCE: >1000' NEAREST SURFACE WATER: >1000'NMOCB RANKING SCORE: 0 NMOCB TPH CLOSURE STD: 5000 PPM**SOIL AND EXCAVATION DESCRIPTION:**OVM CALIB. READ. = 52.7 ppm  
OVM CALIB. GAS = 100 ppm RF = 0.52  
TIME: 2:35 am/pm DATE: 3/10/03SOIL TYPE: SAND / SILTY SAND / SILT / SILTY CLAY / CLAY / GRAVEL / OTHER \_\_\_\_\_SOIL COLOR: LT. TO MED. GRAYCOHESION (ALL OTHERS): NON COHESIVE / SLIGHTLY COHESIVE / COHESIVE / HIGHLY COHESIVECONSISTENCY (NON COHESIVE SOILS): LOOSE / FIRM / DENSE / VERY DENSE

PLASTICITY (CLAYS): NON PLASTIC / SLIGHTLY PLASTIC / COHESIVE / MEDIUM PLASTIC / HIGHLY PLASTIC

DENSITY (COHESIVE CLAYS &amp; SILTS): SOFT / FIRM / STIFF / VERY STIFF / HARD

MOISTURE: DRY / SLIGHTLY MOIST / MOIST / WET / SATURATED / SUPER SATURATEDDISCOLORATION/STAINING OBSERVED: YES / NO EXPLANATION - MAJORITY OF EXCAVATIONHC ODOR DETECTED: YES / NO EXPLANATION - EXCAVATED SOIL & OVM SAMPLESAMPLE TYPE: GRAB / COMPOSITE - # OF PTS. 1

ADDITIONAL COMMENTS: \_\_\_\_\_

RISK ASSESSED**SCALE****FIELD 418.1 CALCULATIONS**

SAMP. TIME	SAMP. ID	LAB NO.	WEIGHT (g)	mL FREON	DILUTION	READING	CALC. (ppm)

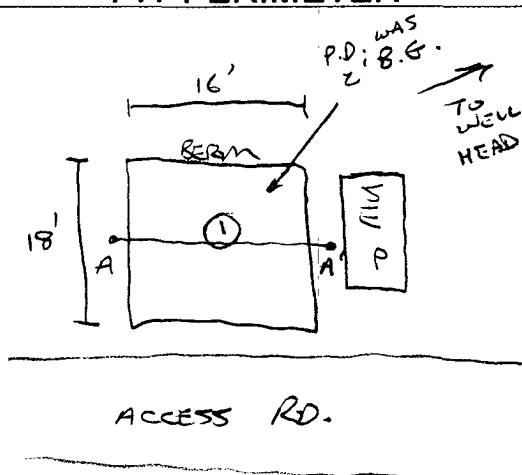
**PIT PERIMETER****OVM READING**

SAMPLE ID	FIELD HEADSPACE (ppm)
1 @ 12'	1667
2 @	
3 @	
4 @	
5 @	

**LAB SAMPLES**

SAMPLE ID	ANALYSIS	TIME
DE 12'	TPH (80158)	1150
"	BTEX (80218)	"
	TPH - <u>ASSESSED</u>	
	TOT BTEX - <u>FAILED</u>	

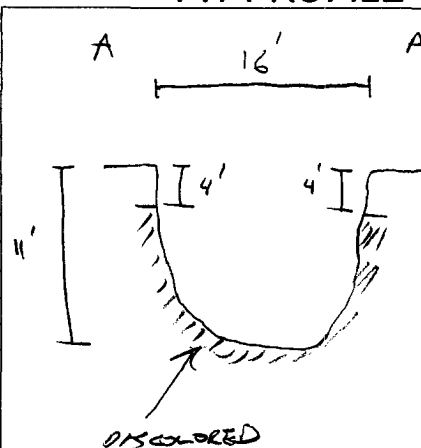
**PIT PROFILE**P.D. = PIT DEPRESSION; B.G. = BELOW GRADE; B = BELOW  
T.H. = TEST HOLE; ~ = APPROX.; T.B. = TANK BOTTOM

TRAVEL NOTES:

CALLOUT: 3/11/03 - MORN.ONSITE: 3/11/03 - MORN.

# Hall Environmental Analysis Laboratory

Date: 20-Mar-03

CLIENT: Blagg Engineering

Client Sample ID: #158E 1@12' Separator Pit

Lab Order: 0303077

Collection Date: 3/11/2003 11:50:00 AM

Project: GCU Lease

Lab ID: 0303077-02

Matrix: SOIL

Analyses	Result	Limit	Qual	Units	DF	Date Analyzed
<b>EPA METHOD 8015B: DIESEL RANGE</b>						Analyst: JMP
Diesel Range Organics (DRO)	250	5.0		mg/Kg	1	3/18/2003 10:06:21 PM
Motor Oil Range Organics (MRO)	ND	50		mg/Kg	1	3/18/2003 10:06:21 PM
Surr: DNOP	97.6	60-124		%REC	1	3/18/2003 10:06:21 PM
<b>EPA METHOD 8015B: GASOLINE RANGE</b>						Analyst: NB
Gasoline Range Organics (GRO)	1200	250		mg/Kg	50	3/17/2003 11:25:43 AM
Surr: BFB	156	74-118	S	%REC	50	3/17/2003 11:25:43 AM
<b>EPA METHOD 8021B: VOLATILES</b>						Analyst: NB
Benzene	ND	1.3		mg/Kg	50	3/17/2003 11:25:43 AM
Toluene	11	1.3		mg/Kg	50	3/17/2003 11:25:43 AM
Ethylbenzene	6.1	1.3		mg/Kg	50	3/17/2003 11:25:43 AM
Xylenes, Total	83	1.3		mg/Kg	50	3/17/2003 11:25:43 AM
Surr: 4-Bromofluorobenzene	99.7	74-118		%REC	50	3/17/2003 11:25:43 AM

**Qualifiers:**  
ND - Not Detected at the Reporting Limit  
J - Analyte detected below quantitation limits  
B - Analyte detected in the associated Method Blank  
\* - Value exceeds Maximum Contaminant Level

S - Spike Recovery outside accepted recovery limits  
R - RPD outside accepted recovery limits  
E - Value above quantitation range

612 E. Murray Drive  
Farmington, NM 87401

Off: (505) 327-1072

*iiná bá*

P.O. Box 2606  
Farmington, NM 87499

Fax: (505) 327-1496

## ANALYTICAL REPORT

Date: 26-Mar-03

CLIENT: Blagg Engineering

Work Order: 0303007

Project: BP - GCU #158E Separator Pit

Lab ID: 0303007-001A

Client Sample Info: BP - GCU #158E Separator Pit

Client Sample ID: 1 @ 12ft.

Collection Date: 3/11/2003 11:50:00 AM

Matrix: SOIL

Parameter	Result	PQL	Qual	Units	DF	Date Analyzed
<b>DIESEL RANGE ORGANICS</b>						Analyst: JEM
T/R Hydrocarbons: C10-C28	305	25.0		mg/Kg	1	3/25/2003
<b>GASOLINE RANGE ORGANICS</b>						Analyst: HNR
T/R Hydrocarbons: C6-C10	1620	180		mg/Kg	1000	3/22/2003
<b>AROMATIC VOLATILES BY GC/PID</b>						Analyst: JEM
Benzene	ND	1000		µg/Kg	1000	3/25/2003
Ethylbenzene	13000	1000		µg/Kg	1000	3/25/2003
m,p-Xylene	130000	2000		µg/Kg	1000	3/25/2003
o-Xylene	31000	1000		µg/Kg	1000	3/25/2003
Toluene	16000	2000		µg/Kg	1000	3/25/2003

Qualifiers: ND - Not Detected at the Practical Quantitation Limit  
J - Analyte detected below Practical Quantitation Limit  
B - Analyte detected in the associated Method Blank  
\* - Value exceeds Maximum Contaminant Level

S - Spike Recovery outside accepted recovery limits  
R - RPD outside accepted precision limits  
E - Value above Upper Quantitation Limit - UQL

CLIENT: BP**BLAGG ENGINEERING, INC.**  
P.O. BOX 87, BLOOMFIELD, NM 87413  
(505) 632-1199LOCATION NO: B1165C.O.C. NO: 13922**FIELD REPORT: LANDFARM/COMPOST PILE CLOSURE VERIFICATION**LOCATION: NAME: GCU WELL #: 158E PITS:  
QUAD/UNIT: G SEC: 36 TWP: 28N RNG: 13W PM: NM CNTY: ST ST: NM  
QTR/FOOTAGE: SW/NE CONTRACTOR:DATE STARTED: 7/25/05

DATE FINISHED: \_\_\_\_\_

ENVIRONMENTAL  
SPECIALIST: NV**SOIL REMEDIATION:**

80

REMEDATION SYSTEM: LANDFARM

APPROX. CUBIC YARDAGE: \_\_\_\_\_

LAND USE: RANGELIFT DEPTH (ft): 1-2**FIELD NOTES & REMARKS:**DEPTH TO GROUNDWATER: >100' NEAREST SURFACE WATER: >1,000'NEAREST WATER SOURCE: >1,000' NMOCD RANKING SCORE: 0 NMOCD TPH CLOSURE STD: 5,000 PPMSOIL TYPE: SAND SILTY SAND / SILT / SILTY CLAY / CLAY / GRAVEL / OTHER \_\_\_\_\_SOIL COLOR: VERY PALE TO DK. YELL. ORANGECOHESION (ALL OTHERS): NON COHESIVE SLIGHTLY COHESIVE / COHESIVE / HIGHLY COHESIVECONSISTENCY (NON COHESIVE SOILS): LOOSE FIRM DENSE / VERY DENSE

PLASTICITY (CLAYS): NON PLASTIC / SLIGHTLY PLASTIC / COHESIVE / MEDIUM PLASTIC / HIGHLY PLASTIC

DENSITY (COHESIVE CLAYS &amp; SILTS): SOFT / FIRM / STIFF / VERY STIFF / HARD

MOISTURE: DRY SLIGHTLY MOIST / MOIST / WET / SATURATED / SUPER SATURATEDCLOSEDDISCOLORATION/STAINING OBSERVED: YES / NO EXPLANATION - \_\_\_\_\_HC ODOR DETECTED: YES / NO EXPLANATION - \_\_\_\_\_SAMPLING DEPTHS (LANDFARMS): 8-18 (INCHES)SAMPLE TYPE: GRAB / COMPOSITE # OF PTS. 5

ADDITIONAL COMMENTS: \_\_\_\_\_

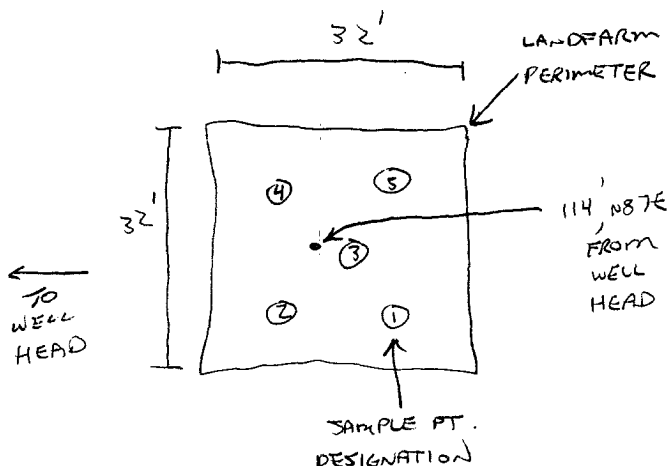
**SKETCH/SAMPLE LOCATIONS**OVM CALIB. READ. = 53.8 ppm  
OVM CALIB. GAS = 100 ppm RF = 0.52  
TIME: 10:15 am/pm DATE: 7/25/05**OVM RESULTS****LAB SAMPLES**

SAMPLE ID	FIELD HEADSPACE (ppm)	SAMPLE ID	ANALYSIS	TIME	RESULTS
LF-1	0.0	LF-1	TPH (80158)	1055	1.5

**SCALE**

P.C. - 3/11/03

TRAVEL NOTES: CALLOUT: N/AONSITE: 7/25/05

# ENVIROTECH LABS

PRACTICAL SOLUTIONS FOR A BETTER TOMORROW

## EPA METHOD 8015 Modified Nonhalogenated Volatile Organics Total Petroleum Hydrocarbons

Client:	Blagg / BP	Project #:	94034-010
Sample ID:	LF - 1	Date Reported:	07-29-05
Laboratory Number:	33843	Date Sampled:	07-25-05
Chain of Custody No:	13922	Date Received:	07-26-05
Sample Matrix:	Soil	Date Extracted:	07-27-05
Preservative:	Cool	Date Analyzed:	07-29-05
Condition:	Cool and Intact	Analysis Requested:	8015 TPH

Parameter	Concentration (mg/Kg)	Det. Limit (mg/Kg)
Gasoline Range (C5 - C10)	ND	0.2
Diesel Range (C10 - C28)	1.5	0.1
Total Petroleum Hydrocarbons	1.5	0.2

ND - Parameter not detected at the stated detection limit.

References: Method 8015B, Nonhalogenated Volatile Organics, Test Methods for Evaluating Solid Waste, SW-846, USEPA, December 1996.

Comments: GCU #158E Landfarm 5 Pt. Composite Sample.

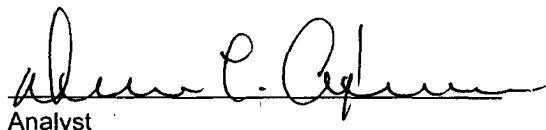
  
Analyst

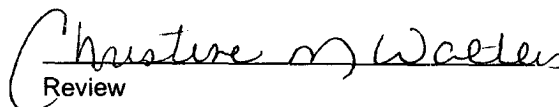
  
Review