

2A = 30-045-21990  
250 = 30-045-26936

3543

DATA SHEET FOR DEEP GROUND BED CATHODIC PROTECTION WELLS  
NORTHWESTERN NEW MEXICO

(Submit 3 copies to OCD Aztec Office)

Operator MERIDIAN OIL INC. Location: Unit D Sec. 3 Twp 30 Rng 9

Name of Well/Wells or Pipeline Serviced RIDDLE #2A, #250

cps 2092w

Elevation 6124' Completion Date 5/25/77 Total Depth 360' Land Type\* N/A

Casing, Sizes, Types & Depths N/A

If Casing is cemented, show amounts & types used N/A

If Cement or Bentonite Plugs have been placed, show depths & amounts used

N/A

Depths & thickness of water zones with description of water when possible:

Fresh, Clear, Salty, Sulphur, Etc. 220'

Depths gas encountered: N/A

Type & amount of coke breeze used: 61 SACKS

Depths anodes placed: 335', 325', 315', 295', 285', 275', 265', 255', 245'

Depths vent pipes placed: 360'

Vent pipe perforations: 200'

Remarks: gb #1

RECEIVED

MAY 31 1991

OIL CON. DIV.

DIST. 3

If any of the above data is unavailable, please indicate so. Copies of all logs, including Drillers Log, Water Analyses & Well Bore Schematics should be submitted when available. Unplugged abandoned wells are to be included.

\*Land Type may be shown: F-Federal; I-Indian; S-State; P-Fee.

If Federal or Indian, add Lease Number.

CATHODIC PROTECTION CONSTRUCTION REPORT

DATE: 1968

*Hand File*

Drilling Log/Attach Here

Completion Date *5-25-77*

Well Name <b>Riddle #2A</b>		Location <b>NW 3-30-9</b>		CPS No. <b>1101 w 2092</b>	
Type & Size Bit Used <b>6 3/4"</b>		Work Order No. <b>57030</b>			
Anode Hole Depth <b>360</b>	Drilling Rig Time <b>3:15</b>	Total Lbs. Core Used	Loss Circulation Material Used	No. Sacks Mud Used	
Anode Depth <b>335</b>	<b>325</b>	<b>315</b>	<b>305</b>	<b>295</b>	<b>285</b>
<b>275</b>	<b>265</b>	<b>255</b>	<b>245</b>	<b>235</b>	<b>225</b>
Anode Output (Amps) <b>3.6</b>	<b>3.7</b>	<b>4.7</b>	<b>4.8</b>	<b>4.0</b>	<b>2.9</b>
<b>3.4</b>	<b>1.8</b>	<b>2.8</b>	<b>2.3</b>	<b>2.1</b>	<b>2.3</b>
Anode Depth #11	#12	#13	#14	#15	#16
Anode Output (Amps) #11	#12	#13	#14	#15	#16
Total Circuit Resistance Volts <b>12</b>	Amps <b>16</b>	Ohms <b>0.75</b>	No. 6 C.P. Cable Used		No. 2 C.P. Cable Used

Remarks: *DRILLER SAID WOT @ 50'. WATER @ 220'. STARTED LOG @ 220'.  
NEXT AM. WATER STANDING @ 125. PERFORATED 200' OF 1" P.V.C. VENT  
PIPE. INSTALLED 360' VENT PIPE. SLURRIED 61 SPARKS OF COKE*

*Rectifier & Rectifier Pole  
needs to be set*

All Construction Completed

*W. A. Louth*

GROUND-BEE LOCATOR SKETCH

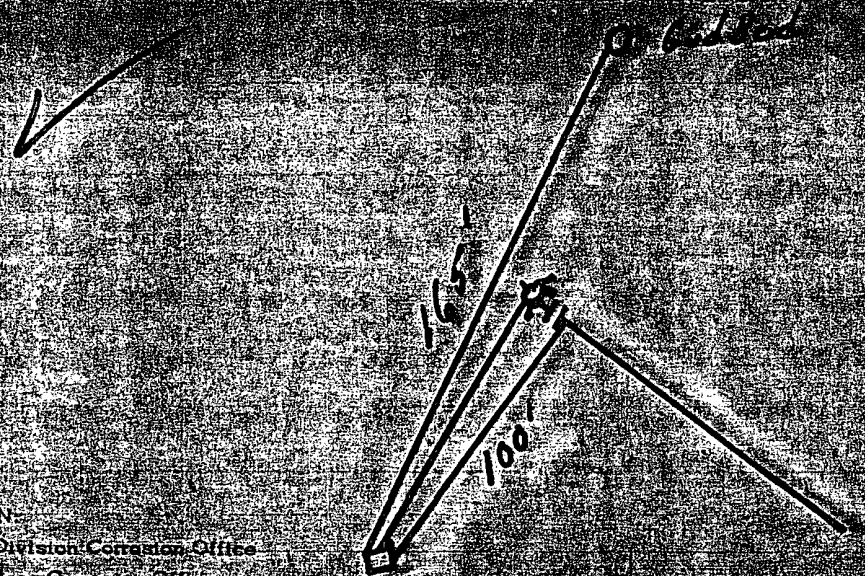

N

DISTRIBUTION:

- WHITE - Division Construction Office
- YELLOW - Area Construction Office
- PINK - Originator File



1701 W

we f @ 50

DRILLER SAND WATER @ 220  
STARTED INJ @ 220  
NEXT AM WATER STANDING @ 225  
PERSONATED 200' OF VERT. INC  
SLURRY 61 SACKS OF COKE

DRILLER SAID WATER @ 220			
STARTED INJ. @ 220			
NEXT AM WATER STAND @ 225			
PERFORATED 200' OF VERT. MC			
SLURRY 61 SACKS OF GEL			
100	⑧ 60 1.0		
	1.8 ⑧		
10	④ 70 1.3		
	1.6 ④		
20	⑩ 80 1.5		
1.0	1.4 ⑥		
30 1.9	⑤ 90 1.5		
2.1	1.8 ⑤	① 335 - 1.9	3.6
40 2.0	⑧ 00 2.0		
2.0	1.9 ④	② 325 - 2.3	3.7
50 2.1	② 10 1.9		
1.8	1.8 ③	③ 315 - 2.7	4.7
60 1.6	① 20 1.7		
1.3	1.6 ②	④ 305 - 2.9	4.8
70 1.0	① 30 1.5		
.7	1.2 ①	⑤ 295 - 2.6	4.0
80 .8	40 .9		
1.6	.8	⑥ 285 - 2.0	2.9
90 1.4	50 1.2		
1.1	335	⑦ 275 - 2.3	
200 .8	60		
.7		⑧ 265 - 1.7	1.8
10 .6			
.6		⑨ 255 - 1.3	2.8
20 .8			
.8		⑩ 245 - 1.3	2.3
30 .7			
.7			
40 .8			
1.5 ⑩		12V 16A	
50 1.1			
1.0 ①			



1997