

Office

Energy, Minerals and Natural Resources

May 27, 2004

District I

1625 N. French Dr., Hobbs, NM 88240

District II

1301 W. Grand Ave., Artesia, NM 88210

District III

1000 Rio Brazos Rd., Aztec, NM 87410

District IV

1220 S. St. Francis Dr., Santa Fe, NM 87505

## OIL CONSERVATION DIVISION

1220 South St. Francis Dr.

Santa Fe, NM 87505

WELL API NO.

30-039-30091

5. Indicate Type of Lease

STATE ☐FEE ☒

6. State Oil &amp; Gas Lease No.

7. Lease Name or Unit Agreement Name

San Juan 30-5 Unit

8. Well Number

#22F

9. OGRID Number

217817

10. Pool name or Wildcat

Blanco Mesaverde / Basin Dakota

SUNDRY NOTICES AND REPORTS ON WELLS  
(DO NOT USE THIS FORM FOR PROPOSALS TO DRILL OR TO DEEPEN OR PLUG BACK TO A  
DIFFERENT RESERVOIR. USE "APPLICATION FOR PERMIT" (FORM C-101) FOR SUCH  
PROPOSALS.)

1. Type of Well:

Oil Well ☐Gas Well ☒

Other

2. Name of Operator

ConocoPhillips Company

3. Address of Operator

3401 E. 30TH STREET, FARMINGTON, NM 87402

4. Well Location

Unit Letter I : 2200' feet from the South line and 900' feet from the East line  
Section 17 Township 30N Rng 5W NMPM County Rio Arriba

11. Elevation (Show whether DR, RKB, RT, GR, etc.)

6332'

Pit or Below-grade Tank Application

or Closure ☐

Pit type

New Drill

Depth to Groundwater

&lt;100'

Distance from nearest fresh water well

&gt;1000'

Distance from nearest surface water

&lt;1000'

Pit Liner Thickness:

12

mil

Below-Grade Tank:

Volume

bbls;

Construction Material

## 12. Check Appropriate Box to Indicate Nature of Notice, Report or Other Data

## NOTICE OF INTENTION TO:

PERFORM REMEDIAL WORK ☐TEMPORARILY ABANDON ☐PULL OR ALTER CASING ☐PLUG AND ABANDON ☐CHANGE PLANS ☐MULTIPLE COMPL ☐

OTHER:

New Drill

☒

## SUBSEQUENT REPORT OF:

REMEDIAL WORK ☐COMMENCE DRILLING OPNS. ☐CASING/CEMENT JOB ☐ALTERING CASING ☐P AND A ☐OTHER: ☐

13. Describe proposed or completed operations. (Clearly state all pertinent details, and give pertinent dates, including estimated date of starting any proposed work). SEE RULE 1103. For Multiple Completions: Attach wellbore diagram of proposed completion or recompletion.

RCVD MAR1'07

OIL CONS. DIV.

DIST. 3

New Drill, Lined:

ConocoPhillips proposes to construct a new drilling pit, an associated vent/flare pit and a pre-set mud pit (if required). Based on ConocoPhillips' interpretation of the Ecosphere's risk ranking criteria, the new drilling pit and pre-set mud pit will be lined pits as detailed in ConocoPhillips' General Plan dated June 2005 on file at the NMOCD office. A portion of the vent/flare pit will be designed to manage fluids and that portion will be lined as per the risk ranking criteria. ConocoPhillips anticipates closing these pits according to the November 1, 2004 Guidelines.

I hereby certify that the information above is true and complete to the best of my knowledge and belief. I further certify that any pit or below-grade tank has been/will be constructed or closed according to NMOCD guidelines ☐, a general permit ☒ or an (attached) alternative OCD-approved plan ☐.

SIGNATURE

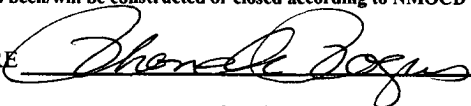

TITLE

Regulatory Technician

DATE

2/28/2007

Type or print name

Rhonda Rogers

E-mail address:

rogers@br-inc.com

Telephone No.

505-326-9518

For State Use Only

APPROVED BY

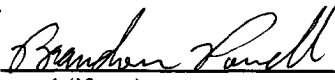

TITLE

DEPUTY OIL &amp; GAS INSPECTOR, DIST. 3

DATE

MAR 01 2007

Conditions of Approval (if any):

~ SURFACE OWNER ~  
 Fee Land: Armondo Espinosa

LATITUDE: 36°48.6852'N  
 LONGITUDE: 107°22.4455'W  
 DATUM: NAD1927

CONOCOPHILLIPS COMPANY SAN JUAN 30-5 UNIT #22F  
 2200' FSL & 900' FEL, SECTION 17, T30N, R5W, NMPM  
 RIO ARriba COUNTY, NEW MEXICO ELEVATION: 6332'

EDGE OF TOTAL DISTURBANCE (MARKED WITH STEEL T-POSTS)

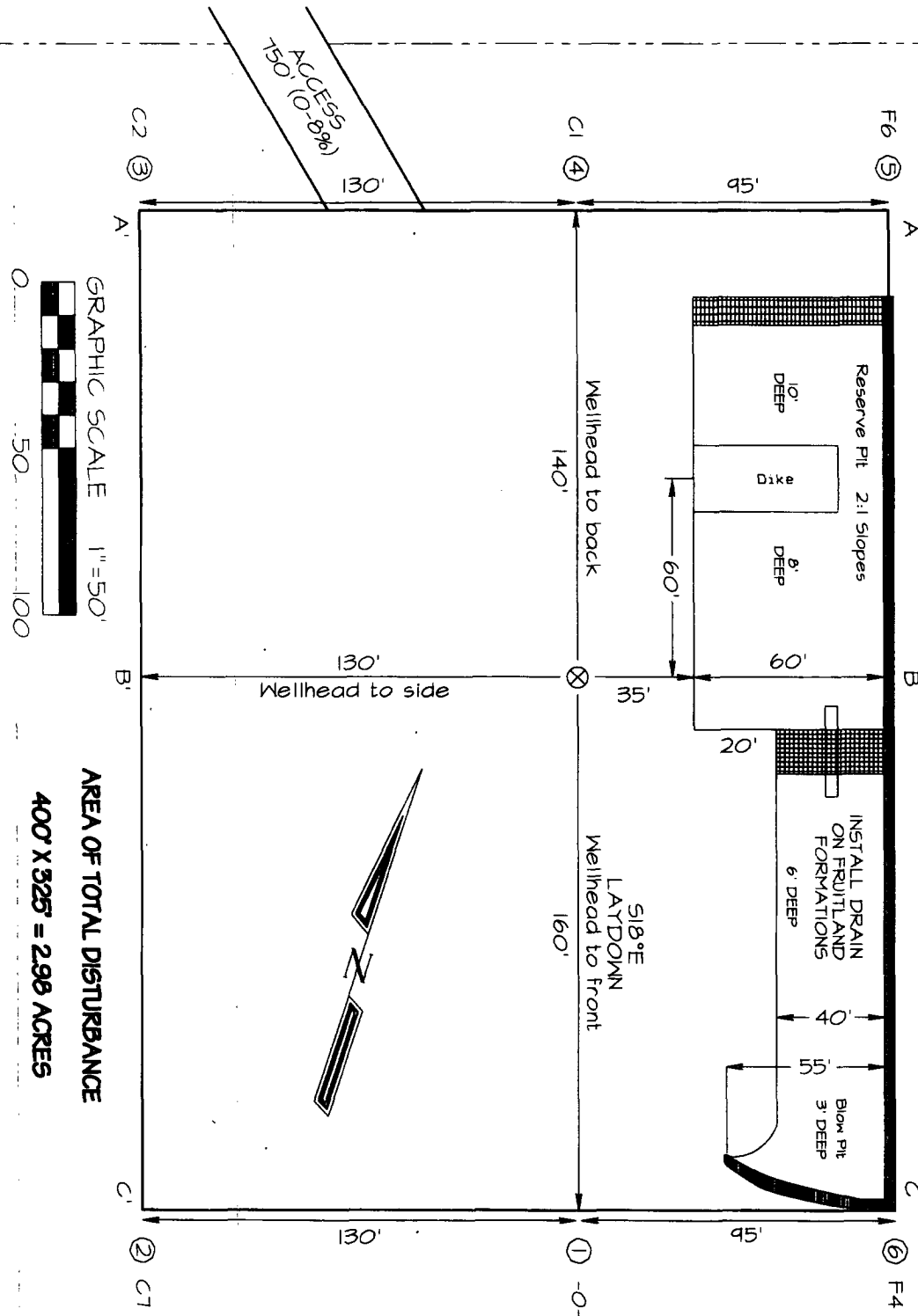

GRAPHIC SCALE 1"=50'  
 0 50 100

AREA OF TOTAL DISTURBANCE

400' X 325' = 2.98 ACRES

NCE SURVEYS IS NOT LIABLE FOR LOCATION OF UNDERGROUND UTILITIES OR PIPELINES.

CONTRACTOR SHOULD CONTACT ONE-CALL FOR LOCATION OF ANY MARKED OR UNMARKED UNDERGROUND UTILITIES OR PIPELINES ON WELLPAD AND/OR ACCESS ROAD AT LEAST TWO WORKING DAYS PRIOR TO CONSTRUCTION.

VERTICAL SCALE 1"=30'

C/LC/L

ANCE SURVEYS IS NOT LIABLE FOR LOCATION OF UNDERGROUND UTILITIES OR PIPELINES.

CONTRACTOR SHOULD CONTACT ONE-CALL FOR LOCATION OF ANY MARKED OR UNMARKED UNDERGROUND UTILITIES OR PIPELINES ON WELLPAD AND/OR ACCESS ROAD AT LEAST TWO WORKING DAYS PRIOR TO CONSTRUCTION.