

District I
1625 N. French Dr., Hobbs, NM 88240
District II
1301 W. Grand Avenue, Artesia, NM 88210
District III
1000 Rio Brazos Road, Aztec, NM 87410
District IV
1220 S. St. Francis Dr., Santa Fe, NM 87505

State of New Mexico
Energy Minerals and Natural Resources

Form C-144
March 12, 2004

Oil Conservation Division
1220 South St. Francis Dr.
Santa Fe, NM 87505

For drilling and production facilities, submit to appropriate NMOCD District Office.
For downstream facilities, submit to Santa Fe office

Pit or Below-Grade Tank Registration or Closure

Is pit or below-grade tank covered by a "general plan"? Yes ☒ No ☐

Type of action: Registration of a pit or below-grade tank ☐ Closure of a pit or below-grade tank ☒

Operator: <u>BP AMERICA PROD. CO.</u> Telephone: <u>(505) 326-9200</u>		
Address: <u>200 Energy Court, Farmington, NM 87410</u>		
Facility or well name: <u>ELLIOTT GC B #1</u>	API #: <u>30-045-08247</u>	U/L or Qtr/Qu <u>K</u> Sec <u>13</u> T <u>29N</u> R <u>9W</u>
County: <u>San Juan</u> Latitude <u>36.72256</u> Longitude <u>107.73456</u>	NAD: 1927 <input type="checkbox"/> 1983 <input checked="" type="checkbox"/> Surface Owner Federal <input checked="" type="checkbox"/> State <input type="checkbox"/> Private <input type="checkbox"/> Indian <input type="checkbox"/>	
Pit Type: Drilling <input type="checkbox"/> Production <input checked="" type="checkbox"/> Disposal <input type="checkbox"/> SEPARATOR Workover <input type="checkbox"/> Emergency <input type="checkbox"/> Lined <input type="checkbox"/> Unlined <input checked="" type="checkbox"/> Liner type: Synthetic <input type="checkbox"/> Thickness _____ mil Clay <input type="checkbox"/> Volume _____ bbl	Below-grade tank Volume: _____ bbl Type of fluid: _____ Construction material: <u>N/A</u> Double-walled with leak detection? Yes <input checked="" type="checkbox"/> If not, explain why not.	
Depth to ground water (vertical distance from bottom of pit to seasonal high water elevation of ground water.)	Less than 50 feet 50 feet or more, but less than 100 feet 100 feet or more	(20 points) (10 points) (0 points) <u>0</u>
Wellhead protection area: (Less than 200 feet from a private domestic water source, or less than 1000 feet from all other water sources.)	Yes No	(20 points) (0 points) <u>0</u>
Distance to surface water: (horizontal distance to all wetlands, playas, irrigation canals, ditches, and perennial and ephemeral watercourses.)	Less than 200 feet 200 feet or more, but less than 1000 feet 1000 feet or more	(20 points) (10 points) (0 points) <u>0</u>
Ranking Score (Total Points)		<u>0</u>

If this is a pit closure: (1) attach a diagram of the facility showing the pit's relationship to other equipment and tanks. (2) Indicate disposal location:

onsite ☒ offsite ☐ If offsite, name of facility _____. (3) Attach a general description of remedial action taken including remediation start date and end date. (4) Groundwater encountered: No ☒ Yes ☐ If yes, show depth below ground surface _____ ft. and attach sample results. (5) Attach soil sample results and a diagram of sample locations and excavations.

I hereby certify that the information above is true and complete to the best of my knowledge and belief. I further certify that the above-described pit or below-grade tank has been/will be constructed or closed according to NMOCD guidelines ☒, a general permit ☐, or an (attached) alternative OCD-approved plan ☒.

Date: 06/12/04

Printed Name/Title Jeff Blagg - P.E. # 11607

Signature Jeff Blagg

Your certification and NMOCD approval of this application/closure does not relieve the operator of liability should the contents of the pit or tank contaminate ground water or otherwise endanger public health or the environment. Nor does it relieve the operator of its responsibility for compliance with any other federal, state, or local laws and/or regulations.

Approval:

Date: MAR 14 2007

Printed Name/Title DEPUTY OIL & GAS INSPECTOR, DIST. IV

Signature Branch B. Bell

CLIENT: BP**BLAGG ENGINEERING, INC.**
P.O. BOX 87, BLOOMFIELD, NM 87413
(505) 632-1199LOCATION NO: B1324COCR NO: 11651**FIELD REPORT: PIT CLOSURE VERIFICATION**PAGE No: 1 of 1LOCATION: NAME: ELIOTT GC B WELL #: 1 TYPE: SEP.
QUAD/UNIT: K SEC: 13 TWP: 29N RNG: 9W PM: NM CNTY: SJ ST: NM
QTR/FOOTAGE: 1650'S/1550'W NE/SW CONTRACTOR: L+L (BRIAN)DATE STARTED: 1/22/04

DATE FINISHED:

ENVIRONMENTAL
SPECIALIST: NVEXCAVATION APPROX. 12 FT. x 12 FT. x 8 FT. DEEP. CUBIC YARDAGE: 30DISPOSAL FACILITY: ON-SITE REMEDIATION METHOD: LANDFARMLAND USE: RANGE - BURN LEASE: NM073159 FORMATION: MVFIELD NOTES & REMARKS: PIT LOCATED APPROXIMATELY 153 FT. N77W FROM WELLHEAD.DEPTH TO GROUNDWATER: >100' NEAREST WATER SOURCE: >1000' NEAREST SURFACE WATER: >1000'NMOCD RANKING SCORE: 0 NMOCD TPH CLOSURE STD: 5000 PPM**SOIL AND EXCAVATION DESCRIPTION:**OVM CALIB. READ. = 54.7 ppm
OVM CALIB. GAS = 100 ppm RF = 0.52
TIME: 12:30 am/pm DATE: 1/14/04SOIL TYPE: SAND / SILTY SAND / SILT / SILTY CLAY / CLAY / GRAVEL / OTHERSOIL COLOR: LT. GRAY TO BLACKCOHESION (ALL OTHERS): NON COHESIVE / SLIGHTLY COHESIVE / COHESIVE / HIGHLY COHESIVECONSISTENCY (NON COHESIVE SOILS): LOOSE / FIRM / DENSE / VERY DENSE

PLASTICITY (CLAYS): NON PLASTIC / SLIGHTLY PLASTIC / COHESIVE / MEDIUM PLASTIC / HIGHLY PLASTIC

DENSITY (COHESIVE CLAYS & SILTS): SOFT / FIRM / STIFF / VERY STIFF / HARD

MOISTURE: DRY / SLIGHTLY MOIST / MOIST / WET / SATURATED / SUPER SATURATEDDISCOLORATION/STAINING OBSERVED: YES NO EXPLANATION - CLOSEDHC ODOR DETECTED: YES NO EXPLANATION -SAMPLE TYPE: GRAB / COMPOSITE - # OF PTS. -

ADDITIONAL COMMENTS:

SCALE

0 FT

FIELD 418.1 CALCULATIONS

SAMP. TIME	SAMP. ID	LAB NO.	WEIGHT (g)	mL FREON	DILUTION	READING	CALC. (ppm)

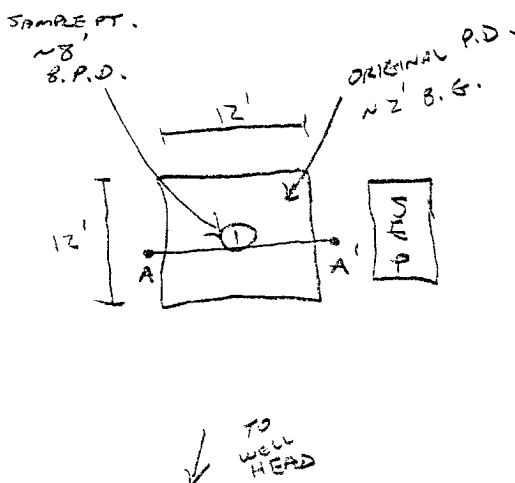
PIT PERIMETER**OVM
READING**

SAMPLE ID	FIELD HEADSPACE (ppm)
1 @ 10	1586
2 @	
3 @	
4 @	
5 @	

LAB SAMPLES

SAMPLE ID	ANALYSIS	TIME
0101	TPH (80153)	1009
"	STEX (80213)	"
BOTH PASSED		

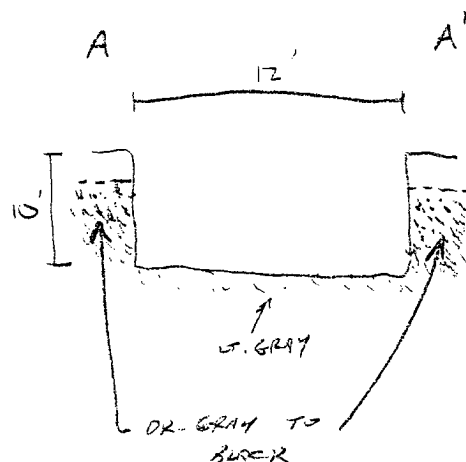
PIT PROFILEP.D. = PIT DEPRESSION; B.G. = BELOW GRADE; B = BELOW
T.H. = TEST HOLE; ~ = APPROX.; T.B. = TANK BOTTOM

TRAVEL NOTES:

CALLOUT: 1/21/04 - MORN. ONSITE: 1/22/04 - MORN. (SCHEDULED)

ENVIROTECH LABS

PRACTICAL SOLUTIONS FOR A BETTER TOMORROW

EPA METHOD 8015 Modified Nonhalogenated Volatile Organics Total Petroleum Hydrocarbons

Client:	Blagg / BP	Project #:	94034-010
Sample ID:	1 @ 10'	Date Reported:	01-26-04
Laboratory Number:	27608	Date Sampled:	01-22-04
Chain of Custody No:	11651	Date Received:	01-23-04
Sample Matrix:	Soil	Date Extracted:	01-23-04
Preservative:	Cool	Date Analyzed:	01-26-04
Condition:	Cool and Intact	Analysis Requested:	8015 TPH

Parameter	Concentration (mg/Kg)	Det. Limit (mg/Kg)
Gasoline Range (C5 - C10)	791	0.2
Diesel Range (C10 - C28)	160	0.1
Total Petroleum Hydrocarbons	951	0.2

ND - Parameter not detected at the stated detection limit.

References: Method 8015B, Nonhalogenated Volatile Organics, Test Methods for Evaluating Solid Waste, SW-846, USEPA, December 1996.

Comments: Elliott GC B #1 Separator Pit Grab Sample.

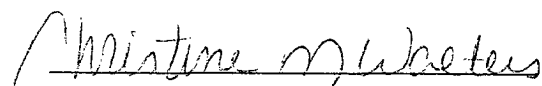
Analyst

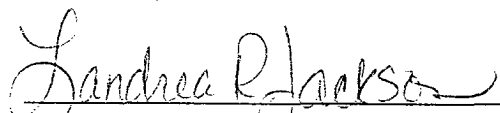
Review

ENVIROTECH LABS

PRACTICAL SOLUTIONS FOR A BETTER TOMORROW

EPA METHOD 8021 AROMATIC VOLATILE ORGANICS

Client:	Blagg / BP	Project #:	94034-010
Sample ID:	1 @ 10'	Date Reported:	01-26-04
Laboratory Number:	27608	Date Sampled:	01-22-04
Chain of Custody:	11651	Date Received:	01-23-04
Sample Matrix:	Soil	Date Analyzed:	01-26-04
Preservative:	Cool	Date Extracted:	01-23-04
Condition:	Cool & Intact	Analysis Requested:	BTEX

Parameter	Concentration (ug/Kg)	Det. Limit (ug/Kg)
Benzene	449	1.8
Toluene	2,200	1.7
Ethylbenzene	715	1.5
p,m-Xylene	2,730	2.2
o-Xylene	1,080	1.0
Total BTEX	7,170	

ND - Parameter not detected at the stated detection limit.

Surrogate Recoveries:	Parameter	Percent Recovery
	Fluorobenzene	99 %
	1,4-difluorobenzene	99 %
	Bromochlorobenzene	99 %

References: Method 5030B, Purge-and-Trap, Test Methods for Evaluating Solid Waste, SW-846, USEPA, December 1996.

Method 8021B, Aromatic Volatile Organics, Test Methods for Evaluating Solid Waste, SW-846, USEPA, December 1996.

Comments: Elliott GC B #1 Separator Pit Grab Sample.

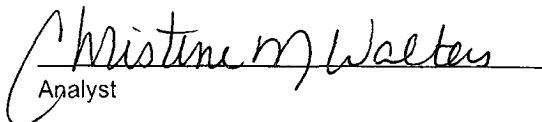
Analyst

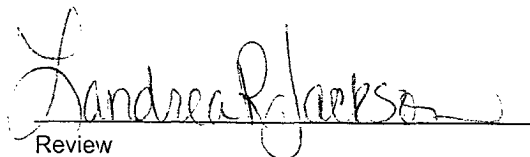
Review

CLIENT: BPBLAGG ENGINEERING, INC.
P.O. BOX 87, BLOOMFIELD, NM 87413
(505) 632-1199LOCATION NO: 81324C.O.C. NO: 14537

FIELD REPORT: LANDFARM/COMPOST PILE CLOSURE VERIFICATION

LOCATION: NAME: ELLIOT GC B WELL #: 1 PITS: D200, SEP.DATE STARTED: 3/21/06QUAD/UNIT: K SEC: 13 TWP: 29N RNG: 9W PM: NM CNTY: ST ST: NM

DATE FINISHED: _____

QTR/FOOTAGE: _____ NELSON CONTRACTOR: _____

ENVIRONMENTAL
SPECIALIST: NV

SOIL REMEDIATION:

45

REMEDICATION SYSTEM: LANDFARM

APPROX. CUBIC YARDAGE: _____

LAND USE: RANGE

LIFT DEPTH (ft): _____

1-2

FIELD NOTES & REMARKS:

DEPTH TO GROUNDWATER: >100'NEAREST SURFACE WATER: >1,000'NEAREST WATER SOURCE: >1,000'NMOCD RANKING SCORE: 0NMOCD TPH CLOSURE STD: 5,000 PPMSOIL TYPE: SAND/SILTY SAND SILT / SILTY CLAY / CLAY / GRAVEL / OTHER _____SOIL COLOR: MOD. BROWN

COHESION (ALL OTHERS): NON COHESIVE / SLIGHTLY COHESIVE / COHESIVE / HIGHLY COHESIVE

CONSISTENCY (NON COHESIVE SOILS): LOOSE / FIRM / DENSE / VERY DENSE

PLASTICITY (CLAYS): NON PLASTIC / SLIGHTLY PLASTIC / COHESIVE / MEDIUM PLASTIC / HIGHLY PLASTIC

DENSITY (COHESIVE CLAYS & SILTS): SOFT / FIRM / STIFF / VERY STIFF / HARD

MOISTURE: DRY / SLIGHTLY MOIST / MOIST / WET / SATURATED / SUPER SATURATED

CLOSEDDISCOLORATION/STAINING OBSERVED: YES NO EXPLANATION - DR. YEL. BROWN STAINING & LT. MED. GRAY TO BLACKHC ODOR DETECTED: YES NO EXPLANATION - WITHIN DISCOLORED PORTIONS ONLY (SAMPLE PTS. ②, ③, & ④)

SAMPLING DEPTHS (LANDFARMS): _____ (INCHES)

SAMPLE TYPE: GRAB / COMPOSITE # OF PTS. 5ADDITIONAL COMMENTS: DISCOLORATION OBSERVED IN MINOR AMOUNTS IN NOTED SAMPLE PTS.

SKETCH/SAMPLE LOCATIONS

N

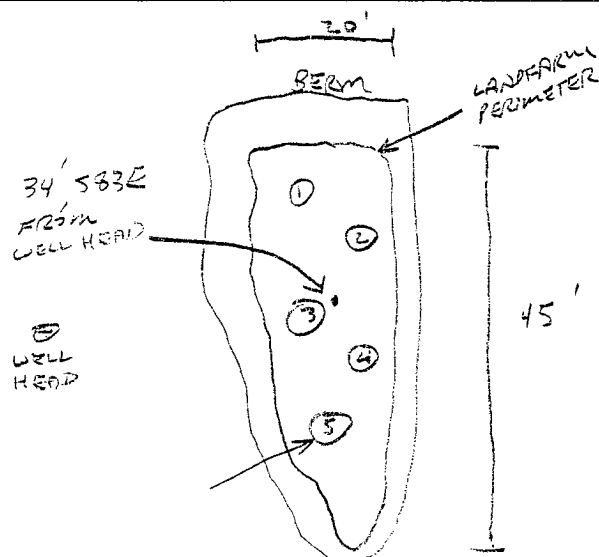
OVM CALIB. READ. = 53.9 ppm
OVM CALIB. GAS = 100 ppm RF = 0.52
TIME: 9:00 am/pm DATE: 3/21/06

OVM RESULTS

LAB SAMPLES

SAMPLE ID	FIELD HEADSPACE (ppm)
LF-1	1.6

SAMPLE ID	ANALYSIS	TIME	RESULTS
LF-1	TPH (SOILS)	0900	718

SCALE



0 FT

P.C. - 1/22/04

TRAVEL NOTES: CALLOUT: N/AONSITE: 3/21/06

ENVIROTECH LABS

PRACTICAL SOLUTIONS FOR A BETTER TOMORROW

EPA METHOD 8015 Modified Nonhalogenated Volatile Organics Total Petroleum Hydrocarbons

Client:	Blagg / BP	Project #:	94034-010
Sample ID:	LF - 1	Date Reported:	03-23-06
Laboratory Number:	36496	Date Sampled:	03-21-06
Chain of Custody No:	14537	Date Received:	03-21-06
Sample Matrix:	Soil	Date Extracted:	03-22-06
Preservative:	Cool	Date Analyzed:	03-23-06
Condition:	Cool and Intact	Analysis Requested:	8015 TPH

Parameter	Concentration (mg/Kg)	Det. Limit (mg/Kg)
Gasoline Range (C5 - C10)	4.0	0.2
Diesel Range (C10 - C28)	714	0.1
Total Petroleum Hydrocarbons	718	0.2

ND - Parameter not detected at the stated detection limit.

References: Method 8015B, Nonhalogenated Volatile Organics, Test Methods for Evaluating Solid Waste, SW-846, USEPA, December 1996.

Comments: Elliott GC B #1 Landfarm 5 Pt. Composite Sample.

Analyst

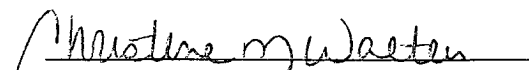
Review