

District I
1625 N. French Dr., Hobbs, NM 88240
District II
1301 W. Grand Avenue, Artesia, NM 88210
District III
1000 Rio Brazos Road, Aztec, NM 87410
District IV
1220 S. St. Francis Dr., Santa Fe, NM 87505

State of New Mexico
Energy Minerals and Natural Resources

Form C-144
June 1, 2004

Oil Conservation Division
1220 South St. Francis Dr.
Santa Fe, NM 87505

For drilling and production facilities, submit to appropriate NMOCD District Office.
For downstream facilities, submit to Santa Fe office

Pit or Below-Grade Tank Registration or Closure

Is pit or below-grade tank covered by a "general plan"? Yes ☐ No ☐

Type of action: Registration of a pit or below-grade tank ☐ Closure of a pit or below-grade tank ☒

Operator: <u>Coleman Oil & Gas, Inc</u> Telephone: <u>(505) 327-0356</u> e-mail address: <u>mhanson@cog-fmn.com</u>		
Address: <u>P.O. Drawer 3337, Farmington NM 87499</u>		
Facility or well name: <u>Juniper 17 #22</u> API #: <u>30-045-32727</u> U/L or Qtr/Qtr: <u>F</u> Sec: <u>17</u> T <u>24N</u> R <u>10W</u>		
County: <u>San Juan</u> Latitude: <u>36° 18' 55"</u> Longitude: <u>107° 55' 18"</u> NAD: 1927 <input checked="" type="checkbox"/> 1983 <input type="checkbox"/>		
Surface Owner: Federal <input checked="" type="checkbox"/> State <input type="checkbox"/> Private <input type="checkbox"/> Indian <input type="checkbox"/>		
RCVD FEB22'07		
Pit	Below-grade tank	
Type: Drilling <input checked="" type="checkbox"/> Production <input type="checkbox"/> Disposal <input type="checkbox"/>	Volume: _____ bbl Type of fluid: _____	
Workover <input type="checkbox"/> Emergency <input type="checkbox"/>	Construction material: _____ DIST. 3	
Lined <input checked="" type="checkbox"/> Unlined <input type="checkbox"/>	Double-walled, with leak detection? Yes <input type="checkbox"/> If not, explain why not.	
Liner type: Synthetic <input type="checkbox"/> Thickness: <u>12</u> mil Clay <input type="checkbox"/>		
Pit Volume: <u>1200</u> bbl		
Depth to ground water (vertical distance from bottom of pit to seasonal high water elevation of ground water.)	Less than 50 feet 50 feet or more, but less than 100 feet 100 feet or more	(20 points) (10 points) (0 points)
Wellhead protection area: (Less than 200 feet from a private domestic water source, or less than 1000 feet from all other water sources.)	Yes No	(20 points) (0 points)
Distance to surface water: (horizontal distance to all wetlands, playas, irrigation canals, ditches, and perennial and ephemeral watercourses.)	Less than 200 feet 200 feet or more, but less than 1000 feet 1000 feet or more	(20 points) (10 points) (0 points)
	Ranking Score (Total Points)	0 points

If this is a pit closure: (1) Attach a diagram of the facility showing the pit's relationship to other equipment and tanks. (2) Indicate disposal location: (check the onsite box if you are burying in place) onsite ☒ offsite ☐ If offsite, name of facility Juniper 17 #22. (3) Attach a general description of remedial action taken including remediation start date and end date. (4) Groundwater encountered: No ☒ Yes ☐ If yes, show depth below ground surface _____ ft. and attach sample results. (5) Attach soil sample results and a diagram of sample locations and excavations.

Additional Comments:
Free liquids were pulled and disposed of. Liner was cut off at mud line, hauled off and disposed of. Reserve pit was backfilled and reclaimed.

I hereby certify that the information above is true and complete to the best of my knowledge and belief. I further certify that the above-described pit or below-grade tank has been/will be constructed or closed according to NMOCD guidelines ☒, a general permit ☐, or an (attached) alternative OCD-approved plan ☐.

Date: February 21, 2007

Printed Name/Title: Michael T. Hanson / Operations Engineer

Signature: Michael T. Hanson

Your certification and NMOCD approval of this application/closure does not relieve the operator of liability should the contents of the pit or tank contaminate ground water or otherwise endanger public health or the environment. Nor does it relieve the operator of its responsibility for compliance with any other federal, state, or local laws and/or regulations.

Approval:

Printed Name/Title: DEPUTY OIL & GAS INSPECTOR, DIST. 3

Signature: [Signature]

Date: FEB 22 2007

COLEMAN OIL & GAS, INC. JUNIPER #22-17
 1830' FNL & 1655' FWL, SECTION 17, T24N, R10W
 NMPM, SAN JUAN COUNTY, NEW MEXICO
 GROUND ELEVATION: 6686'

LATITUDE: 36°18'55"
 LONGITUDE: 107°55'18"
 DATUM: NAD1927

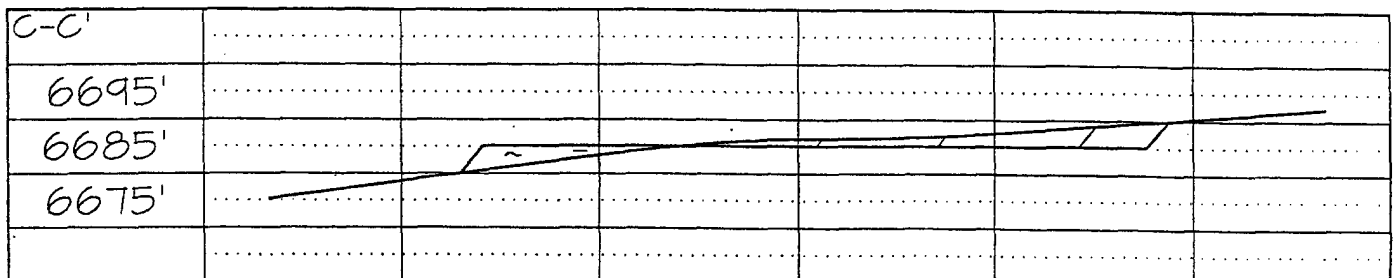
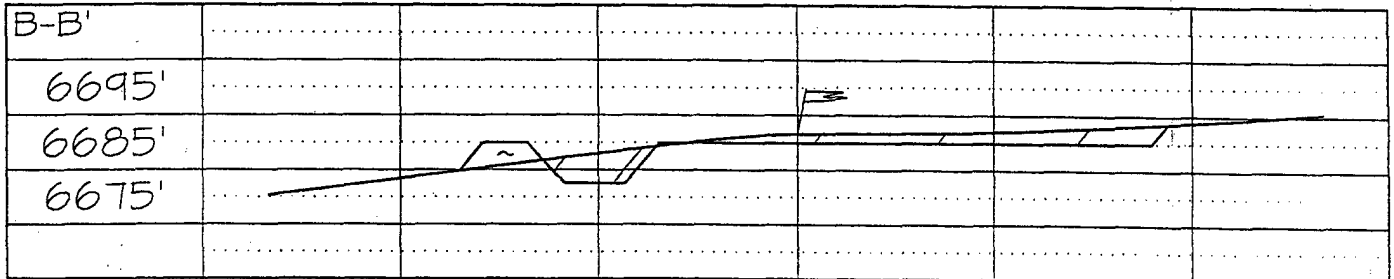
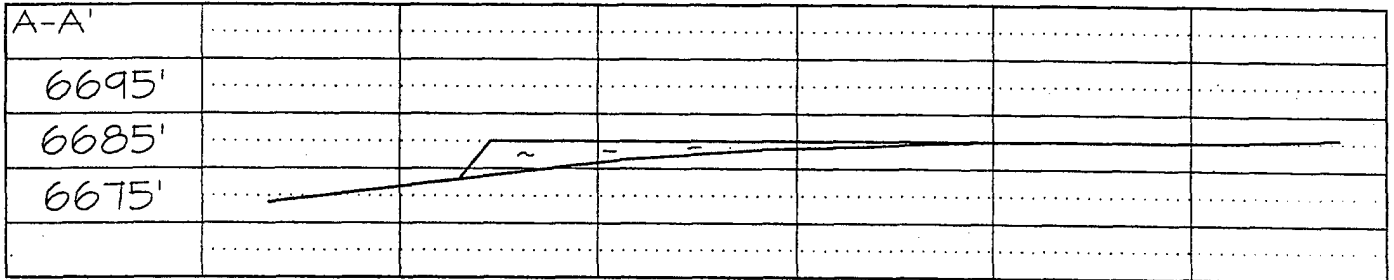
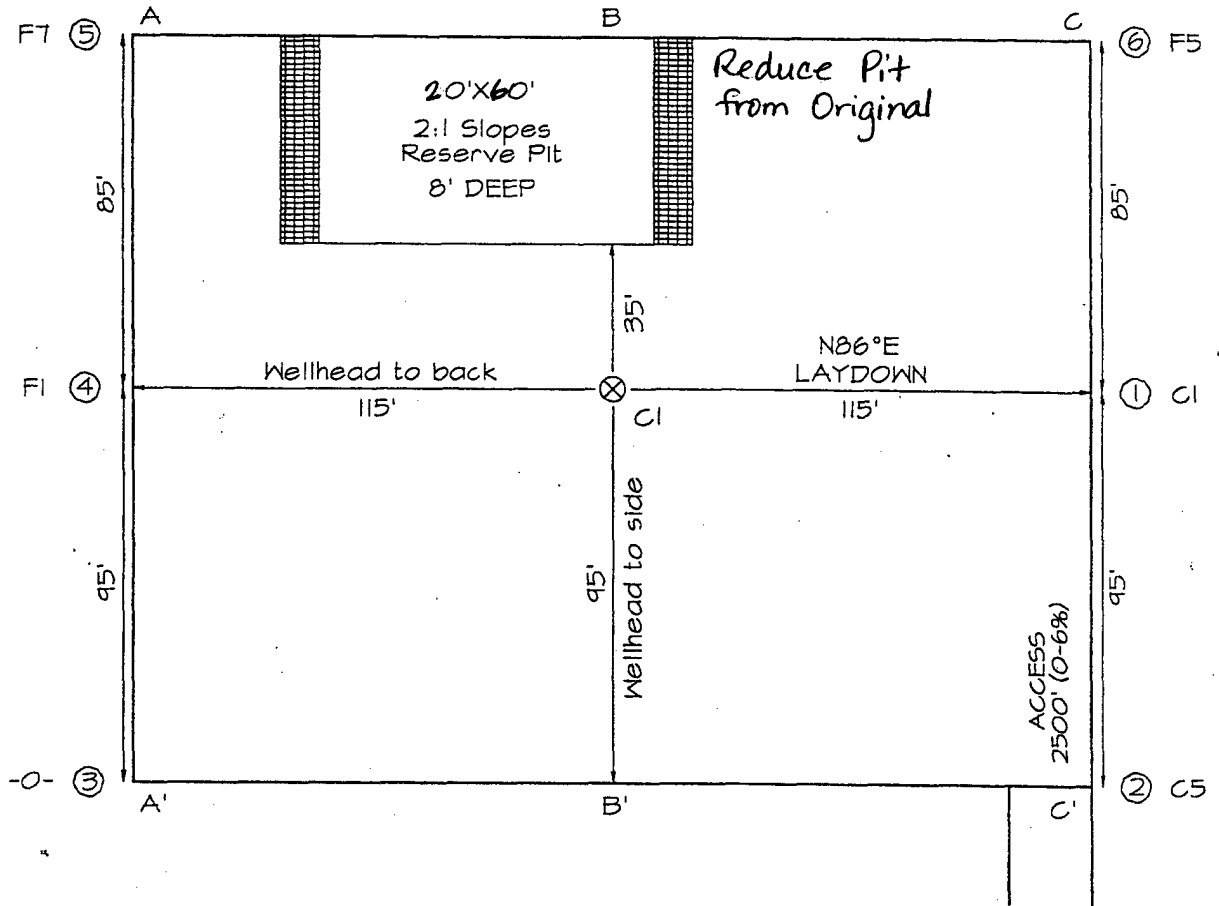

Note: Contractor should call One-Call for location of any marked or unmarked buried pipelines or cables on well pad and/or access road at least two (2) working days prior to construction