

UNITED STATES
DEPARTMENT OF THE INTERIOR
BUREAU OF LAND MANAGEMENT

RCVD MAR 9 '07
OIL CONS. DIV.
DIST. 3

APPLICATION FOR PERMIT TO DRILL, DEEPEN, OR PLUG BACK

1a. Type of Work DRILL	2007 FEB 20 PM 3:59 RECEIVED BLM 210 FARMINGTON NM	5. Lease Number NM-011393 Unit Reporting Number
1b. Type of Well GAS		6. If Indian, All. or Tribe
2. Operator BURLINGTON RESOURCES Oil & Gas Company, LP		7. Unit Agreement Name
3. Address & Phone No. of Operator PO Box 4289, Farmington, NM 87499 (505) 326-9700		8. Farm or Lease Name Cleveland 9. Well Number #2208
4. Location of Well Unit D (NWNW), 745' FNL & 845' FWL, Latitude 36° 33.9301 N Longitude 107° 47.9452 W		10. Field, Pool, Wildcat Basin Fruitland Coal 11. Sec., Twn, Rge, Mer. (NMPM) D Sec. 21, T27N, R9W API # 30-045-34179
14. Distance in Miles from Nearest Town 26 miles/Bloomfield	12. County San Juan	13. State NM
15. Distance from Proposed Location to Nearest Property or Lease Line 745'		
16. Acres in Lease	17. Acres Assigned to Well 320 - (N/2)	
18. Distance from Proposed Location to Nearest Well, Drig, Compl, or Applied for on this Lease		
19. Proposed Depth 2439'	20. Rotary or Cable Tools Rotary	
21. Elevations (DF, FT, GR, Etc.) 6325' GL	22. Approx. Date Work will Start	
23. Proposed Casing and Cementing Program See Operations Plan attached		
24. Authorized by: <u>Rhonda Rogers</u> Rhonda Rogers (Regulatory Technician)	NOTIFY AZTEC OGD IN TIME TO WITNESS 24 hrs CS9 & cement 2-19-07 Date	

PERMIT NO. _____ APPROVAL DATE _____
APPROVED BY Wayne Townsend TITLE Acting AFM DATE 3/7/07

Archaeological Report attached

Threatened and Endangered Species Report attached

NOTE: This format is issued in lieu of U.S. BLM Form 3160-3

Title 18 U.S.C. Section 1001, makes it a crime for any person knowingly and willfully to make to any department or agency of the United States any false, fictitious or fraudulent statements or presentations as to any matter within its jurisdiction.

Example Master Plan Type 2

DRILLING OPERATIONS AUTHORIZED ARE
SUBJECT TO COMPLIANCE WITH ATTACHED
"GENERAL REQUIREMENTS".

NMOCD B 3/13/07

This action is subject to technical and
procedural review pursuant to 43 CFR 3165.3
and appeal pursuant to 43 CFR 3165.4

DISTRICT I
1828 N. French Dr., Hobbs, N.M. 88240

DISTRICT II
1308 West Grand Avenue, Artesia, N.M. 88210

DISTRICT III
1000 Rio Brazos Rd., Aztec, N.M. 87410

DISTRICT IV
1220 S. St. Francis Dr., Santa Fe, NM 87505

State of New Mexico
Energy, Minerals & Natural Resources Department

OIL CONSERVATION DIVISION

1220 South St. Francis Dr.
Santa Fe, NM 87505

Form C-102
Revised October 12, 2005

Submit to Appropriate District Office
State Lease - 4 Copies
Fee Lease - 3 Copies

2007 FEB 20 PM 3:59

7100 71000 71000

RECEIVED

☐ AMENDED REPORT

WELL LOCATION AND ACREAGE DEDICATION PLAT

210 FARMINGTON NM

*API Number 30-045- 34179	*Pool Code 71629	*Pool Name Basin Fruitland Coal
*Property Code 6916	*Property Name CLEVELAND	*Well Number 2205
*OBERD No. 14538	*Operator Name BURLINGTON RESOURCES OIL AND GAS COMPANY LP	*Elevation 6325'

10 Surface Location

UL or lot no. D	Section 21	Township 27-N	Range 9-W	Lot No. 745	Feet from the 745'	North/South line NORTH	Feet from the 845'	East/West line WEST	County SAN JUAN
--------------------	---------------	------------------	--------------	----------------	-----------------------	---------------------------	-----------------------	------------------------	--------------------

11 Bottom Hole Location If Different From Surface

UL or lot no. D	Section	Township	Range	Lot No.	Feet from the	North/South line	Feet from the	East/West line	County
Dedicated Acres 320 acres N/2					Joint or Infill		Consolidation Code		Order No.
RCVD MAR 9 '07 OIL CONS. DIV. DIST. 3									

NO ALLOWABLE WILL BE ASSIGNED TO THIS COMPLETION UNTIL ALL INTERESTS HAVE BEEN CONSOLIDATED
OR A NON-STANDARD UNIT HAS BEEN APPROVED BY THE DIVISION

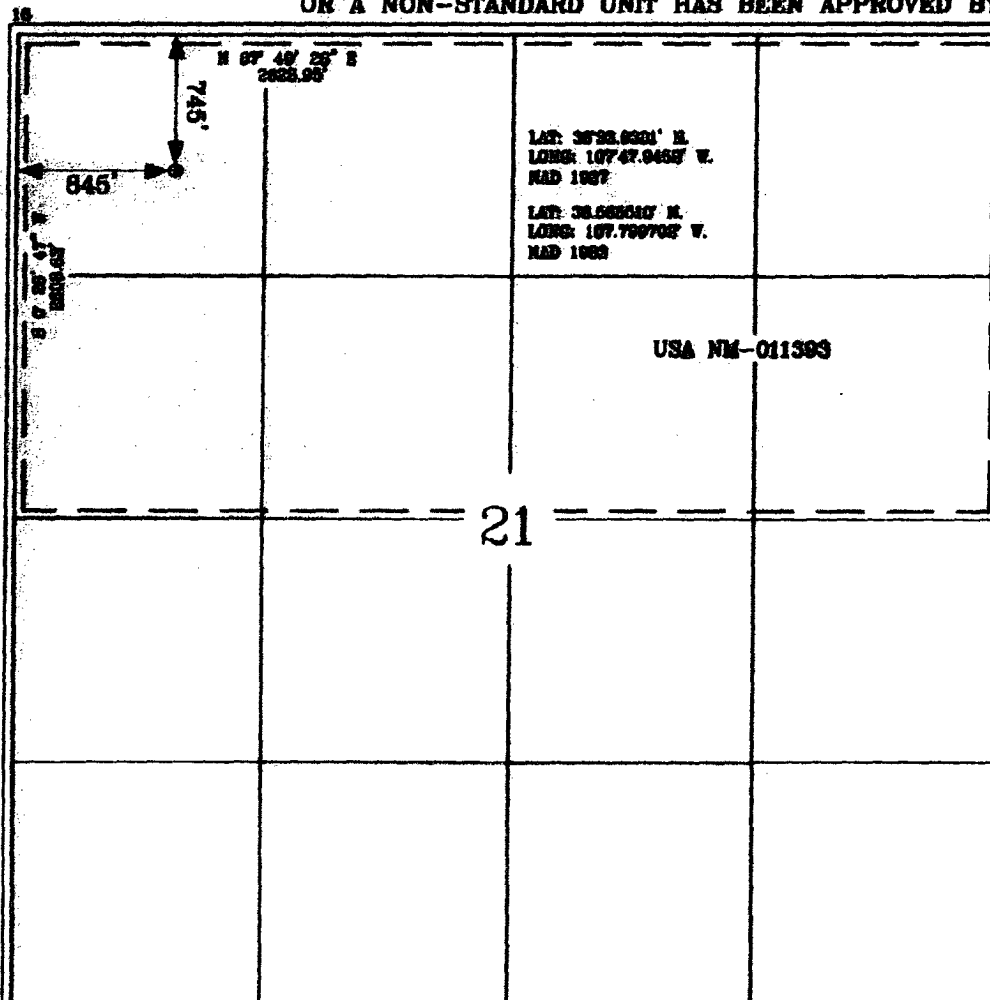

17 OPERATOR CERTIFICATION

I hereby certify that the information contained herein is true and complete to the best of my knowledge and belief, and that this organization either owns a working interest or otherwise has an interest in the land including the proposed bottom hole location or has a right to drill this well at this location pursuant to a contract with an owner of such a mineral or a working interest, or to a voluntary pooling agreement or a compulsory pooling order heretofore entered by the Division.

Rhonda Rogers
Signature Rhonda Rogers
Printed Name
Regulatory Technician

18 SURVEYOR CERTIFICATION

I hereby certify that the well location shown on this plat was plotted from field notes of actual surveys made by me or under my supervision, and that the same is true and correct to the best of my belief.

12-6-06
Date of Survey
Signature *Glen W. Russell*
Glen W. Russell
NEW MEXICO
LICENSED PROFESSIONAL SURVEYOR
15703
Certificate Number 15703

SUNDRY NOTICES AND REPORTS ON
WELLS

State of New Mexico

Form C-103

May 27, 2004

Energy, Minerals and Natural Resources

District I

1625 N. French Dr., Hobbs, NM 88240

District II

1301 W. Grand Ave., Artesia, NM 88210

District III

1000 Rio Brazos Rd., Aztec, NM 87410

District IV

1220 S. St. Francis Dr., Santa Fe, NM 87505

OIL CONSERVATION DIVISION

1220 South St. Francis Dr.

Santa Fe, NM 87505

WELL API NO.

30-045- 34179

5. Indicate Type of Lease

STATE ☐

FEE ☐

6. State Oil & Gas Lease No.

7. Lease Name or Unit Agreement Name

Cleveland

8. Well Number

#220S

9. OGRID Number

14538

10. Pool name or Wildcat

Basin Fruitland Coal

SUNDRY NOTICES AND REPORTS ON WELLS

(DO NOT USE THIS FORM FOR PROPOSALS TO DRILL OR TO DEEPEN OR PLUG BACK TO A DIFFERENT RESERVOIR. USE "APPLICATION FOR PERMIT" (FORM C-101) FOR SUCH PROPOSALS.)

1. Type of Well:

Oil Well ☐

Gas Well ☒

Other

2. Name of Operator

BURLINGTON RESOURCES OIL & GAS COMPANY LP

3. Address of Operator

3401 E. 30TH STREET, FARMINGTON, NM 87402

4. Well Location

Unit Letter D : 745' feet from the North line and 845' feet from the West line
Section 21 Township 27N Rng 9W NMPM County San Juan

11. Elevation (Show whether DR, RKB, RT, GR, etc.)

6325'

Pit or Below-grade Tank Application

☐ or Closure ☐

Pit type

New Drill

Depth to Groundwater

>100

Distance from nearest fresh water well

>1000

Distance from nearest surface water

Pit Liner Thickness:

N/A

mil

Below-Grade Tank:

Volume

bbls;

Construction Material

12. Check Appropriate Box to Indicate Nature of Notice, Report or Other Data

NOTICE OF INTENTION TO:

PERFORM REMEDIAL WORK ☐

TEMPORARILY ABANDON ☐

PULL OR ALTER CASING ☐

PLUG AND ABANDON ☐

CHANGE PLANS ☐

MULTIPLE COMPL ☐

SUBSEQUENT REPORT OF:

REMEDIAL WORK ☐

COMMENCE DRILLING OPNS. ☐

CASING/CEMENT JOB ☐

ALTERING CASING ☐

P AND A ☐

OTHER:

New Drill

☒

OTHER:

☐

13. Describe proposed or completed operations. (Clearly state all pertinent details, and give pertinent dates, including estimated date of starting any proposed work). SEE RULE 1103. For Multiple Completions: Attach wellbore diagram of proposed completion or recompletion.

New Drill, Unlined:

Burlington Resources proposes to construct a new drilling pit and an associated vent/flare pit. Based on Burlington's interpretation of the Ecosphere's risk ranking criteria, the new drilling pit and vent/flare pit will be an unlined pit as detailed in Burlington's Revised Drilling / Workover Pit Construction / Operation Procedures dated November 11, 2004 on file at the NMOCD office. A portion of the vent/flare pit will be designed to manage fluids, and that portion will be unlined, as per the risk ranking criteria. Burlington Resources anticipates closing these pits according to the Drilling / Workover Pit Closure Procedure dated August 2, 2004 on file at the NMOCD office.

I hereby certify that the information above is true and complete to the best of my knowledge and belief. I further certify that any pit or below-grade tank has been/will be constructed or closed according to NMOCD guidelines ☐, a general permit ☒ or an (attached) alternative OCD-approved plan ☐.

SIGNATURE

TITLE

Regulatory Technician

DATE

2/19/2007

Type or print name

Rhonda Rogers

E-mail address:

ogerrs@conocophillips.com

Telephone No.

505-599-4018

For State Use Only

APPROVED BY

TITLE

DEPUTY OIL & GAS INSPECTOR, DIST. III

DATE

MAR 13 2007

Conditions of Approval (if any):

BURLINGTON RESOURCES OIL & GAS COMPANY LP

CLEVELAND 220S, 745' FNL & 845' FWL

SECTION 21, T-27-N, R-9-W, NMPM, SAN JUAN COUNTY, NM

GROUND ELEVATION: 6325', DATE: NOVEMBER 27, 2006

ELEV. A'-A

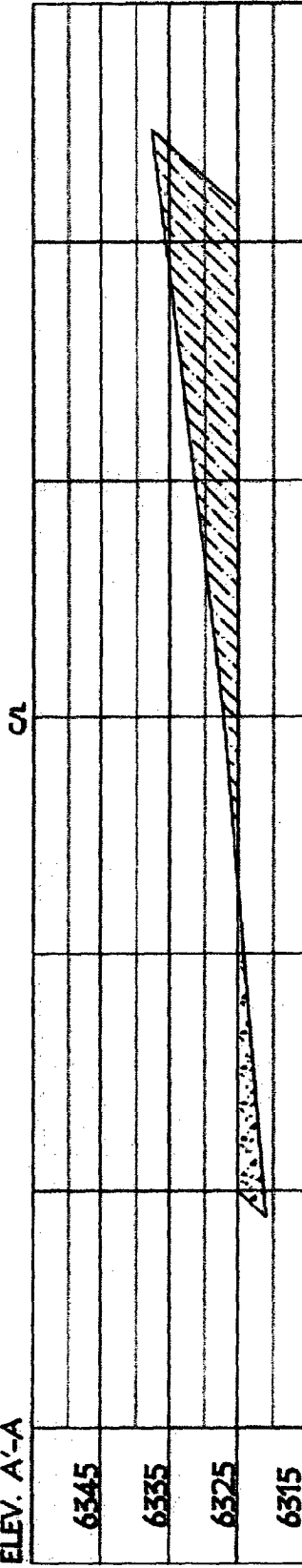

ELEV. B'-B

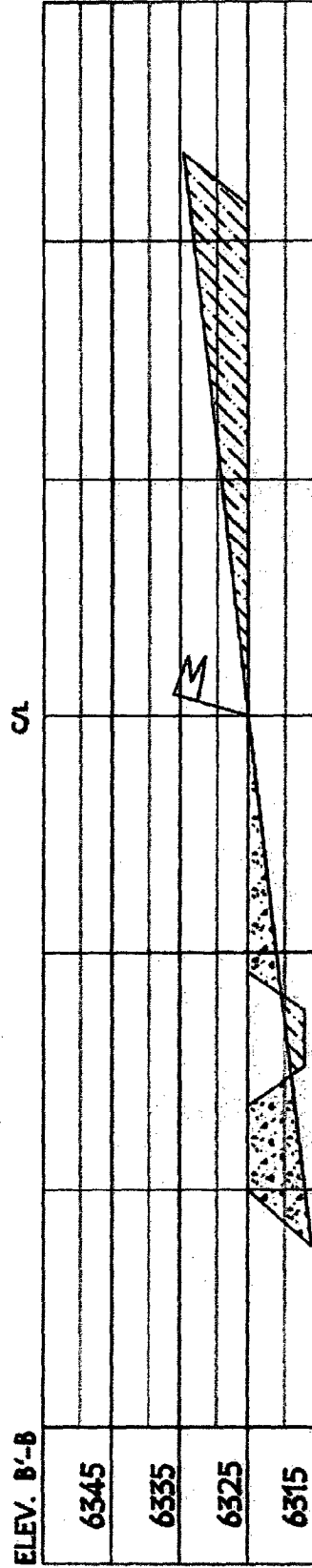

ELEV. C'-C

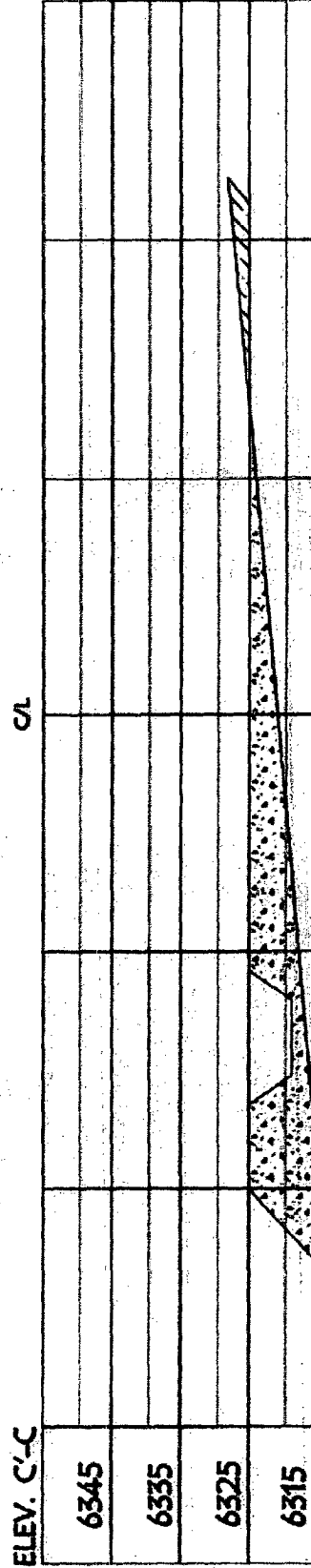

NOTE: VECTOR SURVEYS IS NOT LIABLE FOR UNDERGROUND UTILITIES OR PIPELINES.
CONTRACTOR SHOULD CALL ONE-CALL FOR LOCATION OF ANY MARKED OR UNMARKED BURIED
PIPELINES OR CABLES ON WELL PAD AND OR ACCESS ROAD AT LEAST TWO (2) WORKING DAYS PRIOR TO CONSTRUCTION.

PROJECT PROPOSAL - New Drill / Sidetrack

CLEVELAND 220S

Lease:		AFE #: WAN.CDR.7016		AFE \$: 254,618.01	
Field Name: hBR SAN JUAN		Rig: Aztec Rig 580		State: NM	County: SAN JUAN
Geoscientist: Clark, Dave D		Phone: 505-326-9762		Prod. Engineer: Phone:	
Res. Engineer: Schlabaugh, Jim L		Phone: 505-326-9788		Proj. Field Lead: Phone:	
Primary Objective (Zones):					
Zone	Zone Name				
JCV	BASIN FRUITLAND COAL (GAS)				

Location: Surface		Datum Code: NAD 27		Straight Hole	
Latitude: 36.565502	Longitude: -107.799087	X:	Y:	Section: 21	Range: 009W
Footage X: 845 FWL	Footage Y: 745 FNL	Elevation: 6325	(FT)	Township: 027N	
Tolerance:					

Location Type: Year Round	Start Date (Est.):	Completion Date:	Date In Operation:
---------------------------	--------------------	------------------	--------------------

Formation Data: Assume KB = 6337 Units = FT

Formation Call & Casing Points	Depth (TVD in Ft)	SS (Ft)	Depletion (Yes/No)	BHP (PSIG)	BHT	Remarks
SURFACE CSG	120	6217	<input type="checkbox"/>			8-3/4" hole. 7" 20 ppf J-55 STC casing. Cement with 50 cuft. Circulate cement to surface.
CJO ALAMO	1322	5015	<input type="checkbox"/>			Possible water
KIRTLAND	1427	4910	<input type="checkbox"/>			
FRUITLAND	1924	4413	<input type="checkbox"/>			Gas
PICTURED CLIFFS	2239	4098	<input type="checkbox"/>			Gas
Total Depth	2439	3898	<input type="checkbox"/>	400		6-1/4" hole. 4-1/2" 10.5 ppf J-55 STC casing. Cement with 375 cuft. Circulate cement to surface.

Reference Wells:		
Reference Type	Well Name	Comments

Logging Program:		
Intermediate Logs:	<input type="checkbox"/> Log only if show	<input type="checkbox"/> GR/ILD <input type="checkbox"/> Triple Combo

TD Logs:	<input type="checkbox"/> Triple Combo	<input type="checkbox"/> Dipmeter	<input type="checkbox"/> RFT	<input type="checkbox"/> Sonic	<input type="checkbox"/> VSP	<input type="checkbox"/> TDT	<input checked="" type="checkbox"/> Other
GR/CBL							

Additional Information:

Log Type	Stage	From (Ft)	To (Ft)	Tool Type/Name	Remarks
----------	-------	-----------	---------	----------------	---------

Comments: Location/Tops/Logging - FCNM027N009W21NW1 Nearest offset used is Cleveland 3-21 NW21-27N-09W.

Zones - FCNM027N009W21NW1

General/Work Description - MAKE SURE COST INCLUDE JET PUMP