

District I
1625 N. French Dr., Hobbs, NM 88240
District II
1301 W. Grand Avenue, Artesia, NM 88210
District III
1000 Rio Brazos Road, Aztec, NM 87410
District IV
1220 S. St. Francis Dr., Santa Fe, NM 87505

State of New Mexico
Energy Minerals and Natural Resources

Form C-144
June 1, 2004

Oil Conservation Division
1220 South St. Francis Dr.
Santa Fe, NM 87505

For drilling and production facilities, submit to appropriate NMOCD District Office.
For downstream facilities, submit to Santa Fe office

Pit or Below-Grade Tank Registration or Closure

Is pit or below-grade tank covered by a "general plan"? Yes ☒ No ☐

RCVD FEB27'07

Type of action: Registration of a pit or below-grade tank ☐ Closure of a pit or below-grade tank ☒ OIL CONS. DIV.

Operator: BP America Production Company Telephone: (505)326-9200 e-mail address: DIST. 3
Address: 200 Energy Ct. Farmington, NM 87401
Facility or well name: STATE GC CB #1 API #: 30045 08915 U/L or Qtr/Qtr M Sec 32 T 30 NR 9 W
County: San Juan Latitude _____ Longitude _____ NAD: 1927 ☐ 1983 ☒
Surface Owner: Federal ☐ State ☐ Private ☒ Indian ☐

Pit	Below-grade tank
Type: Drilling <input type="checkbox"/> Production <input type="checkbox"/> Disposal <input checked="" type="checkbox"/> Workover <input type="checkbox"/> Emergency <input type="checkbox"/> Lined <input type="checkbox"/> Unlined <input type="checkbox"/> Liner type: Synthetic <input type="checkbox"/> Thickness _____ mil Clay <input type="checkbox"/> Pit Volume _____ bbl	Volume: _____ bbl Type of fluid: _____ Construction material: _____ Double-walled, with leak detection? Yes <input type="checkbox"/> If not, explain why not. _____
Depth to ground water (vertical distance from bottom of pit to seasonal high water elevation of ground water.)	Less than 50 feet (20 points) 50 feet or more, but less than 100 feet (10 points) 100 feet or more (0 points) <u>0</u>
Wellhead protection area: (Less than 200 feet from a private domestic water source, or less than 1000 feet from all other water sources.)	Yes (20 points) No (0 points) <u>0</u>
Distance to surface water: (horizontal distance to all wetlands, playas, irrigation canals, ditches, and perennial and ephemeral watercourses.)	Less than 200 feet (20 points) 200 feet or more, but less than 1000 feet (10 points) 1000 feet or more (0 points) <u>0</u>
Ranking Score (Total Points) <u>0</u>	

If this is a pit closure: (1) Attach a diagram of the facility showing the pit's relationship to other equipment and tanks. (2) Indicate disposal location: (check the onsite box if you are burying in place) onsite ☒ offsite ☐ If offsite, name of facility _____. (3) Attach a general description of remedial action taken including remediation start date and end date. (4) Groundwater encountered: No ☒ Yes ☐ If yes, show depth below ground surface _____ ft. and attach sample results. (5) Attach soil sample results and a diagram of sample locations and excavations.

Additional Comments:

See Attached Documentation

I hereby certify that the information above is true and complete to the best of my knowledge and belief. I further certify that the above-described pit or below-grade tank has been/will be constructed or closed according to NMOCD guidelines ☒, a general permit ☐, or an (attached) alternative OCD-approved plan ☐.

Date: 11/01/2005

Printed Name/Title Jeffrey C. Blagg, Agent

Signature Jeffrey C. Blagg

Your certification and NMOCD approval of this application/closure does not relieve the operator of liability should the contents of the pit or tank contaminate ground water or otherwise endanger public health or the environment. Nor does it relieve the operator of its responsibility for compliance with any other federal, state, or local laws and/or regulations.

Approval:

Printed Name/Title WYTY OIL & GAS INSPECTOR, DIST. 3

Signature Brandon Bell

Date: FEB 27 2007

CLIENT: <u>BP</u>	BLAGG ENGINEERING, INC. P.O. BOX 87, BLOOMFIELD, NM 87413 (505) 632-1199	LOCATION NO: <u>80051</u> COCR NO: <u>10799</u>																																													
FIELD REPORT: PIT CLOSURE VERIFICATION		PAGE No: <u>1</u> of <u>1</u>																																													
LOCATION: NAME: <u>STATE GC C8</u> WELL #: <u>1</u> TYPE: <u>SEP II</u> QUAD/UNIT: <u>M SEC: 32 TWP: 30N RNG: 9W PM: NM CNTY: SJ ST: NM</u> QTR/FOOTAGE: <u>990'S/990'W</u> SW/SW CONTRACTOR: <u>FLINT (JOHN)</u>		DATE STARTED: <u>4/22/03</u> DATE FINISHED: _____ ENVIRONMENTAL SPECIALIST: <u>NV</u>																																													
EXCAVATION APPROX. <u>15</u> FT. x <u>14</u> FT. x <u>4</u> FT. DEEP. CUBIC YARDAGE: <u>30</u>																																															
DISPOSAL FACILITY: <u>ON-SITE</u> REMEDIATION METHOD: <u>LANDFARM</u>																																															
LAND USE: <u>RANGE</u> <u>SURF. USE: -</u> LEASE: <u>STATE</u> FORMATION: <u>MV/OK</u>																																															
FIELD NOTES & REMARKS: PIT LOCATED APPROXIMATELY <u>234</u> FT. <u>N75E</u> FROM WELLHEAD.																																															
DEPTH TO GROUNDWATER: <u>>100'</u> NEAREST WATER SOURCE: <u>>1000'</u> NEAREST SURFACE WATER: <u>>1000'</u>																																															
NMOCD RANKING SCORE: <u>0</u> NMOCD TPH CLOSURE STD: <u>5000</u> PPM																																															
SOIL AND EXCAVATION DESCRIPTION:		OVM CALIB. READ. = <u>51.4</u> ppm OVM CALIB. GAS = <u>100</u> ppm RF = 0.52 TIME: <u>11:50</u> am/pm DATE: <u>4/22/03</u>																																													
SOIL TYPE: <u>SANDY</u> SILTY SAND / SILT / SILTY CLAY / CLAY / GRAVEL / OTHER _____ SOIL COLOR: <u>DIR. YELL. BROWN (TO 1' BELOW TANK BOTTOM)</u> <u>MED. GRAY TO BLACK (BET. 3'-11' BELOW GRADE)</u> COHESION (ALL OTHERS): <u>NON COHESIVE</u> SLIGHTLY COHESIVE / COHESIVE / HIGHLY COHESIVE CONSISTENCY (NON COHESIVE SOILS): <u>LOOSE FIRM</u> DENSE / VERY DENSE PLASTICITY (CLAYS): NON PLASTIC / SLIGHTLY PLASTIC / COHESIVE / MEDIUM PLASTIC / HIGHLY PLASTIC DENSITY (COHESIVE CLAYS & SILTS): SOFT / FIRM / STIFF / VERY STIFF / HARD MOISTURE: DRY <u>SLIGHTLY MOIST</u> <u>MOIST</u> WET / SATURATED / SUPER SATURATED DISCOLORATION/STAINING OBSERVED: <u>YES</u> NO EXPLANATION: _____ HC ODOR DETECTED: <u>YES</u> NO EXPLANATION: <u>EXCAVATED SOIL FROM TEST HOLE & OVM SAMPLE.</u> SAMPLE TYPE: <u>GRAB</u> COMPOSITE - # OF PTS. _____ ADDITIONAL COMMENTS: <u>STEEL TANK REMOVED PRIOR TO TEST HOLE ADVANCEMENT. RECOMMENDED EXCAVATING DISCOLORED SOIL TO MAX. DEPTH OF BACKHOE.</u>																																															
FIELD 418.1 CALCULATIONS																																															
SCALE 0 FT	<table border="1" style="width:100%; border-collapse: collapse;"> <thead> <tr> <th>SAMP. TIME</th> <th>SAMP. ID</th> <th>LAB NO.</th> <th>WEIGHT (g)</th> <th>mL FREON</th> <th>DILUTION</th> <th>READING</th> <th>CALC. (ppm)</th> </tr> </thead> <tbody> <tr><td> </td><td> </td><td> </td><td> </td><td> </td><td> </td><td> </td><td> </td></tr> <tr><td> </td><td> </td><td> </td><td> </td><td> </td><td> </td><td> </td><td> </td></tr> <tr><td> </td><td> </td><td> </td><td> </td><td> </td><td> </td><td> </td><td> </td></tr> <tr><td> </td><td> </td><td> </td><td> </td><td> </td><td> </td><td> </td><td> </td></tr> </tbody> </table>		SAMP. TIME	SAMP. ID	LAB NO.	WEIGHT (g)	mL FREON	DILUTION	READING	CALC. (ppm)																																					
SAMP. TIME	SAMP. ID	LAB NO.	WEIGHT (g)	mL FREON	DILUTION	READING	CALC. (ppm)																																								
PIT PERIMETER	PIT PROFILE																																														
		<table border="1" style="width:100%; border-collapse: collapse;"> <thead> <tr> <th colspan="2">OVM READING</th> </tr> <tr> <th>SAMPLE ID</th> <th>FIELD HEADSPACE (ppm)</th> </tr> </thead> <tbody> <tr><td>1 @ 11'</td><td>987</td></tr> <tr><td>2 @</td><td> </td></tr> <tr><td>3 @</td><td> </td></tr> <tr><td>4 @</td><td> </td></tr> <tr><td>5 @</td><td> </td></tr> <tr><td> </td><td> </td></tr> <tr><td> </td><td> </td></tr> <tr><td> </td><td> </td></tr> <tr><td> </td><td> </td></tr> <tr><td> </td><td> </td></tr> <tr><td> </td><td> </td></tr> <tr><td> </td><td> </td></tr> <tr><td> </td><td> </td></tr> </tbody> </table> <table border="1" style="width:100%; border-collapse: collapse;"> <thead> <tr> <th colspan="3">LAB SAMPLES</th> </tr> <tr> <th>SAMPLE ID</th> <th>ANALYSIS</th> <th>TIME</th> </tr> </thead> <tbody> <tr><td>DE11'</td><td>TPH (80158)</td><td>1142</td></tr> <tr><td>"</td><td>BTEX (80218)</td><td>"</td></tr> <tr><td colspan="3" style="text-align: center;">BOTH PASSED</td></tr> </tbody> </table>	OVM READING		SAMPLE ID	FIELD HEADSPACE (ppm)	1 @ 11'	987	2 @		3 @		4 @		5 @																		LAB SAMPLES			SAMPLE ID	ANALYSIS	TIME	DE11'	TPH (80158)	1142	"	BTEX (80218)	"	BOTH PASSED		
OVM READING																																															
SAMPLE ID	FIELD HEADSPACE (ppm)																																														
1 @ 11'	987																																														
2 @																																															
3 @																																															
4 @																																															
5 @																																															
LAB SAMPLES																																															
SAMPLE ID	ANALYSIS	TIME																																													
DE11'	TPH (80158)	1142																																													
"	BTEX (80218)	"																																													
BOTH PASSED																																															
P.D. = PIT DEPRESSION; B.G. = BELOW GRADE; B = BELOW T.H. = TEST HOLE; - = APPROX.; T.B. = TANK BOTTOM																																															
TRAVEL NOTES: CALLOUT: <u>4/22/03 - MORN.</u> ONSITE: <u>4/22/03 - MORN.</u>																																															

ENVIROTECH LABS

PRACTICAL SOLUTIONS FOR A BETTER TOMORROW

EPA METHOD 8015 Modified Nonhalogenated Volatile Organics Total Petroleum Hydrocarbons

Client:	Blagg / BP	Project #:	94034-010
Sample ID:	1 @ 11'	Date Reported:	04-24-03
Laboratory Number:	25421	Date Sampled:	04-22-03
Chain of Custody No:	10799	Date Received:	04-23-03
Sample Matrix:	Soil	Date Extracted:	04-23-03
Preservative:	Cool	Date Analyzed:	04-24-03
Condition:	Cool and Intact	Analysis Requested:	8015 TPH

Parameter	Concentration (mg/Kg)	Det. Limit (mg/Kg)
Gasoline Range (C5 - C10)	16.3	0.2
Diesel Range (C10 - C28)	18.8	0.1
Total Petroleum Hydrocarbons	35.1	0.2

ND - Parameter not detected at the stated detection limit.

References: Method 8015B, Nonhalogenated Volatile Organics, Test Methods for Evaluating Solid Waste, SW-846, USEPA, December 1996. *RV*

Comments: State GC CB #1 Separator Pit ^{II} Grab Sample.

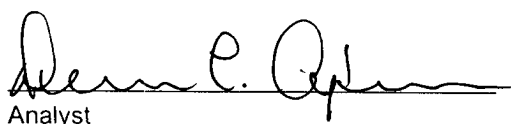
Analyst

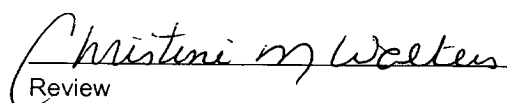
Review

ENVIROTECH LABS

PRACTICAL SOLUTIONS FOR A BETTER TOMORROW

EPA METHOD 8021 AROMATIC VOLATILE ORGANICS

Client:	Blagg / BP	Project #:	94034-010
Sample ID:	1 @ 11'	Date Reported:	04-24-03
Laboratory Number:	25421	Date Sampled:	04-22-03
Chain of Custody:	10799	Date Received:	04-23-03
Sample Matrix:	Soil	Date Analyzed:	04-24-03
Preservative:	Cool	Date Extracted:	04-23-03
Condition:	Cool & Intact	Analysis Requested:	BTEX

Parameter	Concentration (ug/Kg)	Det. Limit (ug/Kg)
Benzene	ND	1.8
Toluene	216	1.7
Ethylbenzene	47.1	1.5
p,m-Xylene	442	2.2
o-Xylene	176	1.0
Total BTEX	881	

ND - Parameter not detected at the stated detection limit.

Surrogate Recoveries:	Parameter	Percent Recovery
	Fluorobenzene	98 %
	1,4-difluorobenzene	98 %
	Bromochlorobenzene	98 %

References: Method 5030B, Purge-and-Trap, Test Methods for Evaluating Solid Waste, SW-846, USEPA, December 1996.

Method 8021B, Aromatic Volatile Organics, Test Methods for Evaluating Solid Waste, SW-846, USEPA, December 1996.

Comments: State GC CB #1 Separator Pit ^{II} Grab Sample.

Analyst

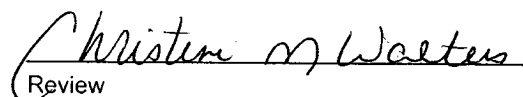
Review

CLIENT: BPBLAGG ENGINEERING, INC.
P.O. BOX 87, BLOOMFIELD, NM 87413
(505) 632-1199LOCATION NO: 80051C.O.C. NO: 13921

FIELD REPORT: LANDFARM/COMPOST PILE CLOSURE VERIFICATION

LOCATION: NAME: STATE GC CB WELL #: 1 PITS:
QUAD/UNIT: M SEC: 32 TWP: 30N RNG: 9W PM: NM CNTY: 5J ST: NM
QTR/FOOTAGE: SW1SW CONTRACTOR: FLINT (JOHN)DATE STARTED: 7/22/05DATE FINISHED: ENVIRONMENTAL
SPECIALIST: NV

SOIL REMEDIATION:

235

REMEDICATION SYSTEM: LANDFARMAPPROX. CUBIC YARDAGE: LAND USE: RANGELIFT DEPTH (ft): 0.5 - 1

FIELD NOTES & REMARKS:

DEPTH TO GROUNDWATER: >100'NEAREST SURFACE WATER: >1,000'NEAREST WATER SOURCE: >1,000' NMOCD RANKING SCORE: 0 NMOCD TPH CLOSURE STD: 5,000 PPMSOIL TYPE: (SAND) / SILTY SAND / SILT / SILTY CLAY / CLAY / GRAVEL / OTHER SOIL COLOR: VERY PALE ORANGE TO DK. YELL. ORANGECOHESION (ALL OTHERS): (NON COHESIVE) / SLIGHTLY COHESIVE / COHESIVE / HIGHLY COHESIVECONSISTENCY (NON COHESIVE SOILS): (LOOSE) / (FIRM) / DENSE / VERY DENSE

PLASTICITY (CLAYS): NON PLASTIC / SLIGHTLY PLASTIC / COHESIVE / MEDIUM PLASTIC / HIGHLY PLASTIC

DENSITY (COHESIVE CLAYS & SILTS): SOFT / FIRM / STIFF / VERY STIFF / HARD

MOISTURE: (DRY) / SLIGHTLY MOIST / MOIST / WET / SATURATED / SUPER SATURATEDCLOSEDDISCOLORATION/STAINING OBSERVED: YES (NO) EXPLANATION - HC ODOR DETECTED: YES (NO) EXPLANATION - SAMPLING DEPTHS (LANDFARMS): 4-8 (INCHES)SAMPLE TYPE: GRAB (COMPOSITE) # OF PTS. 5ADDITIONAL COMMENTS:

SKETCH/SAMPLE LOCATIONS

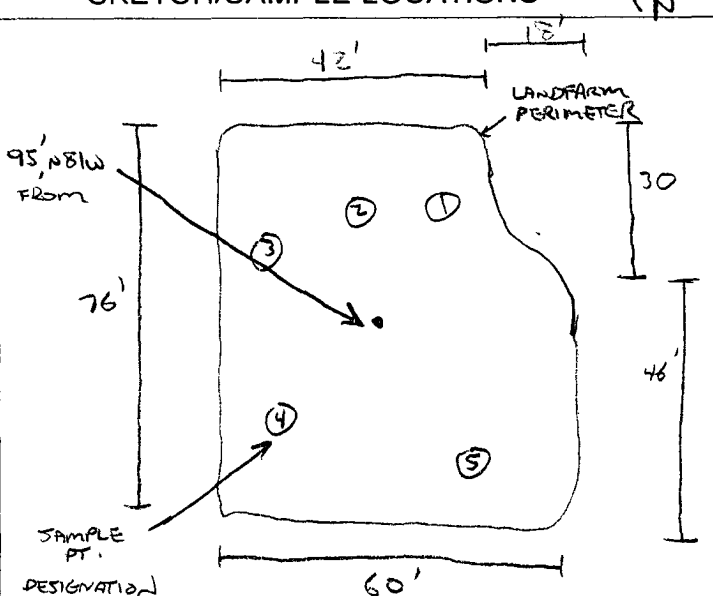
OVM CALIB. READ. = 53.4 ppm
OVM CALIB. GAS = 100 ppm RF = 0.52
TIME: 7:10 am/pm DATE: 7/20/05

OVM RESULTS

LAB SAMPLES

SAMPLE ID	FIELD HEADSPACE (ppm)	SAMPLE ID	ANALYSIS	TIME	RESULTS
LF-1	0.0	LF-1	TPH (80158)	1420	ND

P.C. - 4/22/03

SCALE

0 FT

TRAVEL NOTES: CALLOUT: N/AONSITE: 7/22/05

ENVIROTECH LABS

PRACTICAL SOLUTIONS FOR A BETTER TOMORROW

EPA METHOD 8015 Modified Nonhalogenated Volatile Organics Total Petroleum Hydrocarbons

Client:	Blagg / BP	Project #:	94034-010
Sample ID:	LF - 1	Date Reported:	07-29-05
Laboratory Number:	33835	Date Sampled:	07-22-05
Chain of Custody No:	13921	Date Received:	07-25-05
Sample Matrix:	Soil	Date Extracted:	07-27-05
Preservative:	Cool	Date Analyzed:	07-29-05
Condition:	Cool and Intact	Analysis Requested:	8015 TPH

Parameter	Concentration (mg/Kg)	Det. Limit (mg/Kg)
Gasoline Range (C5 - C10)	ND	0.2
Diesel Range (C10 - C28)	ND	0.1
Total Petroleum Hydrocarbons	ND	0.2

ND - Parameter not detected at the stated detection limit.

References: Method 8015B, Nonhalogenated Volatile Organics, Test Methods for Evaluating Solid Waste, SW-846, USEPA, December 1996.

Comments: **State GC CB #1 Landfarm 5 Pt. Composite Sample.**

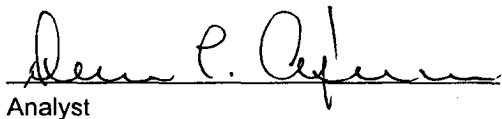
Analyst

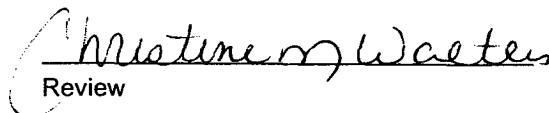
Review