

District I
1625 N. French Dr., Hobbs, NM 88240
District II
1301 W. Grand Avenue, Artesia, NM 88210
District III
1000 Rio Brazos Road, Aztec, NM 87410
District IV
1220 S. St. Francis Dr., Santa Fe, NM 87505

State of New Mexico
Energy Minerals and Natural Resources

Oil Conservation Division
1220 South St. Francis Dr.
Santa Fe, NM 87505

For drilling and production facilities, submit to appropriate NMOCD District Office.
For downstream facilities, submit to Santa Fe office

Form C-144
March 12, 2004

RCVD MAR6'07
OIL CONS. DIV.
DIST. 3

Pit or Below-Grade Tank Registration or Closure

Is pit or below-grade tank covered by a "general plan"? Yes ☒ No ☐

Type of action: Registration of a pit or below-grade tank ☐ Closure of a pit or below-grade tank ☒

Operator: <u>BP AMERICA PROD. CO.</u> Telephone: <u>(505) 326-9200</u>	
Address: <u>200 Energy Court, Farmington, NM 87410</u>	
Facility or well name: <u>DAY B #4</u>	API #: <u>30-045-08437</u> U/L or Qtr/Qt: <u>M</u> Sec <u>8</u> T <u>29N</u> R <u>8W</u>
County: <u>San Juan</u> Latitude <u>36.73485</u> Longitude <u>107.70265</u> NAD: 1927 <input type="checkbox"/> 1983 <input checked="" type="checkbox"/> Surface Owner Federal <input checked="" type="checkbox"/> State <input type="checkbox"/> Private <input type="checkbox"/> Indian <input type="checkbox"/>	
Pit Type: Drilling <input type="checkbox"/> Production <input checked="" type="checkbox"/> Disposal <input type="checkbox"/> SEPARATOR Workover <input type="checkbox"/> Emergency <input type="checkbox"/> Lined <input type="checkbox"/> Unlined <input checked="" type="checkbox"/> Liner type: Synthetic <input type="checkbox"/> Thickness _____ mil Clay <input type="checkbox"/> Volume _____ bbl	Below-grade tank Volume: _____ bbl Type of fluid: _____ Construction material: <u>N/A</u> Double-walled with leak detection? Yes <input type="checkbox"/> If not, explain why not.
Depth to ground water (vertical distance from bottom of pit to seasonal high water elevation of ground water.)	Less than 50 feet (20 points) 50 feet or more, but less than 100 feet (10 points) <u>0</u> 100 feet or more (0 points)
Wellhead protection area: (Less than 200 feet from a private domestic water source, or less than 1000 feet from all other water sources.)	Yes (20 points) No (0 points) <u>0</u>
Distance to surface water: (horizontal distance to all wetlands, playas, irrigation canals, ditches, and perennial and ephemeral watercourses.)	Less than 200 feet (20 points) 200 feet or more, but less than 1000 feet (10 points) <u>0</u> 1000 feet or more (0 points)
Ranking Score (Total Points) <u>0</u>	

If this is a pit closure: (1) attach a diagram of the facility showing the pit's relationship to other equipment and tanks. (2) Indicate disposal location: onsite ☒ offsite ☐ If offsite, name of facility _____. (3) Attach a general description of remedial action taken including remediation start date and end date. (4) Groundwater encountered: No ☒ Yes ☐ If yes, show depth below ground surface _____ ft. and attach sample results. (5) Attach soil sample results and a diagram of sample locations and excavations.

I hereby certify that the information above is true and complete to the best of my knowledge and belief. I further certify that the above-described pit or below-grade tank has been/will be constructed or closed according to NMOCD guidelines ☒, a general permit ☐, or an (attached) alternative OCD-approved plan ☒.

Date: 06/12/04

Printed Name/Title Jeff Blagg - P.E. # 11607

Signature [Signature]

Your certification and NMOCD approval of this application/closure does not relieve the operator of liability should the contents of the pit or tank contaminate ground water or otherwise endanger public health or the environment. Nor does it relieve the operator of its responsibility for compliance with any other federal, state, or local laws and/or regulations.

Approval:

Date: MAR 06 2007

Printed Name/Title SENIOR OIL & GAS INSPECTOR, DIST. 3

Signature [Signature]

3004508437

CLIENT: <u>BP</u>	BLAGG ENGINEERING, INC. P.O. BOX 87, BLOOMFIELD, NM 87413 (505) 632-1199	LOCATION NO: <u>B1333</u>
		COCR NO: <u>11826</u>

FIELD REPORT: PIT CLOSURE VERIFICATIONPAGE No: 1 of 1

LOCATION: NAME: <u>DAY B</u>	WELL #: <u>4</u>	TYPE: <u>SEP</u>	DATE STARTED: <u>2-6-04</u>
QUAD/UNIT: <u>M</u> SEC: <u>8</u> TWP: <u>29N</u> RNG: <u>8W</u> PM: <u>NM</u> CNTY: <u>SJ</u> ST: <u>NM</u>			DATE FINISHED: <u>2-6-04</u>
QTR/FOOTAGE: <u>990'S/990'W</u>	SW/SW CONTRACTOR: <u>FLINT (BEN)</u>		ENVIRONMENTAL SPECIALIST: <u>JCB</u>

EXCAVATION APPROX. <u>NA</u> FT. x <u>NA</u> FT. x <u>NA</u> FT. DEEP. CUBIC YARDAGE: <u>0</u>
DISPOSAL FACILITY: <u>NA</u> REMEDIATION METHOD: <u>CLOSE AS IS</u>
LAND USE: <u>RANGE - B-m</u> LEASE: <u>SF 078414</u> FORMATION: <u>MV</u>

FIELD NOTES & REMARKS: PIT LOCATED APPROXIMATELY 84 FT. N32°W FROM WELLHEAD.DEPTH TO GROUNDWATER: >100 NEAREST WATER SOURCE: >1000 NEAREST SURFACE WATER: >1000NMOCD RANKING SCORE: 0 NMOCD TPH CLOSURE STD: 5000 PPM**SOIL AND EXCAVATION DESCRIPTION:**

OVM CALIB. READ. = 53.6 ppm
 OVM CALIB. GAS = 100 ppm RF = 0.52
 TIME: 1310 am/pm DATE: 2-6-04

SOIL TYPE: SAND / SILTY SAND / SILT / SILTY CLAY / CLAY / GRAVEL / OTHER CLAYSTONE BEDROCK @ 3' BESOIL COLOR: GRAY / GREENCOHESION (ALL OTHERS): NON COHESIVE / SLIGHTLY COHESIVE / COHESIVE / HIGHLY COHESIVE

CONSISTENCY (NON COHESIVE SOILS): LOOSE / FIRM / DENSE / VERY DENSE

PLASTICITY (CLAYS): NON PLASTIC / SLIGHTLY PLASTIC / COHESIVE / MEDIUM PLASTIC / HIGHLY PLASTIC

DENSITY (COHESIVE CLAYS & SILTS): SOFT / FIRM / STIFF / VERY STIFF / HARDMOISTURE: DRY / SLIGHTLY MOIST / MOIST / WET / SATURATED / SUPER SATURATEDDISCOLORATION/STAINING OBSERVED: YES NO EXPLANATION - MOISTUREHC ODOR DETECTED: YES / NO EXPLANATION - MODERATESAMPLE TYPE: GRAB / COMPOSITE - # OF PTS. 1ADDITIONAL COMMENTS: EARLIER PITBEDROCK BOTTOM**FIELD 418.1 CALCULATIONS**

SCALE

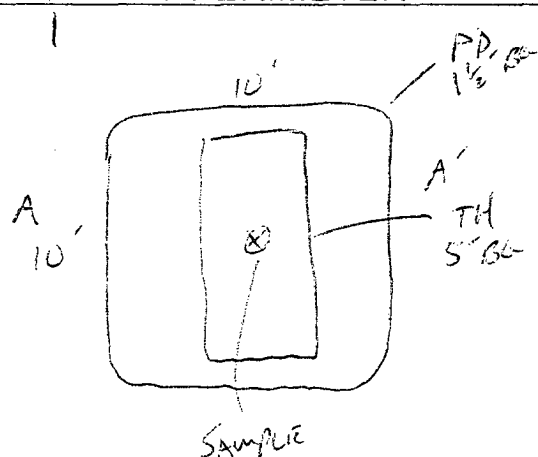

0 10 FT

PIT PERIMETER**OVM READING**

SAMPLE ID	FIELD HEADSPACE (ppm)
1 @ 5'	34.3
2 @	
3 @	
4 @	
5 @	

LAB SAMPLES

SAMPLE ID	ANALYSIS	TIME
1115	TPH/GTEX	1315
	<u>BOTH PASSED</u>	

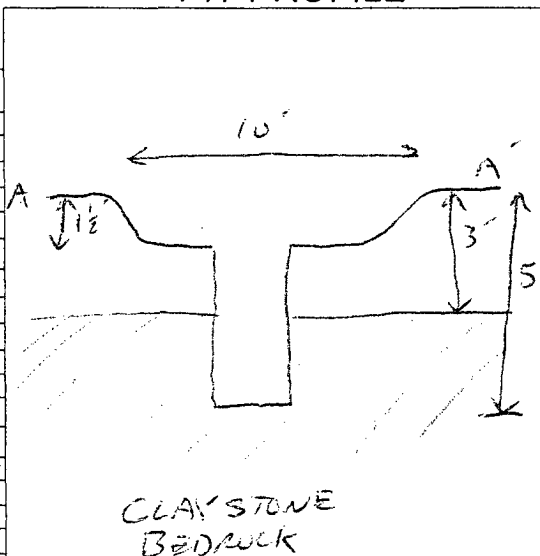
PIT PROFILE

P.D. = PIT DEPRESSION; B.G. = BELOW GRADE; B = BELOW
 T.H. = TEST HOLE; ~ = APPROX.; T.B. = TANK BOTTOM

TRAVEL NOTES:

CALLOUT: 2/6/04 0730ONSITE: 2/6/04 1300

ENVIROTECH LABS

PRACTICAL SOLUTIONS FOR A BETTER TOMORROW

EPA METHOD 8015 Modified Nonhalogenated Volatile Organics Total Petroleum Hydrocarbons

Client:	Blagg / BP	Project #:	94034-010
Sample ID:	1 @ 5'	Date Reported:	02-09-04
Laboratory Number:	27806	Date Sampled:	02-06-04
Chain of Custody No:	11826	Date Received:	02-06-04
Sample Matrix:	Soil	Date Extracted:	02-09-04
Preservative:	Cool	Date Analyzed:	02-09-04
Condition:	Cool and Intact	Analysis Requested:	8015 TPH

Parameter	Concentration (mg/Kg)	Det. Limit (mg/Kg)
Gasoline Range (C5 - C10)	17.2	0.2
Diesel Range (C10 - C28)	ND	0.1
Total Petroleum Hydrocarbons	17.2	0.2

ND - Parameter not detected at the stated detection limit.

References: Method 8015B, Nonhalogenated Volatile Organics, Test Methods for Evaluating Solid Waste, SW-846, USEPA, December 1996.

Comments: **Day B #4 Separator Pit.**

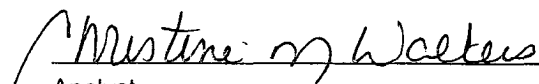
Analyst

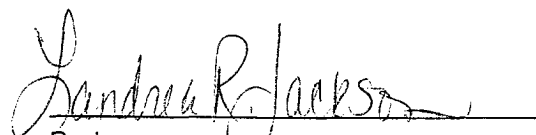
Review

ENVIROTECH LABS

PRACTICAL SOLUTIONS FOR A BETTER TOMORROW

EPA METHOD 8021 AROMATIC VOLATILE ORGANICS

Client:	Blagg / BP	Project #:	94034-010
Sample ID:	1 @ 5'	Date Reported:	02-09-04
Laboratory Number:	27806	Date Sampled:	02-06-04
Chain of Custody:	11826	Date Received:	02-06-04
Sample Matrix:	Soil	Date Analyzed:	02-09-04
Preservative:	Cool	Date Extracted:	02-09-04
Condition:	Cool & Intact	Analysis Requested:	BTEX

Parameter	Concentration (ug/Kg)	Det. Limit (ug/Kg)
Benzene	8.1	1.8
Toluene	390	1.7
Ethylbenzene	370	1.5
p,m-Xylene	1,400	2.2
o-Xylene	694	1.0
Total BTEX	2,860	

ND - Parameter not detected at the stated detection limit.

Surrogate Recoveries:	Parameter	Percent Recovery
	Fluorobenzene	95 %
	1,4-difluorobenzene	95 %
	Bromochlorobenzene	95 %

References: Method 5030B, Purge-and-Trap, Test Methods for Evaluating Solid Waste, SW-846, USEPA, December 1996.

Method 8021B, Aromatic Volatile Organics, Test Methods for Evaluating Solid Waste, SW-846, USEPA, December 1996.

Comments: Day B #4 Separator Pit.

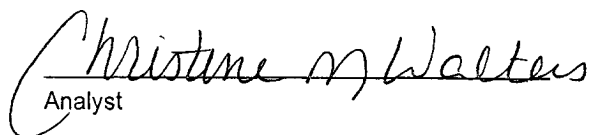
Analyst

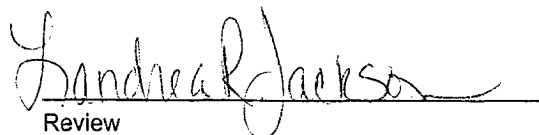
Review

CLIENT: BPBLAGG ENGINEERING, INC.
P.O. BOX 87, BLOOMFIELD, NM 87413
(505) 632-1199LOCATION NO: 31333

C.O.C. NO: _____

FIELD REPORT: LANDFARM/COMPOST PILE CLOSURE VERIFICATION

LOCATION: NAME: DAY B WELL #: 4 PITS: DEHY
QUAD/UNIT: M SEC: 8 TWP: 29N RNG: 8W PM: NM CNTY: ST ST: NM
QTR/FOOTAGE: SE/SE CONTRACTOR: _____DATE STARTED: 3/28/06
DATE FINISHED: _____ENVIRONMENTAL
SPECIALIST: NV

SOIL REMEDIATION:

REMEDICATION SYSTEM: LANDFARM

APPROX. CUBIC YARDAGE: _____

LAND USE: RANGE - BLNLIFT DEPTH (ft): 1-1.5

FIELD NOTES & REMARKS:

DEPTH TO GROUNDWATER: >100'NEAREST SURFACE WATER: >1,000'NEAREST WATER SOURCE: >1,000' NMOCD RANKING SCORE: 2 NMOCD TPH CLOSURE STD: 5,000 PPMSOIL TYPE: SAND SILTY SAND / SILT / SILTY CLAY / CLAY / GRAVEL / OTHER _____SOIL COLOR: OK. YEL. BROWN TO OLIVE BLACKCOHESION (ALL OTHERS): NON COHESIVE / SLIGHTLY COHESIVE / COHESIVE / HIGHLY COHESIVECONSISTENCY (NON COHESIVE SOILS): LOOSE / FIRM / DENSE / VERY DENSE

PLASTICITY (CLAYS): NON PLASTIC / SLIGHTLY PLASTIC / COHESIVE / MEDIUM PLASTIC / HIGHLY PLASTIC

~~DENSITY (COHESIVE CLAYS & SILTS):~~ SOFT / FIRM / STIFF / VERY STIFF / HARDMOISTURE: DRY / SLIGHTLY MOIST / MOIST / WET / SATURATED / SUPER SATURATEDDISCOLORATION/STAINING OBSERVED: YES / NO EXPLANATION - _____HC ODOR DETECTED: YES / NO EXPLANATION - _____SAMPLING DEPTHS (LANDFARMS): 5-15 (INCHES)SAMPLE TYPE: GRAB / COMPOSITE # OF PTS. 5

ADDITIONAL COMMENTS: _____

CLOSED

SKETCH/SAMPLE LOCATIONS

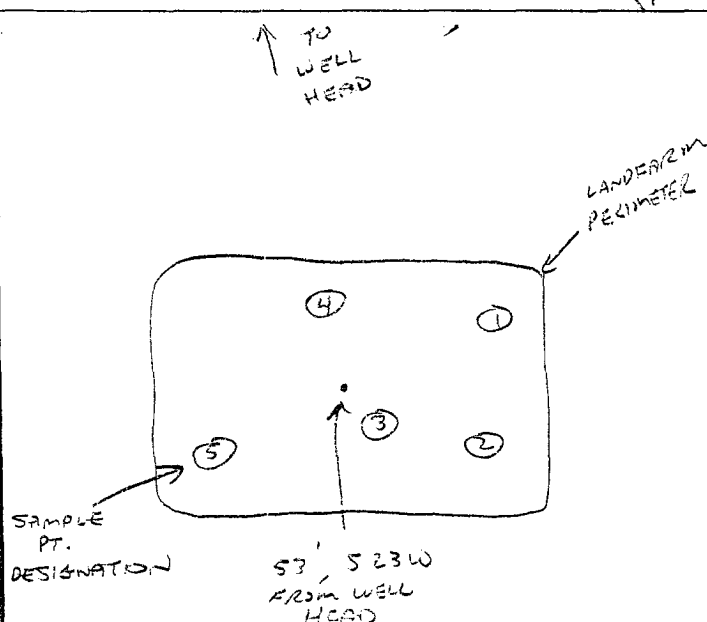
OVM CALIB. READ. = 53.6 ppm
OVM CALIB. GAS = 100 ppm RF = 0.52
TIME: 9:50 am/pm DATE: 3/24/06

OVM RESULTS

LAB SAMPLES

SAMPLE ID	FIELD HEADSPACE (ppm)	SAMPLE ID	ANALYSIS	TIME	RESULTS
LF-1	0.0	LF-1	TPH (80153)	1620	76.3

P.C. - 2/9/04

SCALE



0

FT

TRAVEL NOTES: CALLOUT: N/AONSITE: 3/24/06

ENVIROTECH LABS

PRACTICAL SOLUTIONS FOR A BETTER TOMORROW

EPA METHOD 8015 Modified Nonhalogenated Volatile Organics Total Petroleum Hydrocarbons

Client:	Blagg / BP	Project #:	94034-010
Sample ID:	LF - 1	Date Reported:	03-30-06
Laboratory Number:	36631	Date Sampled:	03-28-06
Chain of Custody No:	14613	Date Received:	03-29-06
Sample Matrix:	Soil	Date Extracted:	03-29-06
Preservative:	Cool	Date Analyzed:	03-30-06
Condition:	Cool and Intact	Analysis Requested:	8015 TPH

Parameter	Concentration (mg/Kg)	Det. Limit (mg/Kg)
Gasoline Range (C5 - C10)	ND	0.2
Diesel Range (C10 - C28)	76.3	0.1
Total Petroleum Hydrocarbons	76.3	0.2

ND - Parameter not detected at the stated detection limit.

References: Method 8015B, Nonhalogenated Volatile Organics, Test Methods for Evaluating Solid Waste, SW-846, USEPA, December 1996.

Comments: **Day B #4 Landfarm 5 Pt. Composite Sample.**

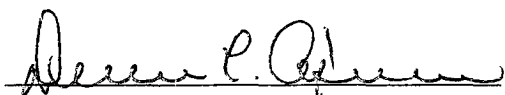
Analyst

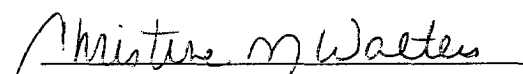
Review