

**UNITED STATES
DEPARTMENT OF THE INTERIOR
BUREAU OF LAND MANAGEMENT**

APPLICATION FOR PERMIT TO DRILL, DEEPEN, OR PLUG BACK

2007 MAR 13 PM 4:13

1a. Type of Work DRILL	5. Lease Number NMM-020504 Unit Reporting Number
1b. Type of Well GAS	6. If Indian, All. or Tribe
2. Operator BURLINGTON RESOURCES Oil & Gas Company, LP	7. Unit Agreement Name
3. Address & Phone No. of Operator PO Box 4289, Farmington, NM 87499 (505) 326-9700	8. Farm or Lease Name Cooper 9. Well Number #78
4. Location of Well Unit A (NENE), 735' FNL & 955' FEL, Latitude 36° 45.56854 N Longitude 108° 01.59334 W	10. Field, Pool, Wildcat Basin Fruitland Coal 11. Sec., Twn, Rge, Mer. (NMPM) Sec. 6, T29N, R11W API # 30-045-34237
14. Distance in Miles from Nearest Town 6 miles/Aztec	12. County San Juan 13. State NM
15. Distance from Proposed Location to Nearest Property or Lease Line 1235'	17. Acres Assigned to Well 310.38 (E/2)
16. Acres in Lease	
18. Distance from Proposed Location to Nearest Well, Drig, Compl, or Applied for on this Lease	
19. Proposed Depth 2225'	20. Rotary or Cable Tools Rotary
21. Elevations (DF, FT, GR, Etc.) 5826' GL	22. Approx. Date Work will Start RCVD JUN11'07
23. Proposed Casing and Cementing Program See Operations Plan attached	OIL CONS. DIV. DIST. 3
24. Authorized by <u><i>Rhonda Rogers</i></u> Rhonda Rogers (Regulatory Technician)	<u><i>3-13-07</i></u> Date

A

Lot 1

PERMIT NO. _____ APPROVAL DATE _____
APPROVED BY *D. Montez* TITLE *ATEM* DATE *6/7/07*

Archaeological Report attached
Threatened and Endangered Species Report attached ✓
NOTE: This format is issued in lieu of U.S. BLM Form 3160-3
Title 18 U.S.C. Section 1001, makes it a crime for any person knowingly and willfully to make to any department or agency of the United States any false, fictitious or fraudulent statements or presentations as to any matter within its jurisdiction.
Example Master Plan Type 2
DRILLING OPERATIONS AUTHORIZED ARE SUBJECT TO COMPLIANCE WITH ATTACHED "GENERAL REQUIREMENTS".
06-12-07 BH NMOCDO
This action is subject to technical and procedural review pursuant to 43 CFR 3165.3 and appeal pursuant to 43 CFR 3165.4
NOTIFY AZTEC OCD 24 HRS. PRIOR TO CASING & CEMENT

Submit 3 Copies To Appropriate District Office

State of New Mexico

Form C-103

District I

Energy, Minerals and Natural Resources

May 27, 2004

1625 N. French Dr., Hobbs, NM 88240

District II

1301 W. Grand Ave., Artesia, NM 88210

OIL CONSERVATION DIVISION

1220 South St. Francis Dr.

Santa Fe, NM 87505

District III

1000 Rio Brazos Rd., Aztec, NM 87410

District IV

1220 S. St. Francis Dr., Santa Fe, NM 87505

WELL API NO.	30-045-34237
5. Indicate Type of Lease	STATE <input type="checkbox"/> FEE <input type="checkbox"/>
6. State Oil & Gas Lease No.	NMNM - 020504
7. Lease Name or Unit Agreement Name	Cooper
8. Well Number	7S
9. OGRID Number	14538
10. Pool name or Wildcat	Fruitland Coal

SUNDRY NOTICES AND REPORTS ON WELLS (DO NOT USE THIS FORM FOR PROPOSALS TO DRILL OR TO DEEPEN OR PLUG BACK TO A DIFFERENT RESERVOIR. USE "APPLICATION FOR PERMIT" (FORM C-101) FOR SUCH PROPOSALS.)

1. Type of Well: Oil Well Gas Well Other

2. Name of Operator BURLINGTON RESOURCES OIL & GAS COMPANY LP

3. Address of Operator 3401 E. 30TH STREET, FARMINGTON, NM 87402

4. Well Location Unit Letter A : 735' feet from the North line and 955' feet from the East line Section 6 Township 29N Rng 11W NMPM County San Juan

11. Elevation (Show whether DR, RKB, RT, GR, etc.) 5826'

Pit or Below-grade Tank Application or Closure

Pit type New Drill Depth to Groundwater >100' Distance from nearest fresh water well >1000' Distance from nearest surface water <1000'

Pit Liner Thickness: 12 mil Below-Grade Tank: Volume bbls; Construction Material

12. Check Appropriate Box to Indicate Nature of Notice, Report or Other Data

NOTICE OF INTENTION TO:

PERFORM REMEDIAL WORK PLUG AND ABANDON TEMPORARILY ABANDON CHANGE PLANS PULL OR ALTER CASING MULTIPLE COMPL

OTHER: New Drill

SUBSEQUENT REPORT OF:

REMEDIAL WORK ALTERING CASING COMMENCE DRILLING OPNS. P AND A CASING/CEMENT JOB

OTHER:

13. Describe proposed or completed operations. (Clearly state all pertinent details, and give pertinent dates, including estimated date of starting any proposed work). SEE RULE 1103. For Multiple Completions: Attach wellbore diagram of proposed completion or recompletion.

New Drill, Lined:

Burlington Resources proposes to construct a new drilling pit and an associated vent/flare pit. Based on Burlington's interpretation of the Ecosphere's risk ranking criteria, the new drilling pit will be a lined pit as detailed in Burlington's Revised Drilling / Workover Pit Construction / Operation Procedures dated November 11, 2004 on file at the NMOCD office. A portion of the vent/flare pit will be designed to manage fluids and that portion will be lined as per the risk ranking criteria. Burlington Resources anticipates closing these pits according to the Drilling / Workover Pit Closure Procedure dated August 2, 2004 on file at the NMOCD office.

I hereby certify that the information above is true and complete to the best of my knowledge and belief. I further certify that any pit or below-grade tank has been/will be constructed or closed according to NMOCD guidelines , a general permit or an (attached) alternative OCD-approved plan .

SIGNATURE Kandis Roland TITLE Regulatory Technician DATE 2/27/2007

Type or print name Kandis Roland E-mail address: kburns@br-inc.com Telephone No. 505-326-9701

APPROVED BY [Signature] TITLE Deputy Oil & Gas Inspector, District #3 DATE JUN 12 2007

Conditions of Approval (if any):

LATITUDE: 36.75948°N
 LONGITUDE: 108.02718°W
 DATUM: NAD 83

SLOPES TO BE CONSTRUCTED TO
 MATCH THE ORIGINAL CONTOURS
 AS CLOSE AS POSSIBLE.

BURLINGTON RESOURCES O&G CO LP

COOPER #7S

735' FNL & 965' FEL

LOCATED IN THE NE/4 NE/4 OF
 SECTION 6, T29N, R11W, N.M.P.M.,
 SAN JUAN COUNTY, NEW MEXICO
 GROUND ELEVATION: 5826', NAVD 88
 FINISHED PAD ELEVATION: 5826.3', NAVD 88

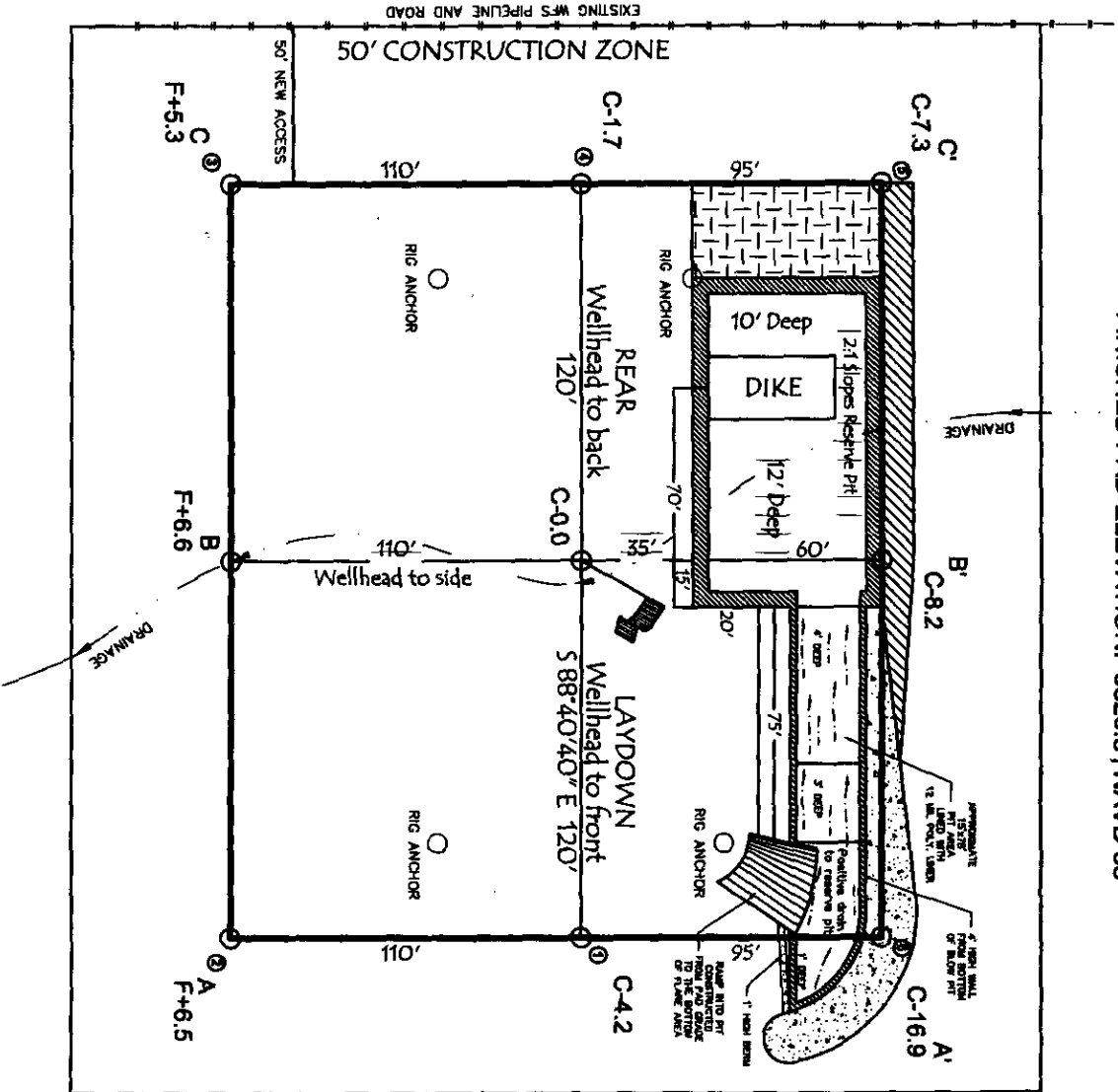
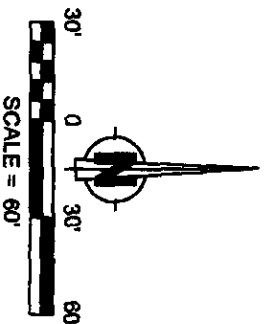

130' x 400' = 3.03 ACRES OF DISTURBANCE
 SCALE: 1" = 60'
 JOB No.: COPC057
 DATE: 12/12/06

NOTE:
 RESERVE PIT DIKE: TO BE 8' ABOVE DEEP SIDE (OVERFLOW - 3' WIDE AND 1' ABOVE SHALLOW SIDE).
 RUSSELL SURVEYING, INC. IS NOT LIABLE FOR UNDERGROUND UTILITIES OR PIPELINES.
 CONTRACTOR SHOULD CALL ONE-CALL FOR LOCATION OF ANY MARKED OR UNMARKED, BURIED PIPELINES OR
 CABLES ON WELL PAD, IN CONSTRUCTION ZONE AND/OR ACCESS ROAD AT LEAST TWO (2) WORKING DAYS PRIOR
 TO CONSTRUCTION.

Russell Surveying
 1408 W. Aztec Blvd. #5
 Aztec, New Mexico 87410
 (505) 334-8637

LATITUDE: 36.75948°N
 LONGITUDE: 108.02718°W
 DATUM: NAD 83

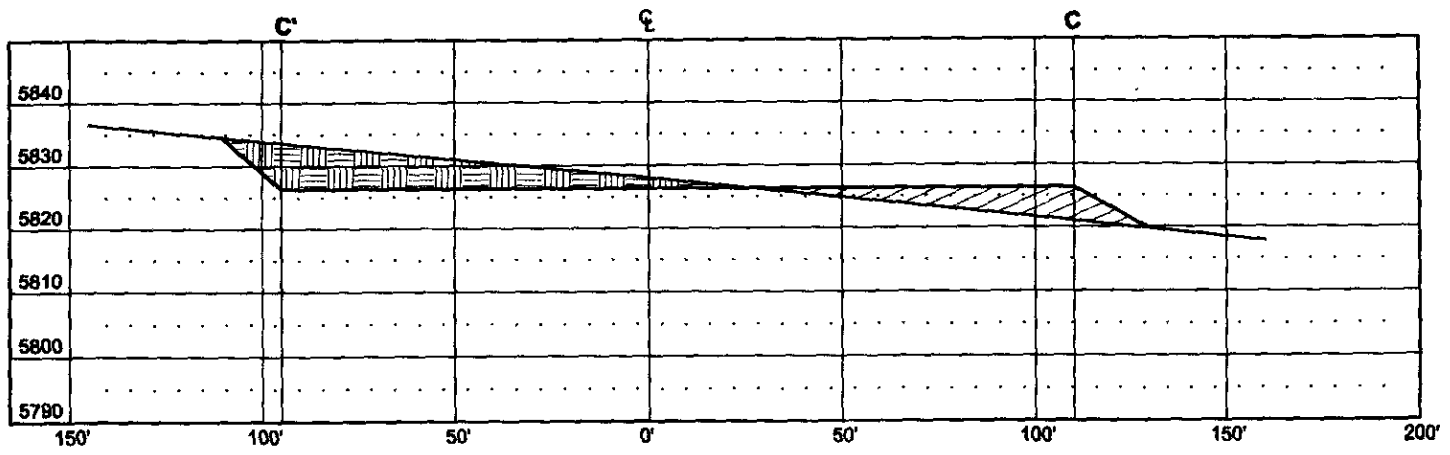
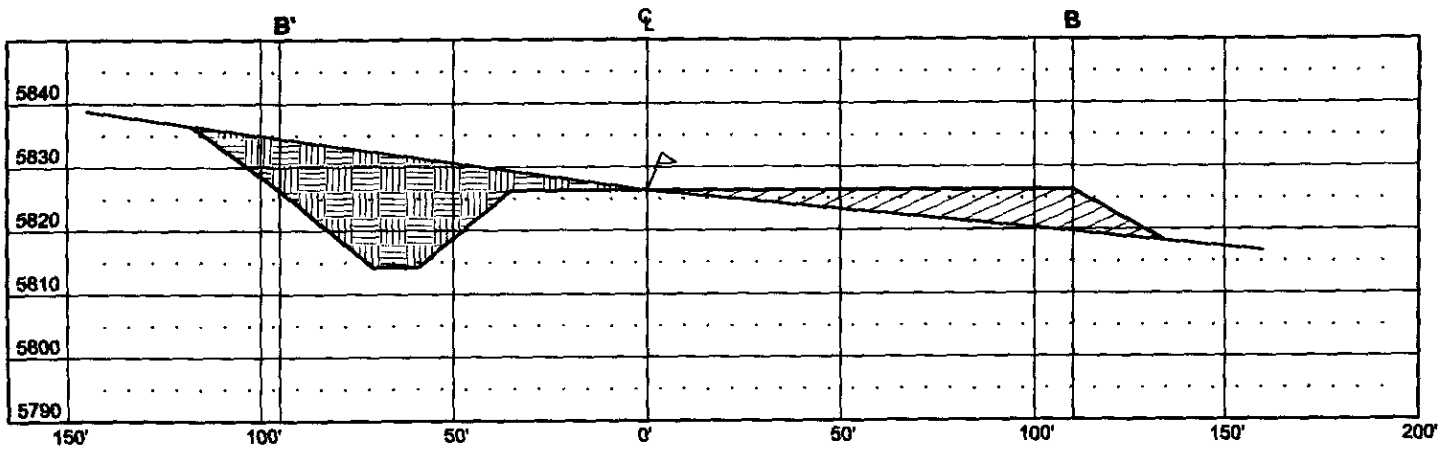
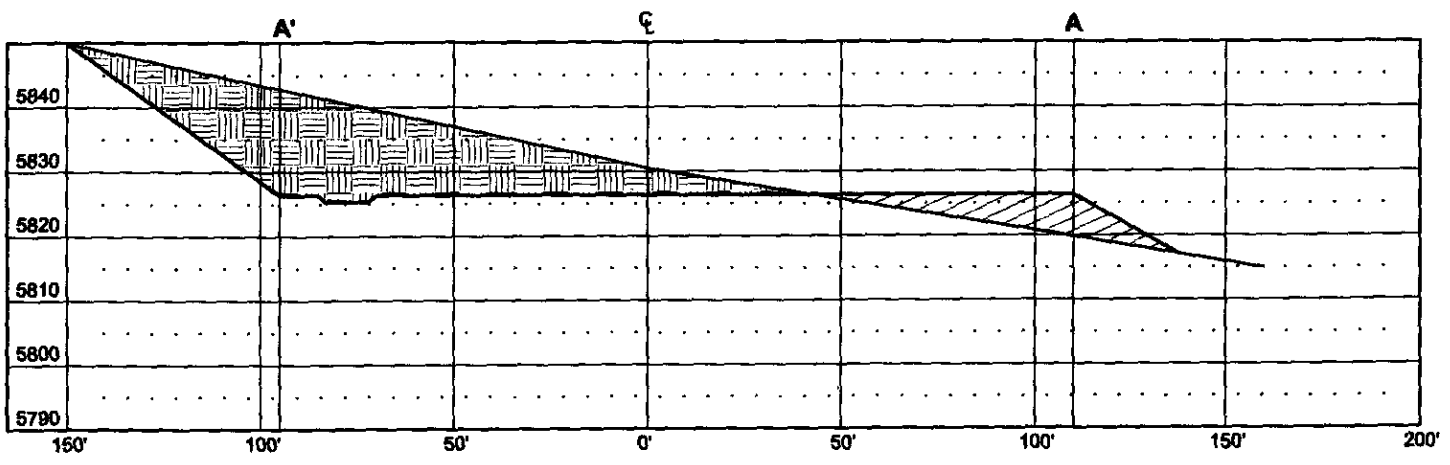

BURLINGTON RESOURCES O&G CO LP

COOPER #7S
 735' FNL & 955' FEL
 LOCATED IN THE NE/4 NE/4 OF
 SECTION 6, T29N, R11W, N.M.P.M.,
 SAN JUAN COUNTY, NEW MEXICO
 GROUND ELEVATION: 5826', NAVD 88
 FINISHED PAD ELEVATION: 5826.3', NAVD 88



THIS DIAGRAM IS AN ESTIMATE OF DIRT BALANCE AND IS NOT INTENDED TO BE AN EXACT MEASURE OF VOLUME

ERT. SCALE: 1" = 30'
 ORZ. SCALE: 1" = 50'
 JB No.: COPC057
 ATE: 12/12/06

 CUT
 FILL

 **Russell Surveying**
 1409 W. Aztec Blvd. #5
 Aztec, New Mexico 87410
 (505) 334-8637

PROJECT PROPOSAL - New Drill / Sidetrack

San Juan Business Unit

COOPER 7S

DEVELOPMENT

Lease:	AFE #: WAN.CDR.7052		AFE \$: 252,525.09	
Field Name: hBR_SAN JUAN	Rig: Aztec Rig 580	State: NM	County: SAN JUAN	API #:
Geoscientist: Clark, Dave D	Phone: 505-326-9762	Prod. Engineer:	Phone:	
Res. Engineer: Schlabaugh, Jim L	Phone: 505-326-9788	Proj. Field Lead:	Phone:	

Primary Objective (Zones):

Zone	Zone Name
JCV	BASIN FRUITLAND COAL (GAS)

Location: Surface Datum Code: NAD 27 Straight Hole

Latitude: 36.759476	Longitude: -108.026556	X:	Y:	Section: 06	Range: 011W
Footage X: 955 FEL	Footage Y: 735 FNL	Elevation: 5826	(FT)	Township: 029N	

Tolerance:

Location Type: Year Round	Start Date (Est.):	Completion Date:	Date In Operation:
---------------------------	--------------------	------------------	--------------------

Formation Data: Assume KB = 5838 Units = FT

Formation Call & Casing Points	Depth (TVD in Ft)	SS (Ft)	Depletion (Yes/No)	BHP (PSIG)	BHT	Remarks
SURFACE CSG	120	5718	<input type="checkbox"/>			8-3/4" hole. 7" 20 ppf J-55 STC casing. Circulate cement to surface. Cement with 50 cuft.
OJO ALAMO	673	5165	<input type="checkbox"/>			Possible water
KIRTLAND	775	5063	<input type="checkbox"/>			
FRUITLAND	1698	4140	<input type="checkbox"/>			Gas
PICTURED CLIFFS	2025	3813	<input type="checkbox"/>			
Total Depth	2225	3613	<input type="checkbox"/>	300		6-1/4" hole. 4-1/2" 10.5 ppf J-55 STC casing. Circulate cement to surface. Cement with 342 cuft.

Reference Wells:

Reference Type	Well Name	Comments
----------------	-----------	----------

Logging Program:

Intermediate Logs: Log only if show GR/ILD Triple Combo

TD Logs: Triple Combo Dipmeter RFT Sonic VSP TDT Other
GR/CBL

Additional Information:

Log Type	Stage	From (Ft)	To (Ft)	Tool Type/Name	Remarks
----------	-------	-----------	---------	----------------	---------

Comments: Location/Tops/Logging - FCNM029N011W06NE1 Nearest offset is Federal 6-B NE06-29N-11W.

Zones - FCNM029N011W06NE1

General/Work Description - MAKE SURE COST INCLUDE JET PUMP.