

UNITED STATES
DEPARTMENT OF THE INTERIOR
BUREAU OF LAND MANAGEMENT

APPLICATION FOR PERMIT TO DRILL, DEEPEN, OR PLUG BACK

1a. Type of Work DRILL	5. Lease Number SF-079289 Unit Reporting Number
1b. Type of Well GAS	6. If Indian, All. or Tribe
2. Operator ConocoPhillips	7. Unit Agreement Name San Juan 28-7 Unit
3. Address & Phone No. of Operator PO Box 4289, Farmington, NM 87499 (505) 326-9700	8. Farm or Lease Name 9. Well Number #220F
4. Location of Well Surf:Unit F (SENW), 1590' FNL & 1845' FWL, Unit D (NWNW), 1000' FNL & 500' FWL, Surf:Latitude 36° .649602 N Longitude 107° 562993 W BH:Latitude 36° .653337 N Longitude 107° .567555 W	10. Field, Pool, Wildcat Blanco MV/Basin DK 11. Sec., Twn, Rge, Mer. (NMPM) F Sec. 22, T28N, R7W API # 30-039- 30289
14. Distance in Miles from Nearest Town 24 miles/Blanco	12. County Rio Arriba 13. State NM
15. Distance from Proposed Location to Nearest Property or Lease Line 500'	
16. Acres in Lease 1304.48	17. Acres Assigned to Well MV/DK 320 (W/2)
18. Distance from Proposed Location to Nearest Well, Drlg, Compl, or Applied for on this Lease 130' from San Juan 28-7 220M	
19. Proposed Depth 7952' (TVD)/8288' (TMD)	20. Rotary or Cable Tools Rotary
21. Elevations (DF, FT, GR, Etc.) 6805' GL	22. Approx. Date Work will Start RCVD JUL 23 '07 OIL-CONS. DIV. DIST. 3
23. Proposed Casing and Cementing Program See Operations Plan attached	
24. Authorized by: Rhonda Rogers (Regulatory Technician)	6-25-07 Date

PERMIT NO.

APPROVAL DATE

APPROVED BY

TITLE

DATE

Archaeological Report attached

Threatened and Endangered Species Report attached

NOTE: This format is issued in lieu of U.S. BLM Form 3160-3

Title 18 U.S.C. Section 1001, makes it a crime for any person knowingly and willfully to make to any department or agency of the United States any false, fictitious or fraudulent statements or presentations as to any matter within its jurisdiction.

Example Master Plan Type 3

This action is subject to technical and
procedural review pursuant to 43 CFR 3165.3
and appeal pursuant to 43 CFR 3165.4

NOTIFY AZTEC OCD 24 HRS.
PRIOR TO CASING & CEMENT

HOLD 0104 FOR Directional Survey

DRILLING OPERATIONS AUTHORIZED ARE
SUBJECT TO COMPLIANCE WITH ATTACHED
"GENERAL REQUIREMENTS".

District I
PO Box 1980, Hobbs, NM 88241-1980

District II
PO Drawer DD, Artesia, NM 88211-0719

District III
1000 Rio Brazos Rd., Aztec, NM 87410

District IV
PO Box 2088, Santa Fe, NM 87504-2088

State of New Mexico
Energy, Minerals & Natural Resources Department

Form C-102
Revised February 21, 1994
Instructions on back
Submit to Appropriate District Office
State Lease - 4 Copies
Fee Lease - 3 Copies

OIL CONSERVATION DIVISION
PO Box 2088
Santa Fe, NM 87504-2088

RECEIVED
210 F187
AMENDED REPORT

WELL LOCATION AND ACREAGE DEDICATION PLAT

*API Number 30-039-30289		*Pool Code 72319 / 71599	*Pool Name BLANCO MESAVERDE / BASIN DAKOTA
*Property Code 31739	*Property Name SAN JUAN 28-7 UNIT		*Well Number 220F
*OGRID No 217817	*Operator Name CONOCOPHILLIPS COMPANY		*Elevation 6805

10 Surface Location

UL or lot no.	Section	Township	Range	Lot Idn	Feet from the	North/South line	Feet from the	East/West line	County
F	22	28N	7W		1590	NORTH	1845	WEST	RIO ARriba

11 Bottom Hole Location If Different From Surface

UL or lot no.	Section	Township	Range	Lot Idn	Feet from the	North/South line	Feet from the	East/West line	County
D	22	28N	7W		1000	NORTH	500	WEST	RIO ARriba

12 Dedicated Acres 320.0 Acres - W/2 (MV)
320.0 Acres - W/2 (DK)

13 Joint or Infill

14 Consolidation Code

15 Order No.

BOTTOM-HOLE LOCATION
LAT: 36°39.0729' N
LONG: 107°34.0553' W
DATUM: NAD27

NO ALLOWABLE WILL BE ASSIGNED TO THIS COMPLETION UNTIL ALL INTERESTS HAVE BEEN CONSOLIDATED OR A NON-STANDARD UNIT HAS BEEN APPROVED BY THE DIVISION

	<p>17 OPERATOR CERTIFICATION</p> <p>I hereby certify that the information contained herein is true and complete to the best of my knowledge and belief</p> <p><i>Virgil E. Chavez</i> Signature Virgil E. Chavez Printed Name Projects & Operations Lead Title December 1, 2007 Date</p> <p>18 SURVEYOR CERTIFICATION</p> <p>I hereby certify that the well location shown on this plat was plotted from field notes of actual surveys made by me or under my supervision, and that the same is true and correct to the best of my belief</p> <p>Date of Survey: JULY 6, 2006</p> <p>Signature and Seal of Professional Surveyor</p> <p><i>JASON C. EDWARDS</i> 15269 REGISTERED PROFESSIONAL SURVEYOR NEW MEXICO</p> <p><i>JASON C. EDWARDS</i> Certificate Number 15269</p>
--	---

District I
1625 N. French Dr., Hobbs, NM 88240
District II
1301 W. Grand Ave., Artesia, NM 88210
District III
1000 Rio Brazos Rd., Aztec, NM 87410
District IV
1220 S. St. Francis Dr., Santa Fe, NM 87505

Energy, Minerals and Natural Resources

OIL CONSERVATION DIVISION
1220 South St. Francis Dr.
Santa Fe, NM 87505

WELL API NO.	30-039- 30289
5. Indicate Type of Lease	STATE <input type="checkbox"/> FEE <input type="checkbox"/>
6. State Oil & Gas Lease No.	Federal Lease SF-079289
7. Lease Name or Unit Agreement Name	San Juan 28-7
8. Well Number	#220F
9. OGRID Number	217817
10. Pool name or Wildcat	Blanco MV/Basin DK

SUNDY NOTICES AND REPORTS ON WELLS
(DO NOT USE THIS FORM FOR PROPOSALS TO DRILL OR TO DEEPEN OR PLUG BACK TO A DIFFERENT RESERVOIR USE "APPLICATION FOR PERMIT" (FORM C-101) FOR SUCH PROPOSALS.)

1. Type of Well: Oil Well ☐ Gas Well ☒ Other: _____

2. Name of Operator
ConocoPhillips

3. Address of Operator
3401 E. 30TH STREET, FARMINGTON, NM 87402

4. Well Location
Unit Letter **F** : **1590'** feet from the **North** line and **1845'** feet from the **West** line
Section **22** Township **28N** Rng **7W** NMPM County **Rio Arriba**

11. Elevation (Show whether DR, RKB, RT, GR, etc.)
6805'

Pit or Below-grade Tank Application ☐ or Closure ☐

Pit type **New Drill** Depth to Groundwater **>100** Distance from nearest fresh water well **>1000'** Distance from nearest surface water **>1000**

Pit Liner Thickness: **NA** mil Below-Grade Tank: **Volume** bbls; Construction Material _____

12. Check Appropriate Box to Indicate Nature of Notice, Report or Other Data

NOTICE OF INTENTION TO:		SUBSEQUENT REPORT OF:	
PERFORM REMEDIAL WORK <input type="checkbox"/>	PLUG AND ABANDON <input type="checkbox"/>	REMEDIAL WORK <input type="checkbox"/>	ALTERING CASING <input type="checkbox"/>
TEMPORARILY ABANDON <input type="checkbox"/>	CHANGE PLANS <input type="checkbox"/>	COMMENCE DRILLING OPNS. <input type="checkbox"/>	P AND A <input type="checkbox"/>
PULL OR ALTER CASING <input type="checkbox"/>	MULTIPLE COMPL. <input type="checkbox"/>	CASING/CEMENT JOB <input type="checkbox"/>	
OTHER: New Drill <input checked="" type="checkbox"/>		OTHER: <input type="checkbox"/>	

13. Describe proposed or completed operations. (Clearly state all pertinent details, and give pertinent dates, including estimated date of starting any proposed work). SEE RULE 1103. For Multiple Completions: Attach wellbore diagram of proposed completion or recompletion.

New Drill, Unlined:

ConocoPhillips proposes to construct a new drilling pit, an associated vent/flare pit and a pre-set mud pit (if required). Based on ConocoPhillips' interpretation of the Ecosphere's risk ranking criteria, the new drilling pit and pre-set mud pit will be unlined pits as detailed in ConocoPhillips' General Plan dated June 2005 on file at the NMOCD office. A portion of the vent/flare pit will be designed to manage fluids and that portion will be unlined as per the risk ranking criteria. ConocoPhillips anticipates closing these pits according to the November 1, 2004 Guidelines.

I hereby certify that the information above is true and complete to the best of my knowledge and belief. I further certify that any pit or below-grade tank has been/will be constructed or closed according to NMOCD guidelines ☐, a general permit ☒ or an (attached) alternative OCD-approved plan ☐.

SIGNATURE *Rhonda Rogers* TITLE Regulatory Technician DATE 6-25-07

Type or print name Rhonda Rogers E-mail address: rogerr@conocophillips.com Telephone No. 505-599-4018

For State Use Only

APPROVED BY *[Signature]* TITLE Deputy Oil & Gas Inspector, District #3 DATE JUL 24 2007

Conditions of Approval (if any):

MESAVERDE/DAKOTA LAYOUT

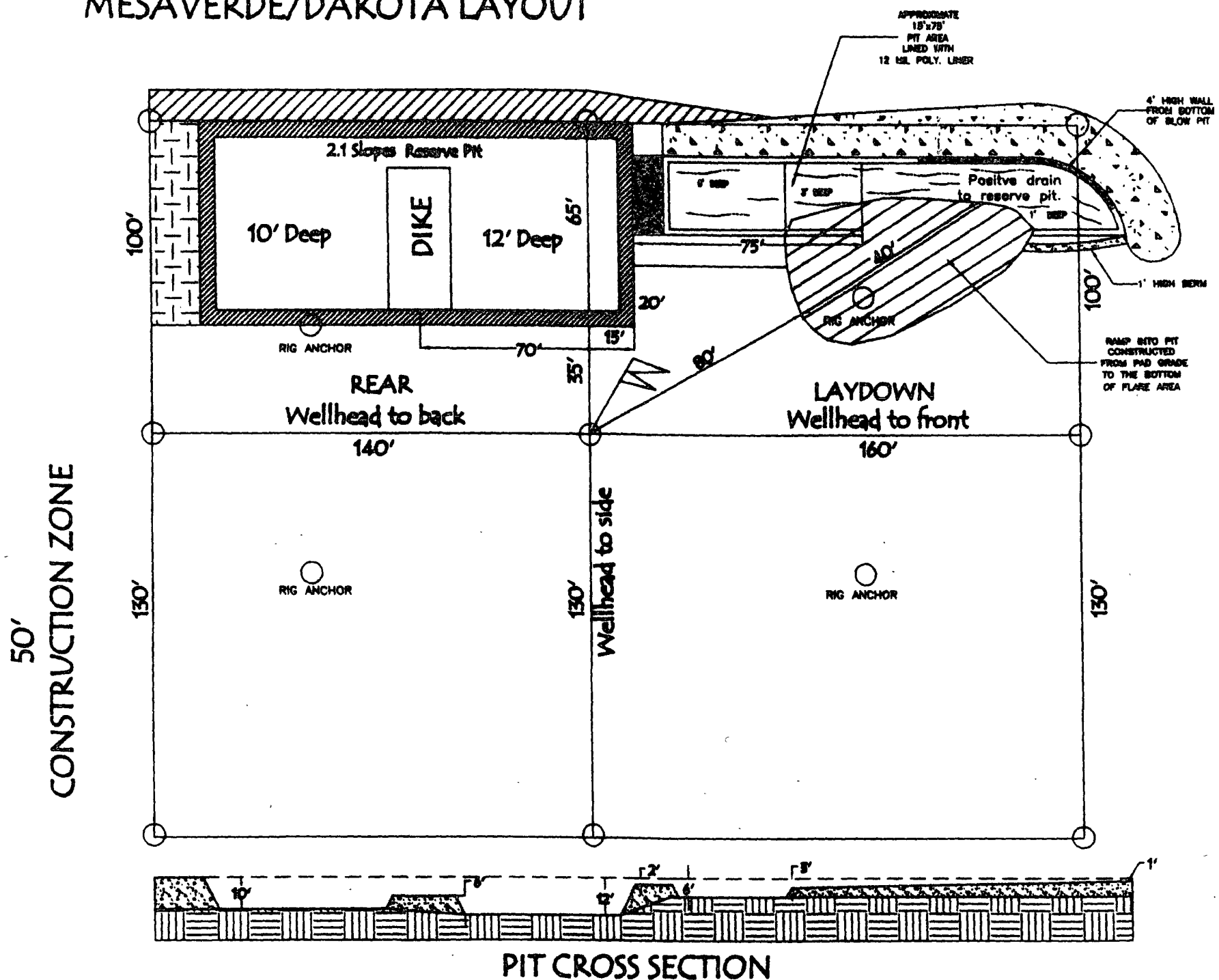

LATITUDE: 36.64961° N
LONGITUDE: 107.56360° W
DATUM: NAD1983

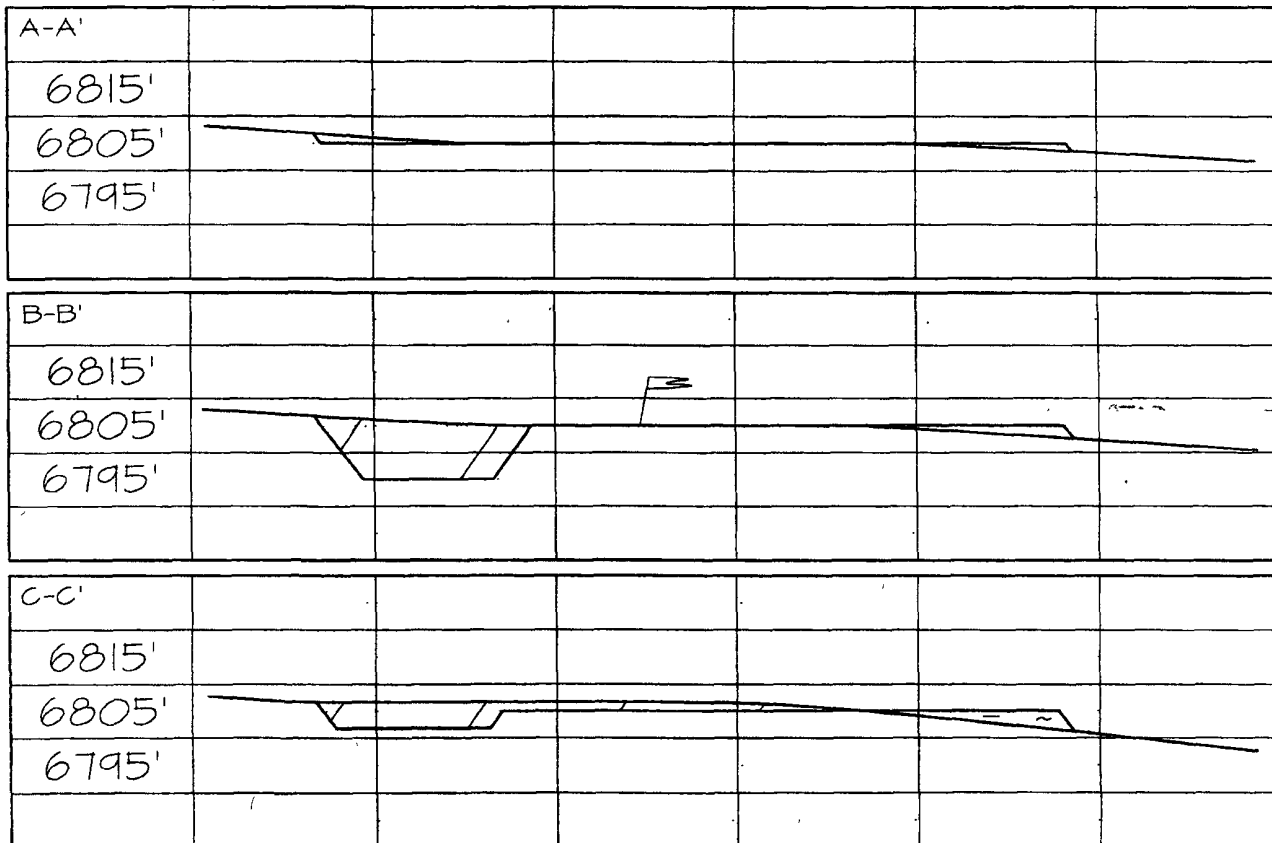

PROJECT PROPOSAL - New Drill / Sidetrack

San Juan Business Unit

SAN JUAN 28-7 UNIT 220F

DEVELOPMENT

Lease:		AFE #: WAN.CNV.7166		AFE \$:	
Field Name: 28-7		Rig: Aztec Rig 777		State: NM	County: RIO ARRIBA
Geologist:		Phone:		Geophysicist:	
Geoscientist: Glaser, Terry J		Phone: (832)486-2332		Prod. Engineer: Fontenot, Jessie C	
Res. Engineer: Johnson, Tom B.		Phone: (832)-486-2347		Phone: +1 832-486-3483	
Proj. Field Lead: Franssen, Eric E.		Phone:			
Primary Objective (Zones):					
Zone	Zone Name				
R20002	MESAVERDE(R20002)				
R20076	DAKOTA(R20076)				
Location: Surface Datum Code: NAD 27 Deviated					
Latitude: 36.649602	Longitude: -107.562993	X:	Y:	Section: 22	Range: 007W
Footage X: 1845 FWL	Footage Y: 1590 FNL	Elevation:	(FT)	Township: 028N	
Tolerance:					
Location: Bottom Hole Datum Code: NAD 27 Deviated					
Latitude: 36.653337	Longitude: -107.567555	X:	Y:	Section: 22	Range: 007W
Footage X: 500 FWL	Footage Y: 1000 FNL	Elevation: 6805	(FT)	Township: 028N	
Tolerance:					
Location Type: Year Round		Start Date (Est.):		Completion Date:	
				Date In Operation:	
Formation Data: Assume KB = 6819 Units = FT					
Formation Call & Casing Points	Depth (TVD in Ft)	SS (Ft)	Depletion (Yes/No)	BHP (PSIG)	BHT
SURFACE CSG	200	6619	<input type="checkbox"/>		
OJAM	2647	4172	<input type="checkbox"/>		
KRLD	2743	4076	<input type="checkbox"/>		
FRLD	3054	3765	<input type="checkbox"/>		
PCCF	3476	3343	<input type="checkbox"/>		
LEWS	3585	3234	<input type="checkbox"/>		
HURF	4096	2723	<input type="checkbox"/>		
Intermediate Casing	4000' 4336	2483	<input type="checkbox"/>		
CHRA	4428	2391	<input type="checkbox"/>		
MASSIVE CLIFF HOUSE	5108	1711	<input type="checkbox"/>		
MENF	5264	1555	<input type="checkbox"/>		
PTLK	5663	1156	<input type="checkbox"/>		
MNCS	6152	667	<input type="checkbox"/>		
GLLP	6894	-75	<input type="checkbox"/>		
GRHN	7633	-814	<input type="checkbox"/>		
GRRS	7704	-885	<input type="checkbox"/>		
TWLS	7738	-919	<input type="checkbox"/>		
PAGUATE	7829	-1010	<input type="checkbox"/>		
CBBO	7854	-1035	<input type="checkbox"/>		
CBRL	7882	-1063	<input type="checkbox"/>		
ENCN	7952	-1133	<input type="checkbox"/>		

PROJECT PROPOSAL - New Drill / Sidetrack

SAN JUAN 28-7 UNIT 220F

DEVELOPMENT

TD	7952	-1133	<input type="checkbox"/>	2500	6-1/4" Hole. 4-1/2", 10.5/11.6 ppf, J-55 STC/LTC casing. Cement with 539 cuft. Circulate cement a minimum of 100' inside the previous casing string.
----	------	-------	--------------------------	------	--

Reference Wells:		
Reference Type	Well Name	Comments
Intermediate	SJ 28-7 #220M	nearby pad
Intermediate	SJ 28-7 #194	NE 21-28N-7W
Intermediate	SJ 28-7 #49	NE 21-28N-7W

Logging Program:	
Intermediate Logs:	<input type="checkbox"/> Log only if show <input type="checkbox"/> GR/ILD <input type="checkbox"/> Triple Combo

TD Logs:	<input type="checkbox"/> Triple Combo <input type="checkbox"/> Dipmeter <input type="checkbox"/> RFT <input type="checkbox"/> Sonic <input type="checkbox"/> VSP <input type="checkbox"/> TDT <input checked="" type="checkbox"/> Other
----------	---

GR_CBL

Mudlog from 100' above GRHN to TD - mudlogger will call TD.

Additional Information:					
Log Type	Stage	From (Ft)	To (Ft)	Tool Type/Name	Remarks

Comments: Location/Tops/Logging - Surface loc changed to accommodate a 4 well pad. Surf will be near the #220M (1,490 FNL 1,800 FWL) DK 28N07W22NW2 MVNM028N007W22NW2

Zones - This is part of a 4 well pad drill. Surface was moved to a location NEAR the existing #220M (1,490 FNL 1,800 FWL). Pad will need to be the right size/shape to accommodate a 4 well pad. Make sure there's enough room.
DK 28N07W22NW2 MVNM028N007W22NW2

General/Work Description - Moved from 2007 to 2008 per Z. Stradling 4/4/7 - LM
80/80 Kd/Kmv Directional

ConocoPhillips or its affiliates

Survey Report

Company: ConocoPhillips Lower 48	Local Co-ordinate Reference: Site Monty's Site for directional MV/DK wells
Project: San Juan Basin	TVD Reference: WELL @ 6820.0ft (Original Well Elev)
Site: Monty's Site for directional MV/DK wells	MD Reference: WELL @ 6820.0ft (Original Well Elev)
Well: SJ 28-7 #220F	North Reference: True
Wellbore: SJ 28-7 #220F	Survey Calculation Method: Minimum Curvature
Design: Plan #1	Database: EDM Central Planning

Planned Survey

Measured Depth (ft)	Inclination (d)	Azimuth (d)	Vertical Depth (ft)	+N/-S (ft)	+E/-W (ft)	Vertical Section (ft)	Dogleg Rate (d/100ft)	Build Rate (d/100ft)	Turn Rate (d/100ft)
8,200.0	0.00	0.00	7,864.1	590.0	-1,345.0	1,468.7	0.00	0.00	0.00
8,217.9	0.00	0.00	7,882.0	590.0	-1,345.0	1,468.7	0.00	0.00	0.00
Lower Cubero									
8,287.9	0.00	0.00	7,952.0	590.0	-1,345.0	1,468.7	0.00	0.00	0.00
Encinal - TD - SJ 28-7 #220F - PCP									

Targets

Target Name - hit/miss target - Shape	Dip Angle (d)	Dip Dir. (d)	TVD (ft)	+N/-S ft	+E/-W ft	Northing (ft)	Easting (ft)	Latitude	Longitude
SJ 28-7 #220F - ICF - plan hits target - Point	0.00	0.00	4,000.0	590.0	-1,345.0	609.35	-1,336.67	30° 59' 30.351" N	109° 25' 59.545" W
SJ 28-7 #220F - PCI - plan hits target - Point	0.00	0.00	7,952.0	590.0	-1,345.0	609.35	-1,336.67	30° 59' 30.351" N	109° 25' 59.545" W

Formations

Measured Depth (ft)	Vertical Depth (ft)	Name	Lithology	Dip (d)	Dip Direction (d)
1,497.1	1,434.0	Nacimiento		0.00	
2,881.7	2,647.0	Ojo Alamo		0.00	
2,992.5	2,744.0	Kirtland		0.00	
3,346.3	3,054.0	Fruitland		0.00	
3,804.1	3,475.0	Pictured Cliffs		0.00	
3,917.6	3,585.0	Lewis		0.00	
4,431.9	4,096.0	Huerfano Bentonite		0.00	
4,763.9	4,428.0	Chacra		0.00	
5,463.9	5,128.0	Mass. Cliffhouse		0.00	
5,599.9	5,264.0	Menefee		0.00	
5,998.9	5,663.0	Pt. Lookout		0.00	
6,487.9	6,152.0	Mancos Shale		0.00	
7,229.9	6,894.0	Gallup		0.00	
7,968.9	7,633.0	Greenhorn		0.00	
8,039.9	7,704.0	Graneros		0.00	
8,073.9	7,738.0	Two Wells		0.00	
8,189.9	7,854.0	Upper Cubero		0.00	
8,217.9	7,882.0	Lower Cubero		0.00	
8,287.9	7,952.0	Encinal		0.00	
8,287.9	7,952.0	TD		0.00	

Checked By: _____	Approved By: _____	Date: _____
-------------------	--------------------	-------------