

495

61-30-039-07348

5

142-30-039-20146

460-30-039-25032

DATA SHEET FOR DEEP GROUND BED CATHODIC PROTECTION WELLS  
NORTHWESTERN NEW MEXICO

(Submit 3 copies to OCD Aztec Office)

Operator MERIDIAN OIL Location: Unit SW Sec 21 Twp 28 Rng 6

Name of Well/Wells or Pipeline Serviced SAN JUAN 28-6 UNIT #61, #142, #460

cps 1164w

Elevation 6331' Completion Date 8/5/77 Total Depth 480' Land Type\* N/A

Casing, Sizes, Types & Depths N/A

If Casing is cemented, show amounts & types used N/A

If Cement or Bentonite Plugs have been placed, show depths & amounts used

N/A

Depths & thickness of water zones with description of water when possible:

Fresh, Clear, Salty, Sulphur, Etc. 185' - 200'

Depths gas encountered: N/A

Type & amount of coke breeze used: 54 SACKS

Depths anodes placed: 435', 425', 415', 405', 370', 360', 340', 330', 320', 300'

Depths vent pipes placed: 440'

Vent pipe perforations: 300'

Remarks: gb #1

**RECEIVED**  
MAY 31 1991  
CON. DIV.

If any of the above data is unavailable, please indicate so. Copies of all logs, including Drillers Log, Water Analyses & Well Bore Schematics should be submitted when available. Unplugged abandoned wells are to be included.

\*Land Type may be shown: F-Federal; I-Indian; S-State; P-Fee.  
If Federal or Indian, add Lease Number.

WELL CASING  
CATHODIC PROTECTION CONSTRUCTION REPORT  
DAILY LOG

Drilling Log (Attach Here),

Completion Date **8-5-77**

Well Name <b>SAN JUAN 28-6 UNIT # 61</b>		Location <b>SW 21-28-6</b>		CPS No. <b>1164W</b>	
Type & Size Bit Used <b>6 3/4"</b>				Work Order No. <b>#61=40015.19</b> <b>#142=54564.19</b>	
Anode Hole Depth <b>Logged</b> <b>480 - 455</b>	Total Drilling Rig Time	Total Lbs. Coke Used <b>54</b>	Lost Circulation Mat'l Used	No. Sacks Mud Used	
Anode Depth					
# 1 <b>435</b>	# 2 <b>425</b>	# 3 <b>415</b>	# 4 <b>405</b>	# 5 <b>370</b>	# 6 <b>360</b>
# 7 <b>340</b>	# 8 <b>330</b>	# 9 <b>320</b>	# 10 <b>300</b>		
Anode Output (Amps)					
# 1 <b>3.0</b>	# 2 <b>3.0</b>	# 3 <b>3.2</b>	# 4 <b>3.2</b>	# 5 <b>3.4</b>	# 6 <b>2.9</b>
# 7 <b>3.1</b>	# 8 <b>3.0</b>	# 9 <b>2.8</b>	# 10 <b>3.2</b>		
Anode Depth					
# 11	# 12	# 13	# 14	# 15	# 16
# 17	# 18	# 19	# 20		
Anode Output (Amps)					
# 11	# 12	# 13	# 14	# 15	# 16
# 17	# 18	# 19	# 20		
Total Circuit Resistance				No. 8 C.P. Cable Used	No. 2 C.P. Cable Used
Volts <b>11.5</b>	Amps <b>12.5</b>	Ohms <b>0.92</b>			

Remarks: **Static #61 600'N = 0.78, Static #142 600'SE = 0.75**  
**Installed 10-2"x2"x4" Graphite Anodes. Driller said MAKING WATER between 185' & 200'. Drilled to 380' & logged. Needed Room for 3 more anodes. Drilled to 500'. Logging Anode stopped @ 370'. PERFORATE 300' of 1" PVC Vent Pipe Installed 440' of 1" PVC Vent pipe. Slurried 54 SACK OF COKE. #61 MARKED 3 Notches, #142 MARKED 1 Notch.**

**Installed 600 30A Rectifier & 20' Motor Pole**  
**Installed 380' of 1/2" Rigid conduit** All Construction Completed

*W. J. Lutz*  
(Signature)

GROUND BED LAYOUT SKETCH

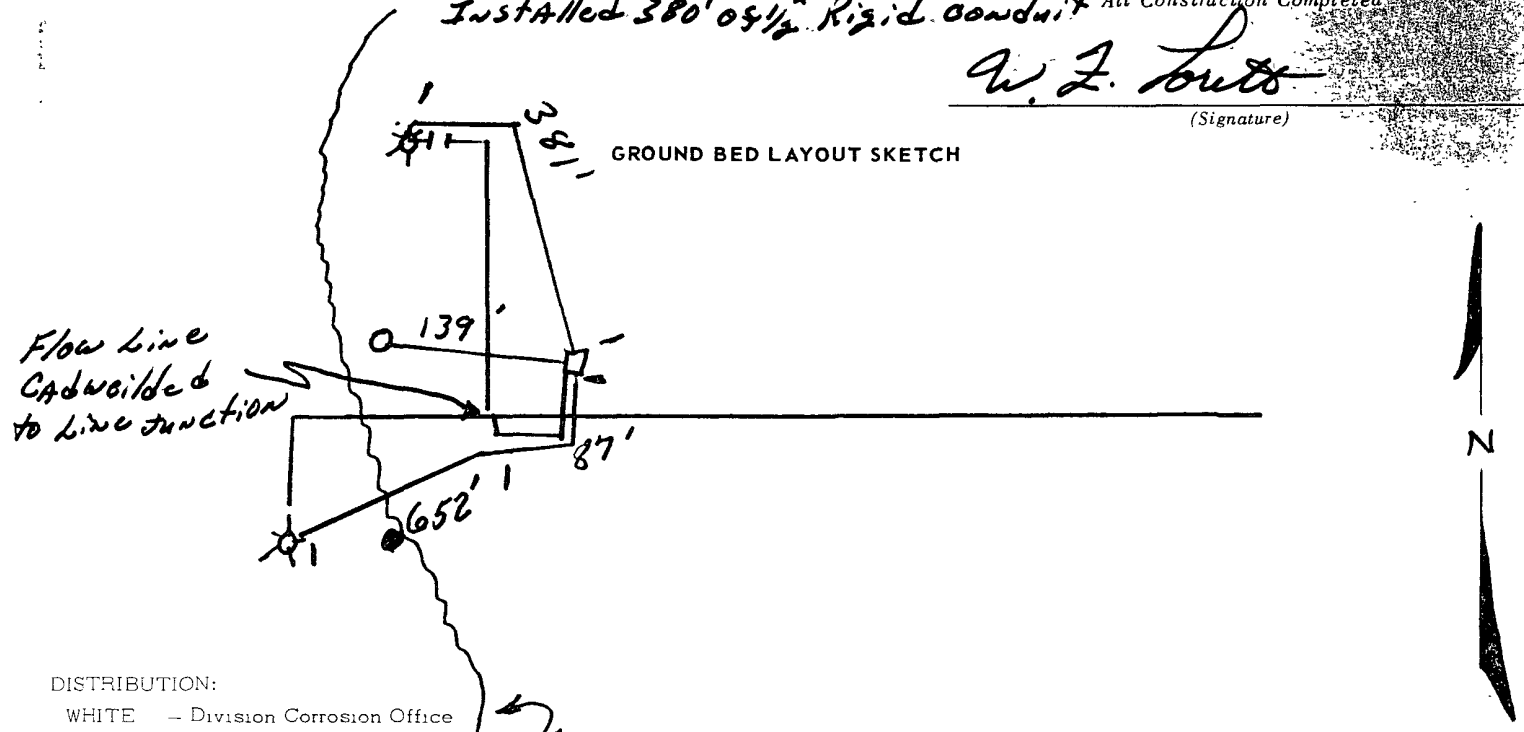

- DISTRIBUTION:
- WHITE - Division Corrosion Office
  - YELLOW - Area Corrosion Office
  - PINK - Originator File

B/1458

6381

SAN JUAN 28-6 Unit #61 40015.19  
SAN JUAN 28-6 Unit #142 SW 21-28-6 1164W 54564.19

MW	gals/mol	
16.04	C1	6.4
30.07	C2	10.12
44.10	C3	10.42
58.12	iC4	12.38
58.12	nC4	11.93
72.15	iC5	13.85
72.15	nC5	13.71
86.18	iC6	15.50
86.18	C6	15.57
100.21	iC7	17.2
100.21	C7	17.46
114.23	C8	19.39
28.05	C2	9.64
42.08	C3	9.67

MW	MISC. gals/mol	
32.00	O2	3.37
28.01	CO	4.19
44.01	CO2	6.38
64.06	SO2	5.50
34.08	H2S	5.17
28.01	N2	4.16
2.02	H2	3.38

Static #61	600' NC 0.78	DRILLER SAID MAKING WATER
Static #142	600' SE = 0.75	Between 185' & 200' waited 20 minutes
Installed	10-2" x 12" x 1/2" Graphite Arises	Blow water
Installed	60V 30A Protection	Perforated 300' of 1" PVC Vent Pipe
Installed	20' Motor Pole	Installed 440' of 1" PVC Vent Pipe
Installed	380' of 1/2" Rigid Conduit	Shrined 54 SACKS OF COKE
		DRILLED TO 380' LOGGED HOLE
200.9	70 1.3 - (5)	Needed Room for 3 more
.7	1.0	Arises. DRILLED TO 480'
101.6	T.D. 80 1.0	Unable to get logging Arise
.3	1.0	Past 380.
20.4	90 .9	
.5	.9	
30.4	400 1.0	
.4	1.2 (4)	
40.6	10 1.3	
.4	1.3 (3)	
50.4	20 1.2	
.9	1.4 (2)	(1) 435 1.8 3.0
60.7	30 1.1	(2) 425 1.6 3.0
.5	1.3 (1)	(3) 415 1.8 3.2
70.5	40 1.3	(4) 405 1.7 3.2
.5	1.3	(5) 390 1.9 3.4
80.5	50 1.3	(6) 360 1.5 2.9
.5	1.3 T.D. 455	(7) 340 1.6 3.1
90.9	20	(8) 330 1.5 3.0
.5		(9) 320 1.3 2.8
100.2	(10) .5	(10) 300 1.5 3.2
.2		
.9	10	
1.0		
10.3 - (1)		11.5 volts 12.5 Amps 0.920 hrs
1.0		
1.3 (7)		
1.2 - (1)		
50.1		
60.1 - (1)		
1.2		

LEASE \_\_\_\_\_ WELL NO. 1164 w CONTRACTOR Posey RIG NO. \_\_\_\_\_ REPORT NO. \_\_\_\_\_ DATE 8-5 19 77

MORNING					DAYLIGHT					EVENING				
Driller		Total Men In Crew			Driller		Total Men In Crew			Driller		Total Men In Crew		
FROM	TO	FORMATION	WT-BIT	R.P.M.	FROM	TO	FORMATION	WT-BIT	R.P.M.	FROM	TO	FORMATION	WT-BIT	R.P.M.

*Total depth 467 1/2 feet*

BIT NO.		NO. DC		SIZE		LENG.		BIT NO.		NO. DC		SIZE		LENG.			
SER.	NO.	STANDS		SINGLES		DOWN ON KELLY		SERIAL NO.	NO.	STANDS		SINGLES		DOWN ON KELLY			
MAKE		TOTAL DEPTH				MAKE		TOTAL DEPTH				MAKE		TOTAL DEPTH			

MUD RECORD			MUD, ADDITIVES USED AND RECEIVED			MUD RECORD			MUD, ADDITIVES USED AND RECEIVED			MUD RECORD			MUD, ADDITIVES USED AND RECEIVED			
Time	Wt.	Vis.	Time	Wt.	Vis.	Time	Wt.	Vis.	Time	Wt.	Vis.	Time	Wt.	Vis.	Time	Wt.	Vis.	

FROM	TO	TIME BREAKDOWN	FROM	TO	TIME BREAKDOWN	FROM	TO	TIME BREAKDOWN
0	1	Surface	180	185	Shale	340	350	Sandy shale
1	25	Sandstone	185	205	Sand Wet (making water)	350	400	Shale
25	140	Shale	205	235	Shale	400	420	Sandy shale
14	140	Sand Dry	235	280	Sandy shale	420	460	Shale
16.4	170	Sandy shale	280	285	Sand stone	460	480	Sandy shale
170	180	Sand Dry	285	340	Shale			

REMARKS -

*Total feet 480*  
*Logged feet 455*

SIGNED: Toolpusher \_\_\_\_\_ Company Supervisor \_\_\_\_\_