

District I
1625 N French Dr, Hobbs, NM 88240
District II
1301 W Grand Avenue, Artesia, NM 88210
District III
1000 Rio Brazos Road, Aztec, NM 87410
District IV
1220 S St Francis Dr, Santa Fe, NM 87505

State of New Mexico
Energy Minerals and Natural Resources

Form C-144
June 1, 2004

Oil Conservation Division
1220 South St. Francis Dr.
Santa Fe, NM 87505

For drilling and production facilities, submit to
appropriate NMOCD District Office.
For downstream facilities, submit to Santa Fe
office

Pit or Below-Grade Tank Registration or Closure

Is pit or below-grade tank covered by a "general plan"? Yes ☒ No ☐

Type of action: Registration of a pit or below-grade tank ☐ Closure of a pit or below-grade tank ☒

Operator: BP America Production Company Telephone: (505)326-9200 e-mail address: _____
Address 200 Energy Ct. Farmington, NM 87401
Facility or well name: Price #1E API #: 3004526001 U/L or Qtr/Qtr D Sec 13 T 28 N R 8 W
County: San Juan Latitude _____ Longitude _____ NAD. 1927 ☐ 1983 ☐
Surface Owner Federal ☐ State ☐ Private ☐ Indian ☐

Pit	Below-grade tank
Type: Drilling <input type="checkbox"/> Production <input checked="" type="checkbox"/> Disposal <input type="checkbox"/> Workover <input type="checkbox"/> Emergency <input type="checkbox"/> Lined <input type="checkbox"/> Unlined <input checked="" type="checkbox"/> Liner type Synthetic <input type="checkbox"/> Thickness _____ mil Clay <input type="checkbox"/> Pit Volume _____ bbl	Volume: _____ bbl Type of fluid: _____ Construction material: _____ Double-walled, with leak detection? Yes <input type="checkbox"/> If not, explain why not. _____
Depth to ground water (vertical distance from bottom of pit to seasonal high water elevation of ground water.)	Less than 50 feet (20 points) 50 feet or more, but less than 100 feet (10 points) <u>0</u> 100 feet or more (0 points)
Wellhead protection area. (Less than 200 feet from a private domestic water source, or less than 1000 feet from all other water sources.)	Yes (20 points) No (0 points) <u>0</u>
Distance to surface water: (horizontal distance to all wetlands, playas, irrigation canals, ditches, and perennial and ephemeral watercourses.)	Less than 200 feet (20 points) 200 feet or more, but less than 1000 feet (10 points) <u>0</u> 1000 feet or more (0 points)
	Ranking Score (Total Points) <u>0</u>

If this is a pit closure: (1) Attach a diagram of the facility showing the pit's relationship to other equipment and tanks. (2) Indicate disposal location. (check the onsite box if you are burying in place) onsite ☒ offsite ☐ If offsite, name of facility _____. (3) Attach a general description of remedial action taken including remediation start date and end date. (4) Groundwater encountered: No ☒ Yes ☐ If yes, show depth below ground surface _____ ft. and attach sample results (5) Attach soil sample results and a diagram of sample locations and excavations.

Additional Comments:
See Attached Documentation
RCVD JUN13'07
OIL CONS. DIV.
DIST. 3

I hereby certify that the information above is true and complete to the best of my knowledge and belief. I further certify that the above-described pit or below-grade tank has been/will be constructed or closed according to NMOCD guidelines ☒, a general permit ☐, or an (attached) alternative OCD-approved plan ☐.

Date: 11/01/2005

Printed Name/Title Jeffrey C. Blagg, Agent

Signature Jeffrey C. Blagg

Your certification and NMOCD approval of this application/closure does not relieve the operator of liability should the contents of the pit or tank contaminate ground water or otherwise endanger public health or the environment. Nor does it relieve the operator of its responsibility for compliance with any other federal, state, or local laws and/or regulations

Approval

Printed Name/Title

Deputy Oil & Gas Inspector,
District #3

Signature Bob Bell

Date: AUG 10 2007

CLIENT: BPBLAGG ENGINEERING, INC.
P.O. BOX 87, BLOOMFIELD, NM 87413
(505) 632-1199LOCATION NO: B0820
C.O.C. NO: 14743

FIELD REPORT: LANDFARM/COMPOST PILE CLOSURE VERIFICATION

LOCATION: NAME: PRICE WELL #: 1E PITS: _____
DATE STARTED: 2/26/07
DATE FINISHED: _____
QUAD/UNIT: D SEC: 13 TWP: 28N RNG: 8W PM: NM CNTY: SJ ST: NM
QTR/FOOTAGE: _____ CONTRACTOR: _____
ENVIRONMENTAL SPECIALIST: NV

SOIL REMEDIATION:

REMEDICATION SYSTEM: LANDFARM

APPROX. CUBIC YARDAGE: _____

LAND USE: RANGE - BURNLIFT DEPTH (ft): N/A

FIELD NOTES & REMARKS:

DEPTH TO GROUNDWATER: >100' NEAREST SURFACE WATER: >1,000'NEAREST WATER SOURCE: >1,000' NMOCD RANKING SCORE: 0 NMOCD TPH CLOSURE STD: 5,000 PPMSOIL TYPE: SAND / SILTY SAND / SILT / SILTY CLAY / CLAY / GRAVEL / OTHER _____SOIL COLOR: MOD BROWNCOHESION (ALL OTHERS): NON COHESIVE / SLIGHTLY COHESIVE / COHESIVE / HIGHLY COHESIVECONSISTENCY (NON COHESIVE SOILS): LOOSE / FIRM / DENSE / VERY DENSE

PLASTICITY (CLAYS): NON PLASTIC / SLIGHTLY PLASTIC / COHESIVE / MEDIUM PLASTIC / HIGHLY PLASTIC

DENSITY (COHESIVE CLAYS & SILTS): SOFT / FIRM / STIFF / VERY STIFF / HARD

MOISTURE DRY / SLIGHTLY MOIST / MOIST / WET / SATURATED / SUPER SATURATEDDISCOLORATION/STAINING OBSERVED. YES / NO EXPLANATION - _____HC ODOR DETECTED: YES / NO EXPLANATION - _____SAMPLING DEPTHS (LANDFARMS): 4-6 (INCHES)SAMPLE TYPE: GRAB / COMPOSITE - # OF PTS. 5ADDITIONAL COMMENTS: NO ACTUAL LANDFARM OBSERVED ON-SITE.CLOSED

SKETCH/SAMPLE LOCATIONS

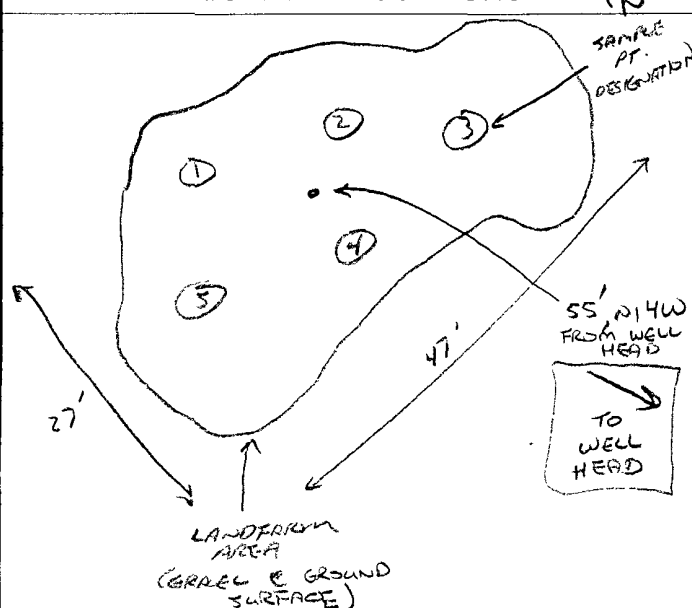
OVM CALIB. READ. = 52.7 ppm
OVM CALIB GAS = 100 ppm RF = 0.52
TIME: 1:10 am/pm DATE: 2/22/07

OVM RESULTS

LAB SAMPLES

SAMPLE ID	FIELD HEADSPACE (ppm)	SAMPLE ID	ANALYSIS	TIME	RESULTS (ppm)
LF-1	0.0	LF-1	TPH (80158)	0800	3.7
		"	CHLOR.	"	259

P.C. - 12/28/00

SCALE

0 FT

TRAVEL NOTES: CALLOUT. N/AONSITE: 3/5/02 2/22/07

EPA METHOD 8015 Modified
Nonhalogenated Volatile Organics
Total Petroleum Hydrocarbons

Client:	Blagg / BP	Project #:	94034-010
Sample ID:	LF - 1	Date Reported:	03-02-07
Laboratory Number:	40216	Date Sampled:	02-26-07
Chain of Custody No:	14743	Date Received:	02-28-07
Sample Matrix:	Soil	Date Extracted:	02-28-07
Preservative:	Cool	Date Analyzed:	03-01-07
Condition:	Cool and Intact	Analysis Requested:	8015 TPH

Parameter	Concentration (mg/Kg)	Det. Limit (mg/Kg)
Gasoline Range (C5 - C10)	ND	0.2
Diesel Range (C10 - C28)	3.7	0.1
Total Petroleum Hydrocarbons	3.7	0.2

ND - Parameter not detected at the stated detection limit.

References: Method 8015B, Nonhalogenated Volatile Organics, Test Methods for Evaluating Solid Waste, SW-846, USEPA, December 1996

Comments: Price #1E Landfarm 5 Pt Composite Sample.

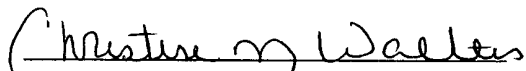
Analyst

Review

ENVIROTECH LABS

PRACTICAL SOLUTIONS FOR A BETTER TOMORROW

Chloride

Client:	Blagg / BP	Project #:	94034-010
Sample ID:	LF - 1	Date Reported:	03-01-07
Lab ID#:	40216	Date Sampled:	02-26-07
Sample Matrix:	Soil	Date Received:	02-28-07
Preservative:	Cool	Date Analyzed:	03-01-07
Condition:	Cool and Intact	Chain of Custody:	14743

Parameter	Concentration (mg/Kg)
Total Chloride	259

Reference: Standard Methods For The Examination of Water And Waste Water", 18th ed., 1992.

Comments: Price #1E Landfarm 5 Pt Composite Sample.

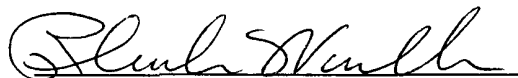
Analyst

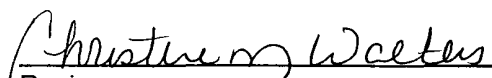
Review

District I
P.O. Box 1980, Hobbs, NM
District II
P.O. Drawer DD, Arcoma, NM 88211
District III
XX Rio Brazos Rd, Aztec, NM 87410

State of New Mexico
Energy, Minerals and Natural Resources Department

OIL CONSERVATION DIVISION
P.O. Box 2088
Santa Fe, New Mexico 87504-2088

SUBMIT 1 COPY TO
APPROPRIATE
DISTRICT OFFICE
AND 1 COPY TO
SANTA FE OFFICE

PIT REMEDIATION AND CLOSURE REPORT

Operator: Amoco Production Company Telephone: (505) - 326-9200
Address: 200 Amoco Court, Farmington, New Mexico 87401
Facility Or: PRICE #1E
Well Name _____
Location: Unit or Qtr/Qtr Sec D Sec 13 T 28N R 8W County SAN JUAN
Pit Type: Separator ___ Dehydrator ___ Other PRODUCTION TANK
Land Type: BLM ☒, State ___, Fee ___, Other _____

Pit Location: Pit dimensions: length 17', width 19', depth 4'
(Attach diagram) Reference: wellhead ☒, other _____
Footage from reference: 143'
Direction from reference: 76 Degrees " _____ East North _____
of
☒ West South ☒

Depth To Ground Water: Less than 50 feet (20 points)
(Vertical distance from 50 feet to 99 feet (10 points)
contaminants to seasonal Greater than 100 feet (0 Points) 0
high water elevation of
ground water)

Wellhead Protection Area: Yes (20 points)
(Less than 200 feet from a private No (0 points) 0
domestic water source, or; less than
1000 feet from all other water sources)

Distance To Surface Water: Less than 200 feet (20 points)
(Horizontal distance to perennial 200 feet to 1000 feet (10 points)
lakes, ponds, rivers, streams, creeks, Greater than 1000 feet (0 points) 0
irrigation canals and ditches)

RANKING SCORE (TOTAL POINTS): 0

Date Remediation Started: _____ Date Completed: 12/29/00

Remediation Method: Excavation ☒
(Check all appropriate sections)

Approx. cubic yards 40

Landfarmed ☒

Insitu Bioremediation _____

Other _____

Remediation Location: Onsite ☒ Offsite _____
(ie. landfarmed onsite,
name and location of
offsite facility)

General Description Of Remedial Action: _____

Excavation. BEDROCK BOTTOM. RISK ASSESSED.

Ground Water Encountered: No ☒ Yes _____ Depth _____

Final Pit:

Sample location see Attached Documents

Closure Sampling:

(if multiple samples,
attach sample results
and diagram of sample
locations and depths)

Sample depth 2' (NORTH SIDEWALL)

Sample date 12/28/00

Sample time 1120

Sample Results

Benzene(ppm) _____

Total BTEX(ppm) _____

Field headspace(ppm) 9.6 / 1,048 ^{PIT BOTTOM}

TPH _____

Ground Water Sample: Yes _____ No ☒ (If yes, attach sample results)

I HEREBY CERTIFY THAT THE INFORMATION ABOVE IS TRUE AND COMPLETE TO THE BEST OF MY KNOWLEDGE AND BELIEF

DATE 12/29/00

SIGNATURE B. Shaw

PRINTED NAME
AND TITLE

Buddy D. Shaw
ENVIRONMENTAL COORDINATOR

BLAGG ENGINEERING, INC.

P.O. Box 87, Bloomfield, New Mexico 87413

Phone: (505)632-1199 Fax: (505)632-3903

Field TPH-Worksheet

Max Characters:

Client:

BP AMOCO

Project #:

Sample ID:

1 @ 2'

Date Analyzed:

12-28-00

Project Location:

Price # 1E

Date Reported:

12-28-00

Laboratory Number:

TPH-2091

Sample Matrix:

Soil

Sample Weight: 5.00 grams
Volume Freon: 20.00 mL
Dilution Factor: 1 (unitless)
TPH Reading: 52 mg/kg

TPH Result: 208.0 mg/kg
Reported TPH Result: 210 mg/kg
Actual Detection Limit: 20.0 mg/kg
Reported Detection Limit: 20 mg/kg

QA/QC:

Original
TPH mg/kg

Duplicate
TPH mg/kg

%
Diff.

96

76

23.26

Comments:

*****Max Characters*****

Comments:

Production Tank Pit - B0820

District I
P O Box 1980, Hobbs, NM
District II
P O Drawer DD, Artesia, NM 88211
District III
100 Rio Brazos Rd, Aztec, NM 87410

OIL CONSERVATION DIVISION
P.O. Box 2088
Santa Fe, New Mexico 87504-2088

SUBMIT 1 COPY TO
APPROPRIATE
DISTRICT OFFICE
AND 1 COPY TO
SANTA FE OFFICE

Operator: Amoco Production Company Telephone: (505) - 326-9200

Address: 200 Amoco Court, Farmington, New Mexico 87401

Facility Or: PRICE #1E

Well Name _____

Location: Unit or Qtr/Qtr Sec D Sec 13 T 2N R 8W County SAN JUAN

Pit Type: Separator ☒ Dehydrator _____ Other _____

Land Type: BLM ☒, State _____, Fee _____, Other _____

Pit Location: Pit dimensions: length NA, width NA, depth NA
(Attach diagram)

Reference: wellhead ☒, other _____

Footage from reference: 138'

Direction from reference: 40 Degrees " _____ East North _____
of
☒ West South ☒

Depth To Ground Water: Less than 50 feet (20 points)
(Vertical distance from 50 feet to 99 feet (10 points)
contaminants to seasonal Greater than 100 feet (0 Points) 0
high water elevation of
ground water)

Wellhead Protection Area: Yes (20 points) 0
(Less than 200 feet from a private No (0 points)
domestic water source, or; less than
1000 feet from all other water sources)

Distance To Surface Water: Less than 200 feet (20 points)
(Horizontal distance to perennial 200 feet to 1000 feet (10 points)
lakes, ponds, rivers, streams, creeks, Greater than 1000 feet (0 points) 0
irrigation canals and ditches)

RANKING SCORE (TOTAL POINTS): 0

Date Remediation Started: _____ Date Completed: 12/28/00Remediation Method: Excavation ☒ Approx. cubic yards NA

(Check all appropriate sections)

Landfarmed _____

Insitu Bioremediation _____

Other DILUTED & AERATED & PLACED BACK INTO PIT AREA(INSITU)

Remediation Location: Onsite _____ Offsite _____

(ie. landfarmed onsite,
name and location of
offsite facility)

General Description Of Remedial Action: _____

Excavation. BEDROCK BOTTOM. RISK ASSESSED.

Ground Water Encountered: No ☒ Yes _____ Depth _____

Final Pit:

Closure Sampling:

(if multiple samples,
attach sample results
and diagram of sample
locations and depths)Sample location see Attached DocumentsSample depth 7' (TEST HOLE BOTTOM)Sample date 12/28/00 Sample time 1045

Sample Results

Benzene (ppm) _____

Total BTEX (ppm) _____

Field headspace (ppm) 1,464TPH NAGround Water Sample: Yes _____ No ☒ (If yes, attach sample results)

I HEREBY CERTIFY THAT THE INFORMATION ABOVE IS TRUE AND COMPLETE TO THE BEST OF MY KNOWLEDGE AND BELIEF

DATE 12/28/00

SIGNATURE

B. ShawPRINTED NAME
AND TITLEBuddy D. Shaw
Environmental Coordinator

CLIENT

BP

BLAGG ENGINEERING, INC.
P.O. BOX 87, BLOOMFIELD, NM 87413
(505) 632-1199

LOCATION NO B0820

C O C NO

FIELD REPORT: LANDFARM/COMPOST PILE CLOSURE VERIFICATION

LOCATION: NAME PRICE WELL # 1E PITS: PROD. TANK
QUAD/UNIT D SEC. 13 TWP: 28N RNG: 8W PM: NM CNTY: SJ ST: NM
QTR/FOOTAGE: NW/NE CONTRACTOR:

DATE STARTED 3/5/02
DATE FINISHED:

ENVIRONMENTAL
SPECIALIST NV

SOIL REMEDIATION:

40

REMEDICATION SYSTEM: LANDFARM

APPROX. CUBIC YARDAGE:

LAND USE: RANGE -

LIFT DEPTH (ft):

FIELD NOTES & REMARKS:

DEPTH TO GROUNDWATER

>100'

NEAREST SURFACE WATER

>1,000'

NEAREST WATER SOURCE

>1,000'

NMOCD RANKING SCORE

0

NMOCD TPH CLOSURE STD

5,000

PPM

SOIL TYPE SAND / SILTY SAND / SILT / SILTY CLAY / CLAY / GRAVEL / OTHER

SOIL COLOR

COHESION (ALL OTHERS): NON COHESIVE / SLIGHTLY COHESIVE / COHESIVE / HIGHLY COHESIVE

CONSISTENCY (NON COHESIVE SOILS): LOOSE / FIRM / DENSE / VERY DENSE

PLASTICITY (CLAYS): NON PLASTIC / SLIGHTLY PLASTIC / COHESIVE / MEDIUM PLASTIC / HIGHLY PLASTIC

DENSITY (COHESIVE CLAYS & SILTS): SOFT / FIRM / STIFF / VERY STIFF / HARD

MOISTURE DRY / SLIGHTLY MOIST / MOIST / WET / SATURATED / SUPER SATURATED

DISCOLORATION/STAINING OBSERVED: YES / NO EXPLANATION -

HC ODOR DETECTED: YES / NO EXPLANATION -

SAMPLING DEPTHS (LANDFARMS): (INCHES)

SAMPLE TYPE: GRAB / COMPOSITE - # OF PTS.

ADDITIONAL COMMENTS: NO LANDFARM OBSERVED ON-SITE.

SKETCH/SAMPLE LOCATIONS

NO LANDFARM
OBSERVED

OVM CALIB. READ. = ppm
OVM CALIB. GAS = ppm RF = 0.52
TIME: am/pm DATE:

OVM RESULTS

LAB SAMPLES

SAMPLE ID	FIELD HEADSPACE (ppm)	SAMPLE ID	ANALYSIS	TIME	RESULTS

SCALE

0 FT

TRAVEL NOTES: CALLOUT:

ONSITE:

CHAIN OF CUSTODY RECORD

14743

Client / Project Name BLAGG / BP			Project Location PRICE # 1E		ANALYSIS / PARAMETERS								
Sampler: NV			Client No. 94034-010		No. of Containers TPH (8015B)		CHLORIDE					Remarks	
Sample No./ Identification	Sample Date	Sample Time	Lab Number	Sample Matrix								PRESERVED COOL	
												5 PT. COMPOSITE SAMPLE	
LF-1	2/26/07	0800	40216	SOIL	1	✓	✓					LANDFARM	
Relinquished by: (Signature) <i>[Signature]</i>			Date 2/28/07	Time 0846	Received by: (Signature) <i>[Signature]</i>			Date 2/28/07	Time 846				
Relinquished by: (Signature)					Received by: (Signature)								
Relinquished by: (Signature)					Received by: (Signature)								
ENVIROTECH INC. 5796 U.S. Highway 64 Farmington, New Mexico 87401 (505) 632-0615										Sample Receipt			
											Y	N	N/A
										Received Intact	✓		
										Cool - Ice/Blue Ice	✓		

ENVIROTECH LABS

PRACTICAL SOLUTIONS FOR A BETTER TOMORROW

EPA Method 8015 Modified
Nonhalogenated Volatile Organics
Total Petroleum Hydrocarbons

Quality Assurance Report

Client:	QA/QC	Project #:	N/A
Sample ID:	03-01-07 QA/QC	Date Reported:	03-02-07
Laboratory Number:	40216	Date Sampled:	N/A
Sample Matrix:	Methylene Chloride	Date Received:	N/A
Preservative:	N/A	Date Analyzed:	03-01-07
Condition:	N/A	Analysis Requested	TPH

	I-Cal Date	I-Cal RF	C-Cal RF	% Difference	Accept. Range
Gasoline Range C5 - C10	07-11-05	2.2460E+003	2.2482E+003	0.10%	0 - 15%
Diesel Range C10 - C28	07-11-05	2.3915E+003	2.3963E+003	0.20%	0 - 15%

Blank Conc. (mg/L - mg/Kg)	Concentration	Detection Limit
Gasoline Range C5 - C10	ND	0.2
Diesel Range C10 - C28	ND	0.1
Total Petroleum Hydrocarbons	ND	0.2

Duplicate Conc. (mg/Kg)	Sample	Duplicate	% Difference	Accept. Range
Gasoline Range C5 - C10	ND	ND	0.0%	0 - 30%
Diesel Range C10 - C28	3.7	3.7	0.0%	0 - 30%

Spike Conc. (mg/Kg)	Sample	Spike Added	Spike Result	% Recovery	Accept. Range
Gasoline Range C5 - C10	ND	250	248	99.2%	75 - 125%
Diesel Range C10 - C28	3.7	250	244	96.1%	75 - 125%

ND - Parameter not detected at the stated detection limit.

References: Method 8015B, Nonhalogenated Volatile Organics, Test Methods for Evaluating Solid Waste, SW-846, USEPA, December 1996.

Comments: QA/QC for Samples 40216 - 40221.

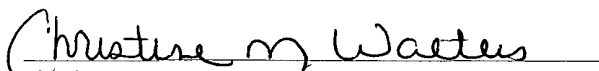
Analyst

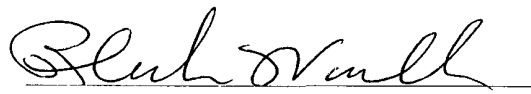
Review