

RECEIVED

2003 AUG -4 PM 1:16

FORM APPROVED  
OMB No. 1004-0136  
Expires November 30, 2000

UNITED STATES  
DEPARTMENT OF THE INTERIOR  
BUREAU OF LAND MANAGEMENT

APPLICATION FOR PERMIT TO DRILL OR REENTER

1a. Type of Work: ☒ DRILL ☐ REENTER

b. Type of Well: ☐ Oil Well ☒ Gas Well ☐ Other ☒ Single Zone ☐ Multiple Zone

2. Name of Operator

**Cordillera Energy Company**

3a. Address

c/o Walsh Engineering, 7415 E. Main, Farmington, NM 87402

3b. Phone No. (include area code)

(505) 327-4892

4. Location of Well (Report location clearly and in accordance with any State requirements. \*)

At surface **1735' FNL and 885' FEL**

At proposed prod. Zone

14. Distance in miles and direction from nearest town or post office\*

**3 miles north of Farmington, NM**

15. Distance from proposed\* location to nearest property or lease line, ft. (Also to nearest drig. unit line, if any)

**885'**

16. No. of Acres in lease

**320+**

17. Spacing Unit dedicated to this well

**320 acres (east half)**

18. Distance from proposed location\* to nearest well, drilling, completed, applied for, on this lease, ft.

**80'**

19. Proposed Depth

**2360 +/-**

20. BLM/BIA Bond No. on file

21. Elevations (Show whether DF, KDB, RT, GL, etc.)

**5702' GL**

22. Approximate date work will start\*

**September 1, 2003**

23. Estimated duration

**1 week**

24. Attachments

The following, completed in accordance with the requirements of Onshore Oil and Gas Order No. 1, shall be attached to this form:

1. Well plat certified by a registered surveyor.
2. A Drilling Plan.
3. A Surface Use Plan (if the location is on National Forest System Lands, the SUPO shall be filed with the appropriate Forest Service Office.
4. Bond to cover the operations unless covered by an existing bond on file (see Item 20 above).
5. Operator certification.
6. Such other site specific information and/or plans as may be required by the authorized office.

25. Signature

*Paul C. Thompson*

Name (Printed/Typed)

**Paul C. Thompson, P.E.**

Date

**7/31/03**

Title

Agent

Approved by (Signature)

**Original Signed: Stephen Mason**

Name (Printed/Typed)

**SEP 10 2003**

Title

Office

Application approval does not warrant or certify that the applicant holds legal or equitable title to those rights in the subject lease which would entitle the applicant to conduct operations thereon.

Conditions of approval, if any, are attached.

Title 18 U.S.C. Section 1001 and Title 43 U.S.C. Section 1212, make it a crime for any person knowingly and willfully to make to any department or agency of the United States any false, fictitious or fraudulent statements or representations as to any matter within its jurisdiction.

\*(Instructions on reverse)

DRILLING OPERATIONS AUTHORIZED ARE  
SUBJECT TO COMPLIANCE WITH ATTACHED  
"GENERAL REQUIREMENTS".

This action is subject to technical and  
procedural review pursuant to 43 CFR 3165.3  
and appeal pursuant to 43 CFR 3165.4

NMOCD

District I  
PO Box 1980, Hobbs, NM 88241-1980

District II  
PO Drawer DD, Artesia, NM 88211-0719

District III  
1000 Rio Brazos Rd., Aztec, NM 87410

District IV  
PO Box 2088, Santa Fe, NM 87504-2088

State of New Mexico  
Energy, Minerals & Natural Resources Department

OIL CONSERVATION DIVISION  
PO Box 2088  
Santa Fe, NM 87504-2088

Form C-102  
Revised February 21, 1994

Instructions on back  
Submit to Appropriate District Office  
State Lease - 4 Copies  
Fee Lease - 3 Copies

2003 AUG -4 PM 1:16  
AMENDED REPORT

070 Farmington, NM

WELL LOCATION AND ACREAGE DEDICATION PLAT

*API Number 30-045-31821		*Pool Code 71629	*Pool Name BASIN FRUITLAND COAL
*Property Code 25128	*Property Name <del>McCLINTOCK</del> Mcclintock		*Well Number 2/15
*GRID No. 173252	*Operator Name CORDILLERA ENERGY, INC.		*Elevation 5702'

<sup>10</sup> Surface Location

UL or lot no.	Section	Township	Range	Lot Idn	Feet from the	North/South line	Feet from the	East/West line	County
H	34	31N	13W		1735	NORTH	885	EAST	SAN JUAN

<sup>11</sup> Bottom Hole Location If Different From Surface

UL or lot no.	Section	Township	Range	Lot Idn	Feet from the	North/South line	Feet from the	East/West line	County

<sup>12</sup> Dedicated Acres 320.0 Acres - (E/2)	<sup>13</sup> Joint or Infill Y	<sup>14</sup> Consolidation Code	<sup>15</sup> Order No.
--	------------------------------------	----------------------------------	-------------------------

NO ALLOWABLE WILL BE ASSIGNED TO THIS COMPLETION UNTIL ALL INTERESTS HAVE BEEN CONSOLIDATED  
OR A NON-STANDARD UNIT HAS BEEN APPROVED BY THE DIVISION

5383.62'

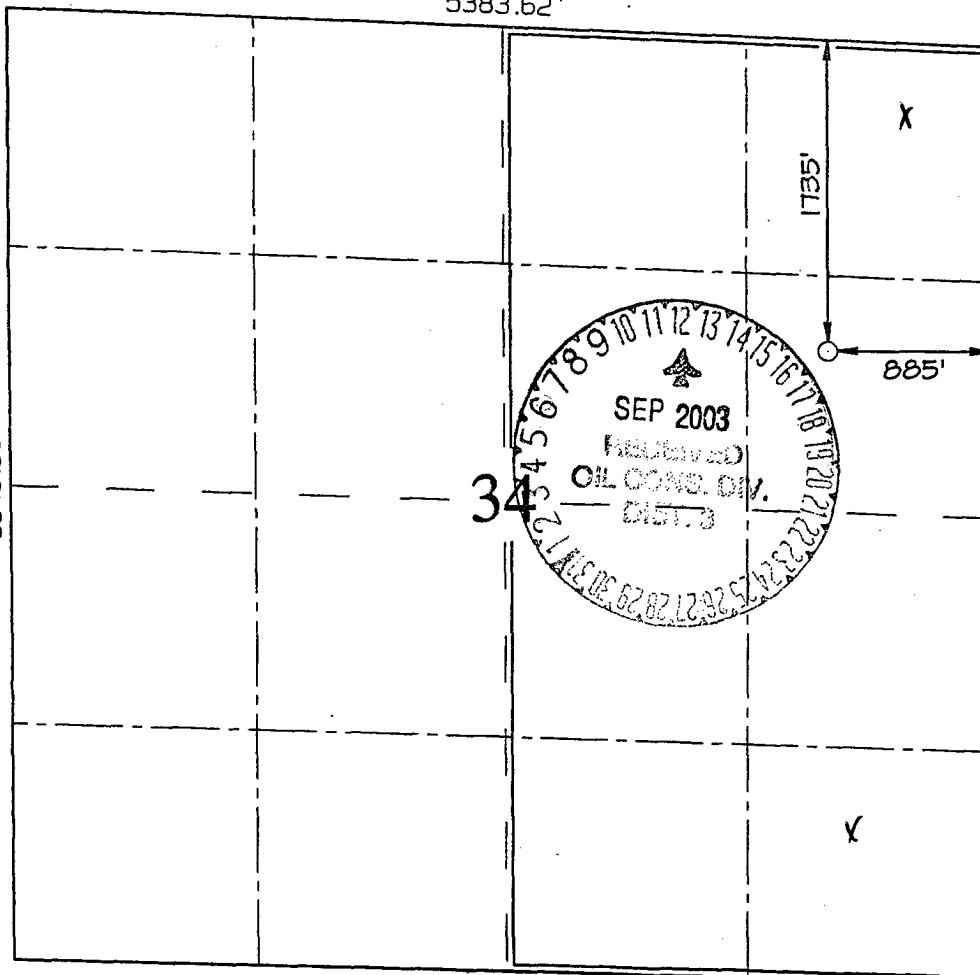

<sup>17</sup> OPERATOR CERTIFICATION

I hereby certify that the information contained herein is true and complete to the best of my knowledge and belief

*Paul C. Thompson*  
Signature

Paul C. Thompson  
Printed Name

AGENT  
Title

7/31/03  
Date

<sup>18</sup> SURVEYOR CERTIFICATION

I hereby certify that the well location shown on this plat was plotted from field notes of actual surveys made by me or under my supervision, and that the same is true and correct to the best of my belief.

Date of Survey: MAY 9, 2003

Signature and Seal of Professional Surveyor



JASON C. EDWARDS  
Certificate Number 15269

C. Minimum Blowout Control Specifications:

Double ram or annular type 2000 psi working pressure BOP with a rotating head. See the attached Exhibits #1 and #2 for details on the BOP equipment. All ram type preventers and related equipment will be hydraulically tested at nipple-up and after any use under pressure to 1000 psi.

The blind rams will be hydraulically activated and checked for operational readiness each time pipe is pulled out of the hole. All checks of the BOP stack and equipment will be noted on the daily drilling report. The BOP equipment will include a kelly cock, floor safety valve, and choke manifold all rated to 2000 psi.

IV. Materials

A. Casing Program:

Hole Size	Depth	Casing Size	Wt. & Grade
8-3/4"	120'	7"	20# J-55
6-1/4"	2360'	4-1/2"	10.5# K-55

B. Float Equipment:

a) Surface Casing: None.

b) Production Casing: 4-1/2" cement guide shoe and self fill insert float. Place float one joint above shoe. Five centralizers spaced every other joint above shoe and five turbolizers placed across the Ojo Alamo.

V. Cementing:

Surface casing: 7" - Use 30 sx (36 cu. ft.) of Cl "B" with 2% CaCl<sub>2</sub> (Yield = 1.18 cu. ft./sk; slurry weight = 15.6 PPG). 100% excess to circulate cement to surface. WOC 12 hours. Pressure test surface casing to 600 psi for 30 min.

Production Casing: 4-1/2" - Before cementing circulate hole with at least 1-1/2 hole volumes of mud. Precede cement with 30 bbls of fresh water. Lead with 180sx (371 cu.ft) of Cl "B" with 2% SMS, 1/4#/sk. celloflake. (Yield = 2.06 cu.ft./sk; slurry weight = 12.5 PPG). Tail with 100 sx (118 cu.ft.) of Cl "B" with 2% CaCl<sub>2</sub>, and 1/4#/sk. celloflake/sk. (Yield = 1.18 cu. ft./sk; slurry weight = 15.6 PPG) Total cement volume is 489 cu.ft. (100% excess to circulate cement to surface).

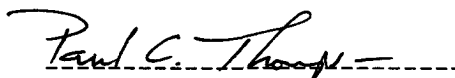
  
Paul C. Thompson, P.E.

UNITED STATES  
DEPARTMENT OF THE INTERIOR  
BUREAU OF LAND MANAGEMENT

SUNDRY NOTICES AND REPORTS ON WELLS

Do not use this form for proposals to drill or reenter an abandoned well. Use Form 3160-3 (APD) for such proposals.

FORM APPROVED  
OMB No. 1004-0135  
Expires November 30, 2000

5. Lease Serial No.	SF 078463
6. If Indian, Allottee or Tribe Name	
7. If Unit or CA/Agreement, Name and/or No.	
8. Well Name and No.	McClintock #2
9. API Well No.	
10. Field and Pool, or Exploratory Area	Basin Fruitland Coal
11. County or Parish, State	San Juan, NM

**SUBMIT IN TRIPLICATE - Other instructions on reverse side**

1. Type of Well <input type="checkbox"/> Oil Well <input checked="" type="checkbox"/> Gas Well <input type="checkbox"/> Other	
2. Name of Operator Cordillera Energy, Inc. c/o Walsh Engineering	
3a. Address 7415 E. Main, Farmington, NM, 87402	3b. Phone No. (include area code) 505-327-4892
4. Location of Well (Footage, Sec., T., R., M., or Survey Description) 1735' FNL and 885' FEL, Sec. 34, T31N, R13W	

12. CHECK APPROPRIATE BOX(ES) TO INDICATE NATURE OF NOTICE, REPORT, OR OTHER DATA

TYPE OF SUBMISSION	TYPE OF ACTION			
<input checked="" type="checkbox"/> Notice of Intent	<input type="checkbox"/> Acidize	<input type="checkbox"/> Deepen	<input type="checkbox"/> Production (Start/Resume)	<input type="checkbox"/> Water Shut-Off
<input type="checkbox"/> Subsequent Report	<input type="checkbox"/> Alter Casing	<input type="checkbox"/> Fracture Treat	<input type="checkbox"/> Reclamation	<input type="checkbox"/> Well Integrity
<input type="checkbox"/> Final Abandonment Notice	<input type="checkbox"/> Casing Repair	<input type="checkbox"/> New Construction	<input type="checkbox"/> Recomplete	<input type="checkbox"/> Other
	<input type="checkbox"/> Change Plans	<input type="checkbox"/> Plug and Abandon	<input type="checkbox"/> Temporarily Abandon	
	<input type="checkbox"/> Convert to Injection	<input type="checkbox"/> Plug Back	<input type="checkbox"/> Water Disposal	

13. Describe Proposed or Completed Operations (clearly state all pertinent details, including estimated starting date of any proposed work and approximate duration thereof. If the proposal is to deepen directionally or recompleat horizontally, give subsurface locations and measured and true vertical depths of all pertinent markers and zones. Attach the Bond under which the work will be performed or provide the Bond No. on file with BLM/BIA. Required subsequent reports shall be filed within 30 days following completion of the involved operations. If the operation results in a multiple completion or recompletion in a new interval, a Form 3160-4 shall be filed once testing has been completed. Final Abandonment Notices shall be filed only after all requirements, including reclamation, have been completed, and the operator has determined that the site is ready for final inspection.)

Due to confusion with a similarly named well, Cordillera wishes to change the name of this well to the **McIntock #1S**

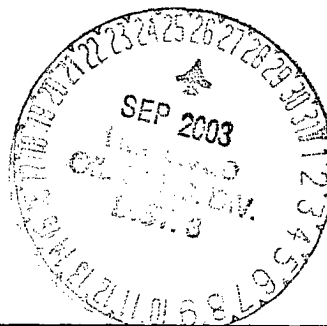

14. I hereby certify that the foregoing is true and correct	
Name (Printed/Typed) Paul C. Thompson, P.E.	Title Agent
Signature <i>Paul C. Thompson</i>	Date September 25, 2003

THIS SPACE FOR FEDERAL OR STATE USE

Approved by	Title	Date
Conditions of approval, if any, are attached. Approval of this notice does not warrant or certify that the applicant holds legal or equitable title to those rights in the subject lease which would entitle the applicant to conduct operations thereon.		Office

Title 18 U.S.C. Section 1001, make it a crime for any person knowingly and willfully to make to any department or agency of the United States any false, fictitious or fraudulent statements or representations as to any matter within its jurisdiction.