

UNITED STATES
DEPARTMENT OF THE INTERIOR
BUREAU OF LAND MANAGEMENT

APPLICATION FOR PERMIT TO DRILL, DEEPEN, OR PLUG BACK

1a. Type of Work DRILL	5. Lease Number USA SF-079391 Unit Reporting Number NMNM-7840913-MV NMNM-78409A-DK	
1b. Type of Well GAS	6. If Indian, All. or Tribe	
2. Operator BURLINGTON RESOURCES Oil & Gas Company, LP	7. Unit Agreement Name San Juan 27-5 Unit	
3. Address & Phone No. of Operator PO Box 4289, Farmington, NM 87499 (505) 326-9700	8. Farm or Lease Name	
4. Location of Well Surf: Unit E (SWNW), 1646' FNL & 1146' FWL BH: Unit D (NWNW), 960' FNL & 1040' FWL SURF: Latitude 36° 35.6873 N Longitude 107° 23.1839 W Latitude 36° 35.6009 N Longitude 107° 23.2058 W	9. Well Number #901 10. Field, Pool, Wildcat Blanco MV/Basin DK 11. Sec., Twn, Rge, Mer. (NMPM) E Sec. 8, T27N, R5W API # 30-039-30317	
14. Distance in Miles from Nearest Town 35 mile/Blanco	12. County Rio Arriba	13. State NM
15. Distance from Proposed Location to Nearest Property or Lease Line 960'	17. Acres Assigned to Well MV/DK 320 (W/2)	
16. Acres in Lease		
18. Distance from Proposed Location to Nearest Well, Drlg, Compl, or Applied for on this Lease 52' from San Juan 27-5 Unit 905		
19. Proposed Depth 7850' TVD/7970' TMD	20. Rotary or Cable Tools Rotary	
21. Elevations (DF, FT, GR, Etc.) 6619' GL	22. Approx. Date Work will Start	
23. Proposed Casing and Cementing Program See Operations Plan attached		
24. Authorized by: <u>Rhonda Rogers</u> Rhonda Rogers (Regulatory Technician)	8-9-07 Date	

PERMIT NO.

APPROVAL DATE

APPROVED BY

TITLE

DATE

Archaeological Report attached

Threatened and Endangered Species Report attached

NOTE: This format is issued in lieu of U.S. BLM Form 3160-3

Title 18 U.S.C. Section 1001, makes it a crime for any person knowingly and willfully to make to any department or agency of the United States any false, fictitious or fraudulent statements or presentations as to any matter within its jurisdiction.

Example Master Plan Type 3

Bond Numbers NMB-000015 and NMB-000089

DRILLING OPERATIONS AUTHORIZED ARE
SUBJECT TO COMPLIANCE WITH ATTACHED
"GENERAL REQUIREMENTS".

HOLD OIL FOR directional survey
NMOC order for pilot project

is subject to technical and
procedural review pursuant to 43 CFR 3165.3
and appeal pursuant to 43 CFR 3165.4

NOTIFY AZTEC OCD 24 HRS.
PRIOR TO CASING & CEMENT

DISTRICT I
1626 N. French Dr., Hobbs, N.M. 88240

DISTRICT II
1901 W. Grand Avenue, Artesia, N.M. 88210

DISTRICT III
1000 Rio Brazos Rd., Aztec, N.M. 87410

DISTRICT IV
1220 S. St. Francis Dr., Santa Fe, N.M. 87505

State of New Mexico
Energy, Minerals & Natural Resources Department

OIL CONSERVATION DIVISION
1220 South St. Francis Dr.
Santa Fe, N.M. 87505

207 AUG 2007
Form C-102
Revised October 12, 2005
Submit to Appropriate District Office
State Lease - 4 Copies
Fee Lease - 3 Copies
AMENDED REPORT

WELL LOCATION AND ACREAGE DEDICATION PLAT

¹ API Number 30-039-30317	² Pool Code 71599/72319	³ Well Name Basin Dakota/.Blanco Mesaverde
⁴ Property Code 7454	⁵ Property Name SAN JUAN 27-5 UNIT	
⁶ OCRD No. 14538	⁷ Operator Name BURLINGTON RESOURCES OIL & GAS COMPANY LP.	⁸ Well Number 901
		⁹ Elevation 6619

¹⁰ Surface Location

UL or lot no.	Section	Township	Range	Lot Idn	Feet from the	North/South line	Feet from the	East/West line	County
E	8	27 N	5 W		1646	NORTH	1146	WEST	RIO ARriba

¹¹ Bottom Hole Location If Different From Surface

UL or lot no.	Section	Township	Range	Lot Idn	Feet from the	North/South line	Feet from the	East/West line	County
D	8	27 N	5 W		960	NORTH	1040	WEST	RIO ARriba

¹² Dedicated Acres 320 W/2	¹³ Joint or Infill	¹⁴ Consolidation Code	¹⁵ Order No.
--	-------------------------------	----------------------------------	-------------------------

NO ALLOWABLE WILL BE ASSIGNED TO THIS COMPLETION UNTIL ALL INTERESTS HAVE BEEN CONSOLIDATED
OR A NON-STANDARD UNIT HAS BEEN APPROVED BY THE DIVISION

<p>16 S 88°47'03" E</p> <p>2646.33'</p> <p>1040'</p> <p>960'</p> <p>1146'</p> <p>N 0°23'21" W</p> <p>2616.10'</p> <p>N 0°35'07" W</p> <p>N 78°52'24" W</p>	<p>NAD 83 LAT: 36.593357° N LONG: 107.387366° W</p> <p>NAD 27 LAT: 36° 35.6009' N LONG: 107° 25.2058' W</p>	5208.18'	<p>¹⁷ OPERATOR CERTIFICATION</p> <p>I hereby certify that the information contained herein is true and complete to the best of my knowledge and belief, and that this organization either owns a working interest or leased mineral interest in the land including the proposed bottom hole location or has a right to drill this well at this location pursuant to a contract with an owner of such a mineral or working interest, or to a voluntary pooling agreement or a compulsory pooling order heretofore entered by the division.</p> <p><i>Kandis Roland</i> 7/13/07 Signature Kandis Roland Printed Name</p> <p>¹⁸ SURVEYOR CERTIFICATION</p> <p>I hereby certify that the well location shown on this plat was plotted from field notes of actual surveys made by me or under my supervision, and that the same is true and correct to the best of my belief.</p> <p>5/17/07 Date of Survey Signature and Seal of Professional Surveyor SHALL W. LINDEN NEW MEXICO 17078 17078 Certificate Number</p>
	<p>NAD 83 LAT: 36.591464° N LONG: 107.387001° W</p> <p>NAD 27 LAT: 36° 35.4873' N LONG: 107° 25.1839' W</p>		
	SECTION 8		
	USA SF-079391		

District I

1625 N French Dr., Hobbs, NM 88240

District II

1301 W. Grand Ave., Artesia, NM 88210

District III

1000 Rio Brazos Rd., Aztec, NM 87410

District IV

1220 S. St. Francis Dr., Santa Fe, NM 87505

Energy, Minerals and Natural Resources

OIL CONSERVATION DIVISION1220 South St. Francis Dr.
Santa Fe, NM 87505

WELL API NO.

30-039- **30317**

5. Indicate Type of Lease

STATE ☐

FEE

☒

6. State Oil & Gas Lease No.

Federal Lease # USA SF-079391

7. Lease Name or Unit Agreement Name

San Juan 27-5 Unit

8. Well Number

#901

9. OGRID Number

14538

10. Pool name or Wildcat

Blanco MV/Basin DK

SUNDRY NOTICES AND REPORTS ON WELLS
(DO NOT USE THIS FORM FOR PROPOSALS TO DRILL OR TO DEEPEN OR PLUG BACK TO A
DIFFERENT RESERVOIR. USE "APPLICATION FOR PERMIT" (FORM C-101) FOR SUCH
PROPOSALS.)

1. Type of Well:

Oil Well ☐Gas Well ☒

Other

2. Name of Operator

BURLINGTON RESOURCES OIL & GAS COMPANY LP

3. Address of Operator

3401 E. 30TH STREET, FARMINGTON, NM 87402

4. Well Location

Unit Letter E : 1646' feet from the North line and 1146' feet from the West line
Section 8 Township 27N Rng 5W NMPM County Rio Arriba

11. Elevation (Show whether DR, RKB, RT, GR, etc.)

6619'

Pit or Below-grade Tank Application

☐ or Closure ☐

Pit type

New Drill

Depth to Groundwater

>100

Distance from nearest fresh water well

>1000

Distance from nearest surface water

<200

Pit Liner Thickness:

12

mil

Below-Grade Tank:

Volume

bbls;

Construction Material

12. Check Appropriate Box to Indicate Nature of Notice, Report or Other Data

NOTICE OF INTENTION TO:PERFORM REMEDIAL WORK ☐PLUG AND ABANDON ☐TEMPORARILY ABANDON ☐CHANGE PLANS ☐PULL OR ALTER CASING ☐MULTIPLE COMPL ☐**SUBSEQUENT REPORT OF:**REMEDIAL WORK ☐ALTERING CASING ☐COMMENCE DRILLING OPNS. ☐P AND A ☐CASING/CEMENT JOB ☐

OTHER:

New Drill ☒OTHER: ☐

13. Describe proposed or completed operations. (Clearly state all pertinent details, and give pertinent dates, including estimated date of starting any proposed work). SEE RULE 1103. For Multiple Completions: Attach wellbore diagram of proposed completion or recompletion.

New Drill, Lined:

Burlington Resources proposes to construct a new drilling pit, an associated vent/flare pit and a pre-set mud pit (if required). Based on Burlington's interpretation of the Ecosphere's risk ranking criteria, the new drilling pit and pre-set mud pit will be lined pits as detailed in Burlington's Revised Drilling / Workover Pit Construction / Operation Procedures dated November 11, 2004 on file at the NMOCD office. A portion of the vent/flare pit will be designed to manage fluids and that portion will be lined as per the risk ranking criteria. Burlington Resources anticipates closing these pits according to the Drilling / Workover Pit Closure Procedure dated August 2, 2004 on file at the NMOCD office.

I hereby certify that the information above is true and complete to the best of my knowledge and belief. I further certify that any pit or below-grade tank has been/will be constructed or closed according to NMOCD guidelines ☐, a general permit ☒ or an (attached) alternative OCD-approved plan ☐.

SIGNATURE

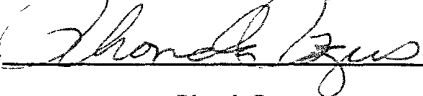

TITLE

Regulatory Technician

DATE

7-24-07

Type or print name

Rhonda Rogers

E-mail address:

rogers@conocophillips.com

Telephone No.

505-599-4018

For State Use Only

APPROVED BY



TITLE

Deputy Oil & Gas Inspector,
District #3

DATE

SEP 06 2007

Conditions of Approval (if any):

PROJECT PROPOSAL - New Drill / Sidetrack

San Juan Business Unit

SAN JUAN 27-5 UNIT 901

DEVELOPMENT

Lease:		AFE #: WAN.CDR.7181		AFE \$:	
Field Name: hBR_SAN JUAN 27-5 UNIT		Rig: Aztec Riq 673		State: NM	County: RIO ARRIBA
Geologist:		Phone:		Geophysicist:	
Geoscientist: Riley, Brook		Phone: +1 505-324-6108		Prod. Engineer:	
Res. Engineer: McKee, Cory J		Phone: 505-326-9826		Proj. Field Lead:	
Primary Objective (Zones):					
Zone	Zone Name				
R20002	MESAVERDE(R20002)				
R20076	DAKOTA(R20076)				
Location: Surface					
Datum Code: NAD 27		Deviated			
Latitude: 36.591451	Longitude: -107.386398	X:	Y:	Section: 08	Range: 005W
Footage X: 1146 FWL	Footage Y: 1646 FNL	Elevation: 6619	(FT)	Township: 027N	
Tolerance:					
Location: Bottom Hole					
Datum Code: NAD 27		Deviated			
Latitude: 36.593348	Longitude: -107.386764	X:	Y:	Section: 08	Range: 005W
Footage X: 1040 FWL	Footage Y: 960 FNL	Elevation:	(FT)	Township: 027N	
Tolerance:					
Location Type: Restricted		Start Date (Est.):		Completion Date:	
Date In Operation:					
Formation Data: Assume KB = 6635 Units = FT					
Formation Call & Casing Points	Depth (TVD in Ft)	SS (Ft)	Depletion (Yes/No)	BHP (PSIG)	BHT
Surface Casing	200	6435	<input type="checkbox"/>		
OJAM	2717	3918	<input type="checkbox"/>		
KRLD	2947	3688	<input type="checkbox"/>		
FRLD	3024	3611	<input type="checkbox"/>		Possible Gas
PCCF	3418	3217	<input type="checkbox"/>		
LEWS	3520	3115	<input type="checkbox"/>		
Intermediate Casing	3620	3015	<input type="checkbox"/>		
HUERFANITO BENTONITE	3952	2683	<input type="checkbox"/>		
CHRA	4362	2273	<input type="checkbox"/>		
UCLFH	4988	1647	<input type="checkbox"/>		Gas
MASSIVE CLIFF HOUSE	5078	1557	<input type="checkbox"/>	702	Gas
MENF	5258	1377	<input type="checkbox"/>		
PTLK	5564	1071	<input type="checkbox"/>		
MNCS	6041	594	<input type="checkbox"/>		
GLLP	6765	-130	<input type="checkbox"/>		
GRHN	7516	-881	<input type="checkbox"/>		
GRRS	7573	-938	<input type="checkbox"/>		
TWLS	7606	-971	<input type="checkbox"/>	2600	Gas
PAGU	7706	-1071	<input type="checkbox"/>		
CBRO	7726	-1091	<input type="checkbox"/>		
CBRL	7770	-1135	<input type="checkbox"/>		
OAK CANYON	7850	-1215	<input type="checkbox"/>		TD T/OKCN

PROJECT PROPOSAL - New Drill / Sidetrack

San Juan Business Unit

SAN JUAN 27-5 UNIT 901

DEVELOPMENT

TOTAL DEPTH DK	7850	-1215	<input type="checkbox"/>	6-1/4" Hole. 4-1/2", 10.6/11.6 ppf, J-55 STC/LTC casing. Cement with 576 cuft. Circulate cement a minimum of 100' inside the previous casing string.
----------------	------	-------	--------------------------	--

Reference Wells:		
Reference Type	Well Name	Comments

Logging Program:	
Intermediate Logs:	<input type="checkbox"/> Log only if show <input type="checkbox"/> GR/ILD <input type="checkbox"/> Triple Combo

TD Logs:	<input type="checkbox"/> Triple Combo <input type="checkbox"/> Dipmeter <input type="checkbox"/> RFT <input type="checkbox"/> Sonic <input type="checkbox"/> VSP <input type="checkbox"/> TDT <input checked="" type="checkbox"/> Other
GR_CBL, MUDLOG 100' above GRHN to TD	

Additional Information:					
Log Type	Stage	From (Ft)	To (Ft)	Tool Type/Name	Remarks

Comments: Location/Tops/Logging - MVNM027N005W08SW3 DKNM027N005W08SW3 SHL as twin with 150R and BHL at 960' FNL & 1040' FWL.
Mudlog 100' above GRHN to TD

Zones - MVNM027N005W08NW3 DKNM027N005W08NW3

ConocoPhillips

Survey Report

Company:	ConocoPhillips Lower 48	Local Co-ordinate Reference:	Well SJ 27-5 #901
Project:	San Juan Basin	TVD Reference:	WELL @ 6634.0ft (Original Well Elev)
Site:	Monty's Site for directional MV/DK wells	MD Reference:	WELL @ 6634.0ft (Original Well Elev)
Well:	SJ 27-5 #901	North Reference:	True
Wellbore:	SJ 27-5 #901	Survey Calculation Method:	Minimum Curvature
Design:	Plan #1	Database:	EDM Central Planning

Planned Survey

Measured Depth (ft)	Inclination (d)	Azimuth (d)	Vertical Depth (ft)	+N/-S (ft)	+E/-W (ft)	Vertical Section (ft)	Dogleg Rate (d/100ft)	Build Rate (d/100ft)	Turn Rate (d/100ft)
7,889.7	0.00	0.00	7,770.0	686.0	-106.0	694.1	0.00	0.00	0.00
Lower Cubero									
7,900.0	0.00	0.00	7,780.3	686.0	-106.0	694.1	0.00	0.00	0.00
7,969.7	0.00	0.00	7,850.0	686.0	-106.0	694.1	0.00	0.00	0.00
Oak Canyon - TD - SJ 27-5 #901 - PCP									

Targets

Target Name hit/miss target Shape	Dip Angle (d)	Dip Dir. (d)	TVD (ft)	+N/-S ft	+E/-W ft	Northing (m)	Easting (m)	Latitude	Longitude
SJ 27-5 #901 - ICP - plan hits target - Point	0.00	0.00	3,620.0	686.0	-106.0	209.58	-29.31	30° 59' 31.302" N	109° 25' 45.312" W
SJ 27-5 #901 - PCP - plan hits target - Point	0.00	0.00	7,850.0	686.0	-106.0	209.58	-29.31	30° 59' 31.302" N	109° 25' 45.312" W

Formations

Measured Depth (ft)	Vertical Depth (ft)	Name	Lithology	Dip (d)	Dip Direction (d)
2,803.0	2,717.0	Ojo Alamo		0.00	
3,051.9	2,947.0	Kirtland		0.00	
3,133.6	3,024.0	Fruitland		0.00	
3,537.3	3,418.0	Pictured Cliffs		0.00	
3,639.7	3,520.0	Lewis		0.00	
4,071.7	3,952.0	Huerf. Bent		0.00	
4,481.7	4,362.0	Chacra		0.00	
5,107.7	4,988.0	Upper Cliffhouse		0.00	
5,197.7	5,078.0	Mass. Cliffhouse		0.00	
5,377.7	5,258.0	Menefee		0.00	
5,683.7	5,564.0	Pt Lookout		0.00	
6,160.7	6,041.0	Mancos Shale		0.00	
6,884.7	6,765.0	Gallup		0.00	
7,635.7	7,516.0	Greenhorn		0.00	
7,692.7	7,573.0	Graneros		0.00	
7,725.7	7,606.0	Two Wells		0.00	
7,825.7	7,706.0	Paguate		0.00	
7,845.7	7,726.0	Upper Cubero		0.00	
7,889.7	7,770.0	Lower Cubero		0.00	
7,969.7	7,850.0	Oak Canyon		0.00	
7,969.7	7,850.0	TD		0.00	

Checked By: _____	Approved By: _____	Date: _____
-------------------	--------------------	-------------

BURLINGTON RESOURCES OIL & GAS COMPANY LP.
SAN JUAN 27-5 UNIT 901 - 1646' FNL & 1146' FWL (SURFACE) - 960' FNL & 1040' FWL (BOTTOM)
SECTION 8, T-27-N, R-5-W, N.M.P.M., RIO ARriba COUNTY, N.M.
GROUND ELEVATION: 6619 - DATE: MAY 17, 2007

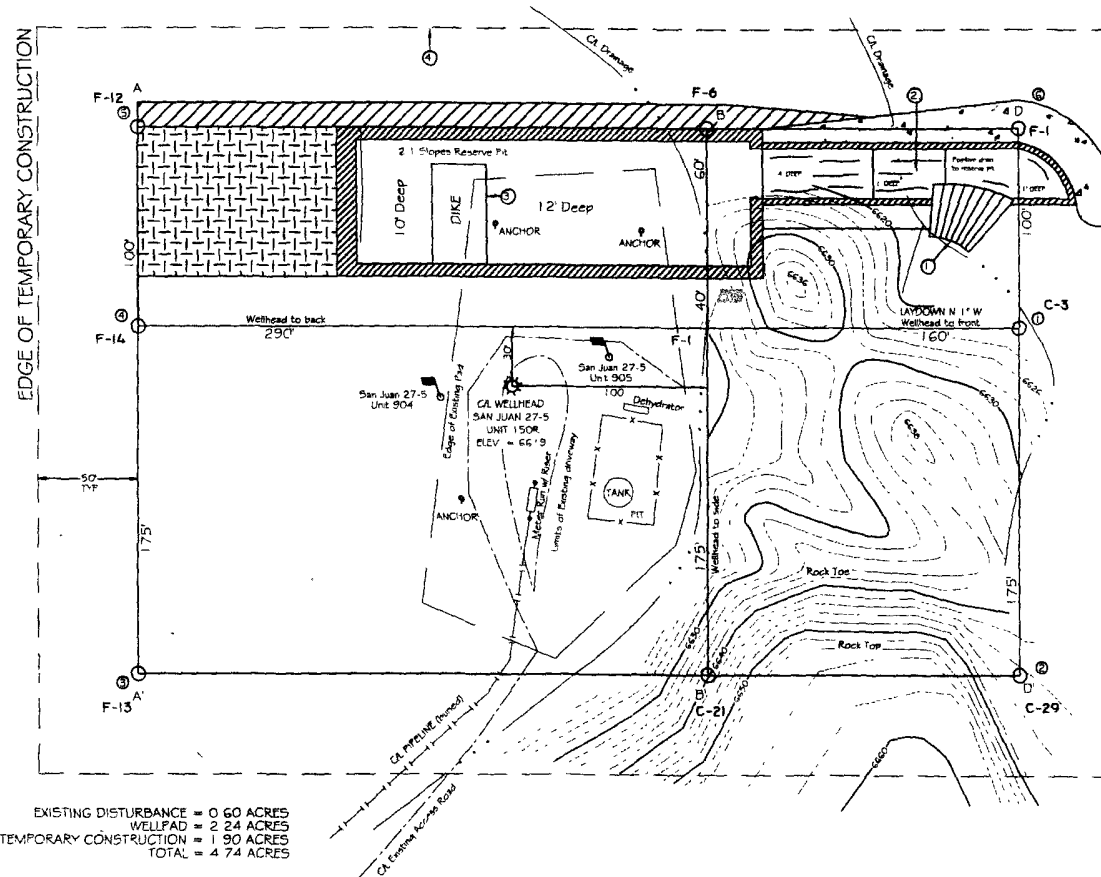

LATITUDE 36°35'48.73" N LONGITUDE 107°23'18.39" W NAD 27

PAD CONST. SPECS

- 1) RAMP INTO PIT CONSTRUCTED FROM PAD GRADE INTO FLARE AREA AT 5% SLOPE
- 2) APPROXIMATE 13x75' PIT AREA LINED WITH 12 MIL POLYURETHANE
- 3) RESERVE PIT DIKE TO BE 6" ABOVE DEEP SIDE OVERFLOW, 3" WIDE AND 1" ABOVE SHALLOW SIDE
- 4) EDGE OF TEMPORARY CONSTRUCTION DEFINED IN FIELD W/6" T-POST

- 1) CONTRACTOR SHOULD CALL "ONE-CALL" FOR LOCATION OF ANY MARKED OR UNMARKED BURIED PIPELINES OR CABLES ON WELLPAD AND OR ACCESS ROAD AT LEAST TWO (2) WORKING DAYS PRIOR TO CONST

- 2) UNITED FIELD SERVICES, INC. IS NOT LIABLE FOR UNDERGROUND UTILITIES OR PIPELINES

SURVEYED: 5/17/07	REV. DATE:	APP BY: M.W.L.
DRAWN BY: H.S.	DATE DRAWN: 6/18/07	FILE NAME: 7895L01

UNITED
FIELD SERVICES INC.

P.O. BOX 3651
FARMINGTON, NM 87406
OFFICE: (505)334-0408

BURLINGTON RESOURCES OIL & GAS COMPANY LP.
 SAN JUAN 27-5 UNIT 901 - 1646' FNL & 1146' FWL (SURFACE)
 960' FNL & 1040' FWL (BOTTOM)
 SECTION 8, T-27-N, R-5-W, N.M.P.M., RIO ARRIBA COUNTY, N.M.
 GROUND ELEVATION: 6619 - DATE: MAY 17, 2007

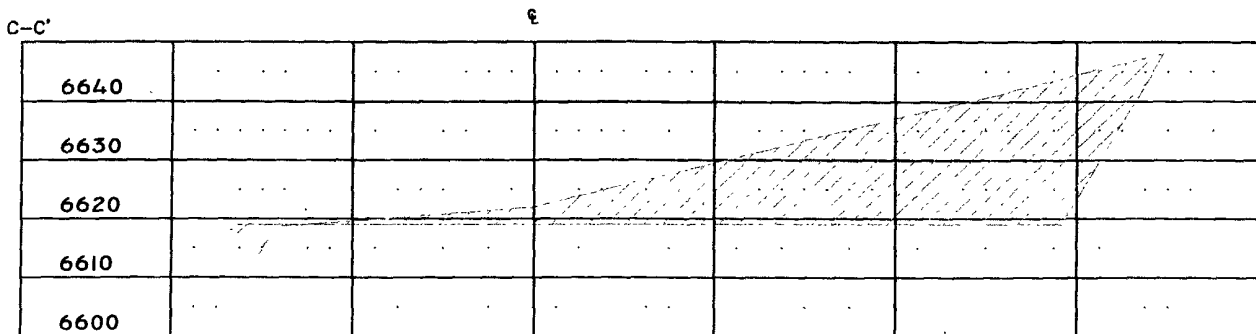
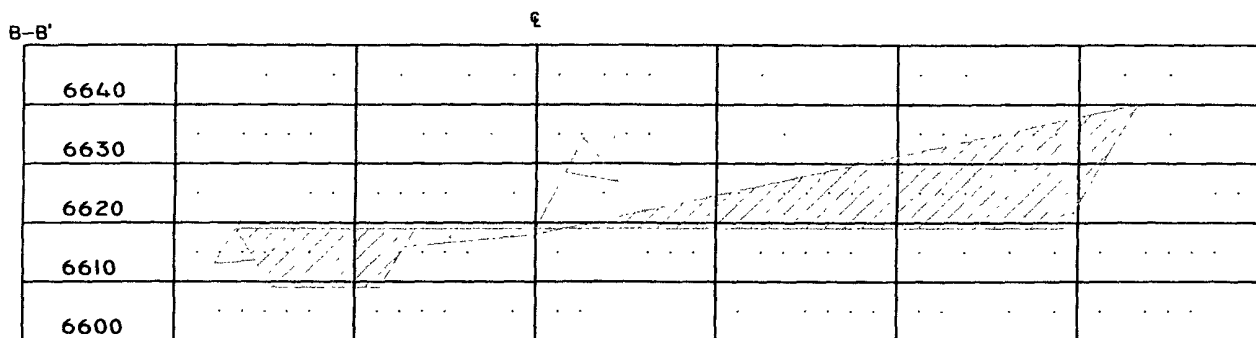
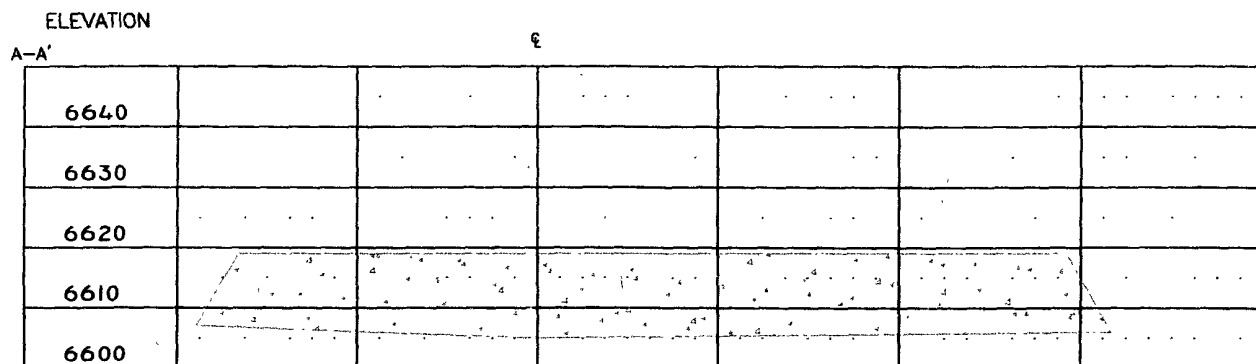

1" = 60' - HORIZ.
 1" = 30' - VERT.

CONTRACTOR SHOULD CALL "ONE-CALL" FOR LOCATION OF ANY MARKED
 OR UNMARKED BURIED PIPELINES OR CABLES ON WELLPAD AND OR
 ACCESS ROAD AT LEAST TWO (2) WORKING DAYS PRIOR TO CONST.

2) UNITED FIELD SERVICES, INC. IS NOT LIABLE FOR UNDERGROUND
 UTILITIES OR PIPELINES.

SURVEYED: 5/17/07

REV. DATE:

APP. BY M.W.L.

DRAWN BY: H.S.

DATE DRAWN: 6/18/07

FILE NAME: 7695C01

UNITED
 FIELD SERVICES INC.

P.O. BOX 3651
 FARMINGTON, NM 87499
 OFFICE: (505)334-0408