

UNITED STATES
DEPARTMENT OF THE INTERIOR
BUREAU OF LAND MANAGEMENT

APPLICATION FOR PERMIT TO DRILL, DEEPEN, OR PLUG BACK PM 3: 48

1a. Type of Work DRILL	5. Lease Number SF-080673 Unit Reporting Number 210 FARMINGTON NM NM-78408B	
1b. Type of Well GAS	6. If Indian, All. or Tribe	
2. Operator BURLINGTON RESOURCES Oil & Gas Company, LP	7. Unit Agreement Name San Juan 27-4 Unit	
3. Address & Phone No. of Operator PO Box 4289, Farmington, NM 87499 (505) 326-9700	8. Farm or Lease Name 9. Well Number #41N	
4. Location of Well Unit F (SENW), 1450' FNL & 2000' FWL, Latitude 36° 35.44324 N Longitude 107° 17.55421 W	10. Field, Pool, Wildcat Basin Dakota 11. Sec., Twn, Rge, Mer. (NMPM) Sec. 7, T27N, R4W API # 30-039-30213	
14. Distance in Miles from Nearest Town	12. County Rio Arriba	13. State NM
15. Distance from Proposed Location to Nearest Property or Lease Line 1450'	17. Acres Assigned to Well 319.37 - (W/2) 321.56	
16. Acres in Lease	18. Distance from Proposed Location to Nearest Well, Drlg, Compl, or Applied for on this Lease	
19. Proposed Depth 8209'	20. Rotary or Cable Tools Rotary	
21. Elevations (DF, FT, GR, Etc.) 6925' GL	22. Approx. Date Work will Start RCVD SEP 5 '07 OIL CONS. DIV. DIST. 3	
23. Proposed Casing and Cementing Program See Operations Plan attached	24. Authorized by: <u>Rhonda Rogers</u> Rhonda Rogers (Regulatory Technician) 3-1-07 Date	

PERMIT NO.

APPROVAL DATE

APPROVED BY

TITLE

DATE

Archaeological Report attached

Threatened and Endangered Species Report attached

NOTE: This format is issued in lieu of U.S. BLM Form 3160-3

Title 18 U.S.C. Section 1001, makes it a crime for any person knowingly and willfully to make to any department or agency of the United States any false, fictitious or fraudulent statements or presentations as to any matter within its jurisdiction.

Example Master Plan Type 3

DILLING OPERATIONS AUTHORIZED ARE
SUBJECT TO COMPLIANCE WITH ATTACHED
"GENERAL REQUIREMENTS".

NMOCD

This action is subject to technical and
procedural review pursuant to 43 CFR 3165.3
and appeal pursuant to 43 CFR 3165.4

DISTRICT I
1625 N. French Dr., Hobbs, N.M. 88240

DISTRICT II
811 South First, Artesia, N.M. 88210

DISTRICT III
1000 Rio Brazos Rd., Aztec, N.M. 87410

DISTRICT IV
3040 South Pacheco, Santa Fe, NM 87505

State of New Mexico
Energy, Minerals & Natural Resources Department

Form C-102
Revised August 15, 2000

OIL CONSERVATION DIVISION
2040 South Pacheco
Santa Fe, NM 87505

Submit to Appropriate District Office
State Lease - 4 Copies
Fee Lease - 3 Copies

RCVD SEP 5 '07

☐ AMENDED REPORT

WELL LOCATION AND ACREAGE DEDICATION PLAT OIL CONS. DIV.

¹ API Number 30-039-30213	² Pool Code 71599	³ Pool Name BASIN DAKOTA	⁴ Well Number DIST 3 41N
⁵ Property Code 7452	⁶ Property Name SAN JUAN 27-4 UNIT		⁷ Elevation 6925'
⁸ GRID No. 14538	⁹ Operator Name BURLINGTON RESOURCES O&G CO LP		

¹⁰ Surface Location

UL or lot no.	Section	Township	Range	Lot Idn	Feet from the	North/South line	Feet from the	East/West line	County
F	7	27N	4W		1450'	NORTH	2000'	WEST	RIO ARriba

¹¹ Bottom Hole Location if Different From Surface

UL or lot no.	Section	Township	Range	Lot Idn	Feet from the	North/South line	Feet from the	East/West line	County
F									
¹² Dedicated Acres 331.56 349.57 Acres - (W/2)					¹³ Joint or Infill		¹⁴ Consolidation Code		¹⁵ Order No.

NO ALLOWABLE WILL BE ASSIGNED TO THIS COMPLETION UNTIL ALL INTERESTS HAVE BEEN CONSOLIDATED
OR A NON-STANDARD UNIT HAS BEEN APPROVED BY THE DIVISION

¹⁶ SINGLE PROPORTIONED CORNER 40.52 1 SAN JUAN 27-4 UNIT #31Y 2000'		S 88°47'31" W WEST 5158.56' (M) 5298.48' (R) LAT. 36.59073° N (NAD 83) LONG. 107.29367° W (NAD 83) LAT. 36°35.44324 N (NAD 27) LONG. 107°17.58421 W (NAD 27)		IND 1" PIPE	
40.43 2 5315.22' (M) 5280.00' (R)					
LEASE # USA SF-080673-7					
40.35 3 N 0°05'03" NORTH					
40.26 4					
IND 3 1/4" BC. SLM 1957					

¹⁷ OPERATOR CERTIFICATION

I hereby certify that the information contained herein is true and complete to the best of my knowledge and belief.

Kandis Burns
Signature
Kandis Burns
Printed Name
Regulatory Technician
Title
November 1 2006
Date

¹⁸ SURVEYOR CERTIFICATION

I hereby certify that the well location shown on this plat was plotted from field notes of actual surveys made by me or under my supervision, and that the same is true and correct to the best of my belief.

SEPTEMBER 30, 2006
Date of Survey
Signature and Seal of Professional Surveyor
David R. Russell
DAVID R. RUSSELL
Certificate Number 10201

District I

1625 N. French Dr., Hobbs, NM 88240

District II

1301 W. Grand Ave., Artesia, NM 88210

District III

1000 Rio Brazos Rd., Aztec, NM 87410

District IV

1220 S. St. Francis Dr., Santa Fe, NM 87505

Energy, Minerals and Natural Resources

OIL CONSERVATION DIVISION

1220 South St. Francis Dr.
Santa Fe, NM 87505

May 27, 2004

<p>SUNDRY NOTICES AND REPORTS ON WELLS (DO NOT USE THIS FORM FOR PROPOSALS TO DRILL OR TO DEEPEN OR PLUG BACK TO A DIFFERENT RESERVOIR. USE "APPLICATION FOR PERMIT" (FORM C-101) FOR SUCH PROPOSALS.)</p>		<p>WELL API NO. 30-039- 30213</p>
<p>1. Type of Well: Oil Well <input type="checkbox"/> Gas Well <input checked="" type="checkbox"/> Other</p>		<p>5. Indicate Type of Lease STATE <input type="checkbox"/> FEE <input type="checkbox"/></p>
<p>2. Name of Operator BURLINGTON RESOURCES OIL & GAS COMPANY LP</p>		<p>6. State Oil & Gas Lease No. SF-080673</p>
<p>3. Address of Operator 3401 E. 30TH STREET, FARMINGTON, NM 87402</p>		<p>7. Lease Name or Unit Agreement Name San Juan 27-4 Unit</p>
<p>4. Well Location Unit Letter <u>F</u> : <u>1450'</u> feet from the <u>North</u> line and <u>2000'</u> feet from the <u>West</u> line Section <u>7</u> Township <u>27N</u> Rng <u>4W</u> NMPM County <u>Rio Arriba</u></p>		<p>8. Well Number 41N</p>
<p>11. Elevation (Show whether DR, RKB, RT, GR, etc.) 6925'</p>		<p>9. OGRID Number 14538</p>
<p>Pit or Below-grade Tank Application <input type="checkbox"/> or Closure <input type="checkbox"/></p>		<p>10. Pool name or Wildcat Basin Dakota</p>
<p>Pit type <u>New Drill</u> Depth to Groundwater <u>>100'</u> Distance from nearest fresh water well <u>>1000'</u> Distance from nearest surface water <u>>100'</u></p>		
<p>Pit Liner Thickness: <u>12</u> mil Below-Grade Tank: Volume <u> </u> bbls; Construction Material <u> </u></p>		

12. Check Appropriate Box to Indicate Nature of Notice, Report or Other Data

NOTICE OF INTENTION TO:

PERFORM REMEDIAL WORK ☐ PLUG AND ABANDON ☐
TEMPORARILY ABANDON ☐ CHANGE PLANS ☐
PULL OR ALTER CASING ☐ MULTIPLE COMPL ☐

SUBSEQUENT REPORT OF:

REMEDIAL WORK ☐ ALTERING CASING ☐
COMMENCE DRILLING OPNS. ☐ P AND A ☐
CASING/CEMENT JOB ☐

OTHER: New Drill Pit ☒

OTHER: ☐

13. Describe proposed or completed operations. (Clearly state all pertinent details, and give pertinent dates, including estimated date of starting any proposed work). SEE RULE 1103. For Multiple Completions: Attach wellbore diagram of proposed completion or recompletion.

RCVD SEP 5 '07
OIL CONS. DIV.
DIST. 3

New Drill, Lined:

Burlington Resources proposes to construct a new drilling pit and an associated vent/flare pit. Based on Burlington's interpretation of the Ecosphere's risk ranking criteria, the new drilling pit will be a lined pit as detailed in Burlington's Revised Drilling / Workover Pit Construction / Operation Procedures dated November 11, 2004 on file at the NMOCD office. A portion of the vent/flare pit will be designed to manage fluids and that portion will be lined as per the risk ranking criteria. Burlington Resources anticipates closing these pits according to the Drilling / Workover Pit Closure Procedure dated August 2, 2004 on file at the NMOCD office.

I hereby certify that the information above is true and complete to the best of my knowledge and belief. I further certify that any pit or below-grade tank has been/will be constructed or closed according to NMOCD guidelines ☐, a general permit ☒ or an (attached) alternative OCD-approved plan ☐.

SIGNATURE Rhonda Rogers TITLE Regulatory Technician DATE 2/28/2007

Type or print name Rhonda Rogers E-mail address: rogers@br-inc.com Telephone No. 505-326-9700

For State Use Only

APPROVED BY [Signature] TITLE Deputy Oil & Gas Inspector, District #3 DATE SEP 10 2007

Conditions of Approval (if any):

PROJECT PROPOSAL - New Drill / Sidetrack

San Juan Business Unit

SAN JUAN 27-4 UNIT 41N

Lease:		AFE #: WAN.CDR.7071		AFE \$: 636,161.40	
Field Name: hBR_SAN JUAN 27-4 UNIT		Rig: XX 2008 27N (2)		State: NM	County: RIO ARRIBA
Geoscientist: Head, Chip F		Phone: 505-326-9772		Prod. Engineer: Phone:	
Res. Engineer: Prabowo, Wahyu		Phone: 832-486-2275		Proj. Field Lead: Phone:	
Primary Objective (Zones):					
Zone	Zone Name				
R20076	DAKOTA(R20076)				

Location: Surface		Datum Code: NAD 27		Straight Hole	
Latitude: 36.590721	Longitude: -107.293070	X:	Y:	Section: 07	Range: 004W
Footage X: 2000 FWL	Footage Y: 1450 FNL	Elevation: 6925	(FT)	Township: 027N	
Tolerance:					

Location Type: Summer Only	Start Date (Est.):	Completion Date:	Date In Operation:
Formation Data: Assume KB = 6937 Units = FT			

Formation Call & Casing Points	Depth (TVD in Ft)	SS (Ft)	Depletion (Yes/No)	BHP (PSIG)	BHT	Remarks
SURFACE CSG	216	6721	<input type="checkbox"/>			12-1/4 hole. 9-5/8" 32.3 ppf, H-40, STC casing. Cement with 171 cuft. Circulate cement to surface.
OJAM	3109	3828	<input type="checkbox"/>			Possible water flows.
KRLD	3328	3609	<input type="checkbox"/>			
FRLD	3414	3523	<input type="checkbox"/>			Possible gas.
PCCF	3751	3186	<input type="checkbox"/>			
LEWS	3924	3013	<input type="checkbox"/>			
Intermediate Casing	4024	2913	<input type="checkbox"/>			8-3/4" Hole. 7", 20 ppf, J-55, STC Casing. Cement with 906 cuft. Circulate cement to surface.
HURF	4326	2611	<input type="checkbox"/>			
CHRA	4727	2210	<input type="checkbox"/>			
UCLFH	5343	1594	<input type="checkbox"/>			
CLFH	5460	1477	<input type="checkbox"/>			Gas; possibly wet
MENF	5586	1351	<input type="checkbox"/>			Gas.
PTLK	5935	1002	<input type="checkbox"/>	800		Gas.
MNCS	6466	471	<input type="checkbox"/>			
GLLP	7110	-173	<input type="checkbox"/>			Gas. Possibly wet.
GRHN	7879	-942	<input type="checkbox"/>	1700		Gas possible, highly fractured
GRRS	7941	-1004	<input type="checkbox"/>			
TWLS	7974	-1037	<input type="checkbox"/>			Gas
CBBO	8088	-1151	<input type="checkbox"/>			Gas
CBRL	8133	-1196	<input type="checkbox"/>			
OKCN	8189	-1252	<input type="checkbox"/>			
ENCINAL	8209	-1272	<input type="checkbox"/>			
TD	8209	-1272	<input type="checkbox"/>			TD at T/ENCN. 6-1/4" hole. 4-1/2", 10.5/11.6 ppf, J-55 STC/LTC casing. Cement with 570 cuft. Circulate cement a minimum of 100' inside the previous casing string.

Reference Wells:		
Reference Type	Well Name	Comments
Production	27-4 #41M	SW 7-27N-4W On Strike

PROJECT PROPOSAL - New Drill / Sidetrack

San Juan Business Unit

SAN JUAN 27-4 UNIT 41N

Production	27-4 #31B	SW 7-27N-4W Kmv well - same pad
Production	27-4 #31Y	SW 7-27N-4W

Logging Program:

Intermediate Logs: ☐ Log only if show ☐ GR/ILD ☐ Triple Combo

TD Logs: ☐ Triple Combo ☐ Dipmeter ☐ RFT ☐ Sonic ☐ VSP ☐ TDT ☒ Other
GR_CBL

Additional Information:

Log Type	Stage	From (Ft)	To (Ft)	Tool Type/Name	Remarks
----------	-------	-----------	---------	----------------	---------

Comments: Location/Tops/Logging - DK 27N04W07NW2

Zones - DK 27N04W07NW2

LATITUDE: 36.59073°N
 LONGITUDE: 107.29367°W
 DATUM: NAD 83

BURLINGTON RESOURCES O&G CO LP

SAN JUAN 27-4 UNIT #41N

1450' FNL & 2000' FWL

LOCATED IN THE SE/4 NW/4 OF

SECTION 7, T27N, R4W, N.M.P.M.,

RIO ARriba COUNTY, NEW MEXICO

GROUND ELEVATION: 6925', NAVD 88

FINISHED PAD ELEVATION: 6925.4', NAVD 88

SLOPES TO BE CONSTRUCTED TO
 MATCH THE ORIGINAL CONTOURS
 AS CLOSE AS POSSIBLE.

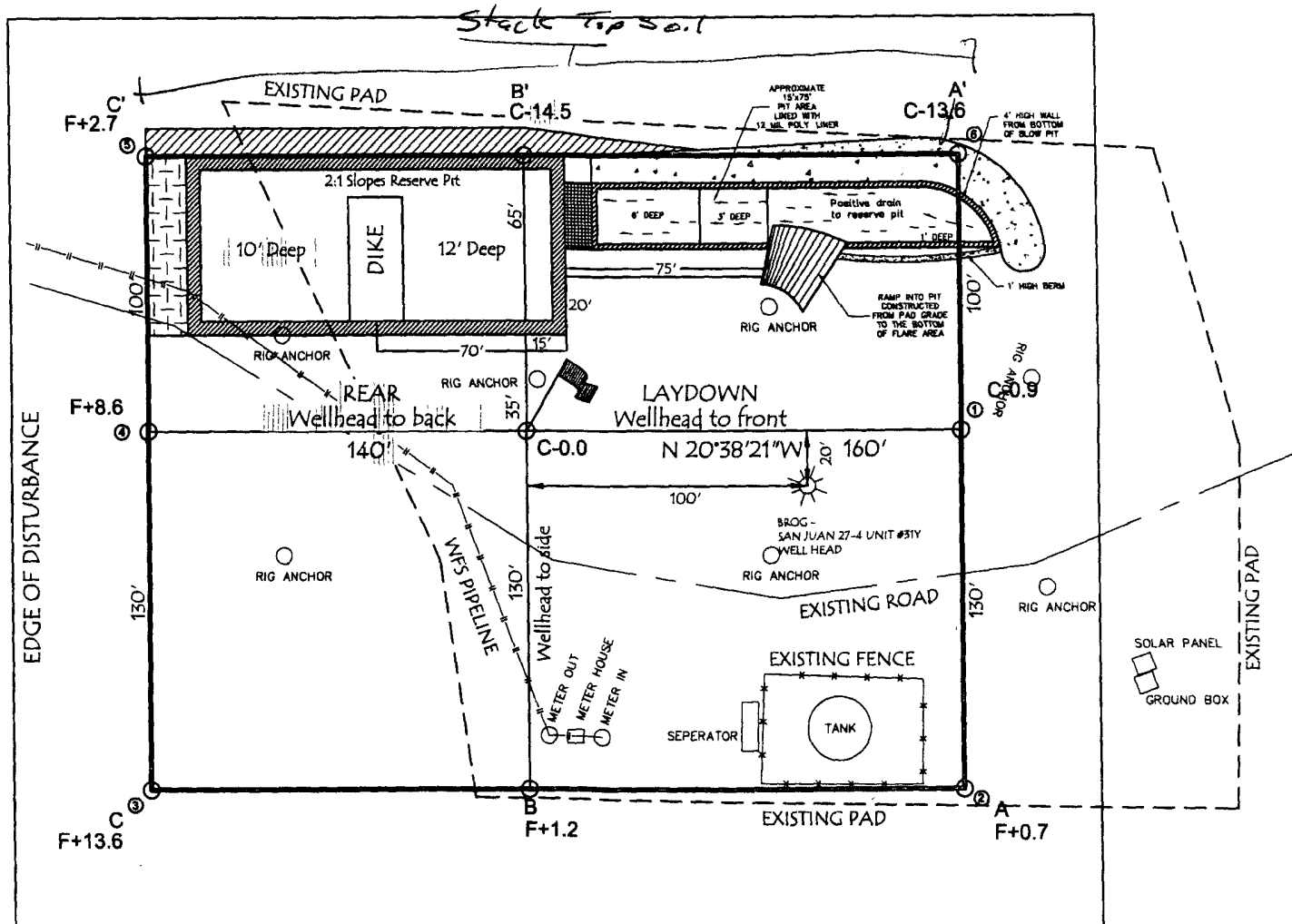
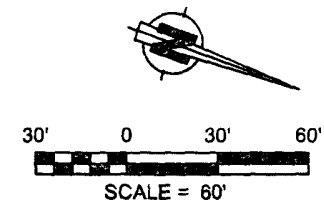

330' x 400' = 3.03 ACRES OF DISTURBANCE
 SCALE: 1" = 60'
 JOB No.: COPC035
 DATE: 10/25/06

NOTE:

RESERVE PIT DIKE: TO BE 8' ABOVE DEEP SIDE (OVERFLOW - 3' WIDE AND 1' ABOVE SHALLOW SIDE).
 RUSSELL SURVEYING, INC. IS NOT LIABLE FOR UNDERGROUND UTILITIES OR PIPELINES.
 CONTRACTOR SHOULD CALL ONE-CALL FOR LOCATION OF ANY MARKED OR UNMARKED, BURIED PIPELINES OR
 CABLES ON WELL PAD, IN CONSTRUCTION ZONE AND/OR ACCESS ROAD AT LEAST TWO (2) WORKING DAYS PRIOR
 TO CONSTRUCTION.



Russell Surveying
 1409 W. Aztec Blvd. #5
 Aztec, New Mexico 87410
 (505) 334-8637

LATITUDE: 36.59073°N
LONGITUDE: 107.29367°W
DATUM: NAD 83

BURLINGTON RESOURCES O&G CO LP

SAN JUAN 27-4 UNIT #41N
1450' FNL & 2000' FWL
LOCATED IN THE SE/4 NW/4 OF
SECTION 7, T27N, R4W, N.M.P.M.,
RIO ARriba COUNTY, NEW MEXICO
GROUND ELEVATION: 6925', NAVD 88
FINISHED PAD ELEVATION: 6925.4', NAVD 88

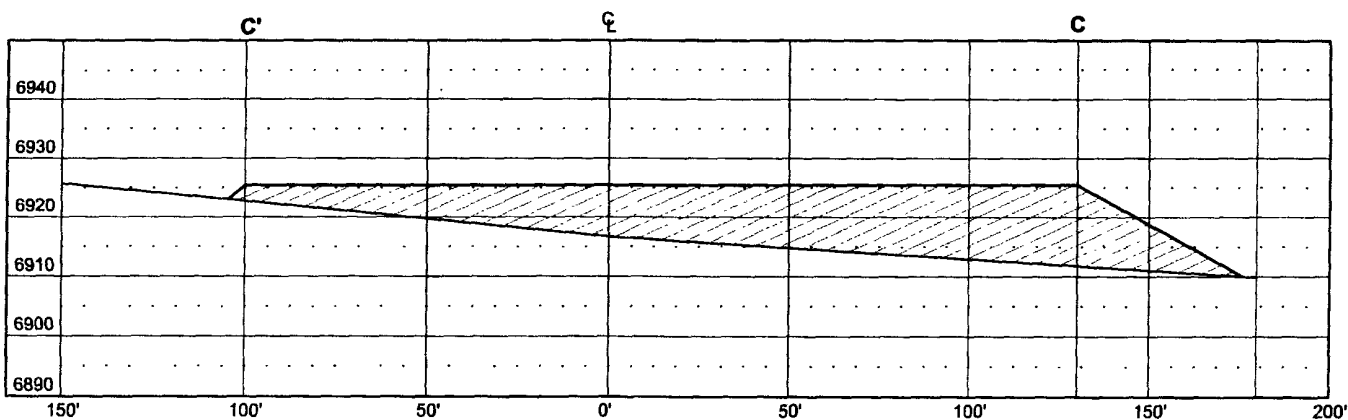
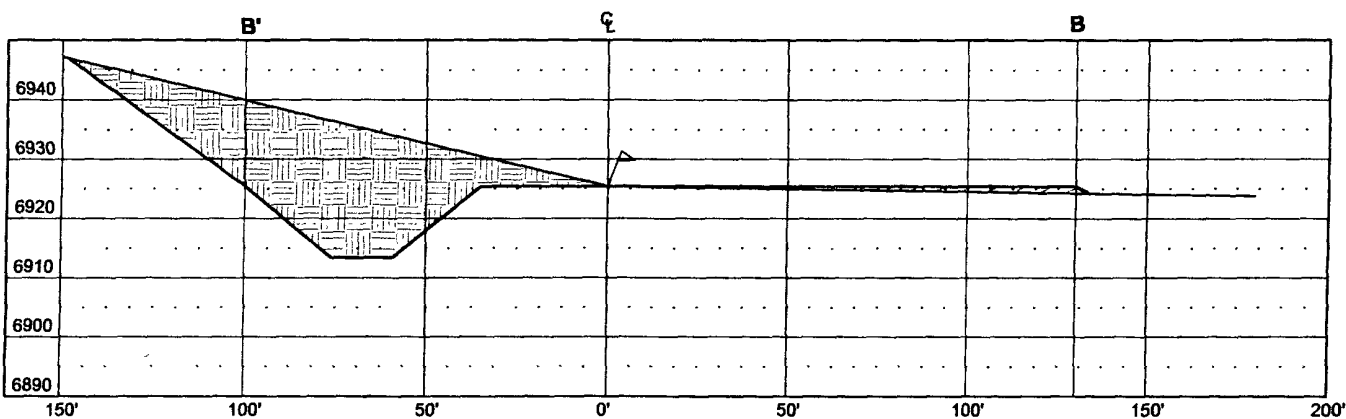
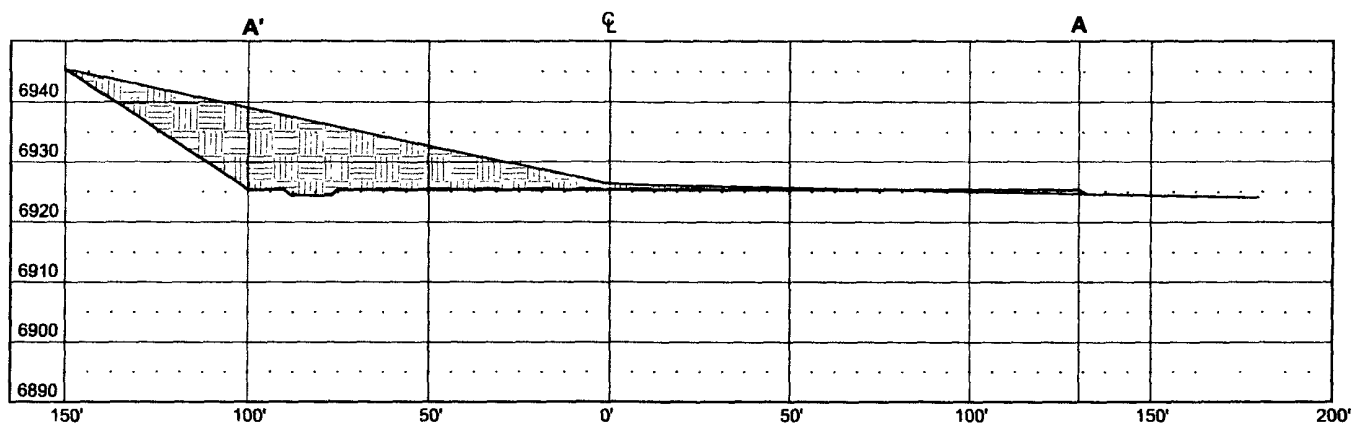

THIS DIAGRAM IS AN ESTIMATE OF DIRT BALANCE AND IS NOT INTENDED TO BE AN EXACT MEASURE OF VOLUME

VERT. SCALE: 1" = 30'
HORZ. SCALE: 1" = 50'
JOB No.: COPC035
DATE: 10/25/06

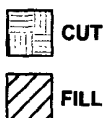

Russell Surveying
1409 W. Aztec Blvd. #5
Aztec, New Mexico 87410
(505) 334-8637