

UNITED STATES  
DEPARTMENT OF THE INTERIOR  
BUREAU OF LAND MANAGEMENT

APPLICATION FOR PERMIT TO DRILL, DEEPEN, OR PLUG BACK

RECEIVED

|   |   |   |
|---|---|---|
| 1a. Type of Work<br>DRILL   | 5. Lease Number<br>NMNM2995   | 2003 AUG 22 PM 2:01   |
| 1b. Type of Well<br>GAS   | Unit Reporting Number<br>070 Farmington, NM   | 6. If Indian, All. or Tribe   |
| 2. Operator<br><b>BURLINGTON</b><br>RESOURCES Oil & Gas Company                                       | 7. Unit Agreement Name  |   |
| 3. Address & Phone No. of Operator<br>PO Box 4289, Farmington, NM 87499<br><br>(505) 326-9700         | 8. Farm or Lease Name<br>Burnt Mesa   | 9. Well Number<br>100S  |
| 4. Location of Well<br>1065' FSL, 1605' FEL<br><br>Latitude 36° 56.8315'N, Longitude 107° 31.9338'W   | 10. Field, Pool, Wildcat<br>Basin Fruitland Coal  | 11. Sec., Twn, Rge, Mer. (NMPM)<br>0 Sec. 26, T-32-N, R-7-W<br>API # 30-045-31873 |
| 14. Distance in Miles from Nearest Town<br>Ignacio 20 miles, Allison 8 miles                          | 12. County<br>San Juan  | 13. State<br>NM   |
| 15. Distance from Proposed Location to Nearest Property or Lease Line<br>1065'                        | 17. Acres Assigned to Well<br>320 5/2   |   |
| 16. Acres in Lease  | 17. Acres Assigned to Well  |   |
| 18. Distance from Proposed Location to Nearest Well, Drlg, Compl, or Applied for on this Lease<br>20' | 20. Rotary or Cable Tools<br>Rotary   |   |
| 19. Proposed Depth<br>3639'   | 22. Approx. Date Work will Start  |   |
| 21. Elevations (DF, FT, GR, Etc.)<br>6729' GR   | 22. Approx. Date Work will Start  |   |
| 23. Proposed Casing and Cementing Program<br>See Operations Plan attached                             | 24. Authorized by: <u><i>Regina Case</i></u><br>Regulatory/Compliance Supervisor Date <u>8-8-03</u> |   |

PERMIT NO. \_\_\_\_\_ APPROVAL DATE \_\_\_\_\_  
APPROVED BY /s/ David J. Mankiewicz TITLE \_\_\_\_\_ DATE SEP 26 2003

Archaeological Report to be submitted

Threatened and Endangered Species Report to be submitted

NOTE: This format is issued in lieu of U.S. BLM Form 3160-3

Title 18 U.S.C. Section 1001, makes it a crime for any person knowingly and willfully to make to any department or agency of the United States any false, fictitious or fraudulent statements or presentations as to any matter within its jurisdiction.

DRILLING OPERATIONS AUTHORIZED ARE  
SUBJECT TO COMPLIANCE WITH ATTACHED  
"GENERAL REQUIREMENTS".

This action is subject to technical and  
procedural review pursuant to 43 CFR 3165.3  
and appeal pursuant to 43 CFR 3165.4

NMOCD

District I  
PO Box 1980, Hobbs, NM 88241-1980

District II  
PO Drawer 00, Artesia, NM 88211-0719

District III  
1000 Rio Brazos Rd., Aztec, NM 87410

District IV  
PO Box 2088, Santa Fe, NM 87504-2088

State of New Mexico  
Energy, Minerals & Natural Resources Department

OIL CONSERVATION DIVISION  
PO Box 2088  
Santa Fe, NM 87504-2088

Form C-102  
Revised February 21, 1994  
Instructions on back  
Submit to Appropriate District Office  
State Lease - 4 Copies  
Fee Lease - 3 Copies

☐ AMENDED REPORT

WELL LOCATION AND ACREAGE DEDICATION PLAT

|                         |  |                                    |
|-------------------------|--|------------------------------------|
| *API Number<br>30-045-  | *Pool Code<br>71629  | *Pool Name<br>Basin Fruitland Coal |
| *Property Code<br>18486 | *Property Name<br>BURNT MESA                                 | *Well Number<br>100S               |
| *OGRID No.<br>14538     | *Operator Name<br>BURLINGTON RESOURCES OIL & GAS COMPANY, LP | *Elevation<br>6729'                |

<sup>10</sup> Surface Location

| UL or lot no. | Section | Township | Range | Lot Idn | Feet from the | North/South line | Feet from the | East/West line | County   |
|---------------|---------|----------|-------|---------|---------------|------------------|---------------|----------------|----------|
| 0             | 26      | 32N      | 7W    |         | 1065          | SOUTH            | 1605          | EAST           | SAN JUAN |

<sup>11</sup> Bottom Hole Location If Different From Surface

| UL or lot no.                          | Section | Township | Range | Lot Idn | Feet from the                 | North/South line | Feet from the                    | East/West line | County                  |
|--|---------|----------|-------|---------|-------------------------------|------------------|----------------------------------|----------------|-------------------------|
|  |         |          |       |         |                               |                  |                                  |                |                         |
| <sup>12</sup> Dedicated Acres<br>S/320 |         |          |       |         | <sup>13</sup> Joint or Infill |                  | <sup>14</sup> Consolidation Code |                | <sup>15</sup> Order No. |

NO ALLOWABLE WILL BE ASSIGNED TO THIS COMPLETION UNTIL ALL INTERESTS HAVE BEEN CONSOLIDATED  
OR A NON-STANDARD UNIT HAS BEEN APPROVED BY THE DIVISION

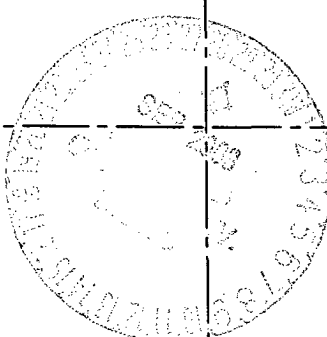
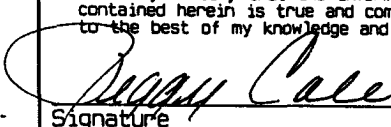
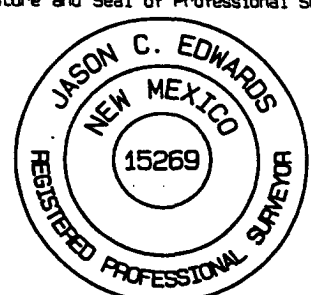
|   |          |   |   |
|---|----------|---|---|
| <sup>16</sup> RECEIVED<br>2002 AUG 22 PM 2:01<br>070 Farmington, NM | 5351.94' |  | <sup>17</sup> OPERATOR CERTIFICATION<br>I hereby certify that the information contained herein is true and complete to the best of my knowledge and belief.<br><br>Signature<br>Peggy Cole<br>Printed Name<br>Regulatory Supervisor<br>Title<br>8-8-03<br>Date   |
|   | 2639.34' |   |   |
| 5160.54'  | 26       | USA NM-2995   | <sup>18</sup> SURVEYOR CERTIFICATION<br>I hereby certify that the well location shown on this plat was plotted from field notes of actual surveys made by me or under my supervision, and that the same is true and correct to the best of my belief.<br>Survey Date: AUGUST 22, 2002<br>Signature and Seal of Professional Surveyor<br><br>JASON C. EDWARDS<br>Certificate Number 15269 |
| 1050'   | 1550'    | 1605'   |   |
|   | 1065'    | LAT: 36°56.8315' N<br>LONG: 107°31.9338' W  |   |
|   | 5312.34' |   |   |

# OPERATIONS PLAN

**Well Name:** Burnt Mesa #100S  
**Location:** 1065' FSL, 1605' FEL Section 26, T-32-N, R-7-W  
Latitude 36° 56.8315'N, Longitude 107° 31.9338'W  
San Juan County, NM  
**Formation:** Basin Fruitland Coal  
**Elevation:** 6729' GR

| Formation:      | Top      | Bottom | Contents |
|-----------------|----------|--------|----------|
| Surface         | San Jose | 2549'  |          |
| Ojo Alamo       | 2549'    | 2668'  | aquifer  |
| Kirtland        | 2668'    | 3103'  |          |
| Fruitland       | 3103'    | 3380'  |          |
| Intermediate TD | 3350'    |        |          |
| Fruitland Coal  | 3380'    | 3639'  | gas      |
| B/Basal Coal    | 3639'    | 3640'  | gas      |
| Total Depth     | 3639'    |        |          |
| Pictured Cliffs | 3640'    |        |          |

**Logging Program:** none  
**Mudlog:** from 7" to TD  
**Coring Program:** none

## **Mud Program:**

| Interval   | Type          | Weight  | Vis.  | Fluid Loss |
|------------|---------------|---------|-------|------------|
| 0- 200'    | Spud          | 8.4-9.0 | 40-50 | no control |
| 200-3350'  | Non-dispersed | 8.4-9.0 | 30-60 | no control |
| 3350-3639' | Air/Mist      |         |       |            |

## **Casing Program (as listed, the equivalent, or better):**

| Hole Size | Depth Interval | Csg. Size | Wt.   | Grade |
|-----------|----------------|-----------|-------|-------|
| 12 1/4"   | 0' - 200'      | 9 5/8"    | 32.3# | H-40  |
| 8 3/4"    | 0' - 3350'     | 7"        | 20.0# | J-55  |
| 6 1/4"    | 3350' - 3639'  | open hole |       |       |

## **Alternate Casing Program (as listed, the equivalent, or better):**

| Hole Size | Depth Interval | Csg. Size | Wt.   | Grade |
|-----------|----------------|-----------|-------|-------|
| 12 1/4"   | 0' - 200'      | 9 5/8"    | 32.3# | H-40  |
| 8 3/4"    | 0' - 3350'     | 7"        | 20.0# | J-55  |
| 6 1/4"    | 3310' - 3639'  | 5 1/2"    | 15.5# | J-55  |

## **Tubing Program:**

|            |        |      |      |
|------------|--------|------|------|
| 0' - 3639' | 2 3/8" | 4.7# | J-55 |
|------------|--------|------|------|

**Float Equipment:** 9 5/8" surface casing - saw tooth guide shoe. Centralizers will be run in accordance with Onshore Order #2.

7" intermediate casing - guide shoe and self-fill float collar. Standard centralizers run every other joint above shoe. Two turbolizing type centralizers - one below and one into the base of the Ojo Alamo @ 2668'. Standard centralizers thereafter every fourth joint up to the base of the surface pipe.

**Wellhead Equipment:** 9 5/8" x 7" x 2 3/8" x 11" 2000 psi xmas tree assembly.

**Cementing:**

9 5/8" surface casing - cement with 44 sx Type III cement w/2% calcium chloride, 0.25 pps celloflake (63 cu.ft. of slurry, bring cement to surface through 3/4" line) or equivalent. WOC 24 hours for pre-set holes or 8 hours for conventionally set holes before pressure testing or drilling out from under surface casing.

7" intermediate casing - lead w/296 sacks Premium Lite with 3% calcium chloride, 5 pps LCM-1, and 1/4#/sack flocele, 0.4% FL-52, & 0.4% SMS. Tail with 90 sacks Type III cmt with 1% calcium chloride, 1/4#/sack flocele and 0.2% FL-52 (755 cu.ft., 50% excess to circulate to surface).

5 1/2" liner - will not be cemented if run.

Note: If open hole logs are run, cement volumes will be based on 25% excess over caliper volumes.

**BOP and tests:**

Surface to intermediate TD - 11" 2000 psi (minimum) double gate BOP stack (Reference Figure #1). Prior to drilling out surface casing, test rams to 600#/30 min.

Intermediate TD to Total Depth - 7 1/6" 2000 psi (minimum) double gate BOP stack (Reference Figure #2). Prior to drilling out intermediate casing, test blind rams and casing to 1500 psi for 30 minutes; all pipe rams and casing to 1500 psi for 30 minutes each.

From surface to TD - choke manifold (Reference Figure #3).

Pipe rams will be actuated at least once each day and blind rams actuated once each trip to test proper functioning. An upper kelly cock valve with handle and drill string safety valves to fit each drill string will be maintained and available on the rig floor.

**Additional information:**

- \* The Fruitland Coal formation will be completed.
- \* Anticipated pore pressure for the Fruitland is less than 500 psi.
- \* This gas is dedicated.
- \* The south half of section 26 is dedicated to the Fruitland Coal.

Date: 8-12-03

Drilling Engineer: James McCarthy

SAN JUAN DIVISION

September 5, 2003

**(Certified Mail – Return Receipt Requested)**

Re: Burnt Mesa #100S  
Basin Fruitland Coal  
1065'FSL, 1605'FEL Section 26, T-32-N, R-7-W  
San Juan County, New Mexico

**To the Affected Persons:**

Burlington Resources Oil & Gas Company LP is submitting the enclosed Application for Permit to Drill to the appropriate regulatory agency(s) for approval. This well is located inside the High Productivity Area of the Basin-Fruitland Coal Pool as indicated on the attached plat. Notice is being made pursuant to New Mexico Oil Conservation Commission Order R-8768-F dated July 17, 2003.

The affected parties have twenty (20) days from receipt of this notice in which to file with the District Office of the New Mexico Oil Conservation Division written objection to the proposed Application for Permit to Drill.

Sincerely,

Tammy Wenzel

**Tammy Wimsatt**  
**Regulatory Specialist**



UNITED STATES  
DEPARTMENT OF THE INTERIOR  
BUREAU OF LAND MANAGEMENT

APPLICATION FOR PERMIT TO DRILL, DEEPEN, OR PLUG BACK

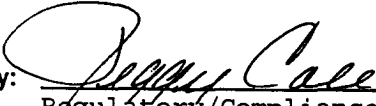
|   |  |
|---|--|
| 1a. Type of Work<br>DRILL   | 5. Lease Number<br>NMNM2995<br>Unit Reporting Number   |
| 1b. Type of Well<br>GAS   | 6. If Indian, All. or Tribe  |
| 2. Operator<br><b>BURLINGTON</b><br>RESOURCES Oil & Gas Company   | 7. Unit Agreement Name   |
| 3. Address & Phone No. of Operator<br>PO Box 4289, Farmington, NM 87499<br>(505) 326-9700   | 8. Farm or Lease Name<br>Burnt Mesa<br>9. Well Number<br>100S  |
| 4. Location of Well<br>1065' FSL, 1605' FEL<br>Latitude 36° 56.8315'N, Longitude 107° 31.9338'W   | 10. Field, Pool, Wildcat<br>Basin Fruitland Coal<br>11. Sec., Twn, Rge, Mer. (NMPM)<br>Sec. 26, T-32-N, R-7-W<br>API # 30-045- |
| 14. Distance in Miles from Nearest Town<br>Ignacio 20 miles, Allison 8 miles  | 12. County<br>San Juan<br>13. State<br>NM  |
| 15. Distance from Proposed Location to Nearest Property or Lease Line<br>1065'  |  |
| 16. Acres in Lease  | 17. Acres Assigned to Well<br>320  |
| 18. Distance from Proposed Location to Nearest Well, Drig, Compl, or Applied for on this Lease<br>20'   |  |
| 19. Proposed Depth<br>3639'   | 20. Rotary or Cable Tools<br>Rotary  |
| 21. Elevations (DF, FT, GR, Etc.)<br>6729' GR   | 22. Approx. Date Work will Start   |
| 23. Proposed Casing and Cementing Program<br>See Operations Plan attached   |  |
| 24. Authorized by: <u></u><br>Regulatory/Compliance Supervisor | Date <u>8-8-03</u>   |

PERMIT NO. \_\_\_\_\_ APPROVAL DATE \_\_\_\_\_  
APPROVED BY \_\_\_\_\_ TITLE \_\_\_\_\_ DATE \_\_\_\_\_

Archaeological Report to be submitted

Threatened and Endangered Species Report to be submitted

NOTE: This format is issued in lieu of U.S. BLM Form 3160-3

Title 18 U.S.C. Section 1001, makes it a crime for any person knowingly and willfully to make to any department or agency of the United States any false, fictitious or fraudulent statements or presentations as to any matter within its jurisdiction.

1980, Hobbs, NM 88241-1980

State of New Mexico  
Energy, Minerals & Natural Resources DepartmentForm C-102  
Revised February 21, 1994  
Instructions on back  
Submit to Appropriate District Office  
State Lease - 4 Copies  
Fee Lease - 3 CopiesDistrict II  
Drawer DD, Artesia, NM 88211-0719District III  
1000 Rio Brazos Rd., Aztec, NM 87410OIL CONSERVATION DIVISION  
PO Box 2088  
Santa Fe, NM 87504-2088District IV  
PO Box 2088, Santa Fe, NM 87504-2088☐ AMENDED REPORT

## WELL LOCATION AND ACREAGE DEDICATION PLAT

|                         |  |                                    |
|-------------------------|--|------------------------------------|
| *API Number<br>30-045-  | *Pool Code<br>71629  | *Pool Name<br>Basin Fruitland Coal |
| *Property Code<br>18486 | *Property Name<br>BURNT MESA                                 | *Well Number<br>100S               |
| *OGRID No.<br>14538     | *Operator Name<br>BURLINGTON RESOURCES OIL & GAS COMPANY, LP | *Elevation<br>6729'                |

<sup>10</sup> Surface Location

| UL or lot no. | Section | Township | Range | Lot Idn | Feet from the | North/South line | Feet from the | East/West line | County   |
|---------------|---------|----------|-------|---------|---------------|------------------|---------------|----------------|----------|
| 0             | 26      | 32N      | 7W    |         | 1065          | SOUTH            | 1605          | EAST           | SAN JUAN |

<sup>11</sup> Bottom Hole Location If Different From Surface

| UL or lot no. | Section | Township | Range | Lot Idn | Feet from the | North/South line | Feet from the | East/West line | County |
|---------------|---------|----------|-------|---------|---------------|------------------|---------------|----------------|--------|
|               |         |          |       |         |               |                  |               |                |        |

|  |                               |                                  |                         |
|--|-------------------------------|----------------------------------|-------------------------|
| <sup>12</sup> Dedicated Acres<br>S/320 | <sup>13</sup> Joint or Infill | <sup>14</sup> Consolidation Code | <sup>15</sup> Order No. |
|--|-------------------------------|----------------------------------|-------------------------|

NO ALLOWABLE WILL BE ASSIGNED TO THIS COMPLETION UNTIL ALL INTERESTS HAVE BEEN CONSOLIDATED  
OR A NON-STANDARD UNIT HAS BEEN APPROVED BY THE DIVISION

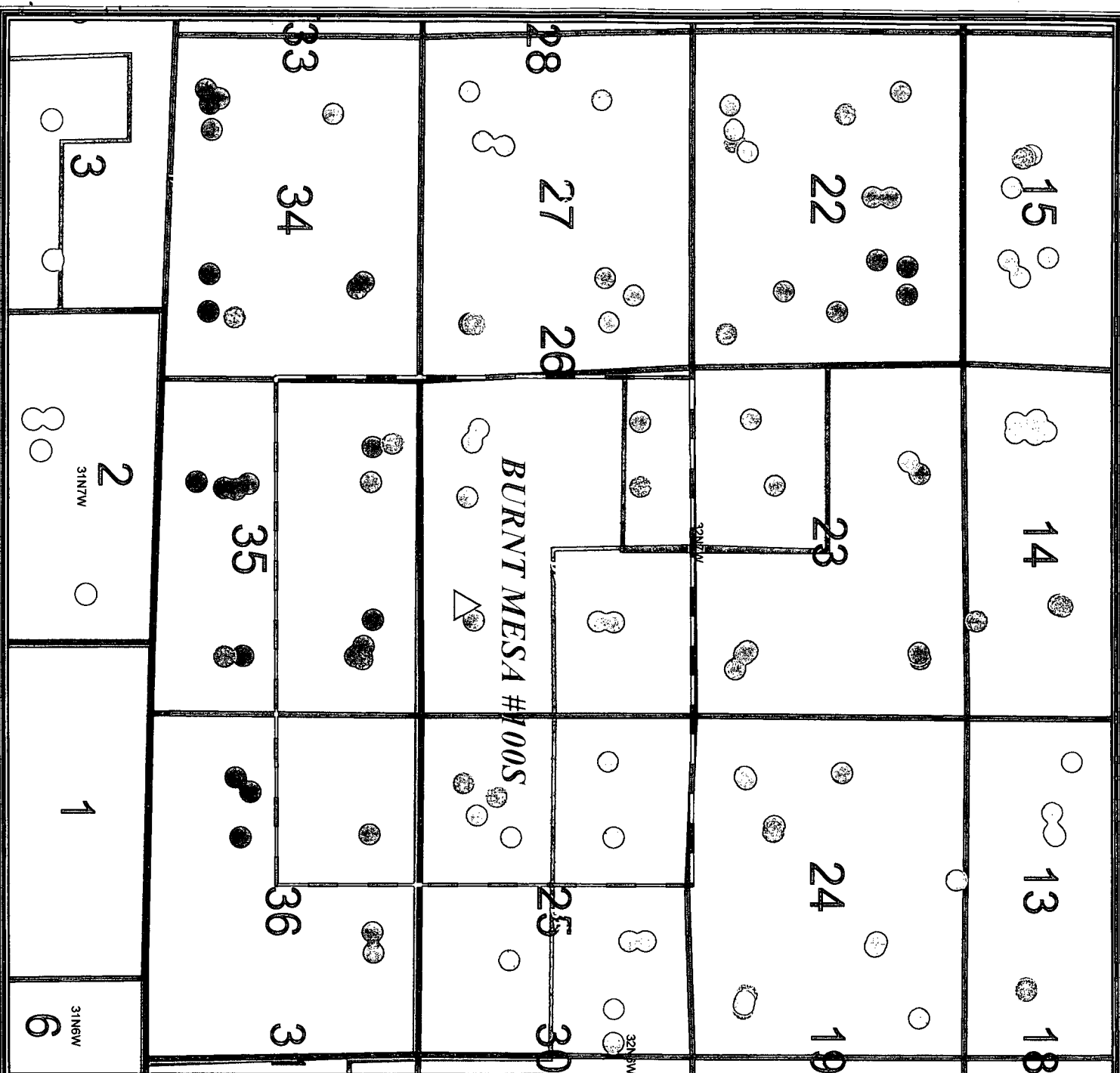

|                   |  |
|-------------------|--|
| <sup>16</sup><br> | <sup>17</sup> OPERATOR CERTIFICATION<br>I hereby certify that the information contained herein is true and complete to the best of my knowledge and belief.<br><br>Signature<br>Peggy Cole<br>Printed Name<br>Regulatory Supervisor<br>Title<br>8-8-03<br>Date   |
|                   | <sup>18</sup> SURVEYOR CERTIFICATION<br>I hereby certify that the well location shown on this plat was plotted from field notes of actual surveys made by me or under my supervision, and that the same is true and correct to the best of my belief.<br>Survey Date: AUGUST 22, 2002<br>Signature and Seal of Professional Surveyor<br><br>JASON C. EDWARDS<br>Certificate Number 15269 |



Legend

P2000 Well Header (sjd)

Current Operator

-  P2000 Well Header (sjd)
-  BURLINGTON
-  CONOCOPHILLIPS

BURLINGTON  
RESOURCES



PLAT

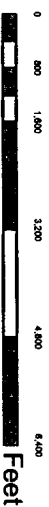

1:71,167.736 - 1" equals 5,930.645'

GCS North American 1927

**BURLINGTON RESOURCES**

*San Juan*

**BURNT MESA #100S**

Prepared By: lmc Date: 8/26/2003  
 File Number:                      Revised Date: 8/26/2003  
 File Name: c:\data\mine\Projects\32\_732\_7.mxd



**SENDER:**

- Complete items 1, 2 and 3.
- Indicate if restricted delivery is desired.
- Print your name and address on the reverse of this form so that we can return this card to you.
- Attach this form to the front of the mailpiece, or on the back if space does not permit.
- Write "Return Receipt Requested" on the mailpiece below the article number.
- The Return receipt Fee will provide you the signature of the person delivered to and the date of delivery.

I also wish to receive the following service (for an extra fee):

☐ **Restricted Delivery**

Consult postmaster for fee.

**1. Article Addressed to:**

ConocoPhillips Company  
Chief Landman San Jaun/Rockies  
PO Box 2197  
PO Box 2197  
Houston, TX 77252-2197

**2. Article Number**

7110 6605 9590 0006 8670

**3. Service Type** ☒ **CERTIFIED**

**Date of Delivery**

SEP 15 2003

**Received By: (Print Name)**

**Enter delivery address if different than item 1.**

**Signature - (Addressee or Agent)**

*[Signature]*

PS Form 3811

**DOMESTIC RETURN RECEIPT**

1:42 PM 8/26/2003

Code: FTC HPA Infill Burnt mesa File: \*1005