

UNITED STATES
DEPARTMENT OF THE INTERIOR
BUREAU OF LAND MANAGEMENT

RCVD OCT 23 '07
OIL CONS. DIV.
DIST. 3

APPLICATION FOR PERMIT TO DRILL, DEEPEN, OR PLUG BACK

1a. Type of Work DRILL	5. Lease Number SF-078200-B Unit Reporting Number	
1b. Type of Well GAS	6. If Indian, All. or Tribe	
2. Operator BURLINGTON RESOURCES Oil & Gas Company, LP	7. Unit Agreement Name	
3. Address & Phone No. of Operator PO Box 4289, Farmington, NM 87499 (505) 326-9700	8. Farm or Lease Name Riddle B 9. Well Number #5F	
4. Location of Well Unit H (SENE), 1880' FNL & 860' FEL, Latitude 36.799708'N Longitude 107.847772'W	10. Field, Pool, Wildcat Basin Dakota 11. Sec., Twn, Rge, Mer. (NMPM) Sec. 23, T30N, R10W API # 30-045- 34447	
14. Distance in Miles from Nearest Town 8.6 miles from Aztec, NM	12. County San Juan	13. State NM
15. Distance from Proposed Location to Nearest Property or Lease Line 860'	17. Acres Assigned to Well 315.98 E/2	
16. Acres in Lease 949.760 acres		
18. Distance from Proposed Location to Nearest Well, Drig, Compl, or Applied for on this Lease 54' from Riddle B 223		
19. Proposed Depth 7483'	20. Rotary or Cable Tools Rotary	
21. Elevations (DF, FT, GR, Etc.) 6268' GL	22. Approx. Date Work will Start	
23. Proposed Casing and Cementing Program See Operations Plan attached		
24. Authorized by: <u>Patsy Clugston</u> Patsy Clugston, Regulatory Specialist	Date <u>9/28/07</u>	

PERMIT NO. _____ APPROVAL DATE _____
APPROVED BY [Signature] TITLE AEIN DATE 10/22/07

Archaeological Report attached

Threatened and Endangered Species Report attached

NOTE: This format is issued in lieu of U.S. BLM Form 3160-3

Title 18 U.S.C. Section 1001, makes it a crime for any person knowingly and willfully to make to any department or agency of the United States any false, fictitious or fraudulent statements or presentations as to any matter within its jurisdiction.

Example Master Plan Type 3

Bond Numbers NMB-000015 and NMB-000089

BLM'S APPROVAL OR ACCEPTANCE OF THIS
ACTION DOES NOT RELIEVE THE LESSEE AND
OPERATOR FROM OBTAINING ANY OTHER
AUTHORIZATION REQUIRED FOR OPERATIONS
ON FEDERAL AND INDIAN LANDS

PRIOR TO CASING & CEMENT
NMOCB OCT 30 2007
DRILLING OPERATIONS AUTHORIZED ARE
SUBJECT TO COMPLIANCE WITH ATTACHED
"GENERAL REQUIREMENTS".

NOTIFY AZTEC OCD 24 HRS.
PRIOR TO CASING & CEMENT

DISTRICT I
1625 N. French Dr., Hobbs, N.M. 88240

DISTRICT II
1301 West Grand Avenue, Artesia, N.M. 88210

DISTRICT III
1000 Rio Brazos Rd., Aztec, N.M. 87410

DISTRICT IV
1220 S. St. Francis Dr., Santa Fe, NM 87505

State of New Mexico
Energy, Minerals & Natural Resources Department

OIL CONSERVATION DIVISION
1220 South St. Francis Dr.
Santa Fe, NM 87505

Form C-102
Revised October 12, 2005

Submit to Appropriate District Office
State Lease - 4 Copies
Fee Lease - 3 Copies

SEP 28 2007

Bureau of Land Management
District Office

☐ AMENDED REPORT

WELL LOCATION AND ACREAGE DEDICATION PLAT

*API Number 30-045- 34447	*Pool Code 71599	*Pool Name BASIN DAKOTA
*Property Code 7424 7427	*Property Name RIDDLE B	*Well Number 5F
*GRID No. 14538	*Operator Name BURLINGTON RESOURCES OIL AND GAS COMPANY LP	*Elevation 6268'

10 Surface Location

UL or lot no.	Section	Township	Range	Lot Idn	Feet from the	North/South line	Feet from the	East/West line	County
H	23	30-N	10-W	8	1880'	NORTH	860'	EAST	SAN JUAN

11 Bottom Hole Location If Different From Surface

UL or lot no.	Section	Township	Range	Lot Idn	Feet from the	North/South line	Feet from the	East/West line	County
H									

*Dedicated Acres DK- 315.98 E/2	*Joint or Infill	*Consolidation Code	*Order No.
------------------------------------	------------------	---------------------	------------

NO ALLOWABLE WILL BE ASSIGNED TO THIS COMPLETION UNTIL ALL INTERESTS HAVE BEEN CONSOLIDATED
OR A NON-STANDARD UNIT HAS BEEN APPROVED BY THE DIVISION

16

LOT 4	LOT 3	LOT 2	LOT 1
LOT 5	LOT 6	LOT 7	LOT 8
LOT 12	LOT 11	LOT 10	LOT 9
LOT 13	LOT 14	LOT 15	LOT 16

23

USA SF-078200 -B

LAT: 36°47.9822' N.
LONG: 107°50.8292' W.
NAD 1927

LAT: 36.799708° N.
LONG: 107.847772° W.
NAD 1983

17 OPERATOR CERTIFICATION

I hereby certify that the information contained herein is true and complete to the best of my knowledge and belief, and that this organization either owns a working interest or unleased mineral interest in the land including the proposed bottom hole location or has a right to drill this well at this location pursuant to a contract with an owner of such a mineral or a working interest, or to a voluntary pooling agreement or a compulsory pooling order heretofore entered by the division.

Patsy Clugston
Signature
Patsy Clugston 7/26/07
Printed Name

18 SURVEYOR CERTIFICATION

I hereby certify that the well location shown on this plat was plotted from field notes of actual surveys made by me or under my supervision, and that the same is true and correct to the best of my belief.

7-
Date of Survey
Signature and Seal of Professional Surveyor
15703
Certificate Number 15703

District I

Energy, Minerals and Natural Resources

May 27, 2004

1625 N. French Dr., Hobbs, NM 88240

District II

1301 W. Grand Ave., Artesia, NM 88210

District III

1000 Rio Brazos Rd., Aztec, NM 87410

District IV

1220 S. St. Francis Dr., Santa Fe, NM 87505

OIL CONSERVATION DIVISION

1220 South St. Francis Dr.
Santa Fe, NM 87505

WELL API NO.

30-045-34447

5. Indicate Type of Lease

STATE ☐

FEE ☐

6. State Oil & Gas Lease No.

Federal Lease - SF-078200-B

7. Lease Name or Unit Agreement Name

Riddle B

8. Well Number

#5F

9. OGRID Number

14538

10. Pool name or Wildcat

Basin Dakota

SUNDRY NOTICES AND REPORTS ON WELLS
(DO NOT USE THIS FORM FOR PROPOSALS TO DRILL OR TO DEEPEN OR PLUG BACK TO A
DIFFERENT RESERVOIR USE "APPLICATION FOR PERMIT" (FORM C-101) FOR SUCH
PROPOSALS)

1. Type of Well:

Oil Well ☐

Gas Well ☒

Other ☐

2. Name of Operator

BURLINGTON RESOURCES OIL & GAS, LP

3. Address of Operator

3401 E. 30TH STREET, FARMINGTON, NM 87402

4. Well Location

Unit Letter H : 1880 feet from the North line and 860 feet from the East line
Section 23 Township 30N Rng 10W NMPM County San Juan

11. Elevation (Show whether DR, RKB, RT, GR, etc.)

6268' GL

Pit or Below-grade Tank Application

☐ or Closure ☐

Pit type New Drill

Depth to Groundwater

>100'

Distance from nearest fresh water well

<1000'

Distance from nearest surface water

<1000'

Pit Liner Thickness:

12

mil

Below-Grade Tank:

Volume

bbls;

Construction Material

12. Check Appropriate Box to Indicate Nature of Notice, Report or Other Data

NOTICE OF INTENTION TO:

PERFORM REMEDIAL WORK ☐

TEMPORARILY ABANDON ☐

PULL OR ALTER CASING ☐

PLUG AND ABANDON ☐

CHANGE PLANS ☐

MULTIPLE COMPL ☐

SUBSEQUENT REPORT OF:

REMEDIAL WORK ☐

COMMENCE DRILLING OPNS. ☐

CASING/CEMENT JOB ☐

ALTERING CASING ☐

P AND A ☐

OTHER:

New Drill

☒

OTHER:

☐

13. Describe proposed or completed operations. (Clearly state all pertinent details, and give pertinent dates, including estimated date of starting any proposed work). SEE RULE 1103. For Multiple Completions: Attach wellbore diagram of proposed completion or recompletion.

New Drill, Lined:

Burlington Resources proposes to construct a new drilling pit, an associated vent/flare pit and a pre-set mud pit (if required). Based on Burlington's interpretation of the Ecosphere's risk ranking criteria, the new drilling pit and pre-set mud pit will be lined pits as detailed in Burlington's Revised Drilling / Workover Pit Construction / Operation Procedures dated November 11, 2004 on file at the NMOCD office. A portion of the vent/flare pit will be designed to manage fluids and that portion will be lined as per the risk ranking criteria. Burlington Resources anticipates closing these pits according to the Drilling / Workover Pit Closure Procedure dated August 2, 2004 on file at the NMOCD office.

I hereby certify that the information above is true and complete to the best of my knowledge and belief. I further certify that any pit or below-grade tank has been/will be constructed or closed according to NMOCD guidelines ☐, a general permit ☒ or an (attached) alternative OCD-approved plan ☐.

SIGNATURE

Patsy Clugston

TITLE

Regulatory Specialist

DATE

9/28/2007

Type or print name

Patsy Clugston

E-mail address:

clugspl@conocophillips

Telephone No.

505-326-9518

For State Use Only

APPROVED BY

[Signature]

TITLE

Deputy Oil & Gas Inspector,
District #3

DATE

OCT 30 2007

Conditions of Approval (if any):



WELL NAME Riddle B #5F LEGALS H-23-30-10 COUNTY San Juan

PURPOSED C.P. SYSTEM: Drill GB on S edge of location (S side of existing). Set up grade rectifier NE edge of location. Tie new and old GB to new rectifier, trenching approx 300' of positive cable from GB's to rectifier. Trench approx 120' of #8 neg. from existing well (Ridge E. 33") to rectifier. Trench approx 210' from proposed well to rectifier.

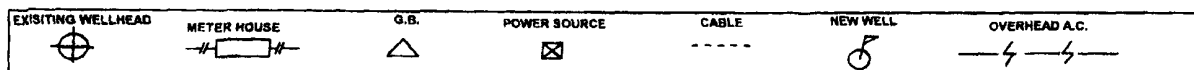
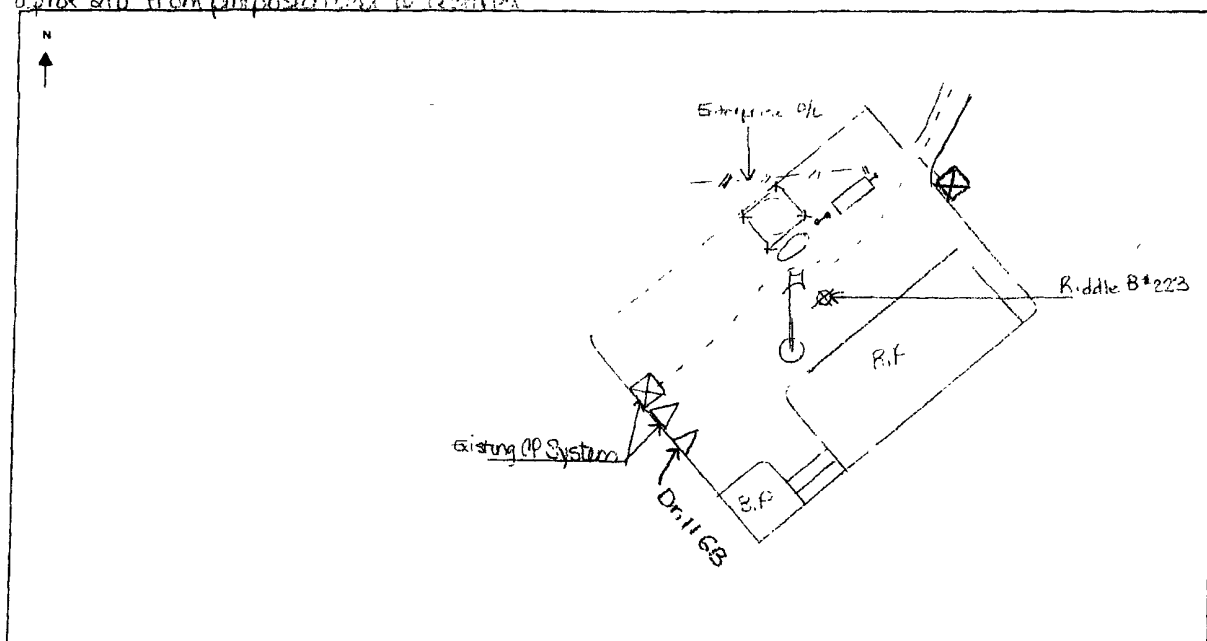

COMMENTS: UGAC to existing facilities not changed

NEAREST POWER SOURCE: Eastern Reef on Middle E #223 DISTANCE: same pool
PIPELINES IN AREA: Enterprise, PTC

TECHNICIAN: M. J. Hines **DATE:** 9/27/07

6 CR 5412 BLOOMFIELD, N.M. 87413
OFFICE: 505-634-0271 CELL: 505-793-6953

PROJECT PROPOSAL - New Drill / Sidetrack

San Juan Business Unit

RIDDLE B 5F

DEVELOPMENT

Lease:		AFE #: WAN.CDR.7279		AFE \$: 629,901.10	
Field Name: hBR_SAN JUAN		Rig: H&P Rig 282		State: NM	County: SAN JUAN
Geologist:		Phone:		Geophysicist:	
Geoscientist: Head, Chip F		Phone: 505-326-9772		Prod. Engineer:	
Res. Engineer: Prabowo, Wahyu		Phone: 505-326-9797		Proj. Field Lead:	
Primary Objective (Zones):					
Zone	Zone Name				
FRR	BASIN DAKOTA (PRORATED GAS)				

Location:		Datum Code: NAD 27		Height: 1015	
Latitude: 36.799700	Longitude: -107.847153	X:	Y:	Section: 23	Range: 010W
Footage X: 860 FEL	Footage Y: 1880 FNL	Elevation: 6268	(FT)	Township: 030N	
Tolerance:					

Location Type: Year Round	Start Date (Est.): 1/1/2008	Completion Date:	Date In Operation:
Formation Data: Assume KB = 6284 Units = FT			

Formation Call & Casing Points	Depth (TVD in Ft)	SS (Ft)	Depletion (Yes/No)	BHP (PSIG)	BHT	Remarks
Surface Casing	200	6084	<input type="checkbox"/>			12-1/4 hole. 200' 9 5/8" 32.3 ppf, H-40, STC casing. Cement with 159 cuft. Circulate cement to surface.
OJAM	1637	4647	<input type="checkbox"/>			
KRLD	1729	4555	<input type="checkbox"/>			
FRLD	2432	3852	<input type="checkbox"/>			Possible Gas
PCCF	2890	3394	<input type="checkbox"/>			
LEWS	2963	3321	<input type="checkbox"/>			
Intermediate Casing	3063	3221	<input type="checkbox"/>			8 3/4" Hole. 7", 20 ppf, J-55, STC Casing. Cement with 690cuft. Circulate cement to surface.
CHRA	3897	2387	<input type="checkbox"/>			
MASSIVE CLIFF HOUSE	4503	1781	<input type="checkbox"/>			Gas
MENF	4673	1611	<input type="checkbox"/>			
PTLK	5133	1151	<input type="checkbox"/>			
MNCS	5533	751	<input type="checkbox"/>			
GLLP	6411	-127	<input type="checkbox"/>			
GRHN	7148	-864	<input type="checkbox"/>			
GRRS	7201	-917	<input type="checkbox"/>			
TWLS	7251	-967	<input type="checkbox"/>	2000		Gas
PAGU	7347	-1063	<input type="checkbox"/>			
CBRL	7399	-1115	<input type="checkbox"/>			
ENCINAL	7443	-1159	<input type="checkbox"/>			TD 40' below T/ENCN
TOTAL DEPTH DK	7483	-1199	<input type="checkbox"/>			6-1/4" Hole. 4-1/2", 10.5/11.6 ppf, J-55 STC/LTC casing. Cement with 601 cuft. Circulate cement a minimum of 100' inside the previous casing string.

Reference Wells:		
Reference Type	Well Name	Comments
Intermediate	Riddle 2B	NE 23-30N-10W
Intermediate	Riddle B 5E	NE 23-30N-10W

PROJECT PROPOSAL - New Drill / Sidetrack

RIDDLE B 5F
DEVELOPMENT
Logging Program:

Intermediate Logs: ☐ Log only if show ☐ GR/ILD ☐ Triple Combo

TD Logs: ☐ Triple Combo ☐ Dipmeter ☐ RFT ☐ Sonic ☐ VSP ☐ TDT ☒ Other

GR_CBL, MUDLOG 100' above GRHN to TD

Additional Information:

Log Type	Stage	From (Ft)	To (Ft)	Tool Type/Name	Remarks
----------	-------	-----------	---------	----------------	---------

Comments: Location/Tops/Logging - DKNM030N010W23NE2 Avoid G, twin Riddle B 2 (MV) in unit H (1st choice) or Riddle B 2B (MV in unit B (2nd choice) else prefer H,B,A, do not twin Riddle B 4 (PC). MUDLOG 100' above GRHN to TD

Zones - DKNM030N010W23NE2

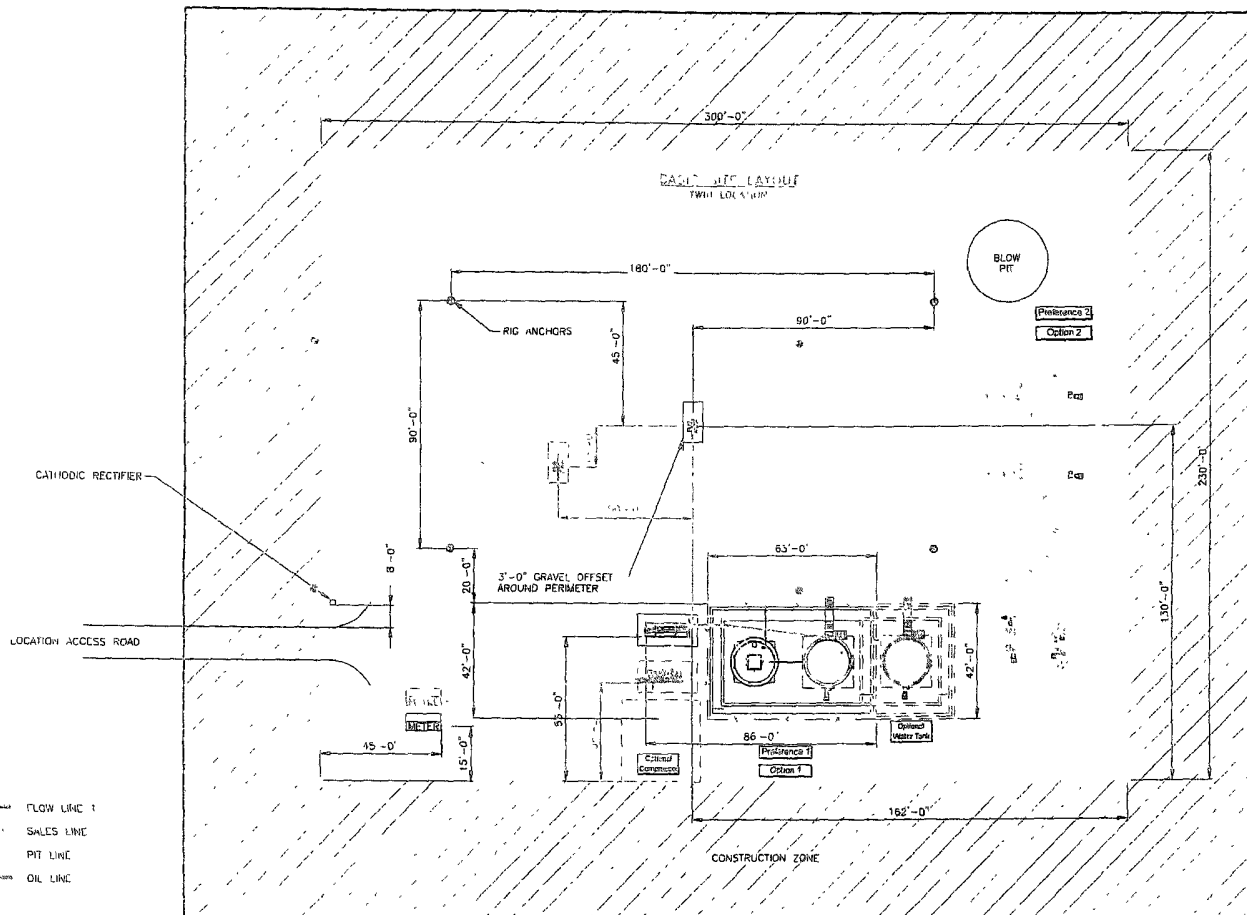

SEE SHEET 2 OF 5 FOR PIPING DETAILS
ALL UNDERGROUND PIPING IS TO BE BURIED A MIN OF 3'-0" TO 10'

SHEET 1 OF 5

ENGINEERING REVIEW										REFERENCE DRAWINGS			CONOCO-PHILLIPS HIGH PRESSURE 3 PHASE FACILITY DIAGRAM- SITE LAYOUT		
DESCRIPTION	DATE	BY	CHECKED	ENG	DISC	PM	DISCUSS	REVIEWED	DATE	NO	DESCRIPTION		CLIENT NO	CLIENT ADDR	ISSUE DATE
													SCALE HERE	SCALE HERE	CREATION DATE 6/20/07
													DATE	DATE	SHEET No
													HP3PHASE-REV1		1 OF 5

Address: C:\p00\Nuclos\Andrew\Regulatory\Yum Location Site Layout.dwg, 06/20/2007 - 02:39pm

RIDDLE B 5F, 1880' FNL & 860' FEL

[illegible]

LAT: 36° 47.9822' N LONG: 107° 50.8292' W NAD27

NOTE: VECTOR SURVEYS LLC IS NOT LIABLE FOR UNDERGROUND UTILITIES OR PIPELINES. CONTRACTOR SHOULD CALL ONE-CALL FOR LOCATION OF ANY MARKED OR UNMARKED BURIED PIPELINES OR CABLES ON WELL PAD AND OR ACCESS ROAD AT LEAST TWO (2) WORKING DAYS PRIOR TO CONSTRUCTION.

BURLINGTON RESOURCES OIL & GAS COMPANY LP
 RIDDLE B 5F, 1880' FNL & 860' FEL
 SECTION 23, T-30-N, R-10-W, NMPM, SAN JUAN COUNTY, NM
 GROUND ELEVATION: 6268', DATE: JULY 10, 2007

ELEV. A'-A

C/L

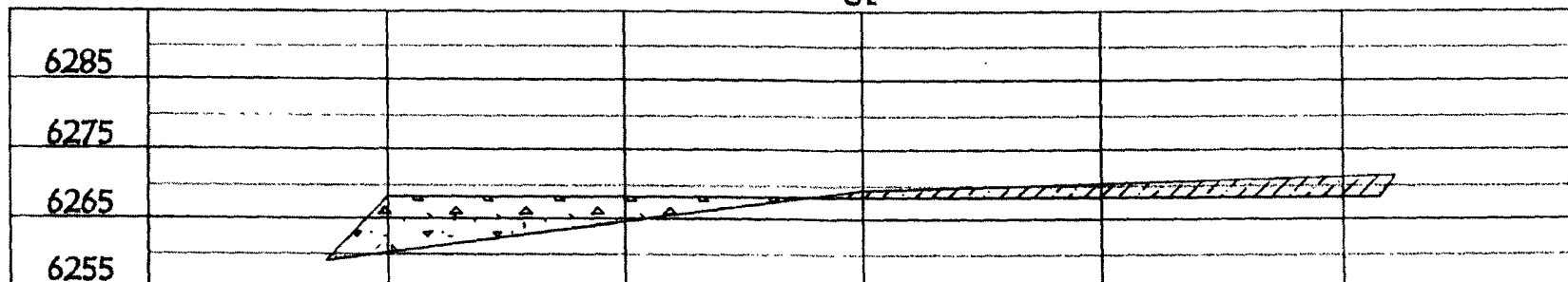

ELEV. B'-B

C/L

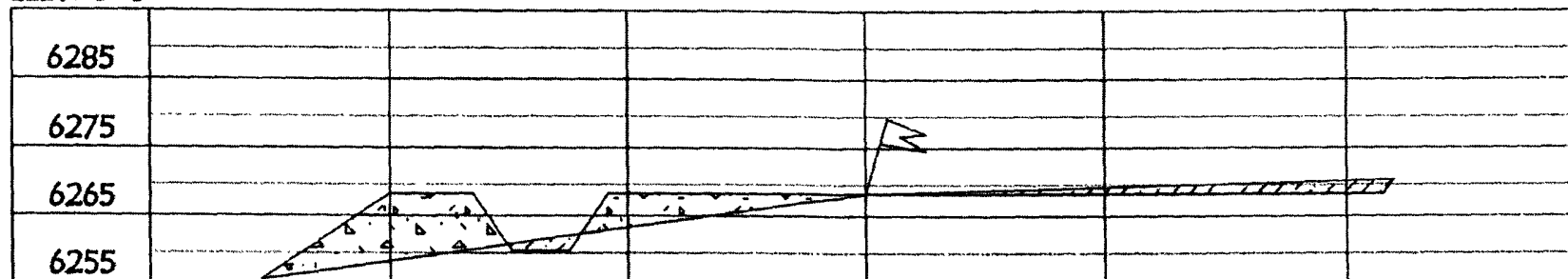

ELEV. C'-C

C/L

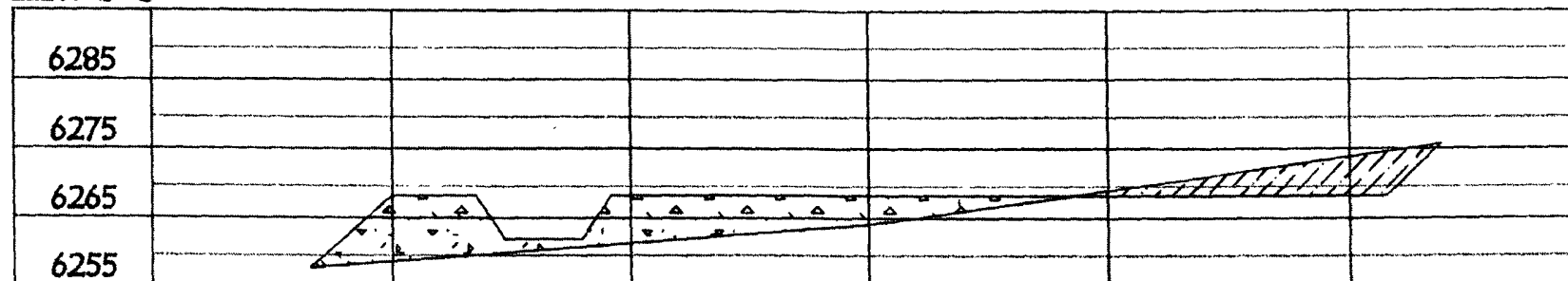

NOTE: VECTOR SURVEYS LLC IS NOT LIABLE FOR UNDERGROUND UTILITIES OR PIPELINES.
 CONTRACTOR SHOULD CALL ONE-CALL FOR LOCATION OF ANY MARKED OR UNMARKED BURIED
 PIPELINES OR CABLES ON WELL PAD AND OR ACCESS ROAD AT LEAST TWO (2) WORKING DAYS PRIOR TO CONSTRUCTION.