

UNITED STATES  
DEPARTMENT OF THE INTERIOR  
BUREAU OF LAND MANAGEMENT

FORM APPROVED  
OMB No 1004-0135  
Expires November 30, 2000

**SUNDRY NOTICES AND REPORTS ON WELLS**  
*Do not use this form for proposals to drill or to re-enter an  
Abandoned well Use Form 3160-3 (APD) for such proposals.*

5 Lease Serial No  
**SF - 078902**

6 If Indian, Allottee or tribe Name

7 If Unit or CA/Agreement, Name and/or No

**SUBMIT IN TRIPLICATE - Other instructions on reverse side**

**RECEIVED**  
**OCT 24 2007**

1 Type of Well  
☐ Oil Well ☒ Gas Well ☐ Other

8 Well Name and No  
Bureau of Land Management  
Farmington Field Office  
**GCU 147E & GCU 355**

2 Name of Operator  
**BP America Production Company Attn: Toya Colvin**

9 API Well No.  
**30-045-26283 & 30-045-26440**

3a Address  
**P.O. Box 3092 Houston, TX 77253**

3b Phone No (include area code)  
**281-366-7148**

10 Field and Pool, or Exploratory Area  
**BASIN DAKOTA & W. KUTZ PICTURED CLIFFS**

4 Location of Well (Footage, Sec., T., R., M., or Survey Description)  
**GCU 147E - 1850' FSL & 1700' FWL GCU 355 - 1735' FSL & 1755' FWL Sec 4  
T27N R12W**

11 County or Parish, State  
**San Juan County, New Mexico**

**12 CHECK APPROPRIATE BOX(ES) TO INDICATE NATURE OR NOTICE, REPORT, OR OTHER DATA**

**TYPE OF SUBMISSION**

☒ Notice of Intent

Subsequent Report

☐ Final Abandonment Notice

**TYPE OF ACTION**

☐ Acidize

☐ Deepen

☐ Production (Start/Resume)

☐ Water shut-Off

☐ Alter Casing

☐ Fracture Treat

☐ Reclamation

☐ Well Integrity

☐ Casing Repair

☐ New Construction

☐ Recomplete

☐ Change Plans

☐ Plug and Abandon

☐ Water Disposal

☐ Convert to Injection

☐ Plug Back

Other

Surface Commingle

13 Describe Proposed or Completed Operation (clearly state all pertinent details, including estimated starting date of any proposed work and approximate duration thereof. If the proposal is to deepen directionally or recomplate horizontally, give subsurface locations and measured and true vertical depths of all pertinent markers and zones. Attach the Bond under which the work will be performed or provide the Bond No. on file with BLM/BIA. Required subsequent reports shall be filed within 30 days following completion of the involved operations. If the operation results in a multiple completion or recompletion in a new interval, a Form 3160-4 shall be filed once testing has been completed. Final Abandonment Notices shall be filed only after all requirements, including reclamation, have been completed, and the operator has determined that the site is ready for final inspection. BP America Production Company respectfully request authorization to surface commingle gas production from Basin Dakota & W. Kutz Pictured Cliffs from our GCU 147E & GCU 355. Surface commingling Basin DK production will consist of the GCU 147E API 30-045-26283. W. Kutz Pictured Cliffs production will be from the GCU 355 API 30-045-26440. The production from each well will be separated prior to the allocation meter. Production from each well will be metered prior to being commingled. The commingled production will then be sent through compression prior to entering the sales meter.

The difference between what is measured prior to commingling and what is sold through the sales meter is the fuel usage. This fuel usage is allocated back to each well based on the well production.

The working interest, royalty and overriding royalty interest owners in the subject wells are different however approval of Order R-12724 allows surface commingling in the GCU without notification. The proposed commingling of production is to reduce operating expenses between the wells and will result in increased economic life of the wells. Surface commingling will not reduce the life of the wells.

Attached in support of our application are copies of documentation submitted to the NMOCD for State approval.

14 I hereby certify that the foregoing is true and correct  
Name (Printed/typed)

**Toya Colvin**

Title Regulatory Analyst

**RCVD DEC 27 '07**  
**OIL CONS. DIV.**  
**DIST. 3**

Signature

*Toya Colvin*

Date 10/23/2007

**THIS SPACE FOR FEDERAL OR STATE OFFICE USE**

Approved by

*[Signature]*

Title

*Peter Eng*

Date

*12/20/07*

Conditions of approval, if any, are attached. Approval of this notice does not warrant or Certify that the applicant holds legal or equitable title to those rights in the subject lease which would entitle the applicant to conduct operations thereon.

Office

Title 18 U.S.C. Section 1001 and Title 43 U.S.C. Section 1212, make it a crime for any person knowingly and willfully to make to any department or agency of the United States any false, fictitious or fraudulent statements or representations as to any matter within its jurisdiction.

**NMOCD**

District I  
1625 N French Drive, Hobbs, NM 88240  
District II  
1301 W Grand Ave, Artesia, NM 88210  
District III  
1000 Rio Brazos Road, Aztec, NM 87410  
District IV  
1220 S St Francis Dr, Santa Fe, NM  
87505

State of New Mexico  
Energy, Minerals and Natural Resources Department

Form C-107-B  
Revised June 10, 2003

### OIL CONSERVATION DIVISION

1220 S. St Francis Drive  
Santa Fe, New Mexico 87505

Submit the original  
application to the Santa Fe  
office with one copy to the  
appropriate District Office.

#### APPLICATION FOR SURFACE COMMINGLING (DIVERSE OWNERSHIP)

OPERATOR NAME: **BP America Production Company**

OPERATOR ADDRESS: **P O Box 3092 Houston, TX 77253**

APPLICATION TYPE:

☒ Pool Commingling ☐ Lease Commingling ☐ Pool and Lease Commingling ☐ Off-Lease Storage and Measurement (Only if not Surface Commingled)

LEASE TYPE: ☐ Fee ☐ State ☒ Federal

Is this an Amendment to existing Order? ☐ Yes ☒ No If "Yes", please include the appropriate Order No. \_\_\_\_\_

Have the Bureau of Land Management (BLM) and State Land office (SLO) been notified in writing of the proposed commingling  
☒ Yes ☐ No

#### (A) POOL COMMINGLING

Please attach sheets with the following information

(1) Pool Names and Codes	Gravities / BTU of Non-Commingled Production	Calculated Gravities / BTU of Commingled Production		Calculated Value of Commingled Production	Volumes
<b>Basin Dakota (GCU 147E)</b>	<b>1148 BTU</b>	<b>1148 BTU</b>		<b>5</b>	<b>5</b>
<b>Picture Cliffs (GCU 355)</b>	<b>1155 BTU</b>	<b>1155 BTU</b>		<b>772</b>	<b>772</b>

(2) Are any wells producing at top allowables? ☐ Yes ☒ No

(3) Has all interest owners been notified by certified mail of the proposed commingling? ☐ Yes ☒ No (Order R-12724 No Notice Required)

(4) Measurement type: ☒ Metering ☐ Other (Specify)

(5) Will commingling decrease the value of production? ☐ Yes ☒ No If "yes", describe why commingling should be approved

#### (B) LEASE COMMINGLING

Please attach sheets with the following information

(1) Pool Name and Code

(2) Is all production from same source of supply? ☐ Yes ☐ No

(3) Has all interest owners been notified by certified mail of the proposed commingling? ☐ Yes ☐ No

(4) Measurement type ☐ Metering ☐ Other (Specify)

#### (C) POOL and LEASE COMMINGLING

Please attach sheets with the following information

(1) Complete Sections A and E

#### (D) OFF-LEASE STORAGE and MEASUREMENT

Please attached sheets with the following information

(1) Is all production from same source of supply? ☐ Yes ☐ No

(2) Include proof of notice to all interest owners

#### (E) ADDITIONAL INFORMATION (for all application types)

Please attach sheets with the following information

(1) A schematic diagram of facility, including legal location.

(2) A plat with lease boundaries showing all well and facility locations. Include lease numbers if Federal or State lands are involved

(3) Lease Names, Lease and Well Numbers, and API Numbers

I hereby certify that the information above is true and complete to the best of my knowledge and belief

SIGNATURE: Toya Colvin TITLE Regulatory Analyst DATE 10/23/07

TYPE OR PRINT NAME Toya Colvin TELEPHONE NO 281-366-7148

E-MAIL ADDRESS: toya.colvin@bp.com

# GCU Shared Compression

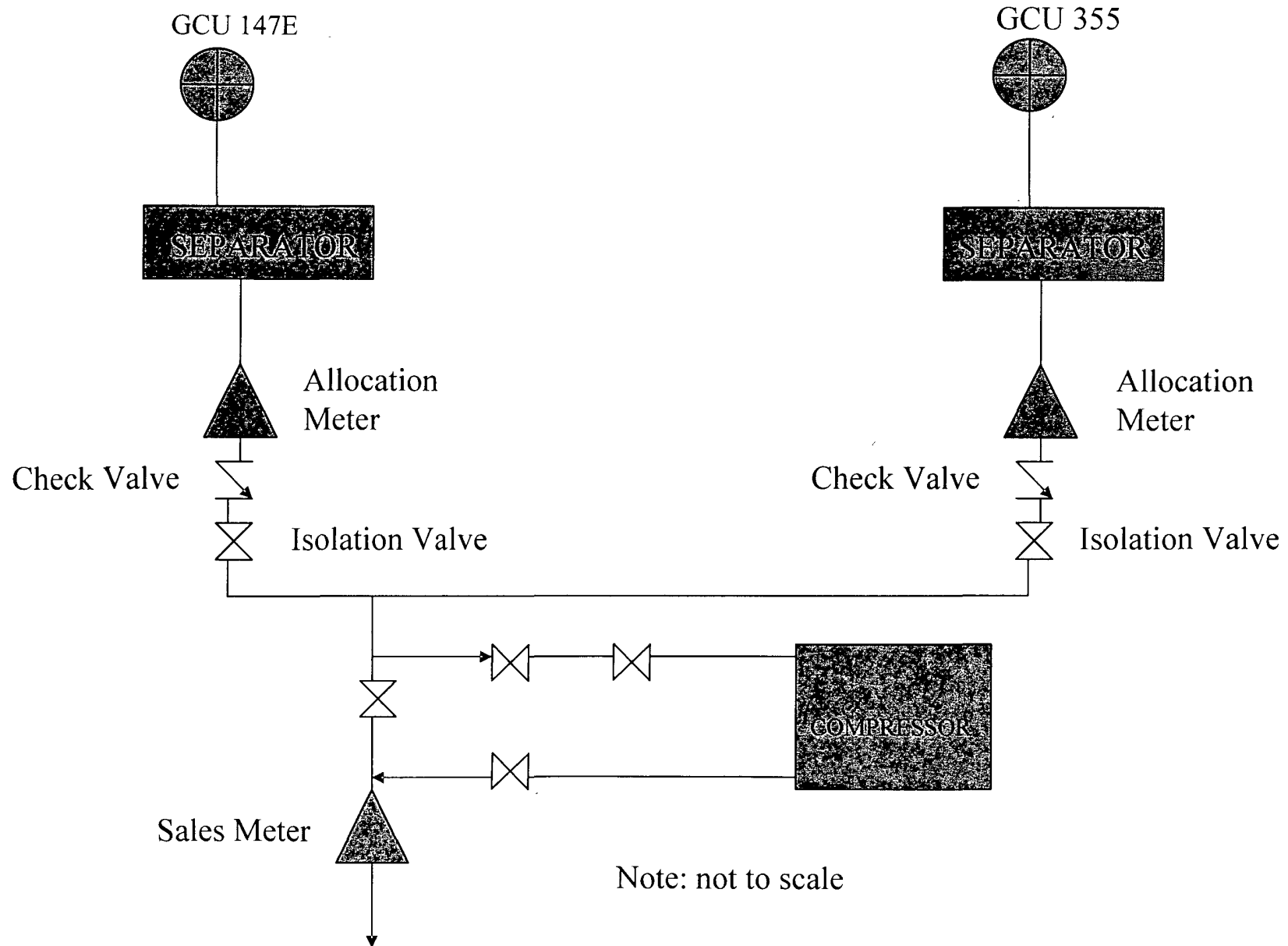

All distances must be from the outer boundaries of the Section.

Operator <b>AMOCO PRODUCTION COMPANY</b>			Lease <b>GALLEGOS CANYON UNIT</b>		Well No. <b>117E</b>
Unit Letter <b>K</b>	Section <b>4</b>	Township <b>27N</b>	Range <b>12W</b>	County <b>San Juan</b>	
Actual Footage Location of Well:					
1850 feet from the		South	line and	1700 feet from the	West line
Ground Level Elev. <b>5731</b>	Producing Formation <b>Dakota &amp; Gallup</b>		Pool <b>Basin Dakota/Undesignated Gallup</b>	Dedicated Acreage: <b>320/40</b> Acres	
<p>1. Outline the acreage dedicated to the subject well by colored pencil or hatchure marks on the plat below.</p> <p>2. If more than one lease is dedicated to the well, outline each and identify the ownership thereof (both as to working interest and royalty).</p> <p>3. If more than one lease of different ownership is dedicated to the well, have the interests of all owners been consolidated by communitization, unitization, force-pooling, etc?</p> <p><input checked="" type="checkbox"/> Yes   <input type="checkbox"/> No   If answer is "yes," type of consolidation <u>Unitized</u></p> <p>If answer is "no," list the owners and tract descriptions which have actually been consolidated. (Use reverse side of this form if necessary.) _____</p> <p>No allowable will be assigned to the well until all interests have been consolidated (by communitization, unitization, forced-pooling, or otherwise) or until a non-standard unit, eliminating such interests, has been approved by the Commission.</p>					

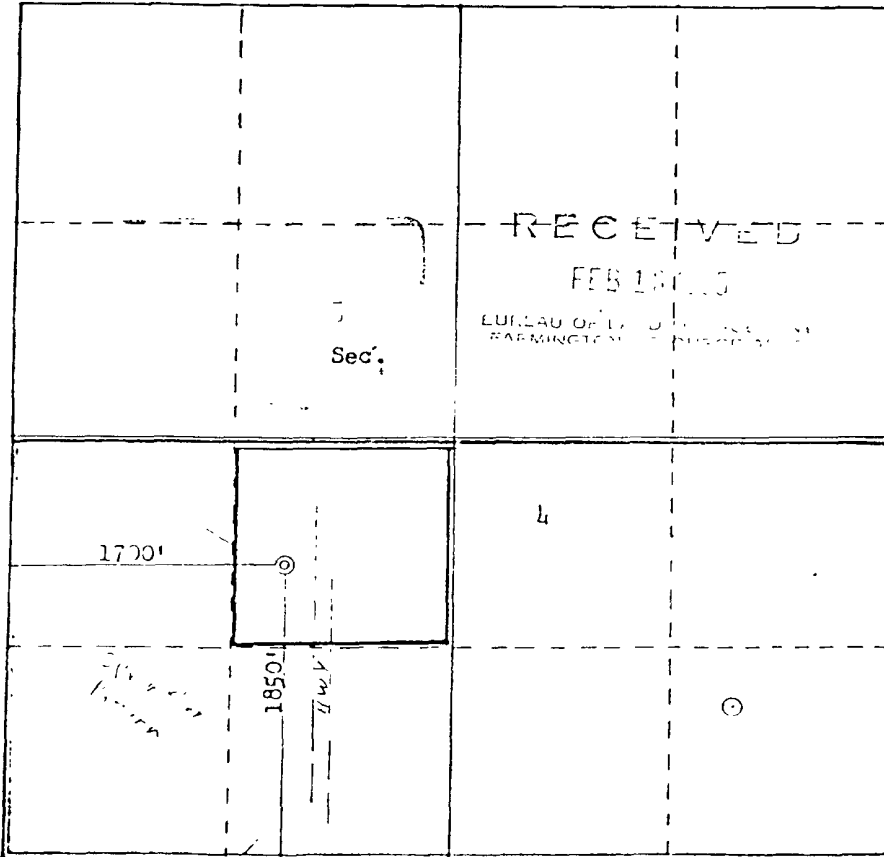

Scale: 1"=1000'

CERTIFICATION	
I hereby certify that the information contained herein is true and complete to the best of my knowledge and belief.	
Original Signature of <b>D.D. Lawson</b>	
Name	<b>D.D. Lawson</b>
Position	<b>District Administrative Supervisor</b>
Company	<b>Amoco Production Company</b>
Date	<b>2/5/85</b>
I hereby certify that the well location shown on this plat was plotted from field notes of actual surveys made by me or under my supervision, and that the same is true and correct to the best of my knowledge and belief.	
Date Surveyed	<b>January 11, 1985</b>
Registered Professional Engineer and Land Surveyor	
<b>Fred B. Kery Jr.</b>	
Certificate No.	<b>3950</b>

NEW MEXICO OIL CONSERVATION COMMISSION  
WELL LOCATION AND ACREAGE DEDICATION PLAT

Form C-102  
Supersedes C-128  
Effective 1-1-65

All distances must be from the outer boundaries of the Section

Operator <b>ENERGY RESERVES GROUP</b>			Lease <b>GALLEGO'S CANYON UNIT</b>		Well No. <b>355</b>
Unit Letter <b>K</b>	Section <b>4</b>	Township <b>27N</b>	Range <b>12W</b>	County <b>San Juan</b>	
Actual Footage Location of Well: <b>1735</b> feet from the <b>South</b> line and <b>1755</b> feet from the <b>West</b> line					
Ground Level Elev. <b>5732</b>	Producing Formation <b>Pictured Cliffs</b>		Pool <b>West Kutz Pictured Cliffs</b>		Dedicated Acreage: <b>160</b> Acres

1. Outline the acreage dedicated to the subject well by colored pencil or hachure marks on the plat below.
2. If more than one lease is dedicated to the well, outline each and identify the ownership thereof (both as to working interest and royalty).
3. If more than one lease of different ownership is dedicated to the well, have the interests of all owners been consolidated by communitization, unitization, force-pooling, etc?

☐ Yes ☐ No If answer is "yes," type of consolidation \_\_\_\_\_

If answer is "no," list the owners and tract descriptions which have actually been consolidated. (Use reverse side of this form if necessary.) \_\_\_\_\_

No allowable will be assigned to the well until all interests have been consolidated (by communitization, unitization, forced-pooling, or otherwise) or until a non-standard unit, eliminating such interests, has been approved by the Commission.

<p>GAS is dedicated to El Paso Natural Gas Company</p> <p>Sec.</p>		<p><b>RECEIVED</b></p> <p><b>MAY 17 1985</b></p> <p>BUREAU OF LAND MANAGEMENT FARMINGTON RESOURCE AREA</p>
		<p><b>1755'</b></p> <p><b>1735'</b></p> <p><b>26 1985</b></p> <p><b>CLECON-DIV.</b></p> <p><b>DIST. 3</b></p>

Scale: 1"=1000'

<p><b>CERTIFICATION</b></p> <p>I hereby certify that the information contained herein is true and complete to the best of my knowledge and belief.</p> <p><i>William J. Fiant</i></p>	
Name	<b>William J. Fiant</b>
Position	<b>Administrator, Field Services</b>
Company	<b>Energy Reserves Group, Inc.</b>
Date	<b>5/3/85</b>
<p>I hereby certify that the well location shown on this plat was plotted from field notes of actual surveys made by me or under my supervision, and that the same is true and correct to the best of my knowledge and belief.</p>	
Date Surveyed	<b>April 23, 1985</b>
Registered Professional Engineer and Land Surveyor	<i>Fred B. Kerr Jr.</i> <b>Fred B. Kerr Jr.</b>
Certificate No.	<b>3950</b>