

District I  
1625 N. French Dr., Hobbs, NM 88240  
District II  
1301 W. Grand Avenue, Artesia, NM 88210  
District III  
1000 Rio Brazos Road, Aztec, NM 87410  
District IV  
1220 S. St. Francis Dr., Santa Fe, NM 87505

State of New Mexico  
Energy Minerals and Natural Resources

Form C-144  
June 1, 2004

Oil Conservation Division  
1220 South St. Francis Dr.  
Santa Fe, NM 87505

For drilling and production facilities, submit to  
appropriate NMOCD District Office.  
For downstream facilities, submit to Santa Fe  
office

**Pit or Below-Grade Tank Registration or Closure**

Is pit or below-grade tank covered by a "general plan"? Yes ☐ No ☒

Type of action: Registration of a pit or below-grade tank ☐ Closure of a pit or below-grade tank ☒

Operator: Williams Production Co., LLC Telephone: 505-634-4219 e-mail address: myke.lane@williams.com  
Address: POB 640, Aztec, NM 87410  
Facility or well name: Rosa 129A API #: 30-039-26297 U/L or Qtr/Qtr K Sec 34 T 32N R 06W  
County: Rio Arriba Latitude \_\_\_\_\_ Longitude \_\_\_\_\_ NAD: 1927 ☐ 1983 ☒  
Surface Owner: Federal ☒ State ☐ Private ☐ Indian ☐

Pit	Below-grade tank	
Type: Drilling <input type="checkbox"/> Production <input checked="" type="checkbox"/> Disposal <input type="checkbox"/> Workover <input type="checkbox"/> Emergency <input type="checkbox"/> Lined <input type="checkbox"/> Unlined <input type="checkbox"/> Liner type: Synthetic <input type="checkbox"/> Thickness _____ mil Clay <input type="checkbox"/> Pit Volume _____ bbl	Volume: <u>120</u> bbl Type of fluid: <u>Produced Water</u> Construction material: <u>Fiberglass with Plastic Liner</u> Double-walled, with leak detection? Yes <input checked="" type="checkbox"/> If not, explain why not.	
Depth to ground water (vertical distance from bottom of pit to seasonal high water elevation of ground water.)	Less than 50 feet	(20 points)
	50 feet or more, but less than 100 feet ✓ 100 feet or more	(10 points) ✓ ( 0 points)
Wellhead protection area: (Less than 200 feet from a private domestic water source, or less than 1000 feet from all other water sources.)	Yes	(20 points)
	✓ No	✓ ( 0 points)
Distance to surface water: (horizontal distance to all wetlands, playas, irrigation canals, ditches, and perennial and ephemeral watercourses.)	Less than 200 feet	(20 points)
	✓ 200 ft or more, but less than 1000 feet 1000 feet or more	✓ (10 points) ( 0 points)
Ranking Score (Total Points)		10

If this is a pit closure: (1) Attach a diagram of the facility showing the pit's relationship to other equipment and tanks. (2) Indicate disposal location: (check the onsite box if you are burying in place) onsite ☒ offsite ☐ If offsite, name of facility \_\_\_\_\_. (3) Attach a general description of remedial action taken including remediation start date and end date. (4) Groundwater encountered: No ☒ Yes ☐ If yes, show depth below ground surface \_\_\_\_\_ ft. and attach sample results. (5) Attach soil sample results and a diagram of sample locations and excavations.

Additional Comments:

Replace Fiberglass BGT with SGT steel tank. Composite soil sample collected following removal of tank and liner 08/03/2006.

See attached site diagram and soil sample results.

I hereby certify that the information above is true and complete to the best of my knowledge and belief. I further certify that the above-described pit or below-grade tank has been/will be constructed or closed according to NMOCD guidelines ☒, a general permit ☐, or an (attached) alternative OCD-approved plan ☐.

Date: 12/2/07

Printed Name/Title Michael K. Lane/EH&S Specialist

Signature [Signature]

Your certification and NMOCD approval of this application/closure does not relieve the operator of liability should the contents of the pit or tank contaminate ground water or otherwise endanger public health or the environment. Nor does it relieve the operator of its responsibility for compliance with any other federal, state, or local laws and/or regulations.

Approval:

Deputy Oil & Gas Inspector,  
District #3

Printed Name/Title \_\_\_\_\_

Signature [Signature]

Date: JAN 07 2008

# ENVIROTECH LABS

PRACTICAL SOLUTIONS FOR A BETTER TOMORROW

## EPA METHOD 8015 Modified Nonhalogenated Volatile Organics Total Petroleum Hydrocarbons

Client:	Williams Production	Project #:	04108-003
Sample ID:	Rosa 129A - BGT	Date Reported:	08-17-06
Laboratory Number:	38162	Date Sampled:	08-03-06
Chain of Custody No:	1340	Date Received:	08-14-06
Sample Matrix:	Soil	Date Extracted:	08-15-06
Preservative:	Cool	Date Analyzed:	08-16-06
Condition:	Cool and Intact	Analysis Requested:	8015 TPH

Parameter	Concentration (mg/Kg)	Det. Limit (mg/Kg)
Gasoline Range (C5 - C10)	2.0	0.2
Diesel Range (C10 - C28)	7.9	0.1
Total Petroleum Hydrocarbons	9.9	0.2

ND - Parameter not detected at the stated detection limit.

References: Method 8015B, Nonhalogenated Volatile Organics, Test Methods for Evaluating Solid Waste, SW-846, USEPA, December 1996.

Comments: **Rosa 129A.**

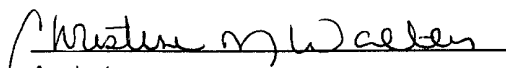
  
Analyst

  
Review

# ENVIROTECH LABS

**PRACTICAL SOLUTIONS FOR A BETTER TOMORROW**

## EPA METHOD 8021 AROMATIC VOLATILE ORGANICS

Client:	Williams Production	Project #:	04108-003
Sample ID:	Rosa 129A - BGT	Date Reported:	08-17-06
Laboratory Number:	38162	Date Sampled:	08-03-06
Chain of Custody:	1340	Date Received:	08-14-06
Sample Matrix:	Soil	Date Analyzed:	08-16-06
Preservative:	Cool	Date Extracted:	08-15-06
Condition:	Cool & Intact	Analysis Requested:	BTEX

Parameter	Concentration (ug/Kg)	Det. Limit (ug/Kg)
Benzene	13.4	1.8
Toluene	32.6	1.7
Ethylbenzene	1,170	1.5
p,m-Xylene	562	2.2
o-Xylene	169	1.0
Total BTEX	1,950	

ND - Parameter not detected at the stated detection limit.

Surrogate Recoveries:	Parameter	Percent Recovery
	Fluorobenzene	98.0 %
	1,4-difluorobenzene	98.0 %
	Bromochlorobenzene	98.0 %

References: Method 5030B, Purge-and-Trap, Test Methods for Evaluating Solid Waste, SW-846, USEPA, December 1996.

Method 8021B, Aromatic Volatile Organics, Test Methods for Evaluating Solid Waste, SW-846, USEPA, December 1996.

Comments: Rosa 129A.

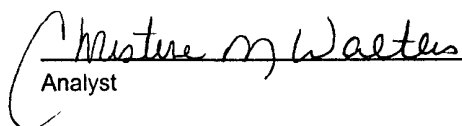
  
Analyst

  
Review

## 1340

san juan reproduction 578-129

Williams Production Company

Rosa 129 A St. # 8288901

Sec. 34 (K) T32N R6W 1680' FSL 1965' FWL

Rio Arriba County N.M.

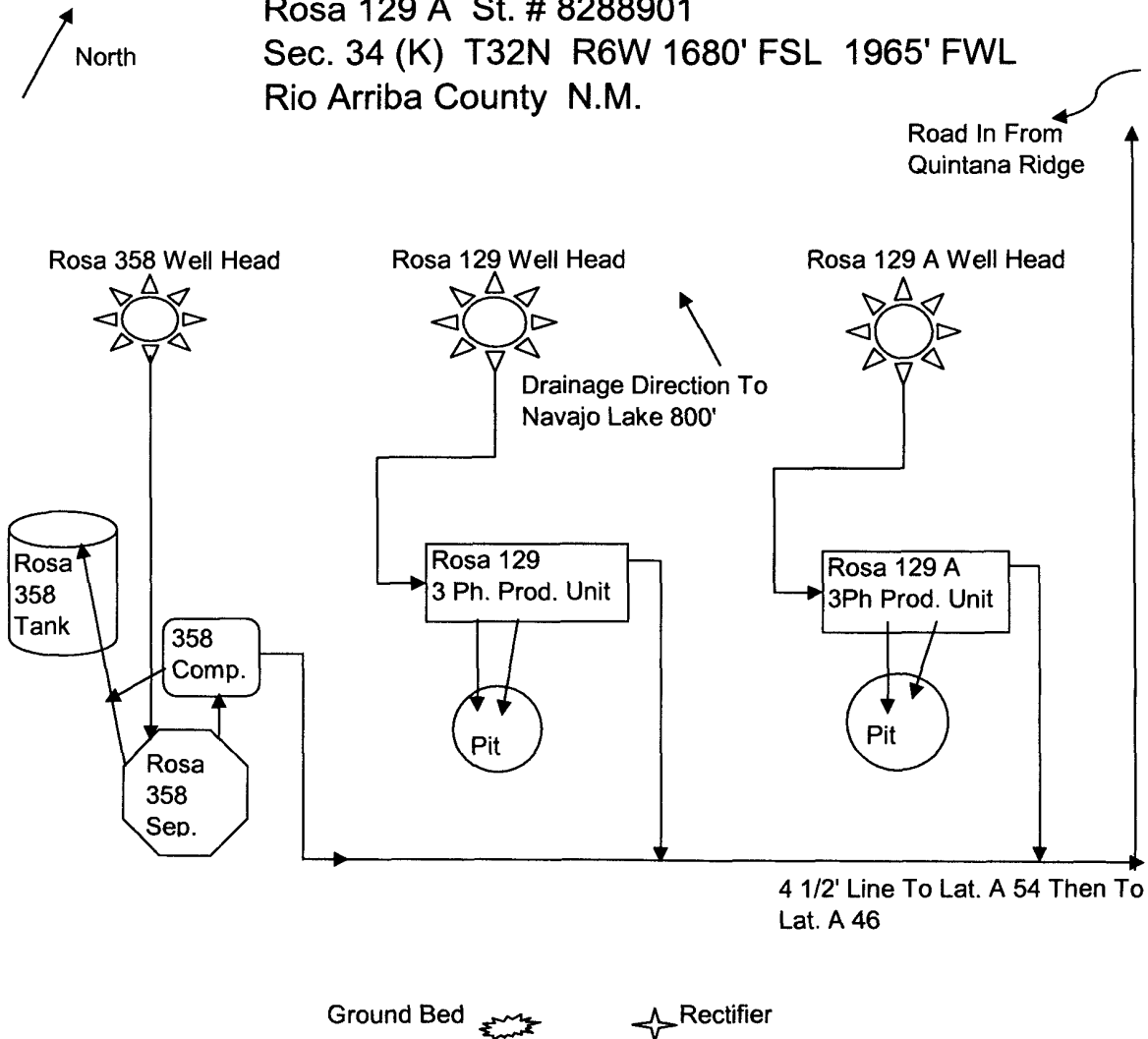

Rosa 129 Sep. Pesco 3 Ph. Ser. # 204041 Year 2000

Rosa 129 A Sep. Pesco 3 Ph. Ser. # 204039 Year 2000

Rosa 358 Equipment ?

Rectifier J A Electronic 120/240 Volt Ser. # 2010148 Shared By All Three Well's

Rosa 129 Pit 120 Bbl. Fiberglass Lined & Leak Detection

Rosa 129 A Pit 120 Bbl. Fiberglass Lined & Leak Detection