

Office

Energy, Minerals and Natural Resources

May 27, 2004

District I

1625 N. French Dr., Hobbs, NM 88240

District II

1301 W. Grand Ave., Artesia, NM 88210

District III

1000 Rio Brazos Rd., Aztec, NM 87410

District IV

1220 S. St. Francis Dr., Santa Fe, NM 87505

**OIL CONSERVATION DIVISION**

1220 South St. Francis Dr.

Santa Fe, NM 87505

WELL API NO.

30-045-34586

5. Indicate Type of Lease

STATE ☒

FEE ☐

6. State Oil & Gas Lease No.

E-1203-13

7. Lease Name or Unit Agreement Name

MIMS State Com

8. Well Number

#1S

9. OGRID Number

14538

10. Pool name or Wildcat

Basin Fruitland Coal

**SUNDARY NOTICES AND REPORTS ON WELLS**  
(DO NOT USE THIS FORM FOR PROPOSALS TO DRILL OR TO DEEPEN OR PLUG BACK TO A DIFFERENT RESERVOIR. USE "APPLICATION FOR PERMIT" (FORM C-101) FOR SUCH PROPOSALS.)

1. Type of Well:

Oil Well ☐

Gas Well ☒

Other

2. Name of Operator

BURLINGTON RESOURCES OIL & GAS COMPANY LP

3. Address of Operator

3401 E. 30TH STREET, FARMINGTON, NM 87402

4. Well Location

Unit Letter F : 1418' feet from the North line and 1767' feet from the West line  
Section 16 Township 29N Rng 9W NMPM County San Juan

11. Elevation (Show whether DR, RKB, RT, GR, etc.)

5788' GL

Pit or Below-grade Tank Application

☐ or Closure ☐

Pit type New Drill

Depth to Groundwater

<50'

Distance from nearest fresh water well

>1000'

Distance from nearest surface water

>1000'

Pit Liner Thickness:

12

mil

Below-Grade Tank:

Volume

4400

bbls;

Construction Material

12. Check Appropriate Box to Indicate Nature of Notice, Report or Other Data

**NOTICE OF INTENTION TO:**

PERFORM REMEDIAL WORK ☐

TEMPORARILY ABANDON ☐

PULL OR ALTER CASING ☐

PLUG AND ABANDON ☐

CHANGE PLANS ☐

MULTIPLE COMPL ☐

**SUBSEQUENT REPORT OF:**

REMEDIAL WORK ☐

COMMENCE DRILLING OPNS. ☐

CASING/CEMENT JOB ☐

ALTERING CASING ☐

P AND A ☐

OTHER:

New Drill ☒

OTHER: ☐

13. Describe proposed or completed operations. (Clearly state all pertinent details, and give pertinent dates, including estimated date of starting any proposed work). SEE RULE 1103. For Multiple Completions: Attach wellbore diagram of proposed completion or recompletion.

RCVD FEB 21 '08

OIL CONS. DIV.

DIST. 3

New Drill, Lined:

Burlington Resources proposes to construct a new drilling pit, an associated vent/flare pit and a pre-set mud pit (if required). Based on Burlington's interpretation of the Ecosphere's risk ranking criteria, the new drilling pit and pre-set mud pit will be lined pits as detailed in Burlington's Revised Drilling / Workover Pit Construction / Operation Procedures dated November 11, 2004 on file at the NMOCD office. A portion of the vent/flare pit will be designed to manage fluids and that portion will be lined as per the risk ranking criteria. Burlington Resources anticipates closing these pits according to the Drilling / Workover Pit Closure Procedure dated August 2, 2004 on file at the NMOCD office.

I hereby certify that the information above is true and complete to the best of my knowledge and belief. I further certify that any pit or below-grade tank has been/will be constructed or closed according to NMOCD guidelines ☐, a general permit ☒ or an (attached) alternative OCD-approved plan ☐.

SIGNATURE

*Patsy Clugston*

TITLE

Regulatory Specialist

DATE

2/20/08

Type or print name

Patsy Clugston

E-mail address:

clugspl@conocophillips.com

Telephone No.

505-326-9518

For State Use Only

Deputy Oil & Gas Inspector,

District #3

APPROVED BY

*Brand Roll*

TITLE

DATE

FEB 21 2008

Conditions of Approval (if any):

LATITUDE: 36.72835°N  
 LONGITUDE: 107.78680°W  
 DATUM: NAD 83

# BURLINGTON RESOURCES O&G CO LP

MIMS STATE COM #1 S  
 1418' FNL & 1767' FWL  
 LOCATED IN THE SE/4 NW/4 OF SECTION 16,  
 T29N, R9W, N.M.P.M.,  
 SAN JUAN COUNTY, NEW MEXICO  
 GROUND ELEVATION: 5788', NAVD 88  
 FINISHED PAD ELEVATION: 5788.3', NAVD 88

SLOPES TO BE CONSTRUCTED TO  
 MATCH THE ORIGINAL CONTOURS  
 AS CLOSE AS POSSIBLE.

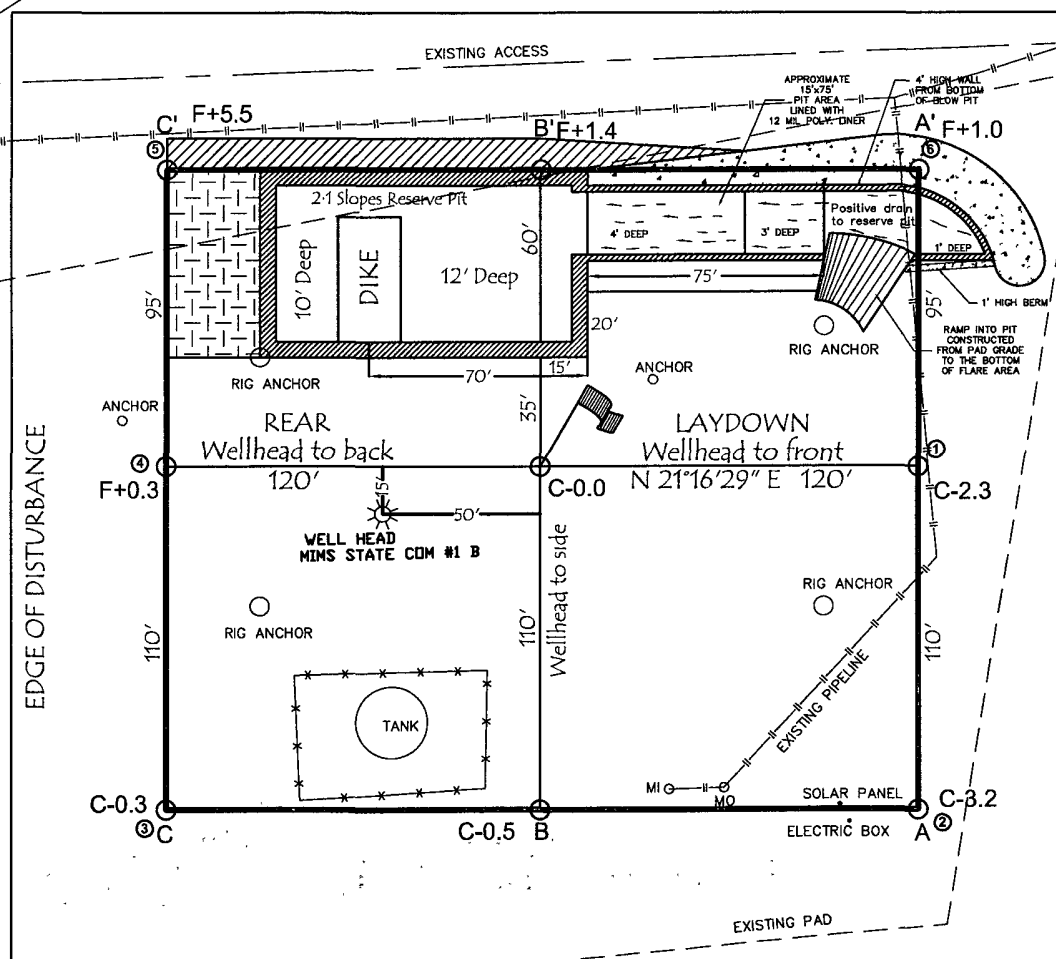
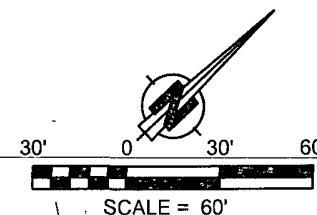

305' x 340' = 2.38 ACRES OF DISTURBANCE  
 SCALE: 1" = 60'  
 JOB No.: COP119  
 DATE: 11/09/07

NOTE:  
 RESERVE PIT DIKE: TO BE 8' ABOVE DEEP SIDE (OVERFLOW - 3' WIDE AND 1' ABOVE SHALLOW SIDE).  
 RUSSELL SURVEYING, INC. IS NOT LIABLE FOR UNDERGROUND UTILITIES OR PIPELINES.  
 CONTRACTOR SHOULD CALL ONE-CALL FOR LOCATION OF ANY MARKED OR UNMARKED, BURIED PIPELINES OR  
 CABLES ON WELL PAD, IN CONSTRUCTION ZONE AND/OR ACCESS ROAD AT LEAST TWO (2) WORKING DAYS PRIOR  
 TO CONSTRUCTION.



**Russell Surveying**  
 1409 W. Aztec Blvd. #2  
 Aztec, New Mexico 87410  
 (505) 334-8637

LATITUDE: 36.72835°N  
LONGITUDE: 107.78680°W  
DATUM: NAD 83

# BURLINGTON RESOURCES O&G CO LP

MIMS STATE COM #1 S  
1418' FNL & 1767' FWL  
LOCATED IN THE SE/4 NW/4 OF SECTION 16,  
T29N, R9W, N.M.P.M.,  
SAN JUAN COUNTY, NEW MEXICO  
GROUND ELEVATION: 5788', NAVD 88  
FINISHED PAD ELEVATION: 5788.3', NAVD 88

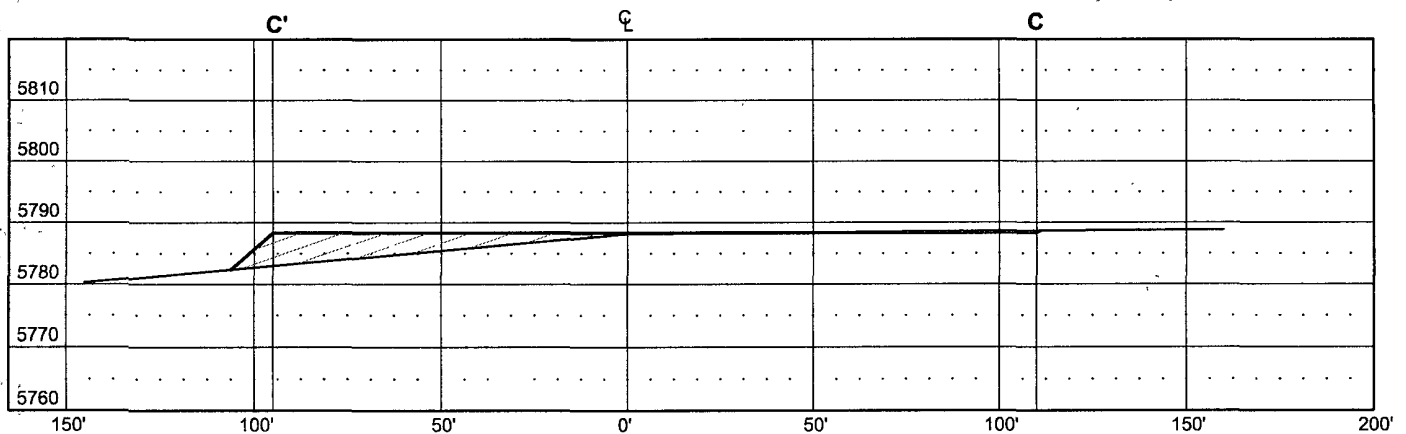
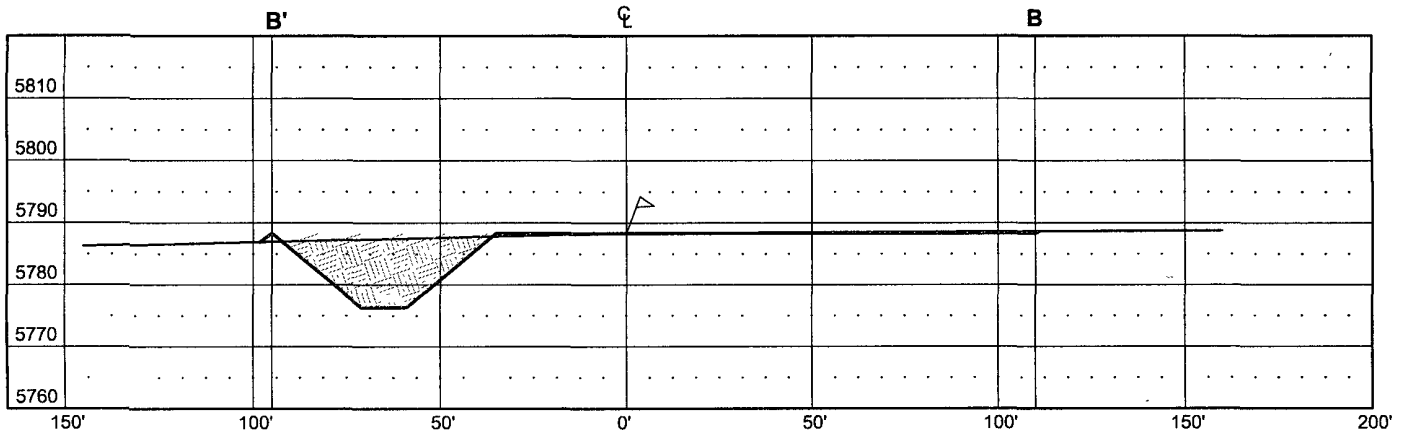
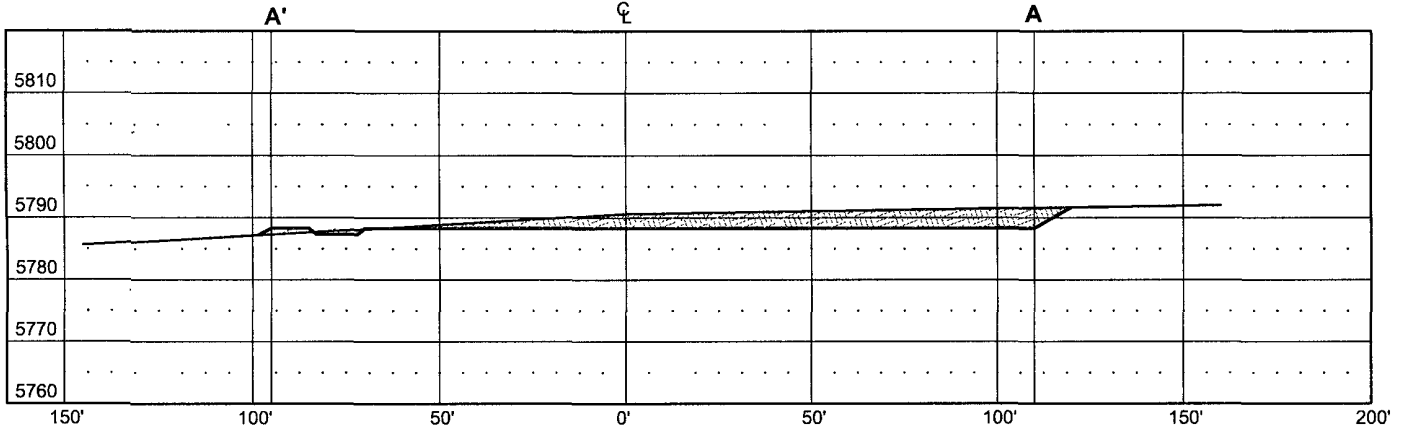

THIS DIAGRAM IS AN ESTIMATE OF DIRT BALANCE AND IS NOT INTENDED TO BE AN EXACT MEASURE OF VOLUME

VERT. SCALE: 1" = 30'  
HORZ. SCALE: 1" = 50'  
JOB No.: COPC119  
DATE: 11/09/07

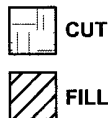

**Russell Surveying**  
1409 W. Aztec Blvd. #2  
Aztec, New Mexico 87410  
(505) 334-8637