

UNITED STATES
DEPARTMENT OF THE INTERIOR
BUREAU OF LAND MANAGEMENT

RCVD MAR 13 '08

OIL CONS. DIV.

DIST. 3

APPLICATION FOR PERMIT TO DRILL, DEEPEN, OR PLUG BACK

RECEIVED

FEB 27 2008

Bureau of Land Management
Farmington Field Office

1a. Type of Work DRILL	5. Lease Number USA SF-078097 Unit Reporting Number	
1b. Type of Well GAS	6. If Indian, All. or Tribe	
2. Operator BURLINGTON RESOURCES Oil & Gas Company, LP	7. Unit Agreement Name	
3. Address & Phone No. of Operator PO Box 4289, Farmington, NM 87499 (505) 326-9700	8. Farm or Lease Name Thurston Com 9. Well Number #100S	
4. Location of Well Surf: Unit O (SWSE), 677' FSL & 1610' FEL Surf: Latitude 36.850167° N Longitude 108.028416° W	10. Field, Pool, Wildcat Basin Fruitland Coal 11. Sec., Twn, Rge, Mer. (NMPM) 0 Sec. 31, T31N, R11W API # 30-045- 34619	
14. Distance in Miles from Nearest Town 2.5 miles/Aztec	12. County San Juan	13. State NM
15. Distance from Proposed Location to Nearest Property or Lease Line 677'	17. Acres Assigned to Well 322.9 (S/2)	
16. Acres in Lease 2475.610 Acres	20. Rotary or Cable Tools Rotary	
18. Distance from Proposed Location to Nearest Well, Drig, Compl, or Applied for on this Lease 633' from Yager 1A - MV	22. Approx. Date Work will Start	
19. Proposed Depth 2574'	21. Elevations (DF, FT, GR, Etc.) 5935' GR	
23. Proposed Casing and Cementing Program See Operations Plan attached	NOTIFY AZTEC OGD 24 HRS. PRIOR TO CASING & CEMENT	
24. Authorized by: <u>Crystal Walker</u> Crystal Walker (Regulatory Technician)	2/27/08 Date	

PERMIT NO. APPROVAL DATE
APPROVED BY [Signature] TITLE AFM DATE 3/12/08

Archaeological Report attached

Threatened and Endangered Species Report attached

NOTE: This format is issued in lieu of U.S. BLM Form 3160-3

Title 18 U.S.C. Section 1001, makes it a crime for any person knowingly and willfully to make to any department or agency of the United States any false, fictitious or fraudulent statements or presentations as to any matter within its jurisdiction.



H₂S POTENTIAL EXIST

Example Master Plan Type 2

Bond Numbers NMB-000015 and NMB-000089

BLM'S APPROVAL OR ACCEPTANCE OF THIS
ACTION DOES NOT RELIEVE THE LESSEE AND
OPERATOR FROM OBTAINING ANY OTHER
AUTHORIZATION REQUIRED FOR OPERATIONS
ON FEDERAL AND INDIAN LANDS

NMOCD

MAR 19 2008
AV

This action is subject to technical and
procedural review pursuant to 43 CFR 3165.3
and appeal pursuant to 43 CFR 3165.4

DRILLING OPERATIONS AUTHORIZED ARE
SUBJECT TO COMPLIANCE WITH ATTACHED
"GENERAL REQUIREMENTS".

DISTRICT I
1625 N. French Dr., Hobbs, N.M. 88240

DISTRICT II
1301 W. Grand Avenue, Artesia, N.M. 88210

DISTRICT III
1000 Rio Brazos Rd., Aztec, N.M. 87410

DISTRICT IV
1220 S. St. Francis Dr., Santa Fe, N.M. 87505

State of New Mexico
Energy, Minerals & Natural Resources Department

OIL CONSERVATION DIVISION
1220 South St. Francis Dr.
Santa Fe, N.M. 87505

Form C-102
Revised October 12, 2005
Submit to Appropriate District Office
State Lease - 4 Copies
Fee Lease - 3 Copies
FEB 27 2008

Bureau of Land Management
Farmington Field Office
☐ AMENDED REPORT

WELL LOCATION AND ACREAGE DEDICATION PLAT

*API Number 30-045-34619	*Pool Code 71629	*Pool Name BASIN FRUITLAND COAL
*Property Code 37061	*Property Name THURSTON COM	*Well Number 100S
*OGRID No. 14538	*Operator Name BURLINGTON RESOURCES OIL & GAS COMPANY LP.	*Elevation 5935

¹⁰ Surface Location

UL or lot no.	Section	Township	Range	Lot Idn	Feet from the	North/South line	Feet from the	East/West line	County
0	31	31 N	11 W		677	SOUTH	1610	EAST	SAN JUAN

¹¹ Bottom Hole Location If Different From Surface

UL or lot no.	Section	Township	Range	Lot Idn	Feet from the	North/South line	Feet from the	East/West line	County
0									

*Dedicated Acres	*Joint or Infill	*Consolidation Code	*Order No.
322.9 (S/2)			

NO ALLOWABLE WILL BE ASSIGNED TO THIS COMPLETION UNTIL ALL INTERESTS HAVE BEEN CONSOLIDATED
OR A NON-STANDARD UNIT HAS BEEN APPROVED BY THE DIVISION

16 S 89°21'24" E 2639.11' LOT 1	2683.13'	S 89°21'22" E 2648.62'	17 OPERATOR CERTIFICATION I hereby certify that the information contained herein is true and complete to the best of my knowledge and belief, and that this organization either owns a working interest or unleased mineral interest in the land including the proposed bottom hole location or has a right to drill this well at this location pursuant to a contract with an owner of such a mineral or working interest, or to a voluntary pooling agreement or a compulsory pooling order heretofore entered by the division. Signature: <u>Sasha Spangler</u> Date: <u>11-29-07</u> Printed Name: <u>Sasha Spangler</u>
N 0°26'10" E LOT 2			
SECTION 31			18 SURVEYOR CERTIFICATION I hereby certify that the well location shown on this plat was plotted from field notes of actual surveys made by me or under my supervision, and that the same is true and correct to the best of my belief. Date of Survey: <u>11/08/07</u> Signature and Seal: <u>[Signature]</u> 17078 Certificate Number
USA SF-078115 LOT 3	USA SF-078097	NAD 83 LAT: 36.850167° N LONG: 108.028416° W	
SAUL A YAGER LOT 4 ET UX	NAD 27 LAT: 36° 51.0098' N LONG: 108° 01.6675' W	1610'	
N 0°05'11" E N 89°58'08" W	2608.61'	N 89°50'08" W 2638.58'	

District I

1625 N. French Dr., Hobbs, NM 88240

District II

1301 W. Grand Ave., Artesia, NM 88210

District III

1000 Rio Brazos Rd., Aztec, NM 87410

District IV

1220 S. St. Francis Dr., Santa Fe, NM 87505

OIL CONSERVATION DIVISION

1220 South St. Francis Dr.

Santa Fe, NM 87505

WELL API NO.	30-045- 34619
5. Indicate Type of Lease	STATE <input type="checkbox"/> FEE <input type="checkbox"/>
6. State Oil & Gas Lease No.	USA SF-078097
7. Lease Name or Unit Agreement Name	Thurston Com
8. Well Number	100S
9. OGRID Number	14538
10. Pool name or Wildcat	Basin Fruitland Coal

SUNDRY NOTICES AND REPORTS ON WELLS
(DO NOT USE THIS FORM FOR PROPOSALS TO DRILL OR TO DEEPEN OR PLUG BACK TO A DIFFERENT RESERVOIR. USE "APPLICATION FOR PERMIT" (FORM C-101) FOR SUCH PROPOSALS.)

1. Type of Well:
Oil Well ☐ Gas Well ☒ Other

2. Name of Operator
BURLINGTON RESOURCES OIL & GAS COMPANY LP

3. Address of Operator
3401 E. 30TH STREET, FARMINGTON, NM 87402

4. Well Location
Unit Letter O : 677' feet from the South line and 1610' feet from the East line
Section 31 Township 31N Rng 11W NMPM County San Juan

11. Elevation (Show whether DR, RKB, RT, GR, etc.)
5935'

Pit or Below-grade Tank Application ☐ or Closure ☐

Pit type New Drill Depth to Groundwater >100 Distance from nearest fresh water well >1000 Distance from nearest surface water >1000
Pit Liner Thickness: N/A mil Below-Grade Tank: Volume bbls; Construction Material

12. Check Appropriate Box to Indicate Nature of Notice, Report or Other Data

NOTICE OF INTENTION TO:

PERFORM REMEDIAL WORK	<input type="checkbox"/>	PLUG AND ABANDON	<input type="checkbox"/>
TEMPORARILY ABANDON	<input type="checkbox"/>	CHANGE PLANS	<input type="checkbox"/>
PULL OR ALTER CASING	<input type="checkbox"/>	MULTIPLE COMPL	<input type="checkbox"/>
OTHER:	<input checked="" type="checkbox"/> New Drill		

SUBSEQUENT REPORT OF:

REMEDIAL WORK	<input type="checkbox"/>	ALTERING CASING	<input type="checkbox"/>
COMMENCE DRILLING OPNS.	<input type="checkbox"/>	P AND A	<input type="checkbox"/>
CASING/CEMENT JOB	<input type="checkbox"/>		
OTHER:	<input type="checkbox"/>		

13. Describe proposed or completed operations. (Clearly state all pertinent details, and give pertinent dates, including estimated date of starting any proposed work). SEE RULE 1103. For Multiple Completions: Attach wellbore diagram of proposed completion or recompletion.

New Drill, Lined:

Burlington Resources proposes to construct a new drilling pit, an associated vent/flare pit and a pre-set mud pit (if required). Based on Burlington's interpretation of the Ecosphere's risk ranking criteria, the new drilling pit and pre-set mud pit will be lined pits as detailed in Burlington's Revised Drilling / Workover Pit Construction / Operation Procedures dated November 11, 2004 on file at the NMOCD office. A portion of the vent/flare pit will be designed to manage fluids and that portion will be lined as per the risk ranking criteria. Burlington Resources anticipates closing these pits according to the Drilling / Workover Pit Closure Procedure dated August 2, 2004 on file at the NMOCD office.

I hereby certify that the information above is true and complete to the best of my knowledge and belief. I further certify that any pit or below-grade tank has been/will be constructed or closed according to NMOCD guidelines ☐, a general permit ☒ or an (attached) alternative OCD-approved plan ☐.

SIGNATURE Sasha Spangler TITLE Regulatory Technician DATE 1/23/2008

Type or print name Sasha Spangler E-mail address: spangs@conocophillips.com Telephone No. 505-326-9568

For State Use Only

APPROVED BY [Signature] TITLE Deputy Oil & Gas Inspector, District #3 DATE MAR 19 2008

Conditions of Approval (if any):



TECHNICAL SERVICES
A CORROSION COMPANY

CATHODIC PROTECTION PLAN FOR NEW WELLS

WELL NAME Thurston Ann #1005 LEGALS 0-31-31-11 COUNTY Salt Lake

PURPOSED C.P. SYSTEM: Drill GB and set 2 well solen on SW edge of location Trench approx 200' AP # 6000 from proposed well to solar.

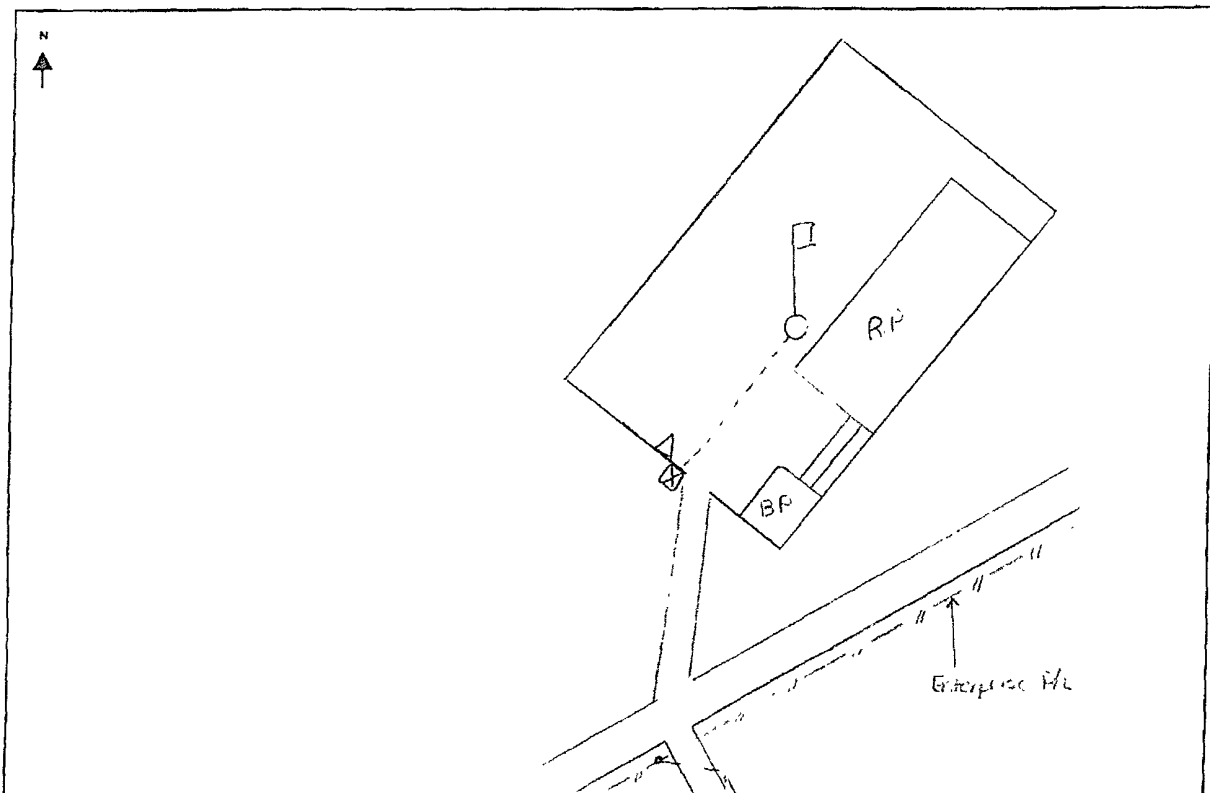

EXISTING WELLHEAD	METER HOUSE	G.B.	POWER SOURCE	CABLE	NEW WELL	OVERHEAD A C

COMMENTS: _____

NEAREST POWER SOURCE N/A DISTANCE: _____

PIPELINES IN AREA: Enterprise Pl.

TECHNICIAN: W. L. H. H. H. DATE: 12/7/07

PROJECT PROPOSAL - New Drill / Sidetrack

San Juan Business Unit

THURSTON COM 100S

DEVELOPMENT

Lease:		AFE #: WAN.CDR.7357		AFE \$: 205,696.52	
Field Name: hBR_SAN JUAN		Rig: Aztec Rig 580		State: NM	County: SAN JUAN
Geologist:		Phone:		Geophysicist:	
Geoscientist: Clark, Dave D		Phone: 505-326-9762		Prod. Engineer:	
Res. Engineer:		Phone:		Proj. Field Lead:	
				Phone:	

Primary Objective (Zones):	
Zone	Zone Name
JCV	BASIN FRUITLAND COAL (GAS)

Location:		Datum Code: NAD 27	
Latitude: 36.850164	Longitude: -108.027791	X:	Y:
Footage X: 1610 FEL	Footage Y: 677 FSL	Elevation: 5935 (FT)	Township: 031N
Tolerance:			

Location Type: Year Round	Start Date (Est.): 1/1/2009	Completion Date:	Date In Operation:
---------------------------	-----------------------------	------------------	--------------------

Formation Data: Assume KB = 5947	Units = FT
----------------------------------	------------

Formation Call & Casing Points	Depth (TVD in Ft)	SS (Ft)	Depletion (Yes/No)	BHP (PSIG)	BHT	Remarks
Surface Casing	120	5827	<input type="checkbox"/>			8-3/4 hole. 7" 20 ppf, J-55 STC csg. Cement with 50 cuft. Circulate cement to surface.
OJO ALAMO	1050	4897	<input type="checkbox"/>			
KIRTLAND	1066	4881	<input type="checkbox"/>			
FRUITLAND	2024	3923	<input type="checkbox"/>	300	Gas	
PICTURED CLIFFS	2374	3573	<input type="checkbox"/>		Gas	
Total Depth	2574	3373	<input type="checkbox"/>			6-1/4" hole. 4-1/2" 10.5 ppf, J-55, STC casing. Cement with 395 cuft. Circulate cement to surface.

Reference Wells:		
Reference Type	Well Name	Comments
Production	Heaton 29	SE31-31N-11W

Logging Program:	
Intermediate Logs:	<input type="checkbox"/> Log only if show <input type="checkbox"/> GR/ILD <input type="checkbox"/> Triple Combo

TD Logs:	<input type="checkbox"/> Triple Combo <input type="checkbox"/> Dipmeter <input type="checkbox"/> RFT <input type="checkbox"/> Sonic <input type="checkbox"/> VSP <input type="checkbox"/> TDT <input checked="" type="checkbox"/> Other
GR/CBL no OH logs no mudlogger	

Additional Information:					
Log Type	Stage	From (Ft)	To (Ft)	Tool Type/Name	Remarks

Comments:

CONOCOPHILLIPS

THURSTON COM 1005 - 677' FSL & 1610' FEL
SECTION 31, T-31-N, R-11-W, N.M.P.M., SAN JUAN COUNTY, N.M.
GRADED ELEVATION: 5935 - DATE: NOVEMBER 8, 2007

PAD CONST. SPECS:

1. RAMP INTO PIT CONSTRUCTED FROM PAD GRADE INTO FLARE AREA AT 5% SLOPE
2. APPROXIMATE 1.3x75' PIT AREA LINED WITH 1.2 MIL POLYUNER
3. RESERVE PIT DIKE TO BE 8' ABOVE DEEP SIDE (OVERFLOW 3' WIDE AND 1' ABOVE SHALLOW SIDE)
4. EDGE OF TEMPORARY CONSTRUCTION DEFINED IN FIELD W/6 T-POST

EDGE OF TEMPORARY CONSTRUCTION

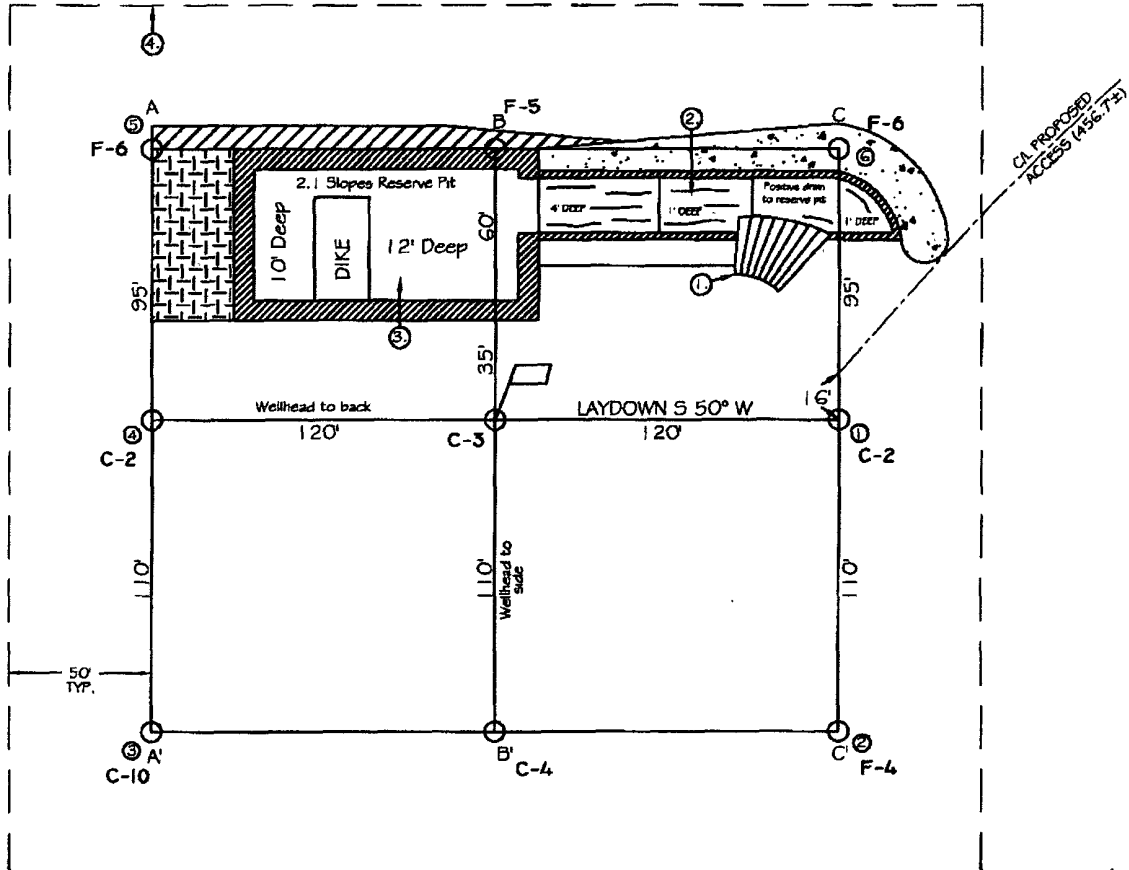

WELLPAD = 1.13 ACRES
TEMPORARY CONSTRUCTION = 1.25 ACRES
TOTAL = 2.38 ACRES

LATITUDE: 36°51.0098' N LONGITUDE: 108°01.6675' W NAD 27

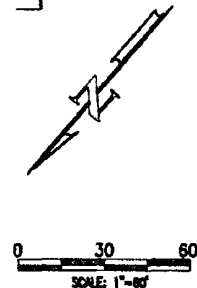

NOTES:

- 1.) CONTRACTOR SHOULD CALL "ONE-CALL" FOR LOCATION OF ANY MARKED OR UNMARKED BURIED PIPELINES OR CABLES ON WELLPAD AND OR ACCESS ROAD AT LEAST TWO (2) WORKING DAYS PRIOR TO CONST.
- 2.) UNITED FIELD SERVICES, INC. IS NOT LIABLE FOR UNDERGROUND UTILITIES OR PIPELINES.

SURVEYED: 11/08/07

REV. DATE: 12/03/07

APP. BY: M.W.L.

DRAWN BY: H.S.

DATE DRAWN: 11/13/07

FILE NAME: 8108L02



P.O. BOX 3651
FARMINGTON, NM 87499
OFFICE: (505)334-0408

CONOCOPHILLIPS

THURSTON COM 1005 - 677' FSL & 1610' FEL
SECTION 31, T-31-N, R-11-W, N.M.P.M., SAN JUAN COUNTY, N.M.
GRADED ELEVATION: 5935 - DATE: NOVEMBER 8, 2007

ELEVATION

A-A'

ε

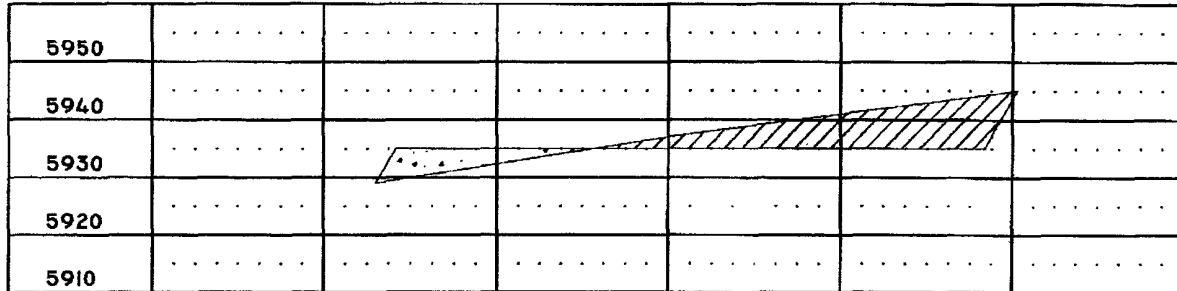

B-B'

ε

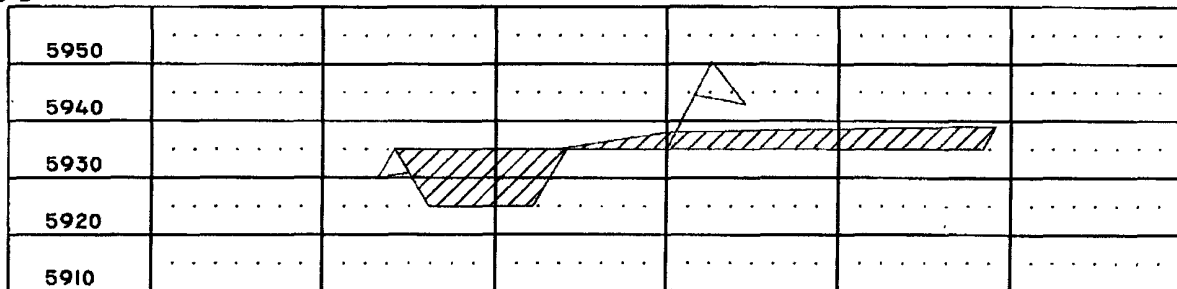

C-C'

ε

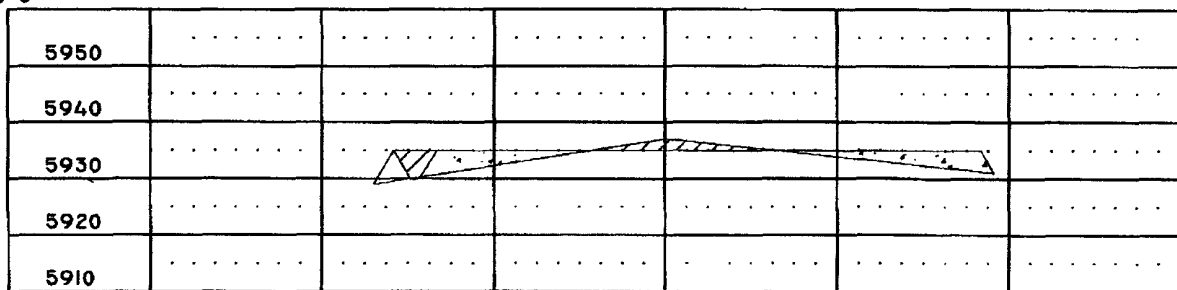

1" = 60' - HORIZ.

1" = 30' - VERT.

NOTES:

1.) CONTRACTOR SHOULD CALL 'ONE-CALL' FOR LOCATION OF ANY MARKED OR UNMARKED BURIED PIPELINES OR CABLES ON WELLPAD AND OR ACCESS ROAD AT LEAST TWO (2) WORKING DAYS PRIOR TO CONST.

2.) UNITED FIELD SERVICES, INC. IS NOT LIABLE FOR UNDERGROUND UTILITIES OR PIPELINES.

SURVEYED: 11/08/07

REV. DATE: 12/03/07

APP. BY M.W.L.

DRAWN BY: H.S.

DATE DRAWN: 11/13/07

FILE NAME: B108C02



P.O. BOX 3551
FARMINGTON, NM 87499
OFFICE: (505)334-0408