

UNITED STATES  
DEPARTMENT OF THE INTERIOR  
BUREAU OF LAND MANAGEMENT

**SUNDRY NOTICES AND REPORTS ON WELLS**  
*Do not use this form for proposals to drill or to re-enter an  
Abandoned well Use Form 3160-3 (APD) for such proposals.*

FORM APPROVED  
OMB No. 1004-0135  
Expires July 31, 2010

5 Lease Serial No

**NM 013860A**

6 If Indian, Allottee or tribe Name  
**RCVD MAR 24 '08**

If Unit or CA/Agreement, Name and/or No  
**OIL CONS. DIV.  
DIST. 3**

**SUBMIT IN TRIPLICATE – Other instructions on reverse side**

1 Type of Well

☐ Oil Well ☒ Gas Well ☐ Other

2 Name of Operator

**BP America Production Company Attn: Cherry Hlava**

3a. Address

**P.O. Box 3092 Houston, TX 77253**

3b Phone No (include area code)

**281-366-4081**

8 Well Name and No

**Russell A 1A**

API Well No

**30-045-23703**

3a. Address

**P.O. Box 3092 Houston, TX 77253**

3b Phone No (include area code)

**281-366-4081**

10 Field and Pool, or Exploratory Area

**Blanco Mesaverde, Otero Chacra**

4 Location of Well (Footage, Sec., T., R., M., or Survey Description)

**1780' FSL & 840' FEL Sec 24 T28N & R08W**

11 County or Parish, State

**San Juan County, New Mexico**

12 CHECK APPROPRIATE BOX(ES) TO INDICATE NATURE OR NOTICE, REPORT, OR OTHER DATA

TYPE OF SUBMISSION

☒ Notice of Intent

Subsequent Report

☐ Final Abandonment Notice

TYPE OF ACTION

☐ Acidize

☐ Alter Casing

☐ Casing Repair

☐ Change Plans

☐ Convert to Injection

☐ Deepen

☐ Fracture Treat

☐ New Construction

☐ Plug and Abandon

☐ Plug Back

☐ Production (Start/Resume)

☐ Reclamation

☐ Recomplete

☐ Water Disposal

☐ Water shut-Off

☐ Well Integrity

☒ Other Downhole  
Commingling

- 13 Describe Proposed or Completed Operation (clearly state all pertinent details, including estimated starting date of any proposed work and approximate duration thereof. If the proposal is to deepen directionally or recompleate horizontally, give subsurface locations and measured and true vertical depths of all pertinent markers and zones. Attach the Bond under which the work will be performed or provide the Bond No. on file with BLM/BIA. Required subsequent reports shall be filed within 30 days following completion of the involved operations. If the operation results in a multiple completion or recompleation in a new interval, a Form 3160-4 shall be filed once testing has been completed. Final Abandonment Notices shall be filed only after all requirements, including reclamation, have been completed, and the operator has determined that the site is ready for final inspection.

BP America Production Company request permission to recompleate the subject well into the Otero Chacra Pool and commingle production Downhole with the existing Blanco Mesaverde as per the attached procedure

The Blanco Mesaverde (72319) and Otero Chacra (82329) Pools are Pre-Approved Pools for Downhole Commingling per NMOCDC order R-11363. The working and overriding royalty interest owners in the proposed commingled pools are identical, therefore no additional notification is required. Production is proposed to be allocated based on the subtraction method using the projected future decline for production from the Mesaverde. That production shall serve as a base for production subtracted from the total production for the commingled well. The balance of the production will be attributed to the Chacra. Attached is the future production decline estimates for the Mesaverde. Commingling Production Downhole in the subject well from the proposed Pools will not reduce the value of the total remaining production.

- 14 I hereby certify that the foregoing is true and correct  
Name (Printed/typed)

**Cherry Hlava**

Title **Regulatory Analyst**

Signature *Cherry Hlava*

Date **03/18/2008**

THIS SPACE FOR FEDERAL OR STATE OFFICE USE

Approved by **Original Signed: Stephen Mason**

Title

Date

**MAR 20 2008**

Conditions of approval, if any, are attached. Approval of this notice does not warrant or certify that the applicant holds legal or equitable title to those rights in the subject lease which would entitle the applicant to conduct operations thereon.

Office

Title 18 U.S.C. Section 1001 and Title 43 U.S.C. Section 1212, make it a crime for any person knowingly and willfully to make to any department or agency of the United States any false, fictitious or fraudulent statements or representations as to any matter within its jurisdiction.

*No DHE order yet*

**NMOCDC**

**Russell A 1A Payadd**  
**BLM Procedure**  
**Sec 24 T28N, R8W**  
**API #: 30-045-23703**

1. Check anchors. MIRU workover rig.
2. If necessary, kill with 2% KCL water. Nipple down WH. NU BOPs.
3. Tag for fill and tally OH with 2-3/8" production tubing currently set at 5439'. Visually inspect tubing while POOH.
4. TIH with bit and scraper for 4 1/2" casing to 5483' PBTD. Note bottom of existing Mesa Verde perforations are 5433'.
5. TIH with tubing-set CIBP @ 4200'. Load hole with 2% KCL and test casing to 2800 psi.
6. Run CBL and RST and Chacra perforate using 3-1/8" casing guns loaded with HEG charges (2 SPF 90 deg phasing) and perforate Chacra 3800-4000'. Note: Depths may be revised after log review.
7. Depending on results of the CBL, remedial cement work may be required to isolate the Chacra in the 4 1/2" liner.
8. RU frac equipment. Use Slick Water 2% KCL Water 150,000# 16/30 45Q-N2 foam in fracture stimulation.
9. Frac Chacra according to pump schedule down casing with wellhead isolation tool installed. Leave well shut-in overnight.
10. TIH with tubing and notched collar. Cleanout fill to CIBP at 4200'. Blow well dry.
11. Test Chacra Zone for 8 hours.
12. Drill out CIBP and clean out to PBTD
13. Hang 2 3/8" production tubing @ 5030'
14. ND BOP's. NU WH. Test well for air. Return well to production as down hole commingle Mesa Verde and Chacra.

# Russell A 1A

Sec 24, T28N, R8W

API # 30-045-23703

GL 6295'

## History

Completed as MV in 12/79

## PROPOSED CHACRA PERFORATIONS

## Mesaverde Perforations

4405--4853' 1spf Frac'd w/ 46,500# sand  
5032-5433' 1spf Frac'd w/ 49,500# sand

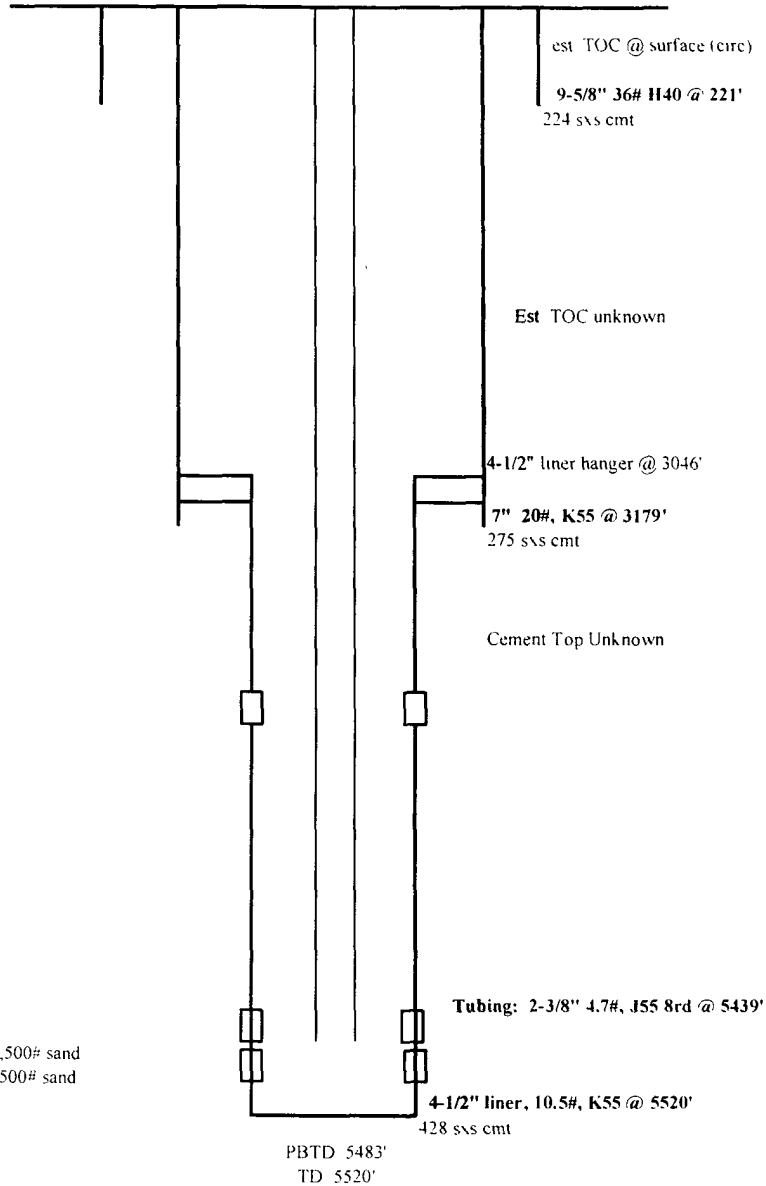

NOTES:

updated 1/3/06 ADB

District I

1625 N. French Dr. Hobbs, NM 88240  
Phone (505) 393-6161 Fax (505) 393-0720

District II

1301 W. Grand Ave., Artesia, NM 88210  
Phone (505) 748-1283 Fax (505) 748-9720

District III

1000 Rio Brazos Rd. Aztec NM 87410  
Phone (505) 334-6178 Fax (505) 334-6170

District IV

1220 S. St Francis Dr., Santa Fe, NM 87505  
Phone (505) 476-3470 Fax (505) 476-3462

**State of New Mexico**  
**Energy, Minerals and Natural Resources**

**Oil Conservation Division**  
**1220 S. St Francis Dr.**  
**Santa Fe, NM 87505**

Form C-102  
Permit 51714

**WELL LOCATION AND ACREAGE DEDICATION PLAT**

1 API Number <i>30-045-23703</i>	2 Pool Code 82329	3 Pool Name OTERO CHACRA (GAS)
4 Property Code 998	5 Property Name RUSSELL A	6 Well No 001A
7 OGRID No 778	8 Operator Name BP AMERICA PRODUCTION COMPANY	9 Elevation 6295

**10. Surface Location**

UL - Lot I	Section 24	Township 28N	Range 08W	Lot Idn	Feet From 1780	N/S Line S	Feet From 870	E/W Line E	County SAN JUAN
---------------	---------------	-----------------	--------------	---------	-------------------	---------------	------------------	---------------	--------------------

**11. Bottom Hole Location If Different From Surface**

UL - Lot	Section	Township	Range	Lot Idn	Feet From	N/S Line	Feet From	E/W Line	County
12 Dedicated Acres 160.00		13 Joint or Infill		14 Consolidation Code		15 Order No			

**NO ALLOWABLE WILL BE ASSIGNED TO THIS COMPLETION UNTIL ALL INTERESTS HAVE BEEN CONSOLIDATED OR A NON-STANDARD UNIT HAS BEEN APPROVED BY THE DIVISION**

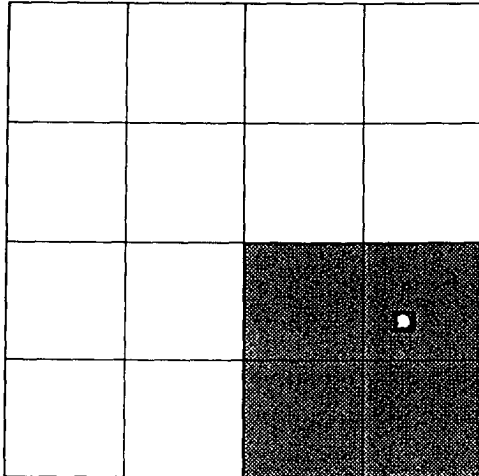
**OPERATOR CERTIFICATION**

*I hereby certify that the information contained herein is true and complete to the best of my knowledge and belief, and that this organization either owns a working interest or unleased mineral interest in the land including the proposed bottom hole location(s) or has a right to drill this well at this location pursuant to a contract with an owner of such a mineral or working interest, or to a voluntary pooling agreement or a compulsory pooling order heretofore entered by the division*

E-Signed By: *Cherry Alicia*  
Title *Regulatory Analyst*  
Date: *3-18-08*

**SURVEYOR CERTIFICATION**

*I hereby certify that the well location shown on this plat was plotted from field notes of actual surveys made by me or under my supervision, and that the same is true and correct to the best of my belief*

Surveyed By.

Date of Survey

Certificate Number. previously filed

All distances must be from the outer boundaries of the Section.

Operator <b>EL PASO NATURAL GAS COMPANY</b>			Lease <b>RUSSELL (NM-013860-A)</b>		Well No. <b>1A</b>
Unit Letter <b>I</b>	Section <b>24</b>	Township <b>28N</b>	Range <b>8W</b>	County <b>San Juan</b>	
Actual Footage Location of Well: <b>1780</b> feet from the <b>South</b> line and <b>870</b> feet from the <b>East</b> line					
Ground Level Elev. <b>6295</b>	Producing Formation <b>Mesa Verde</b>		Pool <b>Blanco Mesa Verde</b>	Dedicated Acreage: <b>320.00</b> Acres	

1. Outline the acreage dedicated to the subject well by colored pencil or hachure marks on the plat below.
2. If more than one lease is dedicated to the well, outline each and identify the ownership thereof (both as to working interest and royalty).
3. If more than one lease of different ownership is dedicated to the well, have the interests of all owners been consolidated by communitization, unitization, force-pooling, etc?

☐ Yes ☐ No If answer is "yes," type of consolidation \_\_\_\_\_

If answer is "no," list the owners and tract descriptions which have actually been consolidated. (Use reverse side of this form if necessary.) \_\_\_\_\_

No allowable will be assigned to the well until all interests have been consolidated (by communitization, unitization, forced-pooling, or otherwise) or until a non-standard unit, eliminating such interests, has been approved by the Commission.

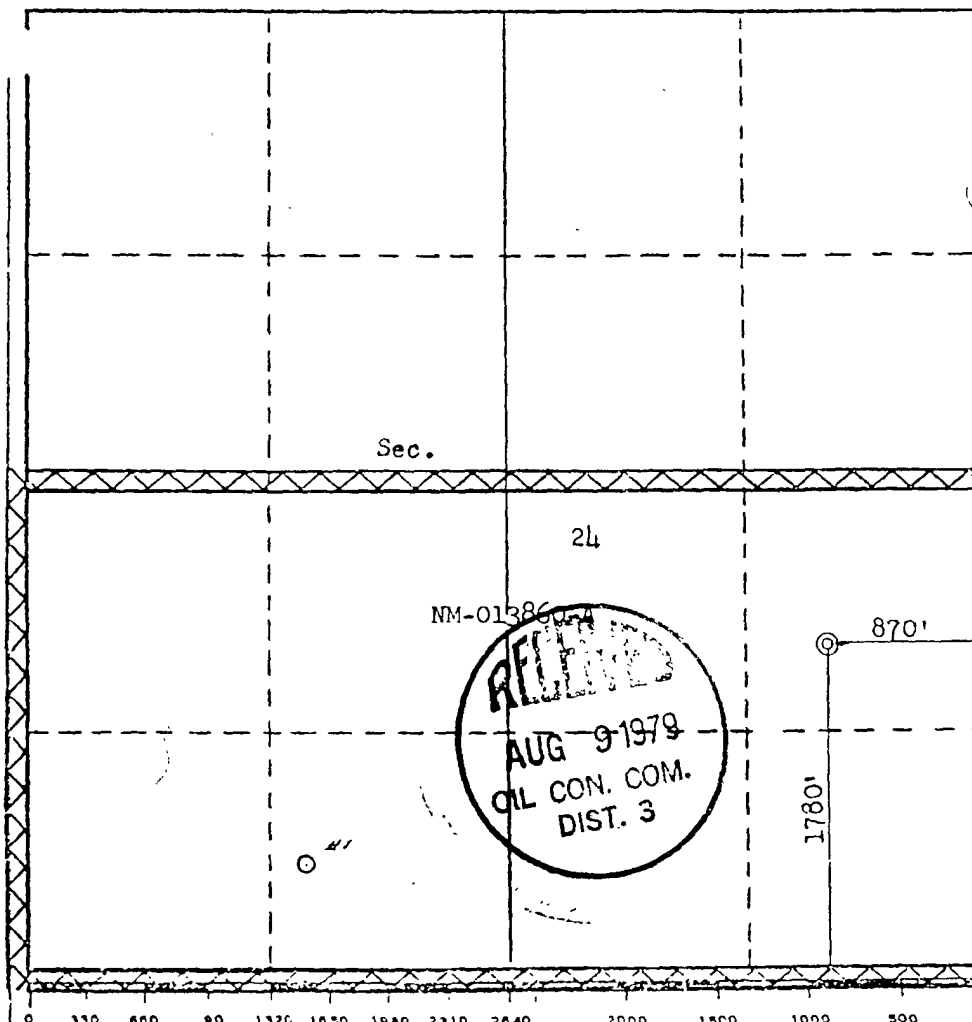

#### CERTIFICATION

I hereby certify that the information contained herein is true and complete to the best of my knowledge and belief.

Name \_\_\_\_\_

Drilling Clerk  
Position

El Paso Natural Gas Co.  
Company

July 26, 1979  
Date

I hereby certify that the well location shown on this plat was plotted from field notes of actual surveys made by me or under my supervision, and that the same is true and correct to the best of my knowledge and belief.

Date Surveyed \_\_\_\_\_

June 19, 1979

Registered Professional Engineer  
and/or Land Surveyor

Fred B. [Signature]  
Certificate No.

3950