

UNITED STATES
DEPARTMENT OF THE INTERIOR
BUREAU OF LAND MANAGEMENT

30-039-25319

APPLICATION FOR PERMIT TO DRILL, DEEPEN, OR PLUG BACK

1a. TYPE OF WORK
DRILL ☒ DEEPEN ☐ PLUG BACK ☐

b. TYPE OF WELL
OIL WELL ☒ GAS WELL ☐ OTHER ☐
SINGLE ZONE ☒ MULTIPLE ZONE ☐

2. NAME OF OPERATOR
TEXACO EXPLORATION AND PRODUCTION INC.

3. ADDRESS OF OPERATOR
P.O. Box 3109, Midland, TX 79702

4. LOCATION OF WELL (Report location clearly and in accordance with any State requirements.)*
At surface
990' FNL & 330' FEL, UNIT LETTER A, NE/NE
At proposed prod. zone
SAME AS SURFACE

5. LEASE DESIGNATION AND SERIAL NO.
SF 079602

6. IF INDIAN, ALLOTTEE OR TRIBE NAME

7. UNIT AGREEMENT NAME

8. FARM OR LEASE NAME
L.L. McCONNELL

9. WELL NO.
16

10. FIELD AND POOL, OR WILDCAT
W.LINDRITH, GALLUP-DAKOTA

11. SEC., T., R., M., OR BLK. AND SURVEY OR AREA
A SEC. 29, T-25-N, R-3-W

12. COUNTY OR PARISH
RIO ARriba

13. STATE
NM

14. DISTANCE IN MILES AND DIRECTION FROM NEAREST TOWN OR POST OFFICE*
9.5 MILES NORTHWEST OF LINDRITH, NM

15. DISTANCE FROM PROPOSED* LOCATION TO NEAREST PROPERTY OR LEASE LINE, FT. (Also to nearest drig. unit line, if any)
330'

16. NO. OF ACRES IN LEASE
1935.29

17. NO OF ACRES ASSIGNED TO THIS WELL
160

18. DISTANCE FROM PROPOSED LOCATION* TO NEAREST WELL, DRILLING, COMPLETED, OR APPLIED FOR, ON THIS LEASE, FT.
4167'

19. PROPOSED DEPTH
8450'

20. ROTARY OR CABLE TOOLS
ROTARY

21. ELEVATIONS (Show Whether DF, RT, GR, ETC.)
GR-7322'

22. APPROX. DATE WORK WILL START
JULY 12, 1993

23. PROPOSED CASING AND CEMENTING PROGRAM

SIZE OF HOLE	SIZE OF CASING	WEIGHT PER FOOT	SETTING DEPTH	QUANTITY OF CEMENT
12 1/4	8 5/8	24#	450'	400 SACKS
7 7/8	5 1/2	17#	8450'	3210 SACKS

SEE ATTACHED DRILLING PROGRAM FOR CEMENTING AND MUD PROGRAMS.

THERE ARE NO OTHER OPERATORS IN THIS QUARTER QUARTER SECTION.

RECEIVED
SEP 13 1993
OIL CON. DIV.
DIST. 3

IN ABOVE SPACE DESCRIBE PROPOSED PROGRAM: If proposal is to deepen or plug back, give data on present productive zone and proposed new productive zone. If proposal is to drill or deepen directionally, give pertinent data on subsurface locations and measured and true vertical depths. Give blowout preventer program, if any.

24.

SIGNED C.P. Basham / cwm TITLE DRILLING OPERATIONS MANAGER DATE 06-21-93

(This space for Federal or State office use)

PERMIT NO. SHIRLEY MONDY APPROVAL DATE Acting AREA MANAGER

APPROVED BY SHIRLEY MONDY TITLE RIO PUERCO RESOURCE AREA DATE SEP 10 1993
CONDITIONS OF APPROVAL, IF ANY:

*See Instructions On Reverse Side

NMOCD

Submit to Appraiser
District Office
State Lease - 4 copies
Fee Lease - 3 copies

State of New Mexico
Energy, Minerals and Natural Resources Department

Form C-102
Revised 1-1-89

OIL CONSERVATION DIVISION

DISTRICT I
P.O. Box 1980, Hobbs, NM 88240

P.O. Box 2088

Santa Fe, New Mexico 87504-2088

DISTRICT II
P.O. Drawer DD, Artesa, NM 88210

DISTRICT III
1000 Rio Arriba Rd., Aztec, NM 87410

WELL LOCATION AND ACREAGE DEDICATION PLAT

All Distances must be from the outer boundaries of the section

Operator		Lease		Well No.	
Texaco Exploration and Production Inc.		L.L. McConnell		16	
Unit Lease	Section	Township	Range	County	
A	29	25 North	3 West	Rio Arriba	
Actual Footage Location of Well:					
990	feet from the	North	line and	330	feet from the
East					line
Ground Level Elev.	Producing Formation		Pool	Dedicated Acreage	
7322'	Gallup - Dakota		West Lindrith, Gallup - Dakota	160 Acres	

- Outline the acreage dedicated to the subject well by colored pencil or ink on the plat below.
- If more than one lease is dedicated to the well, outline each and identify the ownership thereof (both as to working interest and royalty).
- If more than one lease of different ownership is dedicated to the well, have the interest of all owners been consolidated by commutation, unitization, force-pooling, etc.?
☐ Yes ☐ No If answer is "yes" type of consolidation:
If answer is "no" list the owners and tract descriptions which have actually been consolidated. (Use reverse side of this form if necessary.)
No allowable will be assigned to the well until all interests have been consolidated (by commutation, unitization, force-pooling, or otherwise) or until a non-standard unit, eliminating such interest, has been approved by the Division.

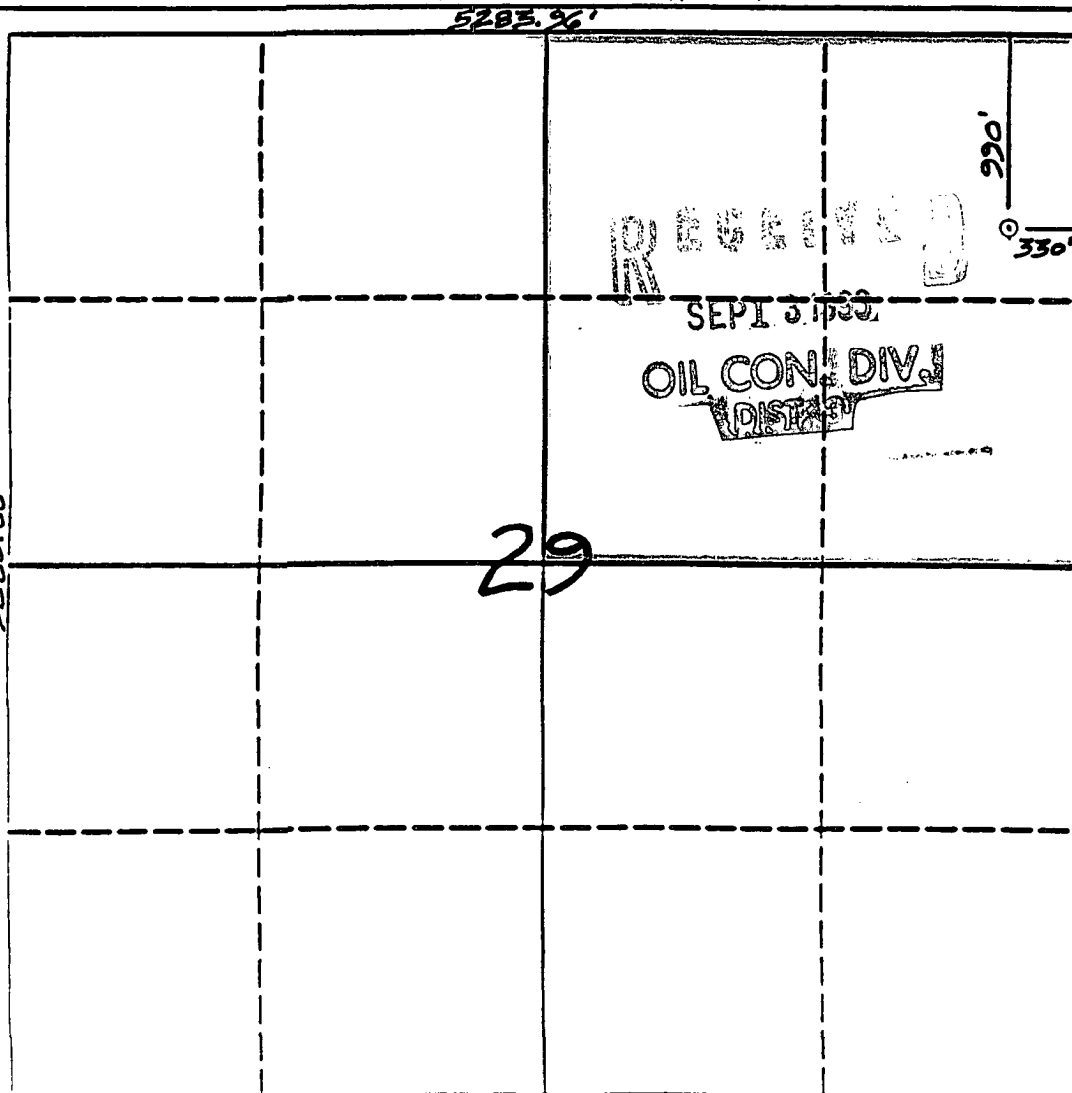

OPERATOR CERTIFICATION

I hereby certify that the information contained herein is true and complete to the best of my knowledge and belief.

Signature: *Royce Mariott*
Printed Name: Royce Mariott
Position: Division Surveyor
Company: Texaco E&P Inc.
Date: June 17, 1993

SURVEYOR CERTIFICATION

I hereby certify that the well location shown on this plat was plotted from field notes of actual surveys made by me or under my supervision, and that the same is true and correct to the best of my knowledge and belief. 6-1-93

Date Surveyed: *C. EDWARDS*
Name: *C. EDWARDS*
Signature: *C. EDWARDS*
Professional Surveyor
9857
Carrollton No. 6857