

(SUBMIT IN TRIPLICATE)

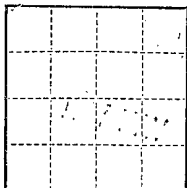

UNITED STATES

DEPARTMENT OF THE INTERIOR
GEOLOGICAL SURVEY

Indian Agency Navajo Tribal

Window Rock, Arizona

Allottee KAYASYAH

Lease No. 14-20-603-779

SUNDRY NOTICES AND REPORTS ON WELLS

NOTICE OF INTENTION TO DRILL.....	<input checked="" type="checkbox"/>	SUBSEQUENT REPORT OF WATER SHUT-OFF.....
NOTICE OF INTENTION TO CHANGE PLANS.....		SUBSEQUENT REPORT OF SHOOTING OR ACIDIZING.....
NOTICE OF INTENTION TO TEST WATER SHUT-OFF.....		SUBSEQUENT REPORT OF ALTERING CASING.....
NOTICE OF INTENTION TO REDRILL OR REPAIR WELL.....		SUBSEQUENT REPORT OF REDRILLING OR REPAIR.....
NOTICE OF INTENTION TO SHOOT OR ACIDIZE.....		SUBSEQUENT REPORT OF ABANDONMENT.....
NOTICE OF INTENTION TO PULL OR ALTER CASING.....		SUPPLEMENTARY WELL HISTORY.....
NOTICE OF INTENTION TO ABANDON WELL.....		

(INDICATE ABOVE BY CHECK MARK NATURE OF REPORT, NOTICE, OR OTHER DATA)

KAYASYAH

Farmington, New Mexico May 12, 19 57

Well No. 1 is located 040 ft. from N line and 1700 ft. from W line of sec. 25

NE/4 of Section 25

T-28-N

R-9-W

T 1 N 1 E

(1/4 Sec. and Sec. No.)

(Twp.)

(Range)

(Meridian)

South Blanco-Pictured Cliffs

San Juan

New Mexico

(Field)

(County or Subdivision)

(State or Territory)

The elevation of the derrick floor above sea level is ft. (To be reported later.)

DETAILS OF WORK

(State names of and expected depths to objective sands; show sizes, weights, and lengths of proposed casings; indicate mudding jobs, cementing points, and all other important proposed work)

We propose to drill the above well to a total depth of approximately 2300' with production anticipated from the Pictured Cliffs formation. Rotary tool bit will be used to total depth.

The proposed casing program is as follows.

SIZE	AMOUNT	COMMENT
8-5/8	140'	Circulate to surface.
5-1/2	2300'	100 Sacks

Copies of location plat are attached. Upon completion of this well copies of all logs taken will be forwarded.

Verbal approval Long to Panor.

I understand that this plan of work must receive approval in writing by the Geological Survey before operations may be commenced.

Company Pan American Petroleum Corporation

Address Box 487

Farmington, New Mexico

By

Title Field Superintendent

NEW MEXICO
OIL CONSERVATION COMMISSION

Form C-128

WELL LOCATION AND/OR GAS PRORATION PLAT

DATE MAY 7, 1957

OPERATOR PAN AMERICAN PETROLEUM CORP. NAME KAYASYAHI

WELL NO. 1 SECTION 25 TOWNSHIP 28 NORTH RANGE 9 WEST NMPM

LOCATED 840 FEET FROM the NORTH LINE 1700 FEET FROM the EAST LINE

SAN JUAN

COUNTY, NEW MEXICO

DATE OF INFORMATION TO BE REPORTED LATER

NAME OF PRODUCING FORMATION PICTURE CLIFF POOL CLIFFS DEDICATED ACREAGE 160

Note: All distances must be from outer boundaries of section.

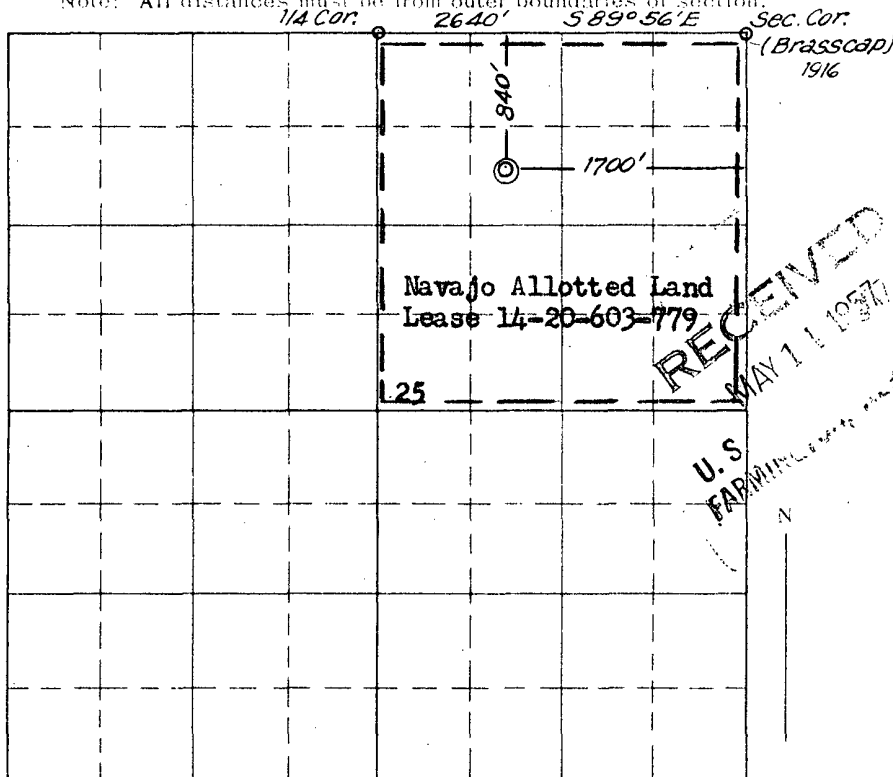

Scale 4 inches equal 1 mile

NOTE

This section of
form is to be used
for gas wells only

This is to certify that the above plat was prepared from
field notes of actual surveys made by me or under my
supervision and that the same are true and correct to the
best of my knowledge and belief.

Date Surveyed 4 MAY 1957

James P. Leese
Registered Professional Engineer and/or Land Surveyor
JAMES P. LEESE
N. MEX. REG. No. 1463



Farmington, New Mexico

1. Is this well a Dual Comp.
Yes _____ No X
2. If the answer to Question 1
is yes, are there any otherdually
completed wells within the
dedicated acreage.
Yes _____
Name R. M. BAUER, JR.

Position FIELD ENGINEER

PAN AMERICAN PETROLEUM CORPORATION

Representing _____

BOX 487, FARMINGTON, NEW MEXICO

Address _____