

(SUBMIT IN TRIPLICATE)

UNITED STATES  
DEPARTMENT OF THE INTERIOR  
GEOLOGICAL SURVEY

Land Office Santa Fe  
Lease No. 07711  
Unit Storey

MAIN OFFICE REC  
APR 10 AM 8:51

## SUNDRY NOTICES AND REPORTS ON WELLS

NOTICE OF INTENTION TO DRILL	<input checked="" type="checkbox"/>	SUBSEQUENT REPORT OF WATER SHUT-OFF	
NOTICE OF INTENTION TO CHANGE PLANS		SUBSEQUENT REPORT OF SHOOTING OR ACIDIZING	
NOTICE OF INTENTION TO TEST WATER SHUT-OFF		SUBSEQUENT REPORT OF ALTERING CASING	
NOTICE OF INTENTION TO RE-DRILL OR REPAIR WELL		SUBSEQUENT REPORT OF RE-DRILLING OR REPAIR	
NOTICE OF INTENTION TO SHOOT OR ACIDIZE		SUBSEQUENT REPORT OF ABANDONMENT	
NOTICE OF INTENTION TO PULL OR ALTER CASING		SUPPLEMENTARY WELL HISTORY	
NOTICE OF INTENTION TO ABANDON WELL			

(INDICATE ABOVE BY CHECK MARK NATURE OF REPORT, NOTICE, OR OTHER DATA)

April 4

19 57

Well No. 7-C (24) is located 690 ft. from [N] line and 1750 ft. from [E] line of sec. 27NE Section 27

(1/4 Sec. and Sec. No.)

28S

(Twp.)

9N

(Range)

N.M.P.M.

(Meridian)

Aztec P.C. Bkt. & Blanco

(Field)

San Juan

(County or Subdivision)

New Mexico

(State or Territory)

The elevation of the derrick floor above sea level is 6834 ft.

## DETAILS OF WORK

(State names of and expected depths to objective sands; show sizes, weights, and lengths of proposed casings; indicate mudding jobs, cementing points, and all other important proposed work)

It is intended to drill & dual complete a well in the Pictured Cliffs formation & Mesa Verde formation. Mud circulation will be used thru the Pictured Cliffs formation & set intermediate casing. Gas circulation will be used thru the Mesa Verde & a production liner will be set. Possible productive intervals will be perforated & fractured. Estimated Total Depth 5475'.

## Casing Program:

10-3/4" at 170' with 125 sacks cement circulated to the surface.

7-5/8" at 5210' with 250 sacks cement.

5-1/2" liner at 5475' with 300 sacks cement.

The E/2 of Section 27 is dedicated to the Mesa Verde.

The NE/4 of Section 27 is dedicated to the Pictured Cliffs.

E/2 and NE/4, SF 07711

I understand that this plan of work must receive approval in writing by the Geological Survey before operations may be commenced.

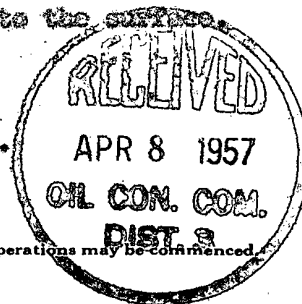
Company El Paso Natural Gas CompanyAddress Box 997Farmington, New MexicoBy Original Signed EWELL N. WALSHTitle Petroleum Engineer

WELL LOCATION AND/OR GAS PRORATION PLAT

DATE APRIL 3, 1957

OPERATOR EL PASO NATURAL GAS COMPANY LEASE STOREY SF 077111

WELL NO. 7-C (PM) SECTION 27 TOWNSHIP 28 N RANGE 9 W NMPM

LOCATED 890 FEET FROM NORTH LINE 1750 FEET FROM EAST LINE

SAN JUAN COUNTY, NEW MEXICO C.L. ELEVATION 6824.12

NAME OF PRODUCING FORMATION P.C. & M.V. POOL AZTEC P.C. EXT. 160 AC. PC  
DEDICATED ACREAGE 320 AC MV  
(1919 PLAT)

Note: All distances must be from outer boundaries of section.

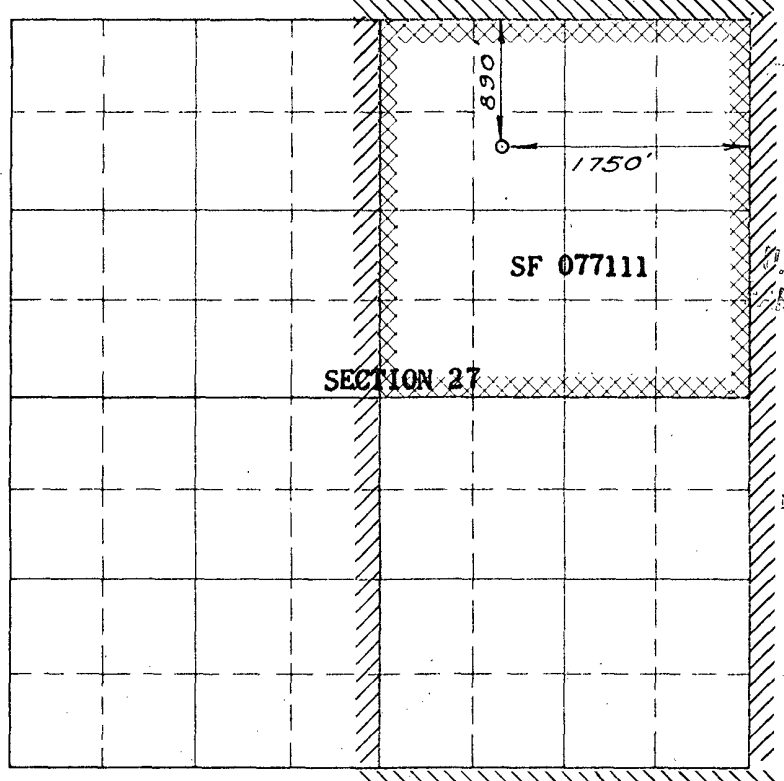

Scale 4 inches equal 1 mile

RECEIVED  
APR 5 1957  
S. GEOLOGICAL SURVEY

NOTE

This section of  
form is to be used  
for gas wells only

This is to certify that the above plat was prepared from  
field notes of actual surveys made by me or under my  
supervision and that the same are true and correct to the  
best of my knowledge and belief.

Date Surveyed MARCH 4, 1957

E. O. Walker  
Registered Professional Engineer and/or Land Surveyor



1. Is this well a Dual Comp.  
Yes X No \_\_\_\_\_
2. If the answer to Question 1  
is yes, are there any other dually  
completed wells within the  
dedicated acreage.  
Yes \_\_\_\_\_ No X

Name Original Signed EWELL N. WALSH

Position Petroleum Engineer

Representing El Paso Natural Gas

Address Box 277 - Farmington, N.M.