

(SUBMIT IN TRIPLICATE)

UNITED STATES
DEPARTMENT OF THE INTERIOR
GEOLOGICAL SURVEY

Land Office New Mexico
Lease No. 03541
Unit Hancock

RECEIVED

SUNDRY NOTICES AND REPORTS ON WELLSAR24 1958

U. S. GEOLOGICAL SURVEY	
NOTICE OF INTENTION TO DRILL.....	<input checked="" type="checkbox"/> SUBSEQUENT REPORT OF WATER SHUT-OFF.....
NOTICE OF INTENTION TO CHANGE PLANS.....	SUBSEQUENT REPORT OF SHOOTING OR ACIDIZING.....
NOTICE OF INTENTION TO TEST WATER SHUT-OFF.....	SUBSEQUENT REPORT OF ALTERING CASING.....
NOTICE OF INTENTION TO RE-DRILL OR REPAIR WELL.....	SUBSEQUENT REPORT OF RE-DRILLING OR REPAIR.....
NOTICE OF INTENTION TO SHOOT OR ACIDIZE.....	SUBSEQUENT REPORT OF ABANDONMENT.....
NOTICE OF INTENTION TO PULL OR ALTER CASING.....	SUPPLEMENTARY WELL HISTORY.....
NOTICE OF INTENTION TO ABANDON WELL.....	

(INDICATE ABOVE BY CHECK MARK NATURE OF REPORT, NOTICE, OR OTHER DATA)

March 21, 19 58

Well No. 2 (FM) is located 1650 ft. from N line and 800 ft. from E line of sec. 29

SW Sec. 29 28N 9E N.M.P.M.
(1/4 Sec. and Sec. No.) (Twp.) (Range) (Meridian)
Blanco M. V. - Aztec P. C. San Juan New Mexico
(Field) (County or Subdivision) (State or Territory)

The elevation of the derrick floor above sea level is 5955 ft.

DETAILS OF WORK

(State names of and expected depths to objective sands; show sizes, weights, and lengths of proposed casings; indicate mudding jobs, cementing points, and all other important proposed work)

It is intended to drill & dual complete a well in the Pictured Cliffs formation & Mesa Verde formation. Mud circulation will be used thru the Pictured Cliffs formation & set intermediate casing. Gas circulation will be used thru the Mesa Verde & a production liner will be set. Possible productive intervals will be perforated & fractured. Estimated Total Depth 4589'.

Casing Program:

10 3/4" at 170' with 125 sacks cement circulated to the surface.

7 5/8" at 3849' with 250 sacks cement.

5 1/2" liner at 4589' with 300 sacks cement.

The SW/4 of Section 29 is dedicated to the Mesa Verde.

The S/2 of Section 29 is dedicated to the Pictured Cliffs

S/2: N.M. 03541

I understand that this plan of work must receive approval in writing by the Geological Survey before operations may be commenced.

Company El Paso Natural Gas Company

Address Box 997

Farmington, New Mexico

By Original Signed D. C. Johnston

Title Petroleum Engineer



NEW MEXICO OIL CONSERVATION COMMISSION

Well Location and Acreage Dedication Plat

Section A.

Date MARCH 17, 1958

Operator EL PASO NATURAL GAS COMPANY Lease HANCOCK NM 03541
 Well No. 2 (RM) Unit Letter L Section 29 Township 28-N Range 9-W NMPM
 Located 1650 Feet From SOUTH Line, 800 Feet From WEST Line
 County, SAN JUAN G. L. Elevation 5945 Dedicated Acreage 320 & 160 Acres
 Name of Producing Formation MESA VERDE & PICTURED CLIFF Pool BLANCO MV, AZTEC PC

1. Is the Operator the only owner in the dedicated acreage outlined on the plat below?
 Yes ☒ No ☐
2. If the answer to question one is "no", have the interests of all the owners been consolidated by communization agreement or otherwise? Yes ☐ No ☐ If answer is "yes", Type of Consolidation.
3. If the answer to question two is "no", list all the owners and their respective interests below:

Owner

Land Description



RECEIVED
 MAR 24 1958
 U. S. GEOLOGICAL SURVEY
 FARMINGTON, NEW MEXICO

Section B.

Note: All distances must be from outer boundaries of section.

This is to certify that the information in Section A above is true and complete to the best of my knowledge and belief.

El Paso Natural Gas CompanyOriginal Signed D. C. Johnston

(Representative)

Box 997

(Address)

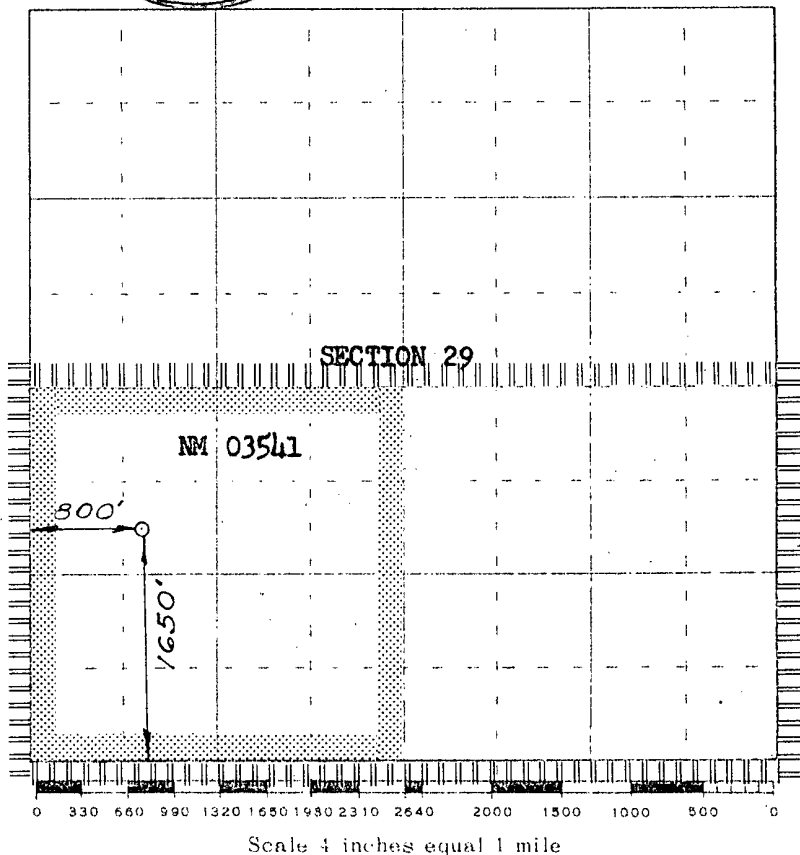
Farmington, New Mexico

This is to certify that the above plat was prepared from field notes of actual surveys made by me or under my supervision and that the same are true and correct to the best of my knowledge and belief.

(Seal)

Date Surveyed FEBRUARY 5, 1958

David O. Kilmer
 Registered Professional Engineer and/or Land Surveyor

Farmington, New Mexico