

UNITED STATES
DEPARTMENT OF THE INTERIOR
BUREAU OF LAND MANAGEMENT

RCVD APR 7 '08
OIL CONS. DIV.
DIST. 3

APPLICATION FOR PERMIT TO DRILL, DEEPEN, OR PLUG BACK

1a. Type of Work DRILL	RECEIVED MAR 12 2008	5. Lease Number USA SF-078266 Unit Reporting Number
1b. Type of Well GAS	Bureau of Land Management Farmington Field Office	6. If Indian, All. or Tribe
2. Operator BURLINGTON RESOURCES Oil & Gas Company, LP	7. Unit Agreement Name	
3. Address & Phone No. of Operator PO Box 4289, Farmington, NM 87499 (505) 326-9700	8. Farm or Lease Name Wood 9. Well Number #3M	
4. Location of Well Surf: Unit I (NESE), 1675' FSL & 1075' FEL Surf: Latitude 36.72359° N Longitude 107.90281° W	10. Field, Pool, Wildcat Basin DK/Blanco MV 11. Sec., Twn, Rge, Mer. (NMPM) Sec. 17, T29N, R10W API # 30-045-34632	
14. Distance in Miles from Nearest Town 6 miles/Bloomfield	12. County San Juan	13. State NM
15. Distance from Proposed Location to Nearest Property or Lease Line 1075'		
16. Acres in Lease 670.160	17. Acres Assigned to Well 305.68 Acres - (E/2)	
18. Distance from Proposed Location to Nearest Well, Drig, Compl, or Applied for on this Lease 1110' from San Juanito #1 - FC		
19. Proposed Depth 6691'	20. Rotary or Cable Tools Rotary	
21. Elevations (DF, FT, GR, Etc.) 5785' GR	22. Approx. Date Work will Start	
23. Proposed Casing and Cementing Program See Operations Plan attached	 H ₂ S POTENTIAL EXIST	
24. Authorized by: <u>Crystal Walker</u> Crystal Walker (Regulatory Technician)	3/12/08 Date	

PERMIT NO.

APPROVAL DATE

APPROVED BY

TITLE

DATE

Archaeological Report attached

Threatened and Endangered Species Report attached

NOTE: This format is issued in lieu of U.S. BLM Form 3160-3

Title 18 U.S.C. Section 1001, makes it a crime for any person knowingly and willfully to make to any department or agency of the United States any false, fictitious or fraudulent statements or presentations as to any matter within its jurisdiction.

Example Master Plan Type 3

Bond Numbers NMB-000015 and NMB-000089

This action is subject to technical and procedural review pursuant to 43 CFR 3165.3 and appeal pursuant to 43 CFR 3165.4

DRILLING OPERATIONS AUTHORIZED ARE SUBJECT TO COMPLIANCE WITH ATTACHED "GENERAL REQUIREMENTS".

APR 10 2008

NMOCD
AN

NOTIFY AZTEC OCD 24 HRS.
PRIOR TO CASING & CEMENT

BLM'S APPROVAL OR ACCEPTANCE OF THIS ACTION DOES NOT RELIEVE THE LESSEE AND OPERATOR FROM OBTAINING ANY OTHER AUTHORIZATION REQUIRED FOR OPERATIONS ON FEDERAL AND INDIAN LANDS

DISTRICT I
1625 N. French Dr., Hobbs, N.M. 88240

State of New Mexico
Energy, Minerals & Natural Resources Department

Form C-102
Revised October 12, 2005

DISTRICT II
1301 W. Grand Avenue, Artesia, N.M. 88210

DISTRICT III
1000 Rio Brazos Rd., Aztec, N.M. 87410

DISTRICT IV
1220 S. St. Francis Dr., Santa Fe, NM 87505

OIL CONSERVATION DIVISION
1220 South St. Francis Dr.
Santa Fe, NM 87505

Submit to Appropriate District Office
State Lease - 4 Copies
Fee Lease - 3 Copies

MAR 12 2008

☐ AMENDED REPORT

WELL LOCATION AND ACREAGE DEDICATION PLAT

¹ API Number 30-045- 34632	² Pool Code 71599/72319	³ Pool Name BASIN DAKOTA, BLANCO MESA VERDE
⁴ Property Code 727616, 725977	⁵ Property Name WOOD	⁶ Well Number 3 M
⁷ GRID No. 14538	⁸ Operator Name BURLINGTON RESOURCES OIL AND GAS COMPANY LP	⁹ Elevation 5785'

¹⁰ Surface Location

UL or lot no.	Section	Township	Range	Lot Idn	Feet from the	North/South line	Feet from the	East/West line	County
I	17	29N	10W	(9)	1675'	SOUTH	1075'	EAST	SAN JUAN

¹¹ Bottom Hole Location If Different From Surface

UL or lot no.	Section	Township	Range	Lot Idn	Feet from the	North/South line	Feet from the	East/West line	County
I									
¹² Dedicated Acres 305.68 Acres - (E/2)			¹³ Joint or Infill		¹⁴ Consolidation Code		¹⁵ Order No.		

NO ALLOWABLE WILL BE ASSIGNED TO THIS COMPLETION UNTIL ALL INTERESTS HAVE BEEN CONSOLIDATED
OR A NON-STANDARD UNIT HAS BEEN APPROVED BY THE DIVISION

16

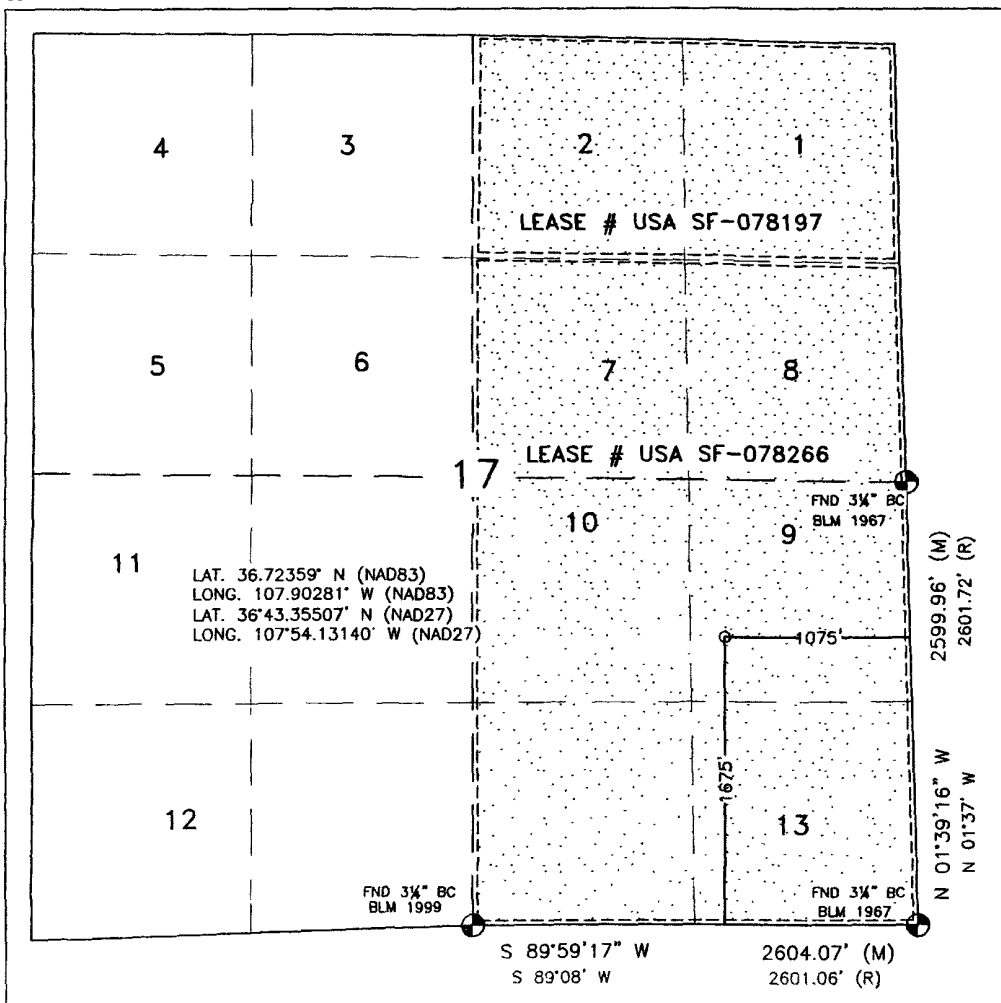

17 OPERATOR CERTIFICATION

I hereby certify that the information contained herein is true and complete to the best of my knowledge and belief, and that this organization either owns a working interest or unleased mineral interest in the land including the proposed bottom hole location or has a right to drill this well at this location pursuant to a contract with an owner or a compulsory pooling order heretofore entered by the division.

Crystal Walker 3/12/08
Signature Date

Crystal Walker 3-12-08
Printed Name

18 SURVEYOR CERTIFICATION

I hereby certify that the well location shown on this plat was plotted from field notes of actual surveys made by me or under my supervision, and that the same is true and correct to the best of my belief.

SEPTEMBER 26, 2007

Date of Survey

Signature and Seal of Professional Surveyor:

David R. Russell

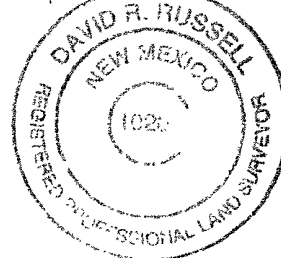

DAVID RUSSELL

Certificate Number 10201

District I

1625 N. French Dr., Hobbs, NM 88240

District II

1301 W. Grand Ave., Artesia, NM 88210

District III

1000 Rio Brazos Rd., Aztec, NM 87410

District IV

1220 S. St. Francis Dr., Santa Fe, NM 87505

Energy, Minerals and Natural Resources

OIL CONSERVATION DIVISION

1220 South St. Francis Dr.

Santa Fe, NM 87505

May 27, 2004

WELL API NO.	30-045- 34632
5. Indicate Type of Lease	STATE <input type="checkbox"/> FEE <input type="checkbox"/>
6. State Oil & Gas Lease No.	USA SF-078266
7. Lease Name or Unit Agreement Name	Wood
8. Well Number	3M
9. OGRID Number	14538
10. Pool name or Wildcat	Basin DK/Blanco MV

SUNDRY NOTICES AND REPORTS ON WELLS
(DO NOT USE THIS FORM FOR PROPOSALS TO DRILL OR TO DEEPEN OR PLUG BACK TO A DIFFERENT RESERVOIR. USE "APPLICATION FOR PERMIT" (FORM C-101) FOR SUCH PROPOSALS.)

1. Type of Well:
Oil Well ☐ Gas Well ☒ Other

2. Name of Operator
BURLINGTON RESOURCES OIL & GAS COMPANY LP

3. Address of Operator
3401 E. 30TH STREET, FARMINGTON, NM 87402

4. Well Location
Unit Letter I : 1675' feet from the South line and 1075' feet from the East line
Section 17 Township 29N Range 10W NMPM County San Juan

11. Elevation (Show whether DR, RKB, RT, GR, etc.)
5785'

Pit or Below-grade Tank Application ☐ or Closure ☐

Pit type New Drill Depth to Groundwater >100' Distance from nearest fresh water well >1000' Distance from nearest surface water >1000'

Pit Liner Thickness: 12 mil Below-Grade Tank: Volume bbls; Construction Material

12. Check Appropriate Box to Indicate Nature of Notice, Report or Other Data

NOTICE OF INTENTION TO:

PERFORM REMEDIAL WORK	<input type="checkbox"/>	PLUG AND ABANDON	<input type="checkbox"/>
TEMPORARILY ABANDON	<input type="checkbox"/>	CHANGE PLANS	<input type="checkbox"/>
PULL OR ALTER CASING	<input type="checkbox"/>	MULTIPLE COMPL	<input type="checkbox"/>
OTHER:	<input checked="" type="checkbox"/> New Drill		

SUBSEQUENT REPORT OF:

REMEDIAL WORK	<input type="checkbox"/>	ALTERING CASING	<input type="checkbox"/>
COMMENCE DRILLING OPNS.	<input type="checkbox"/>	P AND A	<input type="checkbox"/>
CASING/CEMENT JOB	<input type="checkbox"/>		
OTHER:	<input type="checkbox"/>		

13. Describe proposed or completed operations. (Clearly state all pertinent details, and give pertinent dates, including estimated date of starting any proposed work). SEE RULE 1103. For Multiple Completions: Attach wellbore diagram of proposed completion or recompletion.

New Drill, Lined:

Burlington Resources proposes to construct a new drilling pit and an associated vent/flare pit. Based on Burlington's interpretation of the Ecosphere's risk ranking criteria, the new drilling pit will be a lined pit as detailed in Burlington's Revised Drilling / Workover Pit Construction / Operation Procedures dated November 11, 2004 on file at the NMOCD office. A portion of the vent/flare pit will be designed to manage fluids and that portion will be lined as per the risk ranking criteria. Burlington Resources anticipates closing these pits according to the Drilling / Workover Pit Closure Procedure dated August 2, 2004 on file at the NMOCD office

I hereby certify that the information above is true and complete to the best of my knowledge and belief. I further certify that any pit or below-grade tank has been/will be constructed or closed according to NMOCD guidelines ☐, a general permit ☒ or an (attached) alternative OCD-approved plan ☐.

SIGNATURE Sasha Spangler TITLE Regulatory Technician DATE 12/13/2007

Type or print name Sasha Spangler E-mail address: spangs@concoPhillips.com Telephone No. 505-326-9568

APPROVED BY [Signature] TITLE Deputy Oil & Gas Inspector, DATE APR 10 2008
Conditions of Approval (if any): District #3



PROFESSIONAL ENGINEER
STATE OF NEW MEXICO
EXPIRATION DATE 12/31/2007

CATHODIC PROTECTION PLAN FOR NEW WELLS

WELL NAME Wood #3M LEGALS I-17-29-10 COUNTY Santa Fe

PURPOSED C.P. SYSTEM: Drill G.B. and set rectifier on W edge of location (S side of access) Trench approx 1250' of A/C from existing rectifier on Wood #3 to new rectifier.
Trench approx 160' of #8 neg. from proposed well to rectifier.

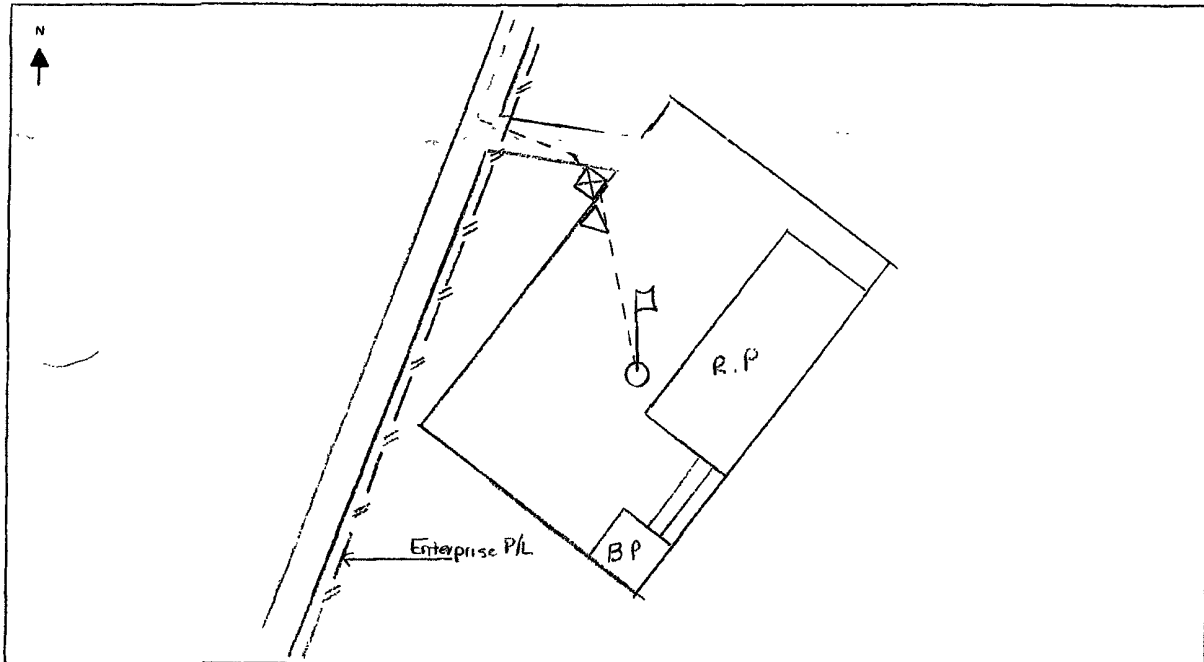

EXISTING WELLHEAD	METER HOUSE	G.B.	POWER SOURCE	CABLE	NEW WELL	OVERHEAD A.C.

COMMENTS: _____

NEAREST POWER SOURCE Existing Rect Wood #3 DISTANCE: 1250'

PIPELINES IN AREA: Enterprise P/L

TECHNICIAN: Michelle Hinojosa DATE: 10/22/07

6 CR 5412 BLOOMFIELD, N.M. 87413
OFFICE: 505-634-0271 CELL: 505-793-6953

*Twinn with
Wood 3M?*

RS?

PROJECT PROPOSAL - New Drill / Sidetrack

San Juan Business Unit

WOOD 3M

DEVELOPMENT

Lease:		AFE #: WAN.CDR.7299		AFE \$:	
Field Name: hBR_SAN JUAN		Rig: H&P Rig 283		State: NM	County: SAN JUAN
Geologist:		Phone:		Geophysicist:	
Geoscientist: Riley, Brook		Phone: +1 505-324-6108		Prod. Engineer:	
Res. Engineer: McKee, Cory J		Phone: 505-326-9826		Proj. Field Lead:	

Primary Objective (Zones):

Zone	Zone Name
FRR	BASIN DAKOTA (PRORATED GAS)
RON	BLANCO MESAVERDE (PRORATED GAS)

Location: Datum Code: NAD 27

Latitude: 36.723585	Longitude: -107.902190	X:	Y:	Section: 17	Range: 010W
Footage X: 1075 FEL	Footage Y: 1675 FSL	Elevation: 5785 (FT)	Township: 029N		
Tolerance:					

Location Type: Year Round	Start Date (Est.): 1/1/2009	Completion Date:	Date In Operation:
---------------------------	-----------------------------	------------------	--------------------

Formation Data: Assume KB = 5797 Units = FT

Formation Call & Casing Points	Depth (TVD in Ft)	SS (Ft)	Depletion (Yes/No)	BHP (PSIG)	BHT	Remarks
Total Depth	0	5797	<input type="checkbox"/>			
Surface Casing	200	5597	<input type="checkbox"/>			12-1/4 hole. 200' 9 5/8" 32.3 ppf, H-40, STC casing. Cement with 159 cuft. Circulate cement to surface.
OJO ALAMO	852	4945	<input type="checkbox"/>			
KIRTLAND	1029	4768	<input type="checkbox"/>			
FRUITLAND	1739	4058	<input type="checkbox"/>			Possible Gas
PICTURED CLIFFS	2099	3698	<input type="checkbox"/>			
LEWIS	2216	3581	<input type="checkbox"/>			
Intermediate Casing	2316	3481	<input type="checkbox"/>			8 3/4" Hole. 7", 20 ppf, J-55, STC Casing. Cement with 522 cuft. Circulate cement to surface.
HUERFANITO BENTONITE	2739	3058	<input type="checkbox"/>			
CHACRA	3106	2691	<input type="checkbox"/>			
MASSIVE CLIFF HOUSE	3769	2028	<input type="checkbox"/>	400	Gas	
MENESEE	3810	1987	<input type="checkbox"/>			
MASSIVE POINT LOOKOUT	4432	1365	<input type="checkbox"/>			
MANCOS	4781	1016	<input type="checkbox"/>			
UPPER GALLUP	5632	165	<input type="checkbox"/>			
GREENHORN	6381	-584	<input type="checkbox"/>			
GRANEROS	6438	-641	<input type="checkbox"/>			
TWO WELLS	6496	-699	<input type="checkbox"/>	1150	Gas	
PAGUATE	6544	-747	<input type="checkbox"/>			
CUBERO	6601	-804	<input type="checkbox"/>			
ENCINAL	6651	-854	<input type="checkbox"/>			
TOTAL DEPTH DK	6691	-894	<input type="checkbox"/>			6-1/4" Hole. 4-1/2", 10.6/11.6 ppf, J-55 STC/LTC casing. Cement with 595 cuft. Circulate cement a minimum of 100' inside the previous casing string.

Reference Wells:

Reference Type	Well Name	Comments
Production	State B Gas COM #1 (SW Sec 16)	

PROJECT PROPOSAL - New Drill / Sidetrack

San Juan Business Unit

WOOD 3M

DEVELOPMENT

Production	Hubbell 5 (17-1) SW17-29N-10W
------------	-------------------------------

Logging Program:

Intermediate Logs: ☐ Log only if show ☐ GR/ILD ☐ Triple Combo

TD Logs: ☐ Triple Combo ☐ Dipmeter ☐ RFT ☐ Sonic ☐ VSP ☐ TDT ☒ Other

GR_CBL. Mudlogger begin 100 ft above Greenhorn. Mudlogger call TD. Encinal sand changing across section.

Additional Information:

Log Type	Stage	From (Ft)	To (Ft)	Tool Type/Name	Remarks
----------	-------	-----------	---------	----------------	---------

Comments:

LATITUDE: 36 72359°N
LONGITUDE: 107 90281°W
DATUM: NAD 83

SLOPES TO BE CONSTRUCTED TO
MATCH THE ORIGINAL CONTOURS
AS CLOSE AS POSSIBLE.

BURLINGTON RESOURCES O&G CO LP

WOOD #3 M

1675' FSL & 1075' FEL

LOCATED IN THE NE/4 SE/4 OF SECTION 17,

T29N, R10W, N.M.P.M.;

SAN JUAN COUNTY, NEW MEXICO

GROUND ELEVATION: 5785', NAVD 88

FINISHED PAD ELEVATION: 5787.0', NAVD 88

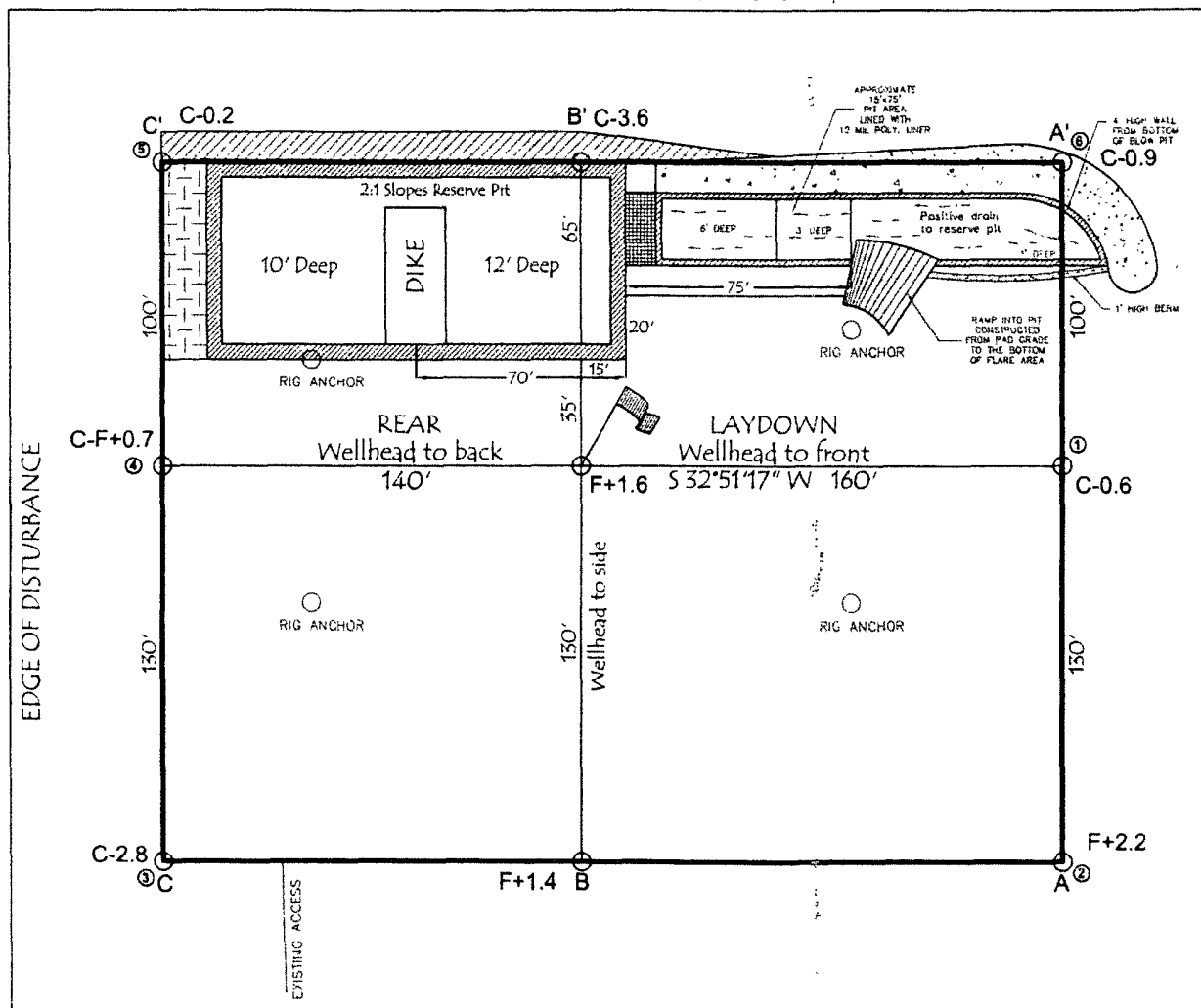
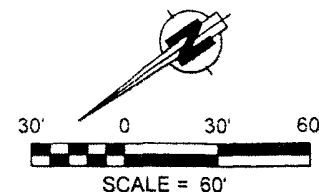

330' x 400' = 3.03 ACRES OF DISTURBANCE

SCALE: 1" = 60'

JOB No.: COPC113

DATE: 10/04/07

NOTE:

RESERVE PIT DIKE: TO BE 8' ABOVE DEEP SIDE (OVERFLOW - 3' WIDE AND 1' ABOVE SHALLOW SIDE).

RUSSELL SURVEYING, INC. IS NOT LIABLE FOR UNDERGROUND UTILITIES OR PIPELINES.

CONTRACTOR SHOULD CALL ONE-CALL FOR LOCATION OF ANY MARKED OR UNMARKED, BURIED PIPELINES OR CABLES ON WELL PAD, IN CONSTRUCTION ZONE AND/OR ACCESS ROAD AT LEAST TWO (2) WORKING DAYS PRIOR TO CONSTRUCTION.



Russell Surveying

1409 W. Aztec Blvd. #2

Aztec, New Mexico 87410

(505) 334-8637

BURLINGTON RESOURCES O&G CO LP

WOOD #3 M

1675' FSL & 1075' FEL

LOCATED IN THE NE/4 SE/4 OF SECTION 17.

T29N, R10W, N.M.P.M.,

SAN JUAN COUNTY, NEW MEXICO

GROUND ELEVATION: 5785', NAVD 88

FINISHED PAD ELEVATION: 5787.0', NAVD 88

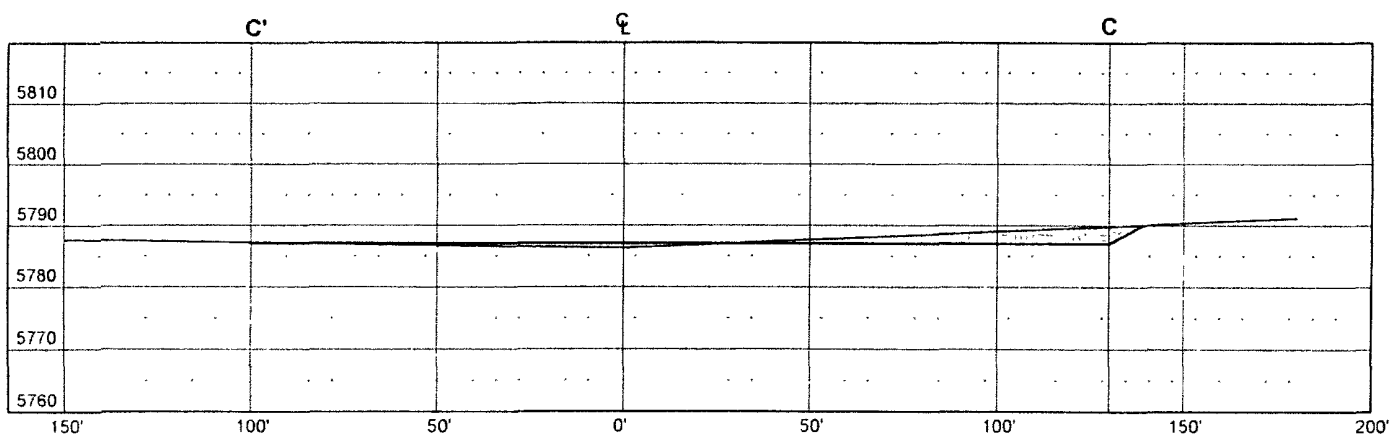
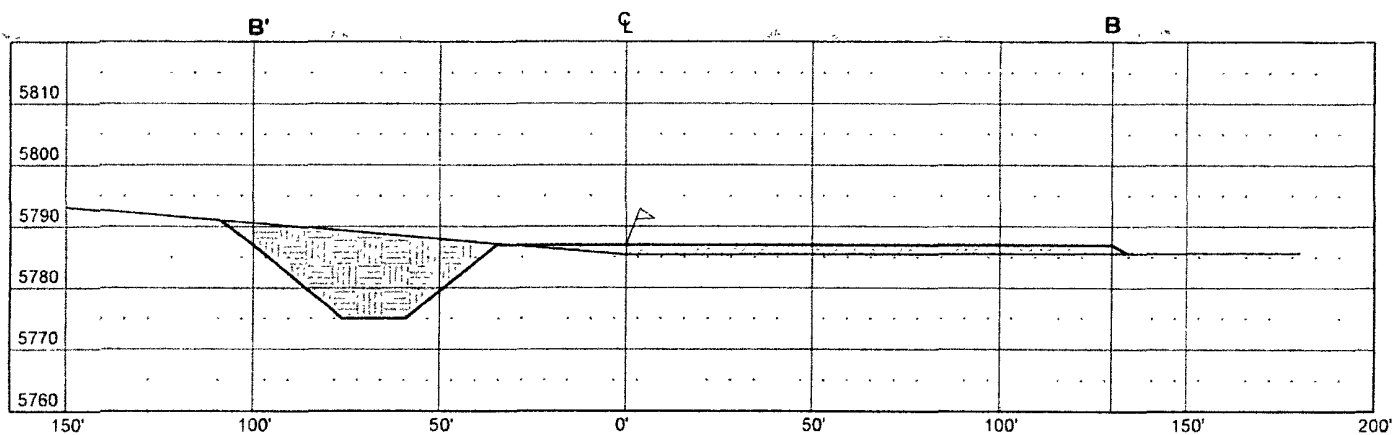
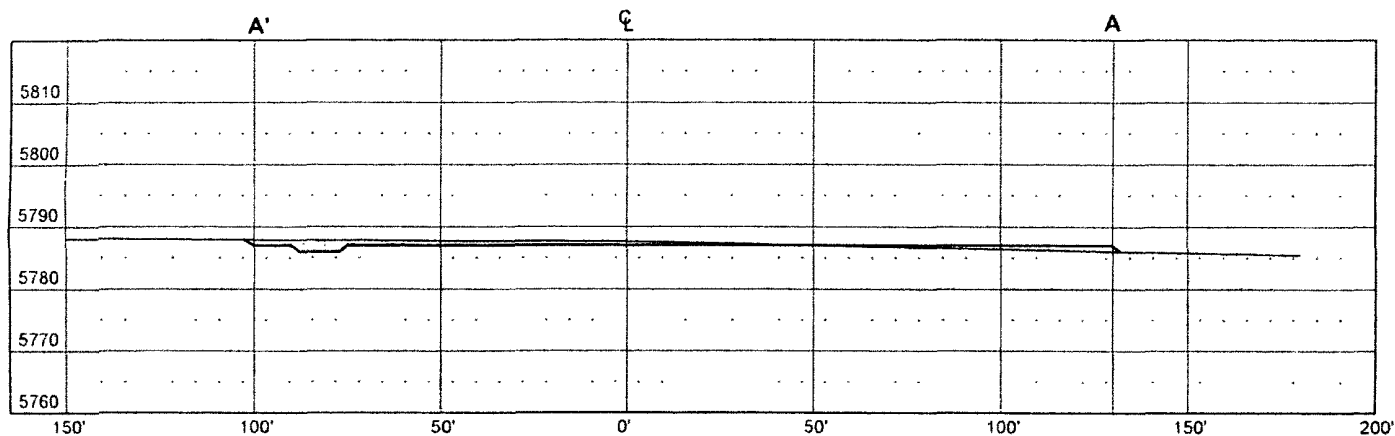

THIS DIAGRAM IS AN ESTIMATE OF DIRT BALANCE AND IS NOT INTENDED TO BE AN EXACT MEASURE OF VOLUME

VERT. SCALE: 1" = 30'
HORIZ. SCALE: 1" = 50'
JOB No.: COPC113
DATE: 10/04/07

 CUT

 FILL

~~RE~~

Russell Surveying
1409 W. Aztec Blvd. #2
Aztec, New Mexico 87410
(505) 334-8637