

District I
1625 N. French Dr , Hobbs, NM 88240
District II
1301 W Grand Avenue, Artesia, NM 88210
District III
1000 Rio Brazos Road, Aztec, NM 87410
District IV
1220 S. St. Francis Dr., Santa Fe, NM 87505

State of New Mexico
Energy Minerals and Natural Resources

Form C-144
June 1, 2004

Oil Conservation Division
1220 South St. Francis Dr.
Santa Fe, NM 87505

For drilling and production facilities, submit to appropriate NMOCD District Office.
For downstream facilities, submit to Santa Fe office

Pit or Below-Grade Tank Registration or Closure

Is pit or below-grade tank covered by a "general plan"? Yes ☐ No ☒

Type of action: Registration of a pit or below-grade tank ☐ Closure of a pit or below-grade tank ☒

Operator <u>D. J. Simmons, Inc.</u> Telephone: <u>(505) 326-3753</u> e-mail address: <u>cstarkey@djsimmons.com</u>		
Address <u>1009 Ridgeway Place, Suite 200, Farmington, New Mexico 87401</u>		
Facility or well name. <u>Blanco Wash 26 #1</u> API # <u>30-045-34119</u> U/L or Qtr/Qtr <u>K</u> Sec <u>26</u> T <u>24N</u> R <u>8W</u>		
County. <u>San Juan</u> Latitude <u>36 282968</u> Longitude <u>107.654759</u> NAD: 1927 <input type="checkbox"/> 1983 <input checked="" type="checkbox"/>		
Surface Owner Federal <input type="checkbox"/> State <input type="checkbox"/> Private <input type="checkbox"/> Indian <input checked="" type="checkbox"/>		
RCVD FEB 28 '08		
Pit Type: Drilling <input checked="" type="checkbox"/> Production <input type="checkbox"/> Disposal <input type="checkbox"/> Workover <input type="checkbox"/> Emergency <input type="checkbox"/> Lined <input checked="" type="checkbox"/> Unlined <input type="checkbox"/> Liner type. Synthetic <input checked="" type="checkbox"/> Thickness <u>12</u> mil Clay <input type="checkbox"/> Pit Volume <u>500</u> bbl	Below-grade tank Volume. <u> </u> bbl Type of fluid: <u> </u> Construction material <u> </u> Double-walled, with leak detection? Yes <input type="checkbox"/> If not, explain why not <u> </u>	OIL CONS. DIV. DIST. 3
Depth to ground water (vertical distance from bottom of pit to seasonal high water elevation of ground water.)	Less than 50 feet 50 feet or more, but less than 100 feet 100 feet or more	(20 points) (10 points) (0 points) 0 points
Wellhead protection area: (Less than 200 feet from a private domestic water source, or less than 1000 feet from all other water sources.)	Yes No <input checked="" type="checkbox"/> X	(20 points) (0 points) 0 points
Distance to surface water: (horizontal distance to all wetlands, playas, irrigation canals, ditches, and perennial and ephemeral watercourses.)	Less than 200 feet 200 feet or more, but less than 1000 feet 1000 feet or more	(20 points) (10 points) (0 points) 0 points
Ranking Score (Total Points)		0 points

If this is a pit closure: (1) Attach a diagram of the facility showing the pit's relationship to other equipment and tanks. (2) Indicate disposal location. (check the onsite box if you are burying in place) onsite ☒ offsite ☐ If offsite, name of facility . (3) Attach a general description of remedial action taken including remediation start date and end date (4) Groundwater encountered: No ☒ Yes ☐ If yes, show depth below ground surface ft. and attach sample results. (5) Attach soil sample results and a diagram of sample locations and excavations.

Additional Comments	Contents of the pit were allowed to evaporate. Pit was back filled with dirt Pit remediation was started approximately 12-8-07. Pit was closed 12-28-07.

I hereby certify that the information above is true and complete to the best of my knowledge and belief. I further certify that the above-described pit or below-grade tank has been/will be constructed or closed according to NMOCD guidelines ☒, a general permit ☐, or an (attached) alternative OCD-approved plan ☐.

Date: 2/27/08

Printed Name/Title Craig Starkey, Permitting

Signature Craig Starkey

Your certification and NMOCD approval of this application/closure does not relieve the operator of liability should the contents of the pit or tank contaminate ground water or otherwise endanger public health or the environment. Nor does it relieve the operator of its responsibility for compliance with any other federal, state, or local laws and/or regulations.

Approval.

Deputy Oil & Gas Inspector,
District #3

Printed Name/Title

Signature B. A. Poll

Date: MAY 30 2008

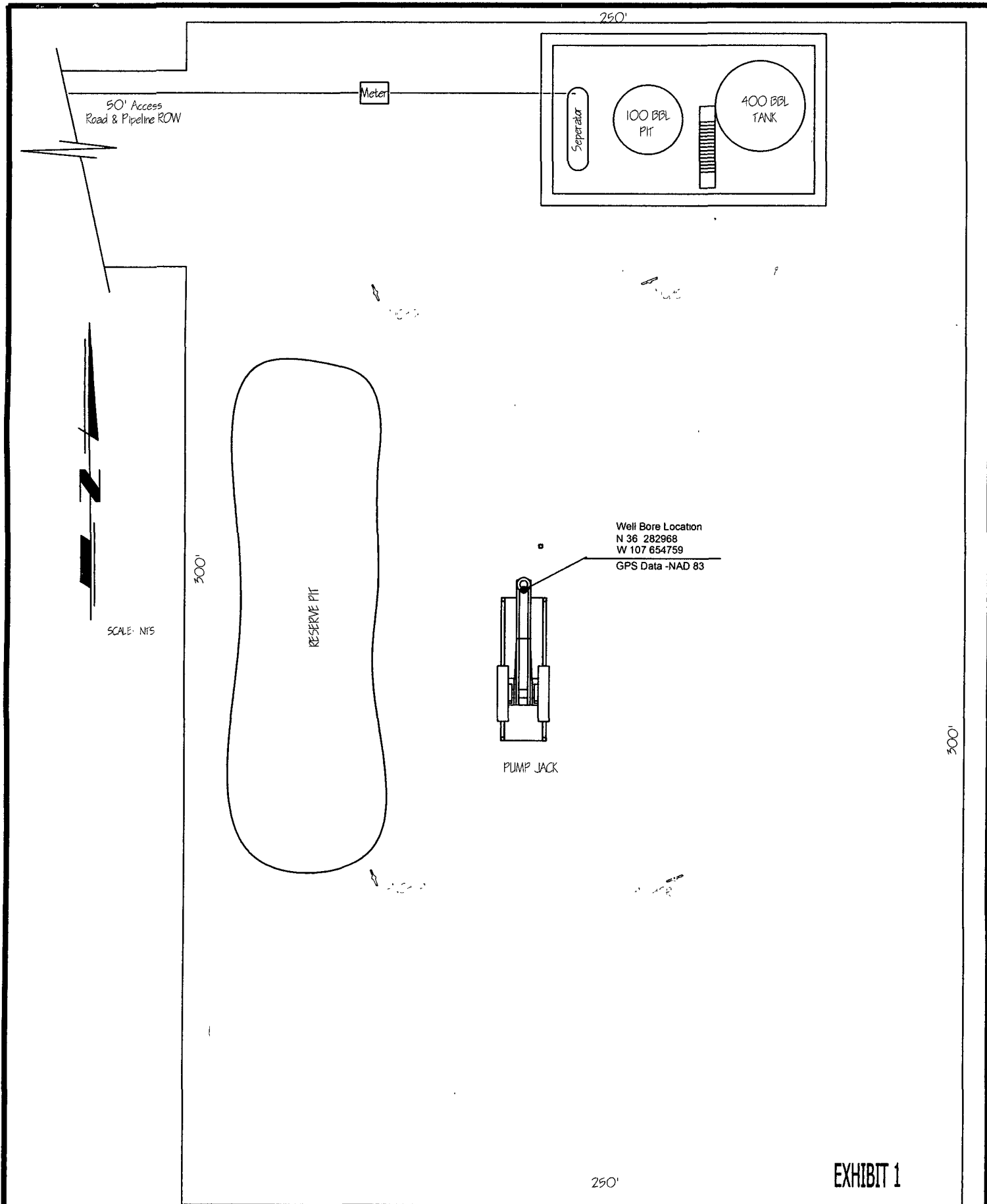

DJ SIMMONS, INC.
 1009 Ridgeway Place, Suite 200
 Farmington, NM. 87401
 Phone 505 326-3753
 Fax 505 327-4659

Reviewed By: Ken Manchester
 Drawn By: Craig Starkey
 Approved By: Rod Seale
 Date: Feb 20, 2008

Blanco 26-1
 Production Equipment Layout Plan
 Section 26, T24N, R8W, N.M.P.M.
 1773 FSL & 1593 FWL
 San Juan, County, New Mexico