

District I
1625 N French Dr , Hobbs, NM 88240
District II
1301 W Grand Avenue, Artesia, NM 88210
District III
1000 Rio Brazos Road, Aztec, NM 87410
District IV
1220 S St Francis Dr , Santa Fe, NM 87505

State of New Mexico
Energy Minerals and Natural Resources

Form C-144
June 1, 2004

Oil Conservation Division
1220 South St. Francis Dr.
Santa Fe, NM 87505

For drilling and production facilities, submit to appropriate NMOCD District Office.
For downstream facilities, submit to Santa Fe office

Pit or Below-Grade Tank Registration or Closure

Is pit or below-grade tank covered by a "general plan"? Yes No

Type of action Registration of a pit or below-grade tank Closure of a pit or below-grade tank

Operator <u>XTO Energy Inc.</u> Telephone <u>505 333-3207</u> e-mail address <u>kim_champlin@xtoenergy.com</u>		
Address <u>#382 County Road 3100, Aztec, NM 87410</u>		
Facility or well name <u>Irish #1</u>	API # <u>30-045-34140</u>	U/L or Qtr/Qtr _____ Sec <u>22C</u> T <u>25N</u> R <u>10W</u>
County <u>San Juan</u>	Latitude <u>36.391028</u>	Longitude <u>107.885833</u> NAD 1927 <input checked="" type="checkbox"/> 1983 <input type="checkbox"/>
Surface Owner Federal <input type="checkbox"/> State <input type="checkbox"/> Private <input type="checkbox"/> Indian <input checked="" type="checkbox"/>		
Pit	Below-grade tank	
Type: Drilling <input checked="" type="checkbox"/> Production <input type="checkbox"/> Disposal <input type="checkbox"/>	Volume _____ bbl Type of fluid _____	
Workover <input type="checkbox"/> Emergency <input type="checkbox"/>	Construction material _____	
Lined <input checked="" type="checkbox"/> Unlined <input type="checkbox"/>	Double-walled, with leak detection? Yes <input type="checkbox"/> If not, explain why not _____	
Liner type Synthetic <input type="checkbox"/> Thickness <u>12</u> mil Clay <input type="checkbox"/>	_____	
Pit Volume _____ bbl	_____	
Depth to ground water (vertical distance from bottom of pit to seasonal high water elevation of ground water)	Less than 50 feet	(20 points)
	50 feet or more, but less than 100 feet	(10 points)
	100 feet or more	(0 points)
Wellhead protection area (Less than 200 feet from a private domestic water source, or less than 1000 feet from all other water sources)	Yes	(20 points)
	No	(0 points)
Distance to surface water: (horizontal distance to all wetlands, playas, irrigation canals, ditches, and perennial and ephemeral watercourses)	Less than 200 feet	(20 points)
	200 feet or more, but less than 1000 feet	(10 points)
	1000 feet or more	(0 points)
Ranking Score (Total Points)		0 Points

If this is a pit closure: (1) Attach a diagram of the facility showing the pit's relationship to other equipment and tanks (2) Indicate disposal location (check the onsite box if you are burying in place) onsite offsite If offsite, name of facility _____. (3) Attach a general description of remedial action taken including remediation start date and end date (4) Groundwater encountered No Yes If yes, show depth below ground surface _____ ft and attach sample results (5) Attach soil sample results and a diagram of sample locations and excavations.

Additional Comments:
The drilling reserve pit associated with the subject well was closed per NMOCD and BLM guidelines and in accordance with XTO's drilling pit closure plan.
RCVD APR 24 '08
OIL CONS. DIV.
DIST. 3

I hereby certify that the information above is true and complete to the best of my knowledge and belief I further certify that the above-described pit or below-grade tank has been/will be constructed or closed according to NMOCD guidelines , a general permit , or an (attached) alternative OCD-approved plan .

Date 04/22/2008
Printed Name/Title Kim Champlin/Environmental Representative Signature Kim Champlin

Your certification and NMOCD approval of this application/closure does not relieve the operator of liability should the contents of the pit or tank contaminate ground water or otherwise endanger public health or the environment Nor does it relieve the operator of its responsibility for compliance with any other federal, state, or local laws and/or regulations

Approval	Deputy Oil & Gas Inspector, District #3	Signature <u>Bob Bell</u>	Date <u>MAY 30 2008</u>
Printed Name/Title			

XTO ENERGY INC.
 IRISH No. 1, 1010' FNL 1920' FWL
 SECTION 22, T25N, R10W, N.M.P.M., SAN JUAN COUNTY, N. M.
 GROUND ELEVATION: 6559', DATE: SEPTEMBER 13, 2005

LAT. = 36°23'27.7" N.
 LONG. = 107°53'09.0" W
 NAD 27

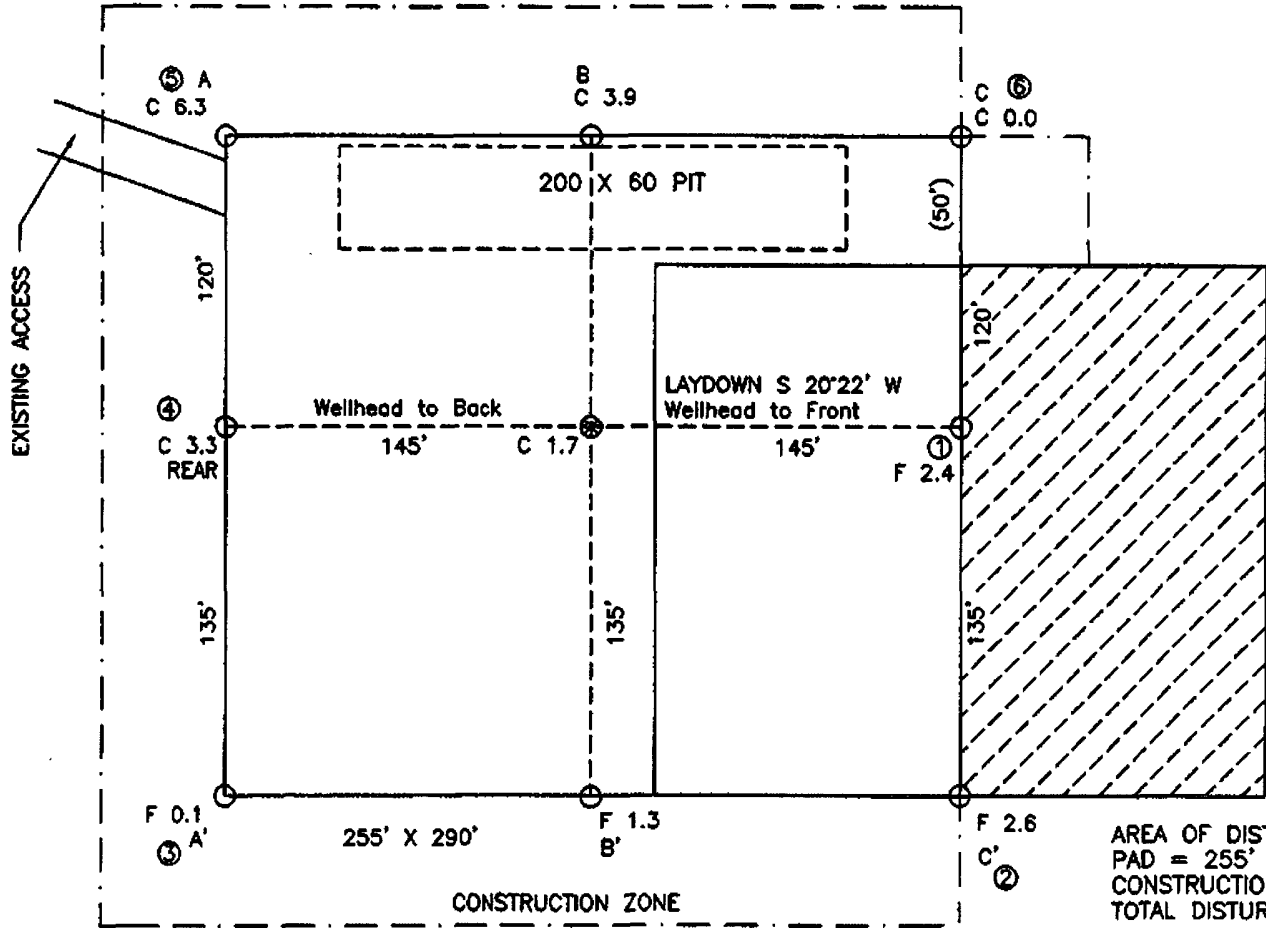

NOT TO SCALE

AREA OF DISTURBANCE:
 PAD = 255' x 290' = 1.7 ACRES
 CONSTRUCTION ZONE 985' x 50' = 1.1 ACRES
 TOTAL DISTURBANCE = 2.8 ACRES

Exhibit E

NOTE: DAGGETT ENTERPRISES, INC. IS NOT LIABLE FOR UNDERGROUND UTILITIES OR PIPELINES. NEW MEXICO ONE CALL TO BE NOTIFIED 48 HOURS PRIOR TO EXCAVATION OR CONSTRUCTION.

CONTRACTOR SHOULD CALL ONE-CALL FOR LOCATION OF ANY MARKED OR UNMARKED BURIED PIPELINES OR CABLES ON WELL PAD AND OR ACCESS ROAD AT LEAST TWO (2) WORKING DAYS PRIOR TO CONSTRUCTION.

	
Daggett Enterprises, Inc. Surveying and Oil Field Services P. O. Box 15066 • Farmington, NM 87401 Phone (505) 326-1772 • Fax (505) 326-6016 NEW MEXICO P.L.S. No. 14831	
DRAWN BY: A.G. ROUNG: CR454	CHECKED BY: CR454PLB DATE: 12/15/05