

District I
1625 N. French Dr., Hobbs, NM 88240
District II
1301 W. Grand Avenue, Artesia, NM 88210
District III
1000 Rio Brazos Road, Aztec, NM 87410
District IV
1220 S. St. Francis Dr., Santa Fe, NM 87505

State of New Mexico
Energy Minerals and Natural Resources

Form C-144
June 1, 2004

Oil Conservation Division
1220 South St. Francis Dr.
Santa Fe, NM 87505

For drilling and production facilities, submit to appropriate NMOCD District Office.
For downstream facilities, submit to Santa Fe office

Pit or Below-Grade Tank Registration or Closure

Is pit or below-grade tank covered by a "general plan"? Yes ☒ No ☐

Type of action: Registration of a pit or below-grade tank ☐ Closure of a pit or below-grade tank ☒

Operator: U. S. Enercorp. Ltd.

Telephone: (210) 829-4888

e-mail address: Katy@usenercorp.com

Address: P. O. Box 17098, San Antonio, TX 78217

Facility or well name: Almagre Arroyo 30 #1

API #: 30-039-30083

U/L or Qtr/Qtr NESW Sec 30 T 24 North R 1 East

County: Rio Arriba

Latitude 36.281820° N Longitude 106.876966° W

NAD: 1927 ☐ 1983 ☒

Surface Owner: Federal ☐ State ☐ Private ☒ Indian ☐

RCVD MAR 28 '08

Pit

Type: Drilling ☒ Production ☐ Disposal ☐

Workover ☐ Emergency ☐

Lined ☒ Unlined ☐

Liner type: Synthetic ☒ Thickness 12 mil Clay ☐

Pit Volume 26,715 bbl

Below-grade tank

Volume: _____ bbl Type of fluid: _____

Construction material: _____

Double-walled, with leak detection? Yes ☐ If not, explain why not.

OIL CONS. DIV.

DIST. 3

Depth to ground water (vertical distance from bottom of pit to seasonal high water elevation of ground water.)

Less than 50 feet

(20 points)

50 feet or more, but less than 100 feet

(10 points)

100 feet or more

(0 points)

Wellhead protection area: (Less than 200 feet from a private domestic water source, or less than 1000 feet from all other water sources.)

Yes

(20 points)

No

(0 points)

Distance to surface water: (horizontal distance to all wetlands, playas, irrigation canals, ditches, and perennial and ephemeral watercourses.)

Less than 200 feet

(20 points)

200 feet or more, but less than 1000 feet

(10 points)

1000 feet or more

(0 points)

Ranking Score (Total Points)

20

If this is a pit closure: (1) Attach a diagram of the facility showing the pit's relationship to other equipment and tanks. (2) Indicate disposal location: (check the onsite box if you are burying in place) onsite ☒ offsite ☐ If offsite, name of facility _____. (3) Attach a general description of remedial action taken including remediation start date and end date. (4) Groundwater encountered: No ☒ Yes ☐ If yes, show depth below ground surface _____ ft. and attach sample results. (5) Attach soil sample results and a diagram of sample locations and excavations.

Additional Comments:

Backfill of pit started 2-10-08 and was completed 2-25-08

I hereby certify that the information above is true and complete to the best of my knowledge and belief. I further certify that the above-described pit or below-grade tank has been/will be constructed or closed according to NMOCD guidelines ☒, a general permit ☐, or an (attached) alternative OCD-approved plan ☐.

Date: 3-15-08

Printed Name/Title Brian Wood / Consultant (Phone: 505 466-8120)

Signature B Wood

Your certification and NMOCD approval of this application/closure does not relieve the operator of liability should the contents of the pit or tank contaminate ground water or otherwise endanger public health or the environment. Nor does it relieve the operator of its responsibility for compliance with any other federal, state, or local laws and/or regulations.

Approval:

**Deputy Oil & Gas Inspector,
District #3**

Printed Name/Title _____

Signature B Wood

Date: MAY 30 2008

NOTIFY
NEW MEXICO ONE-CALL
BEFORE COMMENCING
EXCAVATION!
(800) 321-2537



0 50 100
SCALE: 1"=100'

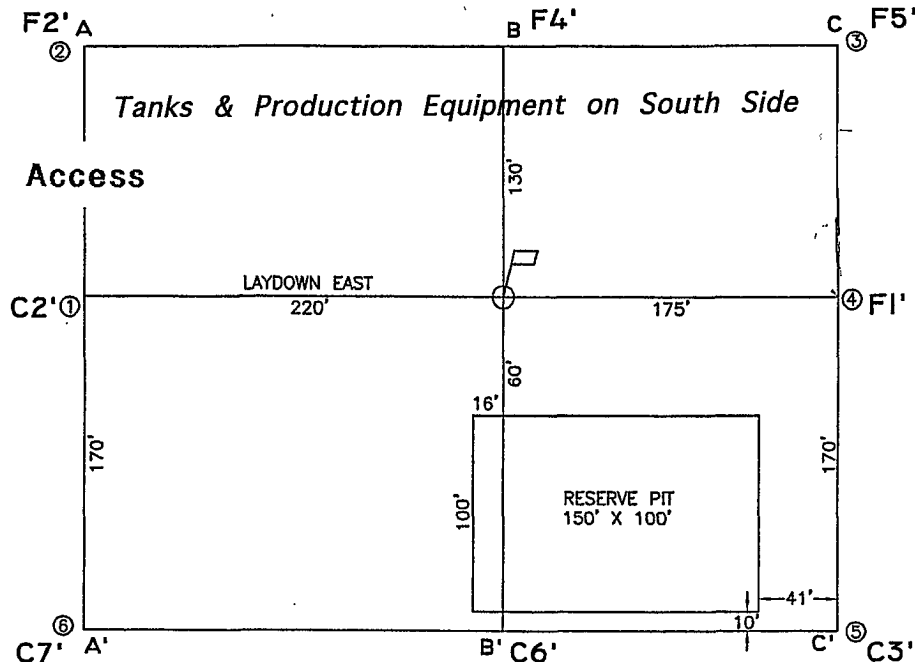

A-A'

7230
7220
7210
7200
7190

B-B'

7230
7220
7210
7200
7190

C-C'

7230
7220
7210
7200
7190

CROSS SECTIONS

HORIZONTAL: 1"=100'

VERTICAL: 1"=10'

LEASE: ALMAGRE ARROYO 30 #1

FOOTAGE: 2605' FSL, 2400' FWL

SEC. 30 TWN. 24 N RNG. 1 E N.M.P.M.

LATITUDE: 36.281820° LONGITUDE: 106.876966°

ELEVATION: 7212

U.S. ENERCORP, LTD.
SAN ANTONIO, TEXAS

SURVEYED: 3/14/06

REV. DATE:

APP. BY R.P.

DRAWN BY: A.D.

DATE DRAWN: 3/30/06

FILE NAME: 6626C01



P.O. BOX 3651
FARMINGTON, NM 87499
OFFICE: (505) 334-0408

UNITED STATES
DEPARTMENT OF THE INTERIOR
BUREAU OF LAND MANAGEMENTFORM APPROVED
OMB No. 1004-0137
Expires: March 31, 2007

SUNDRY NOTICES AND REPORTS ON WELLS

Do not use this form for proposals to drill or to re-enter an abandoned well. Use Form 3160-3 (APD) for such proposals.

SUBMIT IN TRIPLICATE- Other instructions on reverse side1. Type of Well
☒ Oil Well ☐ Gas Well ☐ Other2. Name of Operator
U. S. ENERCCORP, LTD.3a. Address
P. O. BOX 17098, SAN ANTONIO, TX 782173b. Phone No. (include area code)
210 829 4888

4. Location of Well (Footage, Sec., T., R., M., or Survey Description)

SHL: 2605' FSL & 2400' FWL 30-24N-1E NMPM

5. Lease Serial No.

NMNM-114942

6. If Indian, Allottee or Tribe Name

N/A

7. If Unit or CA/Agreement, Name and/or No.

N/A

8. Well Name and No.

ARROYO ALMAGRE 30 #1

9. API Well No.

30-039-30083

10. Field and Pool, or Exploratory Area

W. PUERTO CHIQUITO MANCOS

11. County or Parish, State

RIO ARRIBA COUNTY, NM

12. CHECK APPROPRIATE BOX(ES) TO INDICATE NATURE OF NOTICE, REPORT, OR OTHER DATA

TYPE OF SUBMISSION	TYPE OF ACTION			
<input type="checkbox"/> Notice of Intent	<input type="checkbox"/> Acidize	<input type="checkbox"/> Deepen	<input type="checkbox"/> Production (Start/Resume)	<input type="checkbox"/> Water Shut-Off
<input checked="" type="checkbox"/> Subsequent Report	<input type="checkbox"/> Alter Casing	<input type="checkbox"/> Fracture Treat	<input checked="" type="checkbox"/> Reclamation	<input type="checkbox"/> Well Integrity
<input type="checkbox"/> Final Abandonment Notice	<input type="checkbox"/> Casing Repair	<input type="checkbox"/> New Construction	<input type="checkbox"/> Recomplete	<input type="checkbox"/> Other
	<input type="checkbox"/> Change Plans	<input type="checkbox"/> Plug and Abandon	<input type="checkbox"/> Temporarily Abandon	
	<input type="checkbox"/> Convert to Injection	<input type="checkbox"/> Plug Back	<input type="checkbox"/> Water Disposal	

13. Describe Proposed or Completed Operation (clearly state all pertinent details, including estimated starting date of any proposed work and approximate duration thereof. If the proposal is to deepen directionally or recompleat horizontally, give subsurface locations and measured and true vertical depths of all pertinent markers and zones. Attach the Bond under which the work will be performed or provide the Bond No. on file with BLM/BIA. Required subsequent reports shall be filed within 30 days following completion of the involved operations. If the operation results in a multiple completion or recompleat in a new interval, a Form 3160-4 shall be filed once testing has been completed. Final Abandonment Notices shall be filed only after all requirements, including reclamation, have been completed, and the operator has determined that the site is ready for final inspection.)

Reserve pit backfilled 2-25-08
Will seed once ground has settled
Original of C-144 sent direct to OCD

RCVD MAR 28 '08

OIL CONS. DIV.

DIST. 3

ACCEPTED FOR RECORD

MAR 26 2008

FARMINGTON FIELD OFFICE
BY

cc: BLM, Rodriguez

14. I hereby certify that the foregoing is true and correct
Name (Printed/Typed)

BRIAN WOOD

(PHONE 505 466-8120)

Title CONSULTANT

(FAX 505 466-9682)

Signature

B Wood

Date

03/15/2008

THIS SPACE FOR FEDERAL OR STATE OFFICE USE

Approved by

Conditions of approval, if any, are attached. Approval of this notice does not warrant or certify that the applicant holds legal or equitable title to those rights in the subject lease which would entitle the applicant to conduct operations thereon.

Title

Date

Office

Title 18 U.S.C. Section 1001 and Title 43 U.S.C. Section 1212, make it a crime for any person knowingly and willfully to make to any department or agency of the United States any false, fictitious or fraudulent statements or representations as to any matter within its jurisdiction.

(Instructions on page 2)

NMOC