

District I
1625 N. French Dr., Hobbs, NM 88240
District II
1301 W. Grand Avenue, Artesia, NM 88210
District III
1000 Rio Brazos Road, Aztec, NM 87410
District IV
1220 S. St. Francis Dr., Santa Fe, NM 87505

State of New Mexico
Energy Minerals and Natural Resources

Oil Conservation Division
1220 South St. Francis Dr.
Santa Fe, NM 87505

Form C-101
May 27, 2004

Submit to appropriate District Office

☐ AMENDED REPORT

APPLICATION FOR PERMIT TO DRILL, RE-ENTER, DEEPEN, PLUGBACK, OR ADD A ZONE

Operator Name and Address ENERDYNE LLC P.O. BOX 502, ALBUQUERQUE, NM 87103		OGRID Number 185239
Property Code 025222	Property Name STATE	Well No. 104
Proposed Pool 1 CHACO WASH MESA VERDE		Proposed Pool 2

Surface Location

UL or lot no.	Section	Township	Range	Lot Ida	Feet from the	North/South line	Feet from the	East/West line	County
M	28	20N	9W		470	SOUTH	1100	WEST	McKINLEY

Proposed Bottom Hole Location If Different From Surface

UL or lot no.	Section	Township	Range	Lot Ida	Feet from the	North/South line	Feet from the	East/West line	County
---------------	---------	----------	-------	---------	---------------	------------------	---------------	----------------	--------

Additional Well Information

Work Type Code N	Well Type Code O	Cable/Rotary R	Lease Type Code S	Ground Level Elevation 6499' GR
Multiple NO	Proposed Depth 1200'	Formation MENELEE	Contractor ENERDYNE LLC	Spud Date 7-1-08
Depth to Groundwater > 200'		Distance from nearest fresh water well > 1000'		Distance from nearest surface water > 1000'
Pit: Linear Synthetic <input checked="" type="checkbox"/> 12 mils thick Clay <input type="checkbox"/> Pit Volume: 240 bbls Drilling Method: Closed-Loop System <input type="checkbox"/> Fresh Water <input checked="" type="checkbox"/> Brine <input type="checkbox"/> Diesel/Oil-based <input type="checkbox"/> Gas/Air <input type="checkbox"/>				

Proposed Casing and Cement Program

Hole Size	Casing Size	Casing weight/foot	Setting Depth	Sacks of Cement	Estimated TOC
8.75"	7.00"	23#	120"	35	SURFACE
6.25"	4.50"	10.5#	1200"	160	SURFACE

Describe the proposed program. If this application is to DEEPEN or PLUG BACK, give the data on the present productive zone and proposed new productive zone. Describe the blowout prevention program, if any. Use additional sheets if necessary.

7-1-08 SPUD WELL. DRILL 8.75" HOLE TO 132' GR. SET 125' OF 7.00" SURFACE CASING AND CEMENT TO SURFACE WITH 35 SACKS OF CLASS "B" CEMENT. TEST SURFACE AND DRILL OUT CEMENT. DRILL 6.25" HOLE WITH FRESH WATER AND POLYMER TO TEST THE 1100' MENELEE SANDSTONE. IF OIL IS PRESENT, SET 4.50" CASING TO TD AND CEMENT TO SURFACE WITH 160 SACKS OF CLASS "B" CEMENT. TEST CASING AND PERFORATE OIL ZONE. BOP WILL BE INSTALLED FOR PRESSURE CONTROL WITH KILL LINE FROM MUD PUMP AND FLOW LINE TO PIT.

I hereby certify that the information given above is true and complete to the best of my knowledge and belief. I further certify that the drilling pit will be constructed according to NMOCDD guidelines ☒, a general permit ☐, or an (attached) alternative OCD approved plan ☐.

Printed name: DON L HANOSH

Title: GENERAL MANAGER

E-mail Address: DHANOSH426@AOL.COM

Date: 6-9-08

Phone: 505-332-7807

OIL CONSERVATION DIVISION

Approved by:

Title: DEPUTY OIL & GAS INSPECTOR, DIST. #1

Approval Date: JUN 16 2008 Expiration Date: JUN 16 2010

Conditions of Approval Attached ☐

JUN 16 2008

HOLD ON FOR NSL

NOTIFY AZTEC OCD 24 HRS.
PRIOR TO CASING & CEMENT

RCVD JUN 11 '08
OIL CONS. DIV.
DIST. 3

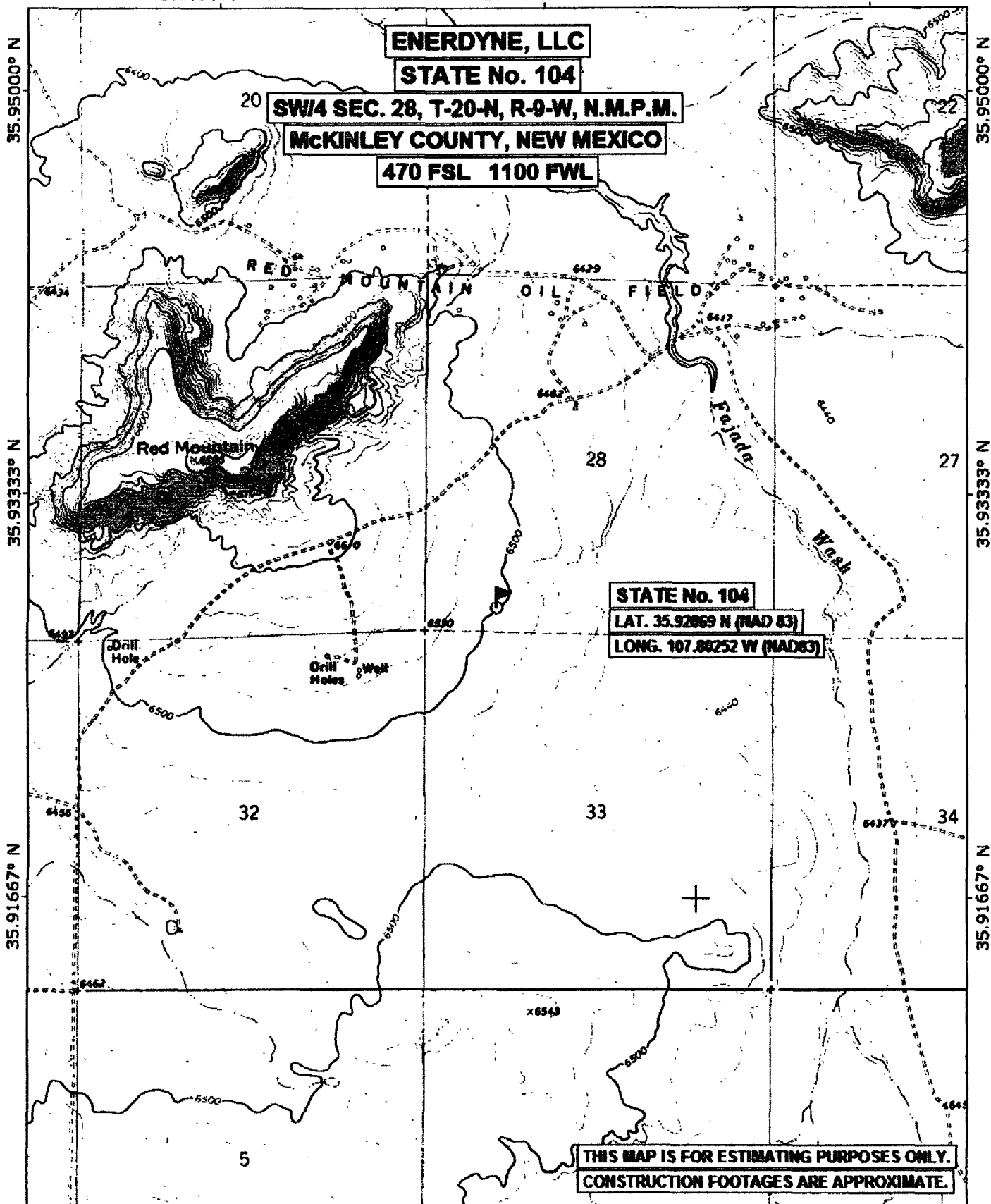

TN
10 1/2°

107.81667° W

107.80000° W

WGS84 107.78333° W

0 1000 FEET 0 500 1000 METERS